



---

**Date:** Monday, 4 November 2024  
**Time:** 3.00 pm  
**Venue:** Reception Lounge  
Auckland Town Hall  
301-305 Queen Street  
Auckland

---

## TŪPUNA MAUNGA O TĀMAKI MAKĀURAU AUTHORITY

### HUI 95 – 4 November 2024

## Open Agenda

---

<b>Chairperson</b>	Mr Paul Majurey	Ngā Mana Whenua o Tāmaki Makaurau (Marutūāhu Rōpū)
<b>Deputy Chairperson</b>	Toni van Tonder	Auckland Council (Devonport-Takapuna Local Board)
<b>Members</b>	Tauanu'u Nick Bakulich	Auckland Council (Mangere-Otahuhu Local Board)
	Ngarimu Blair	Ngā Mana Whenua o Tāmaki Makaurau (Ngāti Whātua Rōpū)
	Cr Christine Fletcher	Auckland Council (Governing Body - Albert-Eden - Puketāppa)
	Clay Hawke	Ngā Mana Whenua o Tāmaki Makaurau (Ngāti Whātua Rōpū)
	Nerissa Henry	Auckland Council (Maungakiekie-Tamaki Local Board)
	Cr Kerrin Leoni	Auckland Council (Governing Body - Whau)
	Josie Smith	Ngā Mana Whenua o Tāmaki Makaurau (Waiohua-Tāmaki Rōpū)
	Tania Tarawa	Ngā Mana Whenua o Tāmaki Makaurau (Marutūāhu Rōpū)
	Cr Ken Turner	Auckland Council (Governing Body - Waitākere)
	Karen Wilson	Ngā Mana Whenua o Tāmaki Makaurau (Waiohua-Tāmaki Rōpū)

*(Quorum is 7 members, comprising the chair or deputy chair and 2 members appointed by the rōpū entities and 2 members appointed by Auckland Council)*

### ITEM TABLE OF CONTENTS

1	Apologies	
2	Declaration of Interest	
3	Confirmation of Minutes	
4	Deferred from 16 September 2024 - Quarter 4 Report	11
5	Deferred from 16 September 2024 - Removal of Tūpuna Maunga from Schedule 2 – Auckland Council Policy on Dogs 2019	19
6	Deferred from 16 September 2024 - Māra Hūpara at Ōtāhuhu/Mt Richmond: Recommended Stage 1 Concept Design	25

7	Deferred from 16 September 2024 - Registers	33
	A    Health & Safety Register	
	B    Events Register	
8	Quarter 1 Report	43
9	Takarunga courts & bus parking development	51
10	Takarunga Playcentre Lease	61
11	Onehunga Māngere United Sports Club Incorporated Lease	67
12	Mt Wellington Roller Sports Club Inc (Skateland) Lease Renewal	73
13	Research Scholarship	79
14	Guy Fawkes Response Plan	81
15	Tūpuna Maunga Planting Update	83
16	Creation of a Bylaw for the Tūpuna Maunga	87
17	Registers	89
	A    Health & Safety Register	
	B    Events Register	

*Ngā Mana Whenua o Tāmaki Makaurau Collective Redress Act 2014*

*109 Functions and powers*

- (1) The Maunga Authority has the powers and functions conferred on it by or under this Act or any other enactment.
- (2) In exercising its powers and carrying out its functions in relation to the maunga, the Maunga Authority must have regard to—
  - (a) the spiritual, ancestral, cultural, customary, and historical significance of the maunga to Ngā Mana Whenua o Tāmaki Makaurau; and
  - (b) section 41(2).
- (3) In exercising its powers and carrying out its functions in relation to the administered lands, the Maunga Authority must have regard to the spiritual, ancestral, cultural, customary, and historical significance of the administered lands to Ngā Mana Whenua o Tāmaki Makaurau.

[Emphasis added]

*41 Maunga must remain as reserves vested in trustee*

- (1) This section applies to each maunga once the maunga is—
  - (a) vested in the trustee under subpart 1, 2, or 3 of this Part;and
  - (b) Declared a reserve under any of sections 18 to 29, 33, and 39.
- (2) The maunga is held by the trustee for the common benefit of Ngā Mana Whenua o Tāmaki Makaurau and the other people of Auckland.

...

[Emphasis added]





## Tūpuna Maunga Reserve Status\*

The following Tūpuna Maunga, with the relevant reserve status, are classified as reserves subject to the Reserves Act 1977

Maunga	Reserve Status
Matukutūruru	Historic reserve
Maungakiekie / One Tree Hill	Recreation reserve
Maungarei / Mt Wellington	Recreation reserve, Local Purpose reserve
Maungawhau / Mount Eden	Historic reserve, Recreation reserve
Maungauika / North Head	Historic reserve
Ōwairaka / Te Ahi-kā-a-Rakataura / Mount Albert	Recreation reserve
Pukewīwī / Puketāpapa / Mount Roskill	Recreation reserve
Te Kōpuke / Tītīkōpuke / Mount St John	Recreation reserve
Ōhinerau / Mount Hobson	Recreation reserve
Ōhūiarangi / Pigeon Mountain	Historic reserve, Recreation reserve, Local Purpose reserve
Ōtāhuhu / Mount Richmond	Recreation reserve
Takarunga / Mount Victoria	Recreation reserve, Local Purpose reserve
Te Tātua-a-Riukiuta / Big King	Recreation reserve
Te Ara Pueru / Te Pane-o-Mataaho / Mangere Mountain	Historic reserve, Recreation reserve, Local Purpose reserve
Rarotonga / Mount Smart	Recreation reserve

\* See sections 18-29, 33 (repealed), 39, 41, 47, 53, 54, and Schedules 1 & 2, 6 of Ngā Mana Whenua o Tāmaki Makaurau Collective Redress Act 2014





**Date:** Monday, 16 September 2024  
**Time:** 2:30 pm  
**Venue:** Reception Lounge  
Auckland Town Hall  
301-305 Queen Street  
Auckland

---

## **TŪPUNA MAUNGA O TĀMAKI MAKĀURAU AUTHORITY**

**HUI 94 – 16 September 2024**

### **Open Minutes**

---

The 16 September 2024 Tūpuna Maunga o Tāmaki Makaurau Authority meeting lapsed due to the lack of a quorum caused by absence of members.

An upcoming Tūpuna Maunga o Tāmaki Makaurau Authority scheduled for 1.00pm Monday, 21<sup>st</sup> of October, in the Reception Lounge, Auckland Town Hall, will consider the items on the 16 September 2024 agenda.



## Open Agenda

### 1 Apologies

That the Tūpuna Maunga o Tāmaki Makaurau Authority:

a) accept the apologies from:

Josie Smith  
Nerissa Henry

Lateness:

Toni Van Tonder

### 2 Declaration of Interest

Members are reminded of the need to be vigilant to stand aside from decision making when a conflict arises between their role as a member and any private or other external interest they might have.

### 3 Confirmation of Minutes

a) whakaū / confirm the minutes of Hui 93 held on Monday, 29 July 2024, as a true and accurate record.





---

## Deferred from 16 September 2024 - Quarter 4 Report

Author: Dominic Wilson, Te Taihū Waka Tairānga Whenua

<b>Purpose</b>	To consider the Quarterly Report for the fourth quarter of the 2023/24 financial year.
<b>Recommendations</b>	That the Tūpuna Maunga o Tāmaki Makaurau Authority: a) <b>note</b> the attached 4th Quarter Report for the 2023/24 financial year.

### Latest Quarterly Report

1. Attached is the Tūpuna Maunga Authority Quarterly Report for the fourth quarter of the 2023/24 financial year.

### Attachments

Attachment A: Quarter 4 Report [↓](#)





## QUARTER 4 REPORT

As at 30 June 2024

## CONTENTS

### 1. Key highlights

### 2. Tūpuna Maunga – key objectives and Maunga-specific work programme

### 3. Financials

#### 3.1 Operating revenue and costs

#### 3.2 Capital projects

## 1. Key highlights in this quarter:

### Planting season

The team started the community and kura planting days within this quarter over ngā Tūpuna Maunga; including Ōtāhuhu, Puketāpapa/Pukewīwī, Te Tātua a Riukiuta, Ōhinerau and Ōhūiarangi. Approximately 200+ volunteers came to the 6 days, and 10000 plants planted.

### Matariki

The Maunga experienced an increase in visitors wanting to observe Matariki.

### Te Taiao education and engagement

Delivered the jobs for nature program to multiple schools. This includes an overview of the TMA’s efforts around biodiversity and biosecurity and how tamariki and kura can get involved in these efforts to uplift our Maunga.

## 2. Tūpuna Maunga key activities and Maunga-specific work programmes

This section of the Performance Report lists each of the Tūpuna Maunga and the key activities undertaken Quarter 2.

Matukutūruru / Wiri	Pest animal management undertaken.
Maungakiekie / One Tree Hill	Fire prevention work undertaken. Firebreaks work. Scheduled tree maintenance undertaken. Renewal Playground wharepaku.
Maungarei / Mt Wellington	Firebreaks work.
Maungauika/North Head	Pest animal management undertaken.
Maungawhau / Mt Eden	Pest animal management undertaken. Scheduled tree maintenance undertaken. Renewal Maungawhau Kiosk deck.
Ōhinerau / Mt Hobson	Firebreaks work. Pest animal management undertaken. Community planting days.

Ōhūiarangi/Pigeon Mountain	Firebreaks work. Pest animal management undertaken. Community planting days.
Ōtāhuhu / Mt Richmond	Firebreaks work. Scheduled tree maintenance undertaken. Community planting day.
Ōwairaka / Te Ahi-Kā-Rakataura /Mt Albert	Firebreaks work. Pest animal management undertaken. Scheduled tree maintenance undertaken. Strengthening work undertaken on changing rooms.
Pukewīwī / Puketāpapa / Mt Roskill	Firebreaks work. Pest animal management undertaken. Scheduled tree maintenance undertaken. Manu Aute day.
Takarunga / Mt Victoria	Firebreaks work. Pest animal management undertaken. Renewals to Whare Toi building undertaken.
Te Kōpuke / Titikōpuke / Mt St John	Firebreaks work. Pest animal management undertaken. Remedial work undertaken after storm damage on tracks.
Te Pane-o-Mataaho/ Te Ara Pueru / Māngere Mountain	Firebreaks work. Pest animal management undertaken. Scheduled tree maintenance undertaken. First hāngi pit booking delivered. Digital campaign for hāngi pit launched (billboard, social)
Te Tātua-a-Riukiuta / Big King	Firebreaks work. Pest animal management undertaken. Community planting day.



## 3.0 FINANCIALS

### 3.1 Operating revenue and costs

**TŪPUNA MAUNGA O TĀMAKI MAKAURAU AUTHORITY**  
Operating Revenue and Expenditure for Quarter 4 as at 30 June 2024

	Actual Qtr 4 \$'000	Budget Qtr 4 \$'000	Variance Qtr 4 \$'000	Actual YTD \$'000	Budget YTD \$'000	Variance YTD \$'000
Operating Revenue	-111	-89	22	-381	-356	25
Operating Expenditure	1,426	1,356	-70	4,829	4,761	-68
Governance Costs	29	40	12	106	161	55
<b>Net Operating Result</b>	<b>1,344</b>	<b>1,308</b>	<b>-37</b>	<b>4,554</b>	<b>4,566</b>	<b>12</b>

**TŪPUNA MAUNGA O TĀMAKI MAKAURAU AUTHORITY**  
Operating Revenue and Expenditure for Quarter 4 as at 30 June 2024

	Actual Qtr 4 \$'000	Budget Qtr 4 \$'001	Variance Qtr 4 \$'000	Actual YTD \$'000	Budget YTD \$'000	Variance YTD \$'000
Fees and user charges revenue	-11	-14	-3	-22	-56	-34
Property rental revenue	-99	-75	24	-359	-300	59
<b>Operating Revenue</b>	<b>-111</b>	<b>-89</b>	<b>22</b>	<b>-381</b>	<b>-356</b>	<b>25</b>
Repairs and maintenance & Outsourced works	635	679	44	2,527	2,490	-37
Professional services	15	72	57	187	232	45
Other expenditure on activities	777	606	-171	2,115	2,038	-77
<b>Operating Expenditure</b>	<b>1,426</b>	<b>1,356</b>	<b>-70</b>	<b>4,829</b>	<b>4,761</b>	<b>-68</b>
<b>Governance Costs</b>	<b>29</b>	<b>40</b>	<b>12</b>	<b>106</b>	<b>161</b>	<b>55</b>
<b>Net Operating Result</b>	<b>1,344</b>	<b>1,308</b>	<b>-37</b>	<b>4,554</b>	<b>4,566</b>	<b>12</b>

**Financial Commentary:**

**Operating Revenue** for quarter four, and for the ended 30 June 2024 was slightly favourable due to lease revenue.

**Operating Expenditure** for quarter four ended 30 June 2024 was higher than budget due to the timing of payments relating to water and electricity and is in line with budget for the year.

### 3.2 Capital projects

**TŪPUNA MAUNGA O TĀMAKI MAKAURAU AUTHORITY**  
Capital Expenditure for Quarter 4 as at 30 June 2024

	Actual YTD \$'000	Budget YTD \$'000	Variance YTD \$'000	FY Budget (incl c/fwd) \$'000
<b>Total Capital Projects</b>	6,893	15,658	8,765	15,658

**Financial Commentary:**

**Capital Expenditure** for the year ended 30 June 2024 was underspent mainly due to adverse weather events during the second half of the financial year. Some work programmes that were planned last financial year will be progressed in FY25 and work programmes are in place to utilise the full capex budget for FY25.

**Deferred from 16 September 2024 - Removal of Tūpuna Maunga from Schedule 2 – Auckland Council Policy on Dogs 2019**

Author: Dominic Wilson, Te Tauihu Waka Tairanga Whenua

<b>Purpose</b>	To consider whether to recommend removal all Tūpuna Maunga from Schedule 2 of the Auckland Council Policy on Dogs 2019.
<b>Recommendation</b>	That the Tūpuna Maunga o Tāmaki Makaurau Authority:  a) <b>requests</b> management to make a submission to the Auckland Council on its review of the Auckland Council Policy of Dogs 2019 seeking the removal of all Tūpuna Maunga from Schedule 2 of that policy.

**Background**

1. The Dog Control Act (DCA) 1996 requires Auckland Council to have a policy on dogs and a bylaw to implement the policy.
2. The Auckland Council Policy on Dogs 2019 (Policy on Dogs) came into force on 1 November 2019 with the main objective being to keep dogs as a positive part of the life of Aucklanders by:
  - a. Maintaining opportunities for owners to take their dogs into public places
  - b. Adopting measures to minimise the problems caused by dogs
  - c. Protecting dogs from harm and ensuring their welfare.
3. The Auckland Council bylaw must be reviewed in 2024 to determine if it is still appropriate having regard to a number of matters including:
  - a. The need to minimise danger, distress, and nuisance to the community generally.
4. Whilst the Policy on Dogs does not expire, this policy will be included in the review process. The policy includes general dog access rules in public spaces as well as designated dog access rules, which impacts 4 Maunga.

**Statutory and other considerations**

5. The process and any decision to adopt an Operational Plan, and summary thereof, is required to take into account the legislative and policy framework.
6. Section 109(2) of Ngā Mana Whenua o Tāmaki Makaurau Collective Redress Act 2014 requires the Authority to have regard to the spiritual, ancestral, cultural, customary, and historical significance of the Maunga to Ngā Mana Whenua o Tāmaki Makaurau and that the Tūpuna Maunga is held in trust for Ngā Mana Whenua and the other people of Auckland.
7. The Tūpuna Maunga Authority’s Integrated Management Plan was unanimously adopted (Mana Whenua and Auckland Council members) by the Authority pursuant to the Ngā Mana Whenua o Tāmaki Makaurau Collective Redress Act 2014 and Reserves Act 1977. The Integrated Management Plan describes a series of “Values” and “Pathways” that guide all activities on the Tūpuna Maunga.

8. The Tūpuna Maunga Authority (Mana Whenua and Auckland Council members) unanimously adopted the Tūpuna Maunga Strategies at Hui 50 on 25 September 2020. The Tūpuna Maunga Strategies are 7 key sections that outline the strategic direction with regards to education, Biodiversity, Tūpuna Maunga design, Recreation, commercial activities and monitoring. Together with the IMP, these strategies inform guide and manage the activities undertaken on the Maunga.
9. The Ngā Mana Whenua o Tāmaki Makaurau Collective Redress Act 2014 sets out a process for the adoption of an “Annual Operational Plan” by the Authority (refer sections 60-63). Management have worked alongside the council’s legal and finance teams to ensure compliance with the procedures set out in the legislation.
10. The Authority administers the Tūpuna Maunga under the Reserves Act 1977 and pursuant to Ngā Mana Whenua o Tāmaki Makaurau Collective Redress Act 2014. The Hauraki Gulf Marine Park Act 2000 is also applicable in relation to Maungauika.

## **Discussion**

### **Current Dog Access on the Maunga**

#### Schedule Definitions in the Auckland Council Policy

11. The Policy on Dogs includes two schedules that relate to dog access rules, these being Schedule 1 and Schedule 2.
12. Schedule 2 refers to dog access rules in defined locations which are under decision making control of Auckland Council. Currently there are 3 Maunga and two designated areas on Maungawhau that are defined as Schedule 2 sites.
  - Ōwairaka /Te Ahi-kā-a-Rakataura/Mount Albert.
  - Takarunga/Mount Victoria.
  - Te Tātua-a-Riukiuta/Big King.
  - Maungawhau Domain: the fenced paddock between Clive Rd entrance and Summit Rd.
  - Tahaki Reserve: north-east of the bowl demarcated by the bush and pathway,
13. Schedule 1 in the Policy on Dogs relates to general dog access rules. The remaining Tūpuna Maunga are subject to Schedule 1 default dog access rules (clause (c) to (d)).
14. See attachment A for current dog access rules on the Maunga.

### **Current Decision-Making Authority on the Maunga**

#### Schedule 2 Decision-Maker

15. The Maunga and included areas listed above are all specifically mentioned in Schedule 2. This means that the decision-maker regarding dog access rules in these areas is Auckland Council. Management recommend it is the Tūpuna Maunga Authority that should have the authority to set policy positions (as provided for in Schedule 1).

Schedule 1 Decision-Maker

16. Any Maunga that are not specifically listed in Schedule 2 are under the decision-making authority of the Tūpuna Maunga Authority.

**Recommending the Transfer Decision-Making Authority**

Auckland Council review of Policy on Dogs 2019

17. The Authority has an opportunity to request that through the review process, Auckland Council reclassify all Schedule 2 Maunga and areas to Schedule 1. This would ensure that the Authority has the future ability to make dog access policy decisions on every Maunga.

18. All current dog access rules would remain the same if the schedule change was implemented after review, until such a time as the Authority may deem it necessary to change policy position.

19. The approximate timeline for this Council review process includes the following:

- a. Seeking local board feedback on the draft proposal in October,
- b. The Regulatory and Community Safety Committee recommends a proposal to the Governing Body to adopt for public consultation in December.
- c. Public consultation is scheduled for January/February 2025.
- d. Final decision is expected to be made in July 2025.

**Attachments**

Attachment A: Current Dog Access Rules on the Maunga [↓](#)





Attachment A: Current Dog Access Rules on the Maunga

Maunga Dog Access Rules			
Maunga	Access Rules	Schedule (Policy on Dogs)	Decision Making Authority
Takarunga/Mt Victoria	Under control, off-leash	Schedule 2	Auckland Council
Ōwairaka/Mt Albert/Te Ahi Kā a Rakataura	Under control, off-leash	Schedule 2	Auckland Council
Te Tātua/Big King	Under control, off-leash	Schedule 2	Auckland Council
“Maungawhau Domain”: the fenced paddock between Clive Rd entrance and Summit Rd at Maungawhau	Under control, off-leash	Schedule 2	Auckland Council
Tahaki Reserve: north-east of the bowl, demarcated by the bush and pathway at Maungawhau	Under control, off-leash	Schedule 2	Auckland Council
Maungawhau/Mt Eden	Under control, on-leash	Schedule 1	TMA
Maungauika/North Head	Under control, on-leash	Schedule 1	TMA
Pukewī/Puketāpapa/Mt Roskill	Under control, on-leash	Schedule 1	TMA
Te Kōpuke/Titokōpuke/Mt St John	Under control, on-leash	Schedule 1	TMA
Ōhinerau/Mt Hobson	Under control, on-leash	Schedule 1	TMA
Maungakiekie/One Tree Hill	Under control, on-leash	Schedule 1	TMA
Ōtāhuhu/Mt Richmond	Under control, on-leash	Schedule 1	TMA
Te Pane-o-Mataaho/Māngere Mountain/Te Ara Pueru	Under control, on-leash	Schedule 1	TMA
Ōhūiarangi/Pigeon Mountain	Under control, on-leash	Schedule 1	TMA
Maungarei/Mt Wellington	Under control, on-leash	Schedule 1	TMA
Matukutūruru/Wiri Mountain	Under control, on-leash	Schedule 1	TMA



**Deferred from 16 September 2024 - Māra Hūpara at Ōtāhuhu/Mt Richmond:  
Recommended Stage 1 Concept Design**

Author: Dominic Wilson, Te Taihū Waka Tairanga Whenua

<b>Purpose</b>	To consider a concept design for the reinstatement of the neighbourhood playground at Ōtāhuhu / Mount Richmond.
<b>Recommendation</b>	That the Tūpuna Maunga o Tāmaki Makaurau Authority:  a) <b>approve</b> the replacement of the neighbourhood playground at Ōtāhuhu / Mount Richmond in accordance with Attachment A to this report.

**Background**

1. The Auckland Storm events in early 2023 resulted in a large tree falling over and destroying the existing neighbourhood playground at Ōtāhuhu/Mt Richmond. This event has provided the opportunity not only for the Tūpuna Maunga Authority to look at future play opportunities for the Maunga but also to investigate ways to enhance the mauri of the Maunga, improve the visitor experience, and increase community understanding of and respect for the Maunga.
2. The site location is as below.



**Statutory and other considerations**

3. Any decision to determine management within a reserve must take into account the legislative and policy framework.
4. The Authority administers the Tūpuna Maunga under the Reserves Act 1977 and pursuant to Ngā Mana Whenua o Tāmaki Makaurau Collective Redress Act 2014. The Hauraki Gulf Marine Park Act 2000 is also relevant. The activities of the Scouts are consistent with the reserve classification.

5. Section 109(2) of Ngā Mana Whenua o Tāmaki Makaurau Collective Redress Act 2014 requires the Authority to have regard to the spiritual, ancestral, cultural, customary, and historical significance of the Maunga to Ngā Mana Whenua o Tāmaki Makaurau and that the Tūpuna Maunga is held in trust for Ngā Mana Whenua and the other people of Auckland.
6. The Tūpuna Maunga Authority's Integrated Management Plan (IMP) was adopted by the Authority in terms of Ngā Mana Whenua o Tāmaki Makaurau Collective Redress Act 2014 and the Reserves Act 1977. The Integrated Management Plan describes a series of "Values" and "Pathways" that guide all activities on the Tūpuna Maunga. The primary focus of the IMP is to protect the health and well-being of the Tūpuna Maunga.
7. The Tūpuna Maunga Authority adopted the Tūpuna Maunga Strategies at Hui 50 on 25 September 2020. The Tūpuna Maunga Strategies are 7 key sections that outline the strategic direction with regards to education, Biodiversity, Tūpuna Maunga design, Recreation, commercial activities and monitoring. Together with the IMP, these strategies inform guide and manage the activities undertaken on the Maunga.

## **Discussion**

### **Reporepo Proposal**

8. The Authority has considered this project at Hui 91 (29 April 2024) and Hui 93 (29 July 2024). The concept presented as Attachment A incorporates the Authority's feedback from those hui. The concept of Reporepo is based on traditional hīnaki (eel trap). Key play feature takes the form of a hīnaki (eel trap) acknowledging the wetland basin that was once a source of kai and mahinga kai. Play experiences include swinging, climbing, rocking, wheeled play, imaginative play, sensory nature play. This concept utilises New Zealand manufactured play elements.
9. In relation to interpretative signage, this element will be progressed through a separate project which will look at signage across the Maunga including the playground.

### **Next Steps**

10. With the approval of the Stage 1 Tākaro Concept, the Team will proceed to procurement and implementation. The Team is working towards having the playground reinstated in Summer 2025.

## **Attachments**

Attachment A: Reporepo Concept (May 2024)[↓](#)



Boffa Miskell 

# ŌTĀHUHU MĀRA HŪPARA

STAGE 01 CONCEPTS  
APRIL 2024







Boffa Miskell is proudly a  
Toitū net carbonzero certified consultancy

**DOCUMENT QUALITY ASSURANCE**

**BIBLIOGRAPHIC REFERENCE FOR CITATION:**

Boffa Miskell, 2020. *Ōtāhuhu Māra Hūpara Concept Document*. Report by Boffa Miskell Limited for Tūpuna Maunga Authority.

**PREPARED BY:** Zak Kelland  
Landscape Architect  
Boffa Miskell Ltd

**REVIEWED BY:** William Hatton  
Project Landscape Architect  
Boffa Miskell Ltd

**STATUS: [DRAFT]** Revision / version: 0

Issue date: April 2024

File ref: BM230665\_concept\_package

Cover photograph: Photo of current stage 01 site from the top of the Ōtāhuhu maunga, © William Hatton, 2024

# STAGE 01 EXTENT

CAPTION  
THIS IS PLACEHOLDER TEXT. TO BRING THIS MASTER PAGE TEXT ONTO YOUR CURRENT PAGE SO YOU CAN EDIT IT, PRESS CTRL+SHIFT AND CLICK ON THE TEXT. A FRAME WILL APPEAR SELECTED AND YOU CAN DOUBLE CLICK THE TEXT TO SELECT AND REPLACE IT.

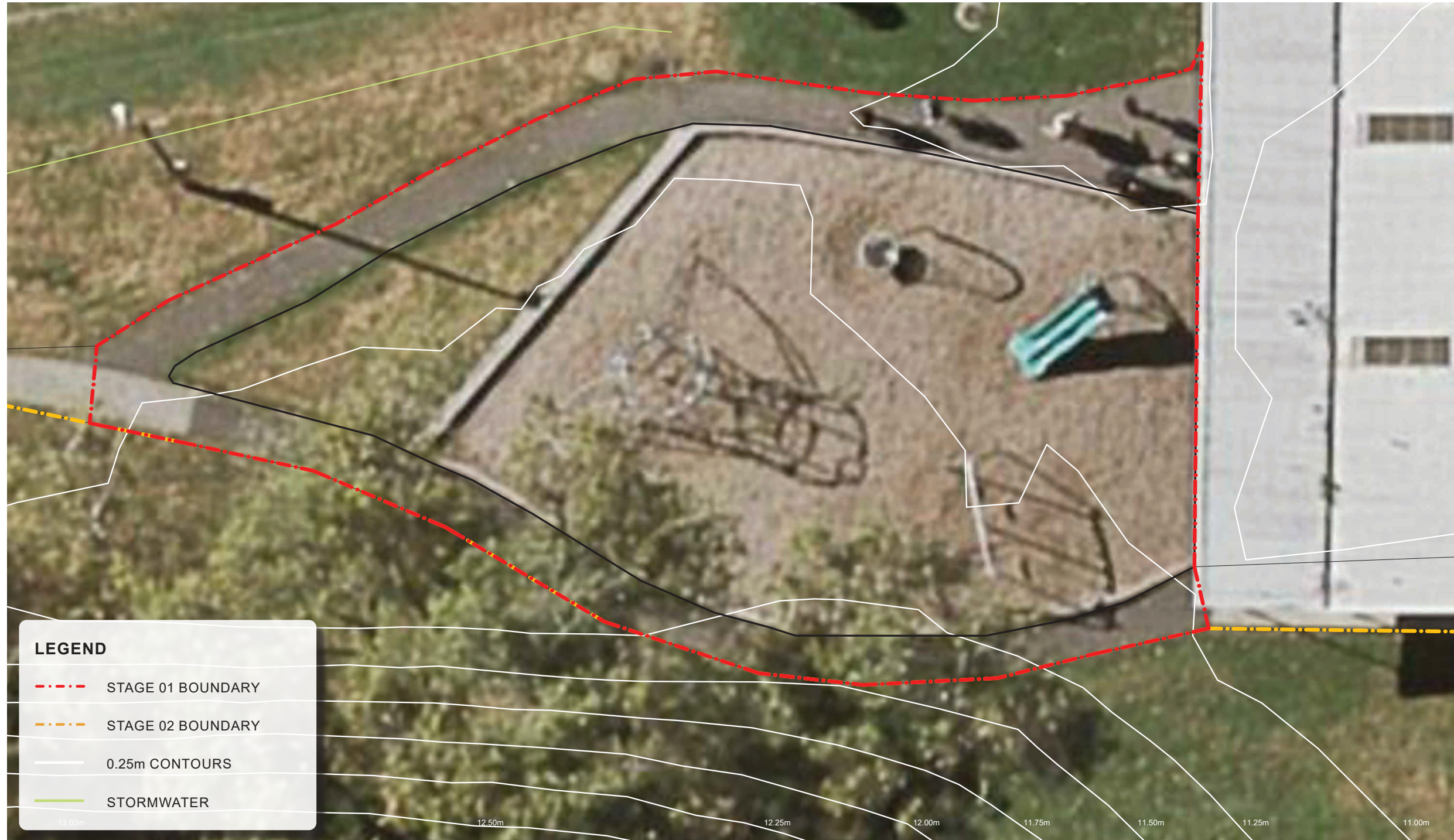
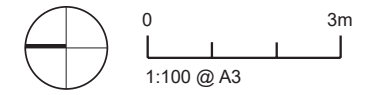



## STAGE 1 OPTION 02B REPOREPO

Construction estimate: \$170,000.00  
(cheaper Hīnaki-themed play structure)

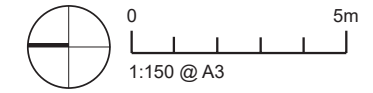

**Design Intent:** Key play feature takes the form of a hīnaki (eel trap) acknowledging the wetland basin that was once a source of kai and mahinga kai. Play experiences include swinging, climbing, rocking, wheeled play, imaginative play, sensory nature play.



**Together. Shaping Better Places.**

Boffa Miskell is a leading New Zealand environmental consultancy with nine offices throughout Aotearoa. We work with a wide range of local, international private and public sector clients in the areas of planning, urban design, landscape architecture, landscape planning, ecology, biosecurity, Te Hīhiri (cultural advisory), engagement, transport advisory, climate change, graphics and mapping. Over the past five decades we have built a reputation for creativity, professionalism, innovation and excellence by understanding each project's interconnections with the wider environmental, social, cultural and economic context.



[www.boffamiskell.co.nz](http://www.boffamiskell.co.nz)

<b>Whangarei</b>	<b>Auckland</b>	<b>Hamilton</b>	<b>Tauranga</b>	<b>Wellington</b>	<b>Nelson</b>	<b>Christchurch</b>	<b>Queenstown</b>	<b>Dunedin</b>
09 358 2526	09 358 2526	07 960 0006	07 571 5511	04 385 9315	03 548 8551	03 366 8891	03 441 1670	03 470 0460



---

## Deferred from 16 September 2024 - Registers

Author: Dominic Wilson, Te Taihū Waka Tairanga Whenua

<b>Purpose</b>	To consider update registers for: a) Heath & Safety (Attachment A) b) Events (Attachment B)
<b>Recommendation</b>	That the Tūpuna Maunga o Tāmaki Makaurau Authority: a) <b>note</b> the attached Registers, which have been updated since Hui 93 (29 July 2024).

### Registers

Attachment A: [Health & Safety Register](#)

Attachment B: [Events Register](#)



Health and Safety Register

Hui reported to	Maunga	Summary of incident	Number of any near misses	Outcome of investigations into any incidents and near misses	Health and Safety management matters arising	Actions Taken
Hui 94	Maungauika	Walking through from Cheltenham to unlock gate, contractor has been frightened by a cat jumping out and has fallen over onto the rocks.		Reviewed need to lock/unlock gate in good visibility.	Injury to contractor	Reinforcement of safety protocols for working in low visibility.
Hui 94	Matukutururu	Gate has been damaged unable to open up.		Random act of vandalism	Damage to structure on the Maunga	Gate and fixings repaired
Hui 94	Matukutururu	Contractor sustained minor facial injury from a stone propelled from another's operator's weed eater.		Contractor was wearing full PPE and safety goggles protected from more serious injury	Injury to contractor	Reinforcement of safety protocols and PPE requirements when doing this mahi at toolbox meeting
Hui 93	Puketāpapa/ Pukewīwī	While pruning garden, contractor has been hit in the face by a branch.		Human error – working too quickly	Potential injury to contractor	Reinforcement of safety protocols and PPE requirements when doing this mahi at toolbox meeting.
Hui 93	Maungauika	While unlocking tunnel gates, contractor has jammed finger in the lock.		Lock mechanism is in good working condition pulled the lock out too quickly	Injury to contractor	Reinforcement of safety protocols at toolbox meeting.
Hui 93	Maungakiekie	Leaving the carpark turned too sharp and collided with a rock on the corner. Damage on the passenger side.		Contractor needed to give more berth in playground carpark when turning. Structure on Maunga is fine.	Damage to structure on the Maunga	Reinforcement of safety protocols at toolbox meeting.
Hui 93	Maungakiekie	The contractor was reversing out of carpark at Stardome, didn't see a cyclist coming down fast towards Manukau and had to break fast to avoid a collision	1	Contractor did not look again while reversing and didn't see cyclist. Cyclist likely travelling faster than speed limit contributed to not seeing them.	Potential injury to public	Reinforcement of safety protocols at toolbox meeting. Management to look at whether speed signage on Maunga is enough.
Hui 93	Maungakiekie	Contractor has backed in the pole of the autogate during work on the Maunga.		Contractor did not have a spotter when reversing and hit the pole.	Damage to structure on the Maunga	Pole reinstated. Reinforcement of safety protocols at toolbox meeting.
Hui 92	Maungakiekie	Member of public has slipped on a section of the tihi road on Maungakiekie.	1	The lichen along the edge of the road was getting slippery in the wet.	Potential fall injury to public	Immediate area water blasted. Program of tihi road treatment reviewed to ensure covering problem areas.
Hui 92	Maungakiekie	Member of public has tripped over on the reduced path on Olive Grove on Maungakiekie and sustained injuries.		Investigation found a broken section of kerb channel that was unnoticed under the leaves.	Potential fall injury to public	Broken channel section repaired. Pathway blown down to clear leaves. More signage put up at the two entrances of narrow path during construction.
Hui 92	Maungawhau	Tourist bus has damaged their vehicle on the exit bollard and spilt oil on the road.		Investigation determined vehicle did not follow the proper process, they failed to wait for bollard to retract fully before driving through. The oil then spilt onto the road and created a slip hazard.	Potential fall injury to public	Spill cordoned off. Emergency spill kit applied to area, followed by another clean. Structural check on Bollards.
Hui 92	Maungauika	Contractors notified management of police cordon on Maungauika early morning as a deceased person had been discovered on the Maunga.		n/a	n/a	Emergency services already on site, had cordoned off area and diverted public.  Management notified TTT and TMA Chair while the investigation continued by Police.  Karakia conducted later that day when Police concluded their investigation.

Hui reported to	Maunga	Summary of incident	Number of any near misses	Outcome of investigations into any incidents and near misses	Health and Safety management matters arising	Actions Taken
						Monitoring of contractors and kaimahi well-being to continue over the week.  Management to continue to reach out to Police to be notified of outcome of investigation.
Hui 90	Maungarei	Small grass fire reported to TMA from FENZ at approx. 10:10pm. FENZ responded quickly to the fire that was located close to the ring road and it was extinguished by 10:30pm.		TMA management notified via FENZ. No further action was needed due to attendance from FENZ.	Potential harm to people Potential harm to Maunga Potential harm to structures	FENZ attended fire and extinguished it quickly. Police report filed.  TMA staff are working with FENZ to review firebreaks and planting areas to further mitigate the risk from fire
Hui 90	Maungakiekie	TMA contractors witnessed a member of the public who was walking through the maunga with a .22 rifle. The police were called and subsequently arrested the member of the public. TMA contractor positively ID'd the arrested person for the Police.		TMA management notified a couple of days after the incident had occurred. TMA has spoken with contractor about H&S of it's employees on the Maunga.	Potential harm to people	Police called with an arrest made.
Hui 90	Ōtāhuhu	A contained campfire was reported to FENZ. The fire was utilised by rough sleepers for cooling.		TMA management notified, no further action needed from TMA staff as FENZ were already attending.	Potential harm to people Potential harm to Maunga Potential harm to structures	NZ Fire Service attended the fire and cordoned the area. Police report filed. TMA provided information to an Auckland Council community services team to provide any ongoing support for the rough sleeper
Hui 90	Te Tātua a Riukiuta	Two motorbikes have been reported speeding through the Maunga by our contractors.	1	Unable to identify any of the bikes.	Potential harm to people Potential harm to Maunga	Reported to Police the behaviour. Increase presence of summer field officers on Te Tātua.
Hui 90	Maungauika	Small fire occurred near the Southern battery approximately 7:00pm. FENZ report indicates that witnesses saw people with fireworks had started the fire.		TMA management notified, no further action needed from TMA staff as FENZ were already attending.	Potential harm to people Potential harm to Maunga Potential harm to structures	NZ Fire Service attended the fire and cordoned the area. Police report filed.  TMA staff are working with FENZ to review firebreaks and planting areas to further mitigate the risk from fire
Hui 90	Puketāpapa	Firearms incident on New Year's morning. Offenders had moved rocks to drive around closed auto gate and FENZ had to call duty officer to unlock gate.		Automatic gate was not yet in operation, but had been programmed to close on New Years Eve to reduce anti-social behaviour. Was not yet programmed with codes though which is why FENZ could not open.	Potential harm to people	Automatic gate online and codes programmed in now. Rocks fixed into ground.
Hui 90	Maungauika	TMA summer rangers encountered abuse from public member while asking to comply with bylaws		Conflict and de-escalation training reemphasised	Staff safety and wellbeing	Team checked on. Reemphasis of removing yourself from situation if it can't be deescalated.
Hui 90	Maungakiekie	Small fire occurred in the Western Crater approximately 9:00pm. FENZ report indicates that witnesses saw people with fireworks had started the fire.		TMA management notified, no further action needed from TMA staff as FENZ were already attending.	Potential harm to people Potential harm to Maunga Potential harm to structures	NZ Fire Service attended the fire and contained it to a small area. Police report filed.  TMA staff are working with FENZ to review firebreaks and planting areas to further mitigate the risk from fire

Hui reported to	Maunga	Summary of incident	Number of any near misses	Outcome of investigations into any incidents and near misses	Health and Safety management matters arising	Actions Taken
Hui 90	Mangere	Fire reportedly started by 3 individuals around 4:30pm on Māngere. FENZ report indicates that witnesses saw people intentionally started the fire.		TMA management notified, no further action needed from TMA staff as FENZ were already attending. Manager went onsite to liaise with FENZ.	Potential harm to people Potential harm to Maunga Potential harm to structures	NZ Fire Service attended the fire and cordoned the area. Police report filed. Two arrests were made.





Events Register

Hui reported to	Maunga	Applicant	Event Description	Event Date	Status	Revenue
Hui 94	Maungauika	Dion Jelley / North Shore Marathon	Commercial	15 <sup>th</sup> of September 2024	Approved	\$900
Hui 94	Maungarei	Steff Holcroft / Northern Tour Schools Cycling	Community	7 <sup>th</sup> of September 2024	Approved	\$0
Hui 94	Maungawhau	Rachel Setters / Ficino School Cross Country Run	Community	16 <sup>th</sup> of August 2024	Approved	\$0
Hui 94	Te Tātua a Riukiuta	TMA / Organisational Planting Day (Nga Mataarae, TWT, Māori Outcomes)	TMA	15 <sup>th</sup> of August 2024	Approved	\$0
Hui 94	Ōtāhuhu	TMA / School Planting Day	TMA	13 <sup>th</sup> of August 2024	Approved	\$0
Hui 93	Te Pane o Mataoho	Rosie Spearing / Young Guns Skate School Event	Community	11 <sup>th</sup> of July 2024	Approved	\$0
Hui 93	Maungawhau	Geoff Holmes / City Centre Prospectus / Drone Shoot	Private	5 <sup>th</sup> of July 2024	Approved	\$0
Hui 93	Ōwairaka	Sheryl Fletcher / Ōwairaka School Sunrise Hīkoi	Community	4 <sup>th</sup> of July 2024	Approved	\$0
Hui 93	Maungawhau	Maungawhau Mission (Fundraiser run)	Community	2 <sup>nd</sup> of July 2024	Approved	\$0
Hui 93	Puketāpapa	Callum McGibbon / Karakia (Matariki)	Community	26 <sup>th</sup> June 2024	Approved	\$0
Hui 93	Maungawhau	Adriana Palmer / Southern Cross Health Care Cleanup	Community	23 <sup>rd</sup> June 2024	Approved	\$0
Hui 93	Te Tātua a Riukiuta	AKLC Planting Day	Community	19 <sup>th</sup> June 2024	Approved	\$0
Hui 93	Puketāpapa	John Sutton / Manu Aute Kite Day	Community	16 <sup>th</sup> June 2024	Approved	\$0
Hui 93	Ōhūiarangi	Community Planting Day (Matariki)	Community	16 <sup>th</sup> June 2024	Approved	\$0
Hui 93	Puketāpapa	Kristen Walsham / Kāhui Ako Matariki Music Video	Community	13 <sup>th</sup> June 2024	Approved	\$0

Hui reported to	Maunga	Applicant	Event Description	Event Date	Status	Revenue
Hui 93	Takarunga	Craig Tikao / Tātaki Unlimited Global Audience Stills Shoot	Community	6 <sup>th</sup> June 2024	Approved	\$0
Hui 93	Ōhinerau	Community Planting Day	Community	1 <sup>st</sup> June 2024	Approved	\$0
Hui 93	Ōhūiarangi	AKLC / Landcare & MPI Planting Day	Community	30 <sup>th</sup> May 2024	Approved	\$0
Hui 93	Ōhinerau	St. Cuthbert's School Planting Day	Community	25 <sup>th</sup> May 2024	Approved	\$0
Hui 93	Ōtāhuhu	Community Planting Day	Community	19 <sup>th</sup> May 2024	Approved	\$0
Hui 92	Maungawhau	Briar Pacey/Tātaki Unlimited Destination Tourism	Private	15 <sup>th</sup> May 2024	Approved	\$0
Hui 92	Maungawhau	Deborah Gray/Balmoral School	Community	9 <sup>th</sup> May 2024	Approved	\$0
Hui 92	Maungawhau	Richard Taylor/Wayne Taylor Band	Community	7 <sup>th</sup> April 2024	Approved	\$0
Hui 92	Maungawhau	Ali Bowey/Green By Nature	Private	4 <sup>th</sup> April 2024	Approved	\$0
Hui 92	Maungawhau	Ashley Pihema/Mā Whero Education	Private	4 <sup>th</sup> April 2024	Approved	\$0
Hui 92	Maungawhau	Kara Beckford	Private	4 <sup>th</sup> April 2024	Approved	\$450
Hui 92	Maungawhau	James McGoram/Rare Disorders NZ	Community	30 <sup>th</sup> March 2024	Approved	\$0
Hui 92	Takarunga	Andie Levell/Combined Churches of Devonport	Community	29 <sup>th</sup> March 2024	Approved	\$0
Hui 92	Te Pane o Mataoho	Teresa Ah Wa/Māngere Catholic	Community	29 <sup>th</sup> March 2024	Approved	\$0
Hui 92	Maungawhau	Dillon Blair/Conservation Volunteers NZ	Private	21 <sup>st</sup> March 2024	Approved	\$0
Hui 90	Maungawhau	Rebecca Woodward/Te Kura School Hikoi	Community	20 <sup>th</sup> March 2024	Approved	\$0

Hui reported to	Maunga	Applicant	Event Description	Event Date	Status	Revenue
Hui 90	Maungawhau	Trish Wilson/Auckland City Brass Concert	Community	16 <sup>th</sup> March 2024	Approved	\$190
Hui 90	Maungarei	Richard Johnston/Panmure Bridge School Hikoī	Community	12 <sup>th</sup> March 2024	Approved	\$0
Hui 90	Maungauika	Caroline Aspden/AUT Field Sampling	Private	9 <sup>th</sup> March 2024	Approved	\$280
Hui 90	Maungakiekie	Tia Barrett	Private	8 <sup>th</sup> January 2024	Approved	\$0
Hui 90	Maungawhau	Maxim Sherstobitov	Private	4 <sup>th</sup> December 2023	Approved	\$450 (ex GST)
Hui 90	Maungauika	Jeff Karaka	Community	25 <sup>th</sup> November 2023	Approved	\$0
Hui 88	Maungawhau	Majic Paora/Filming	Private	12 <sup>th</sup> November 2023	Approved	\$0
Hui 88	Ōwairaka	Sue Harrap/Lena Harrap's Remembrance Vigil	Private	8 <sup>th</sup> November 2023	Approved	\$0
Hui 88	Maungauika	Jason Roberts/Wedding	Private	3 <sup>rd</sup> November 2023	Approved	\$600
Hui 88	Maungakiekie	Greenstone TV/My Life Is Murder	Commercial	2 <sup>nd</sup> November 2023	Approved	\$1200
Hui 88	Maungakiekie	Daisuke Hirata/Japanese Photoshoot	Commercial	9 <sup>th</sup> October 2023	Approved	\$0
Hui 88	Maungauika	Amber Reaves/Devonport Half Marathon	Commercial/Private	1 <sup>st</sup> October 2023	Approved	\$1200



---

## Quarter 1 Report

Authors: David Bhana, Tūpuna Maunga Manager  
Munen Prakash, Lead Financial Advisor

---

<b>Purpose</b>	To consider the Quarterly Report for the first quarter of the 2024/25 financial year.
<b>Recommendation</b>	That the Tūpuna Maunga o Tāmaki Makaurau Authority:  a) <b>note</b> the attached first Quarter Report for the 2024/25 financial year.

## Latest Quarterly Report

1. Attached is the Tūpuna Maunga Authority Quarterly Report for the first quarter of the 2024/25 financial year.

## Attachments

Attachment A: Quarter 1 Report. [↓](#)





## QUARTER 1 REPORT

As at 30 September 2024

## CONTENTS

### 1. Key highlights

### 2. Tūpuna Maunga – key objectives and Maunga-specific work programme

### 3. Financials

#### 3.1 Operating revenue and costs

#### 3.2 Capital projects



## 1. Key highlights in this quarter:

### Planting season

The team continued the planting program within this quarter over ngā Tūpuna Maunga. Of these Te Tātua a Riukiuta and Ōtāhuhu held volunteer planting days. These were attended by 220 volunteers. Approximately 27,000 more plants were planted across the network during this period.

### Kī o Rahi Senior Regionals tournament held on Ōtāhuhu

The team partnered with College Sport Auckland and Kī o Rahi Tāmaki Makaurau to hold the senior regional tournament. A total of 22 teams participated and 300 rangatahi attended the day.

## 2. Tūpuna Maunga key activities and Maunga-specific work programmes

This section of the Performance Report lists each of the Tūpuna Maunga and the key activities undertaken Quarter 1.

Matukutūruru / Wiri	Pest management undertaken.
Maungakiekie / One Tree Hill	Pest management undertaken. Olive Grove and western crater carpark project completed.
Maungarei / Mt Wellington	Pest management undertaken.
Maungauika/North Head	Pest management undertaken.
Maungawhau / Mt Eden	Pest management undertaken. Scheduled tree maintenance undertaken. Renewal Maungawhau Kiosk deck.
Ōhinerau / Mt Hobson	Pest management undertaken.
Ōhūiarangi/Pigeon Mountain	Pest management undertaken.
Ōtāhuhu / Mt Richmond	Ki-o-Rahi Tāmaki Regional tournament held. Pest management undertaken. Kura planting day.
Ōwairaka / Te Ahi-Kā-Rakataura /Mt Albert	Pest management undertaken.

Pukewīwī / Puketāpapa / Mt Roskill	Pest management undertaken.
Takarunga / Mt Victoria	Pest management undertaken.
Te Kōpuke / Tītīkōpuke / Mt St John	Pest management undertaken.
Te Pane-o-Mataaho/ Te Ara Pueru / Māngere Mountain	Pest management undertaken. Kai Regional Network field trip held.
Te Tātua-a-Riukiuta / Big King	Pest management undertaken. Community planting day.

### 3.0 FINANCIALS

#### 3.1 Operating revenue and costs

##### TŪPUNA MAUNGA O TĀMAKI MAKAURAU AUTHORITY

Operating Revenue and Expenditure for Quarter 1 as at 30 September 2024

	Actual Qtr 1 \$'000	Budget Qtr 1 \$'000	Variance Qtr 1 \$'000	Actual YTD \$'000	Budget YTD \$'000	Variance YTD \$'000
Operating Revenue	-86	-107	-21	-86	-107	-21
Operating Expenditure	1,038	1,289	252	1,038	1,289	252
Governance Costs	24	53	28	24	53	28
<b>Net Operating Result</b>	<b>976</b>	<b>1,235</b>	<b>259</b>	<b>976</b>	<b>1,235</b>	<b>259</b>

##### TŪPUNA MAUNGA O TĀMAKI MAKAURAU AUTHORITY

Operating Revenue and Expenditure for Quarter 1 as at 30 September 2024

	Actual Qtr 1 \$'000	Budget Qtr 1 \$'001	Variance Qtr 1 \$'000	Actual YTD \$'000	Budget YTD \$'000	Variance YTD \$'000
Fees and user charges revenue	-14	-14	-1	-14	-14	-1
Property rental revenue	-73	-93	-20	-73	-93	-20
<b>Operating Revenue</b>	<b>-86</b>	<b>-107</b>	<b>-21</b>	<b>-86</b>	<b>-107</b>	<b>-21</b>
Repairs and maintenance & Outsourced works	551	704	153	551	704	153
Professional services	63	46	-18	63	46	-18
Other expenditure on activities	423	540	117	423	540	117
<b>Operating Expenditure</b>	<b>1,038</b>	<b>1,289</b>	<b>252</b>	<b>1,038</b>	<b>1,289</b>	<b>252</b>
<b>Governance Costs</b>	<b>24</b>	<b>53</b>	<b>28</b>	<b>24</b>	<b>53</b>	<b>28</b>
<b>Net Operating Result</b>	<b>976</b>	<b>1,235</b>	<b>259</b>	<b>976</b>	<b>1,235</b>	<b>259</b>

#### Financial Commentary:

**Operating Revenue** for quarter one ended 30 September 2024 was slightly unfavourable due to timing of hall hire revenue.

**Operating Expenditure** for quarter one ended 30 September 2024 was lower than budget due response maintenance and also staff costs are under due to some vacant roles still being recruited.

### 3.2 Capital projects

#### TŪPUNA MAUNGA O TĀMAKI MAKAURAU AUTHORITY

Capital Expenditure for Quarter 1 as at 30 September 2024

	Actual YTD \$'000	Budget YTD \$'000	Variance YTD \$'000	FY Budget (incl c/fwd) \$'000
<b>Total Capital Projects</b>	2,063	2,946	883	11,784

**Financial Commentary:**

**Capital Expenditure** for the quarter one ended 30 September 2024 lower mainly due to timing of work programmes and is expected to come within capex budget for FY25.

## Takarunga courts & bus parking development

Author: David Bhana, Tūpuna Maunga Manger

<b>Purpose</b>	To consider concepts for visitor improvements to the courts and bus parking at Takarunga – Mt Victoria.
<b>Recommendation</b>	That the Tūpuna Maunga o Tāmaki Makaurau Authority: a) <b>approve</b> proceeding with the proposed court upgrade and bus parking improvements as set out in the report and plans attached.

### Background

1. The scope of the project consists of the upgrade of the existing tennis courts to improve the recreation value, and provision of a dedicated bus parking and drop-off area.
2. The Authority previously considered the courts upgrade project at Hui 63 (19 April 2021), and Hui 65 (26 July 2021) at Hui 89 (12 February 2024). The bus parking was first considered at Hui 66 (23 August 2021). The project was most recently considered at Hui 94 (16 September 2021)
3. The key drivers for this piece of work are:
  - a. A need for wharepaku to cater for visitors.
  - b. The deterioration of the court surface, fences and furniture
  - c. Direction from the Integrated Management Plan.
  - d. Improved active and passive recreation provision.

### Statutory and other considerations

4. Any decision to determine management within a reserve must take into account the legislative and policy framework.
5. Section 109(2) of Ngā Mana Whenua o Tāmaki Makaurau Collective Redress Act 2014 requires the Authority to have regard to the spiritual, ancestral, cultural, customary, and historical significance of the Maunga to Ngā Mana Whenua o Tāmaki Makaurau and that the Tūpuna Maunga is held in trust for Ngā Mana Whenua and the other people of Auckland.
6. The Tūpuna Maunga Authority's Integrated Management Plan was adopted by the Authority pursuant to the Ngā Mana Whenua o Tāmaki Makaurau Collective Redress Act 2014 and Reserves Act 1977. The Integrated Management Plan describes a series of "Values" and "Pathways" that guide all activities on the Tūpuna Maunga.
7. The Tūpuna Maunga Authority adopted the Tūpuna Maunga Strategies at Hui 50 on 25 September 2020. The Tūpuna Maunga Strategies are 7 key sections that outline the strategic direction with regards to education, Biodiversity, Tūpuna Maunga design, Recreation, commercial activities and monitoring. Together with the IMP, these strategies inform guide and manage the activities undertaken on the Maunga.
8. The Authority administers the Tūpuna Maunga under the Reserves Act 1977 and pursuant to Ngā Mana Whenua o Tāmaki Makaurau Collective Redress Act 2014. The Hauraki Gulf Marine Park Act 2000 is also applicable in relation to Maungauika.

## Discussion

### Design summary

9. The developed designs for the courts and bus drop-off area are presented in Attachment A. The concepts include representations of the artworks developed by Arapeta Hakura.

### Courts area

10. The recreation value of the courts is increased by incorporating passive as well as active recreation elements. This includes a multi-purpose court, a rear activation/games wall, accessible park furniture, an accessible toilet, and two entry points. The sporting code combination for the court was decided due to the community ties to tennis, and basketball due to the courts' historic use and the current popularity among young people of the sport.
11. The plan shows informal natural play such as rock/log/rope/balancing elements located in the raised garden bed to create a mini nature trail. In addition to this there is a dedicated informal play zone located within the court area. This consists of colourful mulched rubber (recycled) mounds designed in a 'v' formation which represents both migratory birds and waka navigation. Spheres of varying sizes will provide jumping/seating play value. The rubber safety surfacing is required to meet compliance in absorbing shock.
12. The court surface has been designed as concrete for practicality reasons. Surface water drainage will utilise the gardens where possible to ensure filtration of stormwater runoff.
13. Management are continuing to investigate options to place a single accessible carpark nearby.

### Bus drop-off

14. The design presents a bus drop-off area in an extension to the 3 existing carparks located north-west of the Devonport Primary School. The road will need to be widened to the existing bollards to ensure manoeuvrability of buses. Boxed steps will facilitate safe pedestrian access to the tihi road. This option was selected due to it being the least imposing in terms of built form, low archaeological and environmental impact, and modest whole-of-life costs. Decorative paving panels in the road will emphasise the shared nature of the space with an emphasis on pedestrian priority.

### Mahi toi

15. The narratives represented in patterning on the court surface and rear games wall, bus parking zone, furniture, whariki (welcome mats), and pou pay homage to the importance of Takarunga, connecting it to the broader narratives of migration, exploration, and the intertwined destinies of people who followed their paths to Aotearoa.
16. Referencing the legacies of the Tainui waka, a sculptural piece inspired by waka maumahara is included in the elevated position approaching the main road to the tihi.
17. The concept is supported by native planting appropriate to the Maunga in extended areas on the court boundaries and includes species that were once prevalent across the Maunga such as Puriri, Taraire and Kohekohe.
18. Archaeologists and heritage experts have been involved in the development of the courts plans and the drop-off zone plans and will continue to be involved as the designs are further developed.

## Next steps

19. Management will progress the designs with a view to the procurement of physical works.

## Attachments

Attachment A: [Attachment A Takarunga courts and bus parking](#)









# TAKARUNGA MT VICTORIA

Tennis Court & Bus Parking . October 2024

Final concept plan - for approval



# 1. Waka Maumahara Design Development

One waka maumahara inspired sculpture is proposed. The proposed location is shown on the following sheet, on the right hand side of the road approaching the bus parking area. This location is open, elevated and has good sight lines.

The sculpture explores the legacies of Tainui Waka. Its forms are based on the breaking of waves on a waka during travel. These waves have been transformed into 3D loops, joined to create monuments that re-imagine what a waka can be.

Possible material options include perspex or steel.

*'Pushing how we think about waka in contemporary art opens up conversations around structure, form, interpretation, meaning, and feeling. These sculptures aim to evoke a sense of travel, time, water, people, and movement. The form itself reflects elements of a waka, like the taura (rope) and other essential parts. By using a contemporary lens, the work not only reinterprets the waka but also connects deeply to the histories and stories tied to it, while bringing those elements into the present.'*

*Extract from Arapeta Hākura's Waka Maumahara, Takarunga Research and Drawings, Option 2 document*

## Sculpture design progression

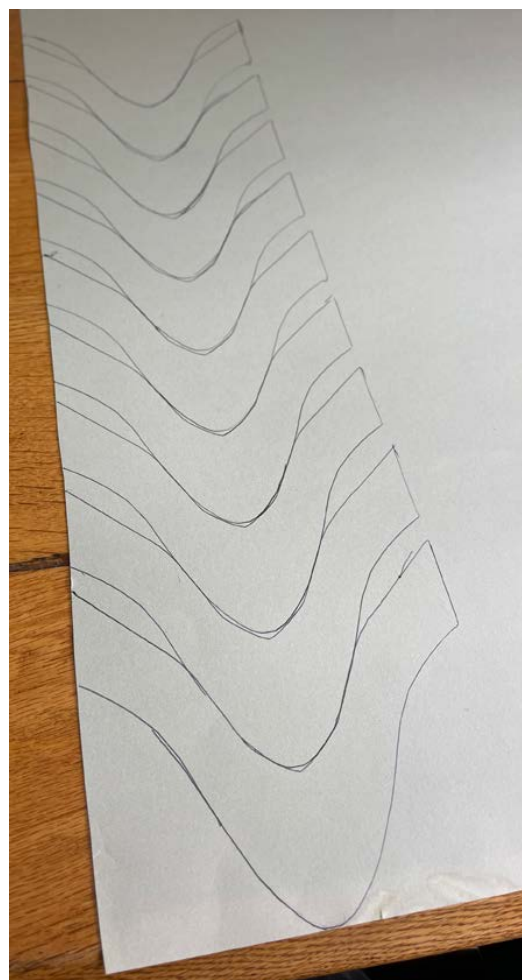

Pattern depicting waves breaking at the bow of waka, this pattern has been developed into 3D form in this investigation



Waiahua o Tainui, single pattern of breaking waves, multiplied by 6 and attached to create Waka Maumahara



Waiahua o Tainui, double pattern of breaking waves inverted, multiplied by three and attached to create circular form



Waiahua o Tainui, single pattern of breaking waves, multiplied by 4 and inverted to create a single structure. This structure is multiplied by 2 and mirrored



WORK IN PROGRESS

## 2. Updated Bus Parking General Arrangement Plan



Location Plan

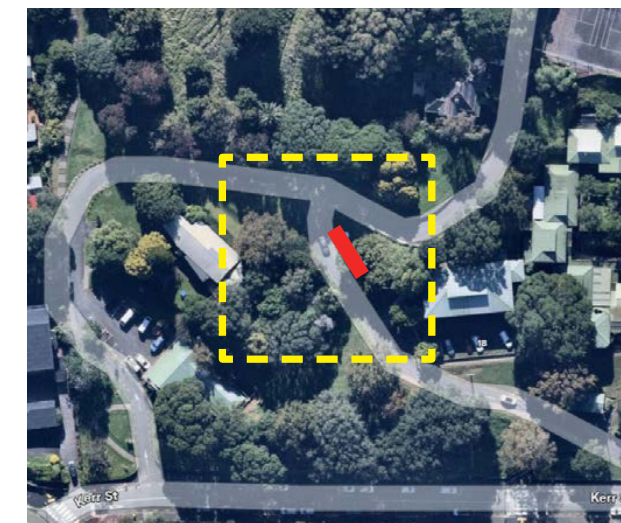

- Provides a direct and safe route for passengers disembarking from the bus stop to the tihi
- Minimal impact on existing mature trees
- Realignment to road are required to accommodate bus tracking
- Paved insets designed in collaboration with Arapeta Hākura provide visual cues to drivers that they are entering a shared space

LEGEND

1. Paved inset strips
2. Basalt rumble strip defines road edge
3. Bus parking area
4. Barrier arm restricts vehicle access to maunga
5. Organic Lock steps
6. Organic Lock path and bus disembarking area
7. Native planting on slopes
8. 2.4m long seat
9. Proposed waka maumahara sculpture location
10. Existing fenceline

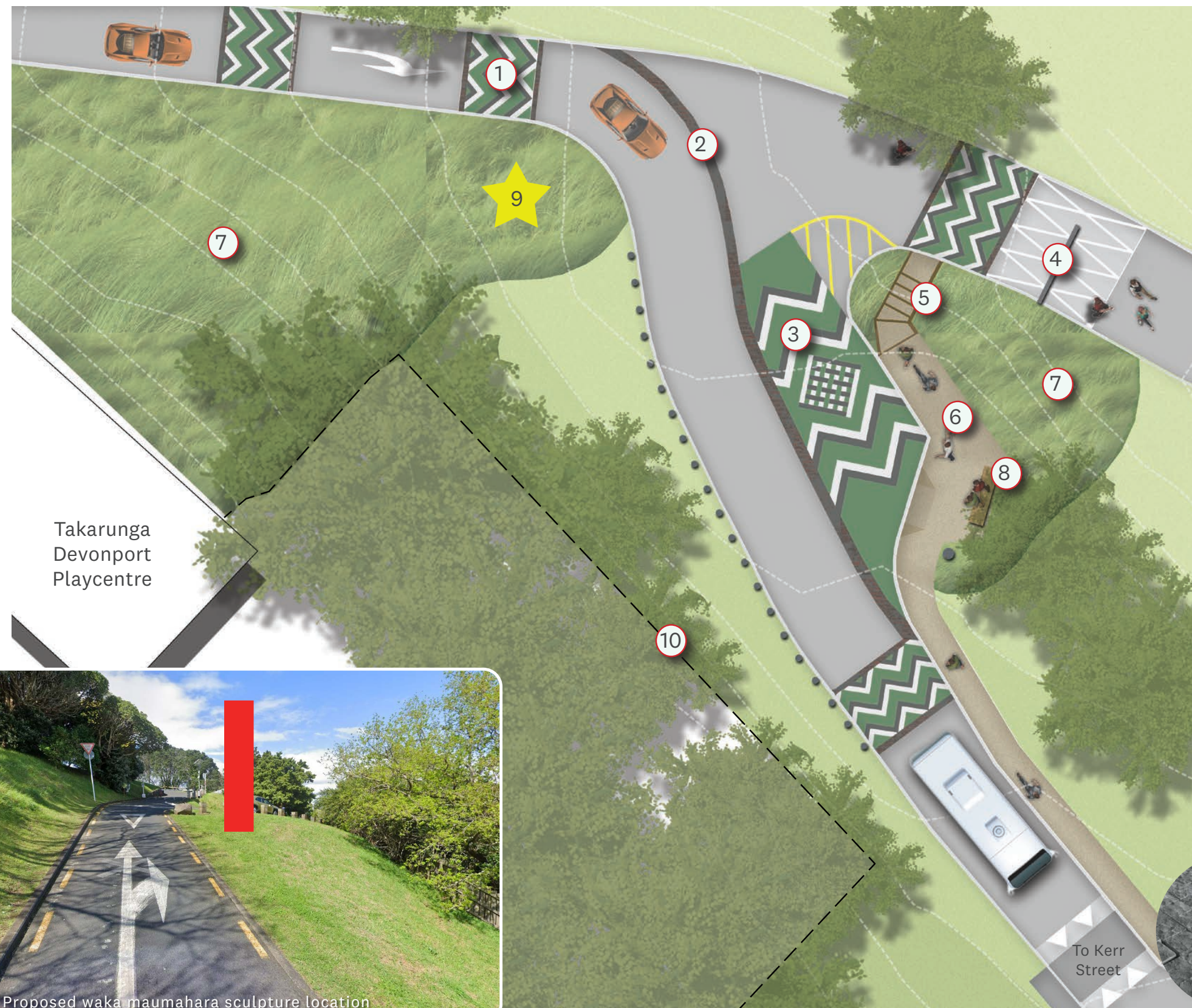

Takarunga Devonport Playcentre

To Kerr Street



Proposed waka maumahara sculpture location

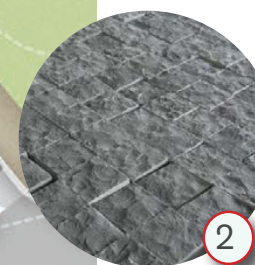

1



2



7



WORK IN PROGRESS

### 3. Updated Court General Arrangement Plan





## 4. Indicative 3D Renders





WORK IN PROGRESS

## 5. Indicative 3D Renders





## Takarunga Playcentre Lease

Author: Lucia Kohler, Kaihautu Hotaka

<b>Purpose</b>	To consider a lease for the Takarunga Playcentre on Takarunga/Mount Victoria.
<b>Recommendations</b>	<p>That the Tūpuna Maunga o Tāmaki Makaurau Authority:</p> <p>a) <b>delegate</b> to the Chair and Deputy Chair the power to execute a lease, including a Maunga Outcomes Plan, with the Takarunga Playcentre for the term of Five (5) years at a market rental (as determined by a registered valuer) and otherwise on the standard terms and conditions; and</p> <p>b) <b>delegate</b> to the Chair and Deputy Chair the power to agree to terms governing the termination arrangements of the Takarunga Playcentre should the Playcentre decide not to accept the new lease.</p>

### Background

1. The Takarunga Playcentre (the Playcentre) lease was inherited by the Tūpuna Maunga Authority. This lease was originally with the North Shore City Council (predecessor to Auckland Council) and was drafted in accordance with that council's policy at the time.
2. At Hui 79 (12 September 2022) the Tupuna Maunga Authority resolved to grant a new lease to the Takarunga Playcentre for initial term of 1 year ending 31 August 2024.
3. The Playcentre occupies an area of Takarunga/Mount Victoria which is classified as a Local Purpose Reserve. The location of the lease area is shown in Attachment A.
4. The Playcentre owns and maintains the building that they currently occupy.

### Statutory and other considerations

5. Any decision to determine management within a reserve must take into account the legislative and policy framework.
6. The Authority administers the Tūpuna Maunga under the Reserves Act 1977 and pursuant to Ngā Mana Whenua o Tāmaki Makaurau Collective Redress Act 2014. The Hauraki Gulf Marine Park Act 2000 is also relevant.
7. Section 109(2) of Ngā Mana Whenua o Tāmaki Makaurau Collective Redress Act 2014 requires the Authority to have regard to the spiritual, ancestral, cultural, customary, and historical significance of the maunga to Ngā Mana Whenua o Tāmaki Makaurau and that the tūpuna maunga is held in trust for Ngā Mana Whenua and the other people of Auckland.
8. The Tūpuna Maunga Authority's Integrated Management Plan (IMP) was adopted by the Authority in terms of Ngā Mana Whenua o Tāmaki Makaurau Collective Redress Act 2014 and the Reserves Act 1977. The Integrated Management Plan describes a series of "Values" and "Pathways" that guide all activities on the Tūpuna Maunga. The primary focus of the IMP is to protect the health and well-being of the Tūpuna Maunga.

9. The Tūpuna Maunga Authority adopted the Tūpuna Maunga Strategies at Hui 50 on 25 September 2020. The Tūpuna Maunga Strategies are 7 key sections that outline the strategic direction with regards to education, Biodiversity, Tūpuna Maunga design, Recreation, commercial activities and monitoring. Together with the IMP, these strategies inform guide and manage the activities undertaken on the Maunga.
10. The Authority administers the Tūpuna Maunga under the Reserves Act 1977 and pursuant to Ngā Mana Whenua o Tāmaki Makaurau Collective Redress Act 2014. The Hauraki Gulf Marine Park Act 2000 is also applicable in relation to Maungauika.
11. The activities of the Playcentre are otherwise consistent with the reserve classification. There have been no other parties who have expressed an interest in occupying the site

## Discussion

### Leases on Tūpuna Maunga

12. The Tūpuna Maunga o Tāmaki Makaurau Integrated Management Plan (IMP) describes a series of values and pathways that dictate decision-making on leases. The IMP places the health and well-being of the Tūpuna Maunga at the heart of all decisions.
13. Any leasing activity must be consistent with the IMP Tūpuna Maunga values and should actively promote those values.

### Playcentre

14. Playcentre is an early childhood education and parenting organisation which operates parent-led early childhood education centres throughout New Zealand. Each Playcentre is cooperatively managed by parents and supported by Te Whānau Tupu Ngātahi o Aotearoa - Playcentre Aotearoa. Its philosophy is that parents are the first educators of children and it encourages the involvement of whānau in early childhood education.
15. The statistics for this centre fluctuate seasonally. The centre currently has 30 Tamariki enrolled with most going to 2 or more sessions per week. Session days and times are Monday, Wednesday and Friday 9am – 12.30. There are 35 registered caregivers and range from mothers, fathers and grandparents. Two whānau that identify as Māori lead kawa and tikanga for the centre.
16. Maunga Outcomes plan:
  - Regular hikoi with Tamariki to the tihi
  - Demonstrated Mātauranga Māori – tikanga, kai karakia, karakia during renewal works, learning Māori waiata and displaying kupu on walls. They have listened to feedback from local rangatira and adjusted the tikanga accordingly.
  - Mātariki celebration for over 8 years
  - Regular Pest control and external compliance checks
  - Changed centre name from Northshore Playcentre.

## Terms

### Term

17. Management has a good working relationship with the tenant. Takarunga Playcentre has completed their Maunga Outcomes plan demonstrated their contribution to the wellbeing of the Maunga and the values set out in the IMP.



18. Given the above context management recommend a term of 5 years.

Rental

19. Rental assessment has been done by the registered valuer in 2022 at \$6,060 per annum. Management will seek advice from a registered valuer to assess the market rental at the beginning of the lease and at periodic terms during the lease.

**Next Steps**

20. If a lease is to be offered, Management will work alongside the Playcentre to draft a Tūpuna Maunga Lease for consideration and execution by the Chair and Deputy Chair.

**Attachments**

Attachment A: Site Plan for the Takarunga Playcentre on Takarunga/Mount Victoria [↓](#)



Site Plan for the Takarunga Playcentre on Takarunga/Mount Victoria





## Onehunga Māngere United Sports Club Incorporated Lease

Author: Lucia Kohler, Kaihautu Hotaka

<b>Purpose</b>	To consider a potential lease to the Onehunga Māngere United Sports Club Incorporated on Te Pane o Mataoho / Te Ara Pueru / Māngere Mountain.
<b>Recommendations</b>	<p>That the Tūpuna Maunga o Tāmaki Makaurau Authority:</p> <ul style="list-style-type: none"> <li>a) <b>grant</b>, subject to completion of statutory processes, including public notification under s119 of the Reserves Act 1977, a lease to Onehunga Māngere United Sports Club Incorporated (Attachment A) subject to the following terms and conditions: <ul style="list-style-type: none"> <li>i) term – Five (5) years, commencing 1 November 2024</li> <li>ii) rent – \$3,400 plus GST per annum, rent is to be reviewed at periodic terms</li> <li>iii) Maunga Outcomes plan be prepared and attached as a schedule to the lease agreement</li> <li>iv) all other terms and conditions in accordance with Ngā Mana Whenua o Tāmaki Makaurau Collective Redress Act 2014 and the Reserves Act 1977 and the Tūpuna Maunga Authority standard form lease agreement.</li> </ul> </li> <li>b) If required, <b>delegate</b> to the chairperson and deputy chairperson the power to appoint a hearings panel pursuant s 120 of the Reserves Act 1977 to consider and hear any submissions received and make a decision on the lease.</li> <li>c) <b>delegate</b> to the Chair and Deputy Chair the power to execute a lease, including a Maunga Outcomes Plan, with lessee on the terms and conditions set out in resolution (a).</li> <li>d) <b>delegate</b> to the Chair and Deputy Chair the power to agree to terms governing the termination arrangements of lessee should they decide not to accept the new lease.</li> </ul>

### Background

1. The previous Onehunga Mangere United Sports Club (the Club) lease was inherited by the Tūpuna Maunga Authority. This lease was originally with the Manukau City Council (predecessor to Auckland Council) and was drafted in accordance with that council's policy at the time.
2. At Hui 66 (23 August 2021) the Tupuna Maunga Authority resolved to grant a lease to the Onehunga Māngere United Sports Club for the initial term of 1 year plus 1 year renewal with the final expiry ending 31 August 2023.
3. The Club occupies an area of Te Pane o Mataoho / Te Ara Pueru / Māngere Mountain which is classified as a Recreation Reserve. The proposed lease area is shown in red of the Attachment A.
4. The lease area covers the building on the site, excluding the ground floor amenity block as shown within the dotted line in Figure 2. The Club owns the portion of the building that they occupy.

---

## Statutory and other considerations

5. This paper updates the Authority on an area of Te Pane o Mataoho / Te Ara Pueru / Māngere Mountain under lease to the Onehunga Mangere United Sports Club. The location of the current leased area is shown below in Schedule A.
6. Any decision to determine management within a reserve must take into account the legislative and policy framework.
7. The Authority administers the Tūpuna Maunga under the Reserves Act 1977 and pursuant to Ngā Mana Whenua o Tāmaki Makaurau Collective Redress Act 2014. The Hauraki Gulf Marine Park Act 2000 is also relevant. The activities of the Club are consistent with the reserve classification.
8. Section 109(2) of Ngā Mana Whenua o Tāmaki Makaurau Collective Redress Act 2014 requires the Authority to have regard to the spiritual, ancestral, cultural, customary, and historical significance of the Maunga to Ngā Mana Whenua o Tāmaki Makaurau and that the Tūpuna Maunga is held in trust for Ngā Mana Whenua and the other people of Auckland.
9. The Tūpuna Maunga Authority's Integrated Management Plan (IMP) was adopted by the Authority in terms of Ngā Mana Whenua o Tāmaki Makaurau Collective Redress Act 2014 and the Reserves Act 1977. The Integrated Management Plan describes a series of "Values" and "Pathways" that guide all activities on the Tūpuna Maunga. The primary focus of the IMP is to protect the health and well-being of the Tūpuna Maunga.
10. The Tūpuna Maunga Authority adopted the Tūpuna Maunga Strategies at Hui 50 on 25 September 2020. The Tūpuna Maunga Strategies are 7 key sections that outline the strategic direction with regards to education, Biodiversity, Tūpuna Maunga design, Recreation, commercial activities and monitoring. Together with the IMP, these strategies inform guide and manage the activities undertaken on the Maunga.
11. The Authority administers the Tūpuna Maunga under the Reserves Act 1977 and pursuant to Ngā Mana Whenua o Tāmaki Makaurau Collective Redress Act 2014. The Hauraki Gulf Marine Park Act 2000 is also applicable in relation to Maungauika.
12. Section 54 of the Reserves Act 1977 sets out the Authority's powers in relation to leasing on a recreation reserve. This clause specifies that the intention to grant a lease must be publicly notified.

## Discussion

### Leases on Tūpuna Maunga

13. The Tūpuna Maunga o Tāmaki Makaurau Integrated Management Plan (IMP) describes a series of values and pathways that dictate decision-making on leases. The IMP places the health and well-being of the Tūpuna Maunga at the heart of all decisions.
14. Any leasing activity must be consistent with the IMP Tūpuna Maunga values and should actively promote those values. One step is a Maunga Outcomes Plan which forms part of all leases on Tūpuna Maunga.

## Sports Club

15. Originally, Club had union of Football and Softball. Softball has recently decided to reallocate to a new location. Football division has 488 members this season. Member age groups are 58% Tamariki less than 12 years, 12% Tamariki 13 to 16 years and 30% Pakeke/Adults. Over 10% of members are Māori. Softball division had 116 members. Club is currently undergoing the winding up process and working with local kura on increasing membership for the football division.

### 16. Maunga Outcomes Plan

- Recognise relationship of kura and working with local schools and our members encouraging diversity.
- Monitor members of the public who might intend on harming the Maunga continuing our custodianship.
- Club has implemented rodent and pest control program for several years now.
- They ensure area is rubbish free.
- Promote smoke free on Maunga and alcohol free on Maunga.
- They are committed to promote Maunga at event introductions.

17. Management has recently granted permission to for the club to hire out club rooms for community events, fundraising events and training seminars/workshops. Subletting is not permitted.

## Key Terms

### Term

18. Onehunga Māngere United Sports Club has completed their Maunga Outcomes plan demonstrated their contribution to the wellbeing of the Maunga and the values set out in the IMP. Lease is currently rolling over on month by month basis.

19. Given the above context management recommend a term of 5 years commencing on 1 November 2024.

### Rental

20. Rental assessment has been done by the registered valuer in 2020 at \$3,400 per annum. Management will seek advice from a registered valuer to assess the market rental at the beginning of the lease and at periodic terms during the lease.

## Next Steps

21. If a lease is to be offered, management will engage in public notification process.

## Attachments

Attachment A: Site Plan for the Onehunga Mangere United Sports Club at Te Pane o Mataoho / Te Ara Pueru / Māngere Mountain [↓](#)





Site Plan for the Onehunga Mangere United Sports Club at Te Pane o Mataoho / Te Ara Pueru / Māngere Mountain



Figure 1: Proposed Lease Location



Sealed Public Car Parking Area

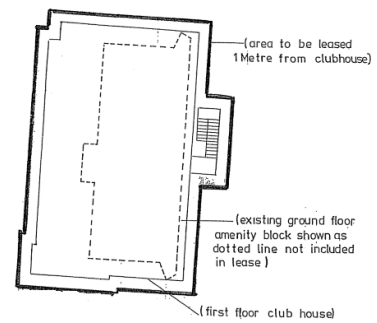

Figure 2: Proposed Leased Area, noting the publicly accessible amenity block on the ground floor does not form part of the proposed lease area.



**Mt Wellington Roller Sports Club Inc (Skateland) Lease Renewal**

Author: Lucia Kohler, Kaihautu Hotaka

<b>Purpose</b>	To consider a potential lease for 5 years, plus 5 years right of renewal, to the Mt Wellington Roller Sports Club Inc (Skateland) on Maungarei / Mt Wellington.
<b>Recommendations</b>	<p>That the Tūpuna Maunga o Tāmaki Makaurau Authority:</p> <ul style="list-style-type: none"> <li>a) <b>grant</b>, subject to completion of statutory processes, including public notification under s119 of the Reserves Act 1977, a lease to Mt Wellington Roller Sports Club Inc (Skateland) (Attachment A) subject to the following terms and conditions: <ul style="list-style-type: none"> <li>i) term – Five (5) years, commencing 1 January 2025 with One (1) right of renewal for a further Five (5) years, and final expiry on 31 December 2034.</li> <li>i) rent review by registered valuer at market rate</li> <li>ii) Maunga Outcomes plan be prepared and attached as a schedule to the lease agreement</li> <li>iii) all other terms and conditions in accordance with Ngā Mana Whenua o Tāmaki Makaurau Collective Redress Act 2014 and the Reserves Act 1977 and the Tūpuna Maunga Authority standard form lease agreement.</li> </ul> </li> <li>b) If required, <b>delegate</b> to the chairperson and deputy chairperson the power to appoint a hearings panel pursuant s 120 of the Reserves Act 1977 to consider and hear any submissions received and make a decision on the lease.</li> <li>c) <b>delegate</b> to the Chair and Deputy Chair the power to execute a lease, including a Maunga Outcomes Plan, with lessee on the terms and conditions set out in resolution (a).</li> <li>d) <b>delegate</b> to the Chair and Deputy Chair the power to agree to terms governing the termination arrangements of lessee should they decide not to accept the new lease.</li> </ul>

**Background**

1. Mt Wellington Roller Sports Club Inc (Skateland) provide a large indoor roller skating and sports rink and have been located on Maungarei since 1969. They have an existing legacy lease carried over from Auckland Council. It commenced on 1 January 2010 and was for an initial term of 5 years with two rights of renewal of 5 years each with a final expiry of 2024. Skateland owns the building and improvements.
2. At Hui 50 (25 September 2019) the Tupuna Maunga Authority resolved to grant a renewal of lease to the Mt Wellington Roller Sports Club Inc for the last term of 5 years ending 31 December 2024.
3. At Hui 92 (20 May 2024) the Tupuna Maunga Authority resolved to public a new lease to the Mt Wellington Roller Sports Club Inc term of 5 years ending 31 December 2029.

4. No submissions have been received following the public notification process under under s119 of the Reserves Act 1977.
5. Following the decision in Hui 92 Skateland have requested further lease renewal for the term of 5 years to make their nearly \$100,000 investment into renewing the skate floor viable.
6. Skateland occupy an area of Maungarei / Mount Wellington which is classified as a Recreation Reserve. Skateland currently own and maintain the building they occupy. The location of the lease area is shown in Attachment A.

### **Statutory and other considerations**

7. Any decision to determine management within a reserve must take into account the legislative and policy framework.
8. The Authority administers the Tūpuna Maunga under the Reserves Act 1977 and pursuant to Ngā Mana Whenua o Tāmaki Makaurau Collective Redress Act 2014. The Hauraki Gulf Marine Park Act 2000 is also relevant. The activities of Skateland are consistent with the reserve classification.
9. Section 109(2) of Ngā Mana Whenua o Tāmaki Makaurau Collective Redress Act 2014 requires the Authority to have regard to the spiritual, ancestral, cultural, customary, and historical significance of the Maunga to Ngā Mana Whenua o Tāmaki Makaurau and that the Tūpuna Maunga is held in trust for Ngā Mana Whenua and the other people of Auckland.
10. The Tūpuna Maunga Authority's Integrated Management Plan (IMP) was adopted by the Authority in terms of Ngā Mana Whenua o Tāmaki Makaurau Collective Redress Act 2014 and the Reserves Act 1977. The Integrated Management Plan describes a series of "Values" and "Pathways" that guide all activities on the Tūpuna Maunga. The primary focus of the IMP is to protect the health and well-being of the Tūpuna Maunga.
11. The Tūpuna Maunga Authority adopted the Tūpuna Maunga Strategies at Hui 50 on 25 September 2020. The Tūpuna Maunga Strategies are 7 key sections that outline the strategic direction with regards to education, Biodiversity, Tūpuna Maunga design, Recreation, commercial activities and monitoring. Together with the IMP, these strategies inform guide and manage the activities undertaken on the Maunga
12. The Authority administers the Tūpuna Maunga under the Reserves Act 1977 and pursuant to Ngā Mana Whenua o Tāmaki Makaurau Collective Redress Act 2014. The Hauraki Gulf Marine Park Act 2000 is also applicable in relation to Maungauika.

#### Reserves Act 1977 considerations

13. Section 54 of the Reserves Act 1977 sets out the Authority's powers in relation to leasing on a recreation reserve.
14. There is a requirement to publicly notify an intention to lease land within a Recreation Reserve.
15. Section 53(1) of the Reserves Act allows the Authority to prescribe the games, sports and other activities for public recreation that may take place in any specified part of the Reserve. This section also allows the Authority to grant organisations exclusive use of parts of the reserve for a sporting or recreation purpose.

## Discussion

### Leases on Tūpuna Maunga

16. The Tūpuna Maunga o Tāmaki Makaurau Integrated Management Plan (IMP) describes a series of values and pathways that dictate decision-making on leases. The IMP places the health and well-being of the Tūpuna Maunga at the heart of all decisions.
17. Any leasing activity must be consistent with the IMP Tūpuna Maunga values and should actively promote those values. One step is a Maunga Outcomes Plan which forms part of all leases on Tūpuna Maunga.
18. The Maunga Outcomes Plan sets out activities that the lessee will do to contribute to the health and well-being of the Tūpuna Maunga. The activities to be carried out by the lessees are co-designed by the lessees and Authority management and reflect the Tūpuna Maunga values. Scouts agrees to a series of measures within the Maunga Outcomes Plan that track progress.
19. The activities are consistent with the classification of the reserve. There have been no other parties who have expressed an interest in occupying the site.
20. The club has 312 members and in the last 12 months they hosted 31,285 skaters though public skate sessions. Skate attendance age groups are mainly 0-13 years with 34% Māori Tamariki. They operate 7 days/week: Mon-Sun are club (member – sports/teams) bookings and Fri-Sun are public skate sessions.
21. Maunga Outcomes Plan
  - Skateland has created an end-of-session experience to raise public awareness of Maungarei.
  - Skateland were involved in planting on the Maunga.
  - The club manager regularly visits the Maunga and, since the closure, it has been very clean.
  - Skateland helped with the Guy Fawkes closure one year and were not needed the year after.
  - Looking ahead at new Maunga Outcomes, the club suggested that Skateland's help do up the sidewalks going up along the walkway.

## Terms

### Term

22. Skateland has been supporting all initiatives taken in Maungarei, they have demonstrated their contribution to health and wellbeing of the Maunga and have successfully formed a good working relationship with Management. Skateland is a bespoke building and there is no immediate need for the area or the building in the Individual Maunga plan.
23. Given the above context management recommend 5 year lease term commencing on January 2025 with 5 years right of renewal and the final expiry date 31 December 2034. 1

### Rental

24. Management will seek advice from a registered valuer to assess the market rental.

## Next Steps

25. If a lease is to be offered, management will engage in public notification process.

## Attachments

Attachment A: Site Plan for the Mt Wellington Roller Sports Club at Maungarei / Mt Wellington [↓](#)





Site Plan for the Mt Wellington Roller Sports Club at Maungarei / Mt Wellington.







## Research Scholarship

Author: Challen Wilson, Manager - Co-Governance Communications

<b>Purpose</b>	To consider the Tūpuna Maunga Research Scholarship grants for 2024/2025.
<b>Recommendations</b>	That the Tūpuna Maunga o Tāmaki Makaurau Authority: a) <b>note</b> the report. b) <b>allocate</b> the Tūpuna Maunga Authority Research Scholarship grant for 2024/25.

## Background

1. The Tūpuna Maunga Research Policy was adopted at Hui 71 (14 February 2022).
2. Alongside the policy, the Tūpuna Maunga Authority agreed to make up to \$10,000 available annually to contribute to research projects deemed to be beneficial for the Tūpuna Maunga.
3. This funding can be allocated to one or more applicants.
4. Aims of the scholarship include:
  - a. provide opportunities for public to engage with the maunga as a space of learning and discovery,
  - b. support student learning, and
  - c. help gather detailed, site-specific information which supports effective management of the maunga.
5. The allocation of scholarship funding occurs within the criteria of the Research Policy.

## Statutory and other considerations

6. All decisions of the Authority must consider the legislative and policy framework.
7. Section 109(2) of Ngā Mana Whenua o Tāmaki Makaurau Collective Redress Act 2014 requires the Authority to have regard to the spiritual, ancestral, cultural, customary, and historical significance of the Maunga to Ngā Mana Whenua o Tāmaki Makaurau and that the Tūpuna Maunga is held in trust for Ngā Mana Whenua and the other people of Auckland.
8. The Tūpuna Maunga Authority's Integrated Management Plan was unanimously adopted (Mana Whenua and Auckland Council members) by the Authority pursuant to the Ngā Mana Whenua o Tāmaki Makaurau Collective Redress Act 2014 and Reserves Act 1977. The Integrated Management Plan describes a series of "Values" and "Pathways" that guide all activities on the Tūpuna Maunga.
9. The Tūpuna Maunga Authority (Mana Whenua and Auckland Council members) unanimously adopted the Tūpuna Maunga Strategies at Hui 50 on 25 September 2020. The Tūpuna Maunga Strategies outline the strategic direction with regards to education, biodiversity, design, recreation, commercial activities and monitoring. Together with the IMP, these strategies inform guide and manage the activities undertaken on the maunga.

10. The Authority administers the Tūpuna Maunga under the Reserves Act 1977 and pursuant to Ngā Mana Whenua o Tāmaki Makaurau Collective Redress Act 2014. The Hauraki Gulf Marine Park Act 2000 is also applicable in relation to Maungauika.
11. Within the monitoring strategy, mechanisms are outlined which enable the education strategy to be implemented. This includes creation of a list of research projects for tertiary students to undertake as part of their qualifications.

### **Discussion**

12. Management communicated the scholarship through the maunga.nz website, the Love Your Maunga social media channels and targeted promotion to stakeholders and interested parties.
13. A letter communicating the commencement of the scholarship round was sent to Mana Whenua, members of the Authority, and other interested parties including Universities and secondary and tertiary education organisations on 30 July 2024.
14. The scholarship application period was from 1 August 2024 to 25 September 2024.
15. Four scholarship applications were completed and received during the grant round.

### **Next steps**

16. If the Authority allocates the research scholarship funds, Management will inform all applicants of the outcome and work alongside the successful applicants to ensure the research is undertaken successfully, and in accordance with permitting conditions.

### **Attachments**

There are no attachments for this report.

## Guy Fawkes Response Plan

Author: David Bhana, Tūpuna Maunga Manager

<b>Purpose</b>	To consider an update on this year's continuing approach for protecting the Tūpuna Maunga during the 2024 Guy Fawkes period.
<b>Recommendation</b>	That the Tūpuna Maunga o Tāmaki Makaurau Authority:  a) <b>note</b> the protection measures, continued since 2020, for the Tūpuna Maunga during the 2024 Guy Fawkes period as set out in the report.

### Background

1. Fireworks are the number one cause of fires on the Tūpuna Maunga.
2. At Hui 22 (21 November 2016) following further fireworks fires on the Maunga, the Authority formally opposed the use of fireworks on the Tūpuna Maunga.
3. On 5 November 2019, two large fires were started on Maungawhau and Maungarei as a direct result of fireworks. This resulted in the Tūpuna Maunga Authority publicly declaring that the Maunga will be closed during the fireworks period until such a time as the Government bans the sale of fireworks to the public.
4. In November 2019, several members of Auckland Council made a submission to parliament seeking a ban on the sales of fireworks to the public. Councillor Cathy Casey, in her capacity as a Ward Councillor for the Albert/Eden ward, was amongst council members who made the submission. Their submission was supported by the Tūpuna Maunga Authority.
5. In August 2020, the Parliamentary Governance and Administration Select Committee decided not to ban the sale of fireworks to the public. The Chairperson of the Tūpuna Maunga Authority then wrote to the Prime Minister expressing disappointment in the decision of the select committee.
6. If there was any doubt about the need for proactive protection of the Maunga, yet another fire occurred on 7 October 2020 at Maungarei – caused by fireworks.
7. In 2024, fireworks go on sale from Saturday 2<sup>nd</sup> November, through to Guy Fawkes Day Wednesday 5<sup>th</sup>. In previous years the immediate days leading up to, and weekend following Guy Fawkes, have also been times of increased fire risk.
8. The Tūpuna Maunga Authority has closed all maunga during this Guy Fawkes period since 2020.

### Statutory and other considerations

9. Any decision to determine management within a reserve must take into account the legislative and policy framework.
10. Section 109(2) of Ngā Mana Whenua o Tāmaki Makaurau Collective Redress Act 2014 requires the Authority to have regard to the spiritual, ancestral, cultural, customary, and historical significance of the Maunga to Ngā Mana Whenua o Tāmaki Makaurau and that the Tūpuna Maunga is held in trust for Ngā Mana Whenua and the other people of Auckland.
11. The Tūpuna Maunga Authority's Integrated Management Plan was adopted by the Authority pursuant to the Ngā Mana Whenua o Tāmaki Makaurau Collective Redress Act 2014 and

Reserves Act 1977. The Integrated Management Plan describes a series of “Values” and “Pathways” that guide all activities on the Tūpuna Maunga.

12. The Tūpuna Maunga Authority adopted the Tūpuna Maunga Strategies at Hui 50 on 25 September 2020. The Tūpuna Maunga Strategies are 7 key sections that outline the strategic direction with regards to education, Biodiversity, Tūpuna Maunga design, Recreation, commercial activities and monitoring. Together with the IMP, these strategies inform guide and manage the activities undertaken on the Maunga.
13. The Authority administers the Tūpuna Maunga under the Reserves Act 1977 and pursuant to Ngā Mana Whenua o Tāmaki Makaurau Collective Redress Act 2014. The Hauraki Gulf Marine Park Act 2000 is also applicable in relation to Maungauika.

### **Overall Approach**

14. Management have successfully planned and delivered Maunga closures during Guy Fawkes since 2020. These closures are tailored to each Maunga based on risk profile.
15. The standard Maunga vehicle access hours are 7am – 8.30pm during daylight savings. From Thursday 2<sup>nd</sup> November through to Sunday 5<sup>th</sup> November vehicle access gates will be closed at 7.00pm.
16. Security teams will be deployed to each Maunga with guards located at all main and secondary entrances from 7.00pm and foot patrols will also be undertaken. All pedestrian visitors will be asked to leave the Maunga at 7.00pm. Vehicle gates will reopen at the standard time of 7am.
17. We are now in our fifth year of the Guy Fawkes response and the public are becoming used to the Maunga being closed during this period. This helps with overall awareness and makes it simpler for our security teams.

### **Public Communications**

18. The key messages for the media and public are set out in our communications through signage, news articles and interviews.
19. Signage advising of the Guy Fawkes Maunga closures, along with the usual ‘No Fireworks’ signage will be displayed at all Maunga entrances at least three weeks prior to Guy Fawkes to give visitors advance warning.
20. A letter mail drop will be completed to residents bordering the Maunga, again advising of the closures. Also included is an update on fire breaks which have been mown around the Maunga perimeters in the lead up to Guy Fawkes week.
21. A media release was issued in late October to highlight the Maunga closures and reasoning. This was picked up thorough various media channels.
22. The media release will be published as a story on the Our Auckland website and will be shared through Community and Local Board social media channels as well as the Authority’s and Auckland Council website pages.

### **Attachments**

There are no attachments for this report.

## Tūpuna Maunga Planting Update

Author: David Bhana, Tūpuna Maunga Manager

<b>Purpose</b>	To consider the 2024 restoration planting programme.
<b>Recommendation</b>	That the Tūpuna Maunga o Tāmaki Makaurau Authority: a) <b>note</b> the report.

### Restoration Planting Programme

1. Key principles in the Tūpuna Maunga Integrated Management Plan are:
  - A. To highlight the importance of restoring the Tūpuna Maunga with indigenous ecosystems,
  - B. To reintroduce and attract indigenous and culturally appropriate species, and
  - C. To nurture and enhance the living connections between the Tūpuna Maunga and other areas of indigenous biodiversity in Tāmaki Makaurau.
2. To reflect these principles, the ongoing restoration programme of planting native plants on the Tūpuna Maunga continues.

### Statutory and other considerations

3. Any decision to determine management within a reserve must take into account the legislative and policy framework.
4. Section 109(2) of Ngā Mana Whenua o Tāmaki Makaurau Collective Redress Act 2014 requires the Authority to have regard to the spiritual, ancestral, cultural, customary, and historical significance of the Maunga to Ngā Mana Whenua o Tāmaki Makaurau and that the Tūpuna Maunga is held in trust for Ngā Mana Whenua and the other people of Auckland.
5. The Tūpuna Maunga Authority's Integrated Management Plan was adopted by the Authority pursuant to the Ngā Mana Whenua o Tāmaki Makaurau Collective Redress Act 2014 and Reserves Act 1977. The Integrated Management Plan describes a series of "Values" and "Pathways" that guide all activities on the Tūpuna Maunga.
6. The Tūpuna Maunga Authority adopted the Tūpuna Maunga Strategies at Hui 50 on 25 September 2020. The Tūpuna Maunga Strategies are 7 key sections that outline the strategic direction with regards to education, Biodiversity, Tūpuna Maunga design, Recreation, commercial activities and monitoring. Together with the IMP, these strategies inform guide and manage the activities undertaken on the Maunga.
7. The Authority administers the Tūpuna Maunga under the Reserves Act 1977 and pursuant to Ngā Mana Whenua o Tāmaki Makaurau Collective Redress Act 2014. The Hauraki Gulf Marine Park Act 2000 is also applicable in relation to Maungauika.

### Discussion

8. At Hui 91 (29th April, 2024), management updated the Tūpuna Maunga Authority on the restoration planting programme for the 2024 planting season.
9. At the end of this planting season, a total of 37,543 new plantings were planted across the Maunga network between May-September 2024. These plantings are additional to the 186,594 plants already planted over the last 4 years (a total of 224,137 plants).
10. The table below details the total plants planted this year

Tūpuna Maunga	Total plants	Community planting	Contractor
Ōtāhuhu/Mount Richmond	7,296	2,264 (Community) 5,020 (School)	12 Specimen Trees
Ōhinerau/Mount Hobson	8,417	360 (School) 2,892 (Community)	5,150 +15 Specimen Trees
Ōhuiarangi/Pigeon Mountain	7,395	2,095 (Organisation) 5,282 (Community)	18 Specimen Trees
Te Tātua a Riukiuta / Big King	5,979	3,583 (Organisation) 1,014 (Community)	16 Specimen Trees + 1,366
Pukewīwī/ Puketapapa/Mount Roskill	3,170		3,170
Te Pane-o-Mataaho / Māngere Mountain	1,772		1,772 Infill Planting
Ōwairaka/Mount Albert	1,489		1,489 Infill Planting
Matukutūruru/Wiri Mountain	2,025		2,025

11. The Maunga were planted with appropriate plant species within the guidance of ecosystem type, site suitability, fire retardant and archaeologically appropriate species.
12. Management held four community planting days across the Maunga network; Ōtāhuhu / Mount Richmond, Ōhinerau / Mount Hosbon, Ōhuiarangi / Pigeon Mountain and Te Tātua a Riukiuta / Big King, two School plantings on Ōtāhuhu / Mount Roskill and Ōhinerau / Mount Hobson and three organisation plantings on Ōhuiarangi / Pigeon Mountain and Te Tātua a Riukiuta / Big King.
13. Community and schools planting dates were best aligned with the Maramataka. Some of the original planting days had to be changed due to wet weather but were still aligned with the Maramataka.
14. Tūpuna Maunga Management staff hosted all planting days, welcoming volunteers and providing a tutorial for first-time planters. Each planting day concluded with a barbecue or small kai. In total, management had 315 community registrations from individuals eager to participate in planting on the Tūpuna Maunga. School planting days involved over 150 students from Panama Road Primary School, Pacific Advancement Secondary School, and St Cuthbert's College. Additionally, more than 90 staff members from various teams within Auckland Council took part in organisational planting days.
15. For health and safety reasons, there are areas on Maunga where planting could only be undertaken using specialist contractors with the right qualifications and equipment to undertake the work.

16. The multi-year planting programme will continue in 2025 and onwards.

**Next steps**

17. Management will continue with the ongoing restoration programme including planting maintenance, monitoring and reporting requirements.

**Attachments**

There are no attachments for this report.





## Creation of a Bylaw for the Tūpuna Maunga

Author: Matt Burton, Kaihautū Tautukanga Tūpuna Maunga/Compliance Advisor

<b>Purpose</b>	To consider the creation of a bylaw for the Tūpuna Maunga
<b>Recommendation</b>	That the Tūpuna Maunga o Tāmaki Makaurau Authority: a) <b>request</b> management to draft a bylaw for the Tūpuna Maunga network for future consideration by the Authority.

### Background

1. At Hui 93, management identified a future regulatory issue at Matukutūruru once the predator proof fencing has been established. The aim of creating a biodiversity sanctuary would mean that dogs and other animals would need to be excluded from the Maunga to ensure success of the overall project. Two options were presented:
  - a. The Authority creates a dog access policy on Matukutūruru that excludes dogs from the Maunga
  - b. A Reserves Act 1977 bylaw is created with the aim of excluding dogs and other animals from the Maunga under Section 106(1(a))
2. At Hui 94, management presented the Authority an analysis of two bylaw options aimed at addressing the regulatory issue:
  - a. A bylaw that would cover all the Tūpuna Maunga (with the exclusion of dogs or other animals from Matukutūruru being laid out in a schedule)
  - b. An individual bylaw for Matukutūruru that would address this regulatory issue.

### Statutory and other considerations

3. This paper relates to Matukutūruru and the wider Tūpuna Maunga network.
4. Any decision to determine management within a reserve must take into account the legislative and policy framework.
5. Section 109(2) of Ngā Mana Whenua o Tāmaki Makaurau Collective Redress Act 2014 requires the Authority to have regard to the spiritual, ancestral, cultural, customary, and historical significance of the Maunga to Ngā Mana Whenua o Tāmaki Makaurau and that the Tūpuna Maunga is held in trust for Ngā Mana Whenua and the other people of Auckland.
6. The Tūpuna Maunga Authority's Integrated Management Plan (IMP) was adopted by the Authority pursuant to the Ngā Mana Whenua o Tāmaki Makaurau Collective Redress Act 2014 and Reserves Act 1977. The Integrated Management Plan describes a series of "Values" and "Pathways" that guide all activities on the Tūpuna Maunga. One of the values set out in the IMP is Mauri Pūnaha Hauropi (Ecology and Biodiversity). One of the significant pathways to achieve this, states: Protect and restore the biodiversity of the Tūpuna Maunga.

7. The Tūpuna Maunga Authority adopted the Tūpuna Maunga Strategies at Hui 50 on 25 September 2020. The Tūpuna Maunga Strategies are 7 key sections that outline the strategic direction with regards to education, Biodiversity, Tūpuna Maunga design, Recreation, commercial activities and monitoring. Together with the IMP, these strategies inform guide and manage the activities undertaken on the Maunga.
8. The Authority administers the Tūpuna Maunga under the Reserves Act 1977 and pursuant to Ngā Mana Whenua o Tāmaki Makaurau Collective Redress Act 2014. The Hauraki Gulf Marine Park Act 2000 is also applicable in relation to Maungauika.

## **Discussion**

### **Reserves Act 1977 Maunga bylaw**

#### Proposed objectives

9. The creation of a Tūpuna Maunga bylaw under the Reserves Act will ensure that there is appropriate provision for the exclusion of animals from Matukutūruru which supports the goal of this Maunga becoming a biodiversity sanctuary for our native flora and fauna. With the use of a bylaw, The Authority can also establish the following ancillary objectives:
  - a. Consolidating network-wide policies into one piece of legislation
  - b. Streamlining the legislative process in the future through having the ability to review, update or amend related provisions in one go, rather than individually.
  - c. The centralisation of dog access rules on every Maunga into one piece of legislation to avoid any confusion within the local communities
  - d. Through the bylaw draft process, enabling the Authority to potentially address any historic regulatory gaps on the Maunga.

### **Recommending the Drafting of a Reserves Act 1977 Maunga Bylaw**

10. Management recommends that the Tūpuna Maunga Authority initiates work on drafting a Maunga bylaw under the Reserves Act 1977. This bylaw would not only support success of a biodiversity sanctuary on Matukutūruru but would establish a singular, network wide piece of regulatory legislation for the Tūpuna Maunga that will act as the framework for future regulatory policy.
11. Management note that the Reserves Act 1977 sets out the public consultation process if the Authority approves any future draft Maunga Bylaw.

## **Attachments**

There are no attachments for this report.

---

## Registers

Author: David Bhana, Tūpuna Maunga Manager

---

<b>Purpose</b>	To consider update registers for: a) Heath & Safety (Attachment A) b) Events (Attachment B)
<b>Recommendation</b>	That the Tūpuna Maunga o Tāmaki Makaurau Authority: a) <b>note</b> the attached Registers, which have been updated since Hui 93 (29 July 2024) .

## Registers

Attachment A: [Health & Safety Register](#)

Attachment B: [Events Register](#)



Health and Safety Register

Hui reported to	Maunga	Summary of incident	Number of any near misses	Outcome of investigations into any incidents and near misses	Health and Safety management matters arising	Actions Taken
Hui 95	Ōwairaka	During filling the water tank on Ōwairaka, an unattended dog jumped up on one of the contractors. The contractors then told the owner of the dog nearby to control his dog and they engaged in a verbal exchange. Police were called to deescalate the situation.		Dog was off leash and not under control when it jumped on the contractor.	Aggressive behaviour	Management working on options to reinforce responsible dog ownership habits to the public. Management working with contractors to support training for such interaction.
Hui 95	Matukutūruru	Neighbouring construction site has excavated to the property boundary below the recently built track. Management have raised concerns of this works effect on the stability of the Maunga and the safety of the track.		Investigations ongoing with Auckland Council regulatory team. Potential unsafe working conditions at the foot of the Maunga has been raised with WorkSafe.	Potential fall risk to anyone on the Maunga. Potential risk to integrity of the Maunga.	Track sectioned off. Matter raised with Auckland Council regulatory team to investigate. TMA has conducted own survey to determine if any encroachment occurred. TMA conducting their own geotechnical assessment to ascertain the impacts on the Maunga.
Hui 94	Maungauika	Walking through from Cheltenham to unlock gate, contractor has been frightened by a cat jumping out and has fallen over onto the rocks.		Reviewed need to lock/unlock gate in good visibility.	Injury to contractor	Reinforcement of safety protocols for working in low visibility.
Hui 94	Matukutūruru	Gate has been damaged unable to open up.		Random act of vandalism	Damage to structure on the Maunga	Gate and fixings repaired
Hui 94	Matukutūruru	Contractor sustained minor facial injury from a stone propelled from another's operator's weedeater.		Contractor was wearing full PPE and safety goggles protected from more serious injury	Injury to contractor	Reinforcement of safety protocols and PPE requirements when doing this mahi at toolbox meeting
Hui 93	Puketāpapa/ Pukewīwī	While pruning garden, contractor has been hit in the face by a branch.		Human error – working too quickly	Potential injury to contractor	Reinforcement of safety protocols and PPE requirements when doing this mahi at toolbox meeting.
Hui 93	Maungauika	While unlocking tunnel gates, contractor has jammed finger in the lock.		Lock mechanism is in good working condition pulled the lock out too quickly	Injury to contractor	Reinforcement of safety protocols at toolbox meeting.
Hui 93	Maungakiekie	Leaving the carpark turned too sharp and collided with a rock on the corner. Damage on the passenger side.		Contractor needed to give more berth in playground carpark when turning. Structure on Maunga is fine.	Damage to structure on the Maunga	Reinforcement of safety protocols at toolbox meeting.
Hui 93	Maungakiekie	The contractor was reversing out of carpark at Stardome, didn't see a cyclist coming down fast towards Manukau and had to break fast to avoid a collision	1	Contractor did not look again while reversing and didn't see cyclist. Cyclist likely travelling faster than speed limit contributed to not seeing them.	Potential injury to public	Reinforcement of safety protocols at toolbox meeting. Management to look at whether speed signage on Maunga is enough.
Hui 93	Maungakiekie	Contractor has backed in the pole of the autogate during work on the Maunga.		Contractor did not have a spotter when reversing and hit the pole.	Damage to structure on the Maunga	Pole reinstated. Reinforcement of safety protocols at toolbox meeting.
Hui 92	Maungakiekie	Member of public has slipped on a section of the tihi road on Maungakiekie.	1	The lichen along the edge of the road was getting slippery in the wet.	Potential fall injury to public	Immediate area water blasted. Program of tihi road treatment reviewed to ensure covering problem areas.
Hui 92	Maungakiekie	Member of public has tripped over on the reduced path on Olive Grove on Maungakiekie and sustained injuries.		Investigation found a broken section of kerb channel that was unnoticed under the leaves.	Potential fall injury to public	Broken channel section repaired. Pathway blown down to clear leaves. More signage put up at the two entrances of narrow path during construction.

Hui reported to	Maunga	Summary of incident	Number of any near misses	Outcome of investigations into any incidents and near misses	Health and Safety management matters arising	Actions Taken
Hui 92	Maungawhau	Tourist bus has damaged their vehicle on the exit bollard and spilt oil on the road.		Investigation determined vehicle did not follow the proper process, they failed to wait for bollard to retract fully before driving through. The oil then spilt onto the road and created a slip hazard.	Potential fall injury to public	Spill cordoned off. Emergency spill kit applied to area, followed by another clean. Structural check on Bollards.
Hui 92	Maungauika	Contractors notified management of police cordon on Maungauika early morning as a deceased person had been discovered on the Maunga.		n/a	n/a	Emergency services already on site, had cordoned off area and diverted public.  Management notified TTT and TMA Chair while the investigation continued by Police.  Karakia conducted later that day when Police concluded their investigation.  Monitoring of contractors and kaimahi well-being to continue over the week.  Management to continue to reach out to Police to be notified of outcome of investigation.

Events Register

Hui reported to	Maunga	Applicant	Event Description	Event Date	Status	Revenue
Hui 95	Maungauika	Amber Greaves / Devonport Half Marathon	Commercial	6 <sup>th</sup> of October 2024	Approved	\$1200
Hui 95	Maungakiekie	Iain Hook / Maungakiekie Songbird	Community	28 <sup>th</sup> of September 2024	Approved	\$0
Hui 95	Ōtāhuhu	Dane Maera / Ki-o-Rahi Tāmaki Makaurau Regionals (Senior)	Community	18 <sup>th</sup> of September 2024	Approved	\$0
Hui 94	Maungauika	Dion Jelley / North Shore Marathon	Commercial	15 <sup>th</sup> of September 2024	Approved	\$900
Hui 94	Maungarei	Steff Holcroft / Northern Tour Schools Cycling	Community	7 <sup>th</sup> of September 2024	Approved	\$0
Hui 94	Maungawhau	Rachel Setters / Ficino School Cross Country Run	Community	16 <sup>th</sup> of August 2024	Approved	\$0
Hui 94	Te Tātua a Riukiuta	TMA / Organisational Planting Day (Nga Mataarae, TWT, Māori Outcomes)	TMA	15 <sup>th</sup> of August 2024	Approved	\$0
Hui 94	Ōtāhuhu	TMA / School Planting Day	TMA	13 <sup>th</sup> of August 2024	Approved	\$0
Hui 93	Te Pane o Mataoho	Rosie Spearing / Young Guns Skate School Event	Community	11 <sup>th</sup> of July 2024	Approved	\$0
Hui 93	Maungawhau	Geoff Holmes / City Centre Prospectus / Drone Shoot	Private	5 <sup>th</sup> of July 2024	Approved	\$0
Hui 93	Ōwairaka	Sheryl Fletcher / Ōwairaka School Sunrise Hīkoi	Community	4 <sup>th</sup> of July 2024	Approved	\$0
Hui 93	Maungawhau	Maungawhau Mission (Fundraiser run)	Community	2 <sup>nd</sup> of July 2024	Approved	\$0
Hui 93	Puketāpapa	Callum McGibbon / Karakia (Matariki)	Community	26 <sup>th</sup> June 2024	Approved	\$0
Hui 93	Maungawhau	Adriana Palmer / Southern Cross Health Care Cleanup	Community	23 <sup>rd</sup> June 2024	Approved	\$0
Hui 93	Te Tātua a Riukiuta	AKLC Planting Day	Community	19 <sup>th</sup> June 2024	Approved	\$0

Hui reported to	Maunga	Applicant	Event Description	Event Date	Status	Revenue
Hui 93	Puketāpapa	John Sutton / Manu Aute Kite Day	Community	16 <sup>th</sup> June 2024	Approved	\$0
Hui 93	Ōhūiarangi	Community Planting Day (Matariki)	Community	16 <sup>th</sup> June 2024	Approved	\$0
Hui 93	Puketāpapa	Kristen Walsham / Kāhui Ako Matariki Music Video	Community	13 <sup>th</sup> June 2024	Approved	\$0
Hui 93	Takarunga	Craig Tikao / Tātaki Unlimited Global Audience Stills Shoot	Community	6 <sup>th</sup> June 2024	Approved	\$0
Hui 93	Ōhinerau	Community Planting Day	Community	1 <sup>st</sup> June 2024	Approved	\$0
Hui 93	Ōhūiarangi	AKLC / Landcare & MPI Planting Day	Community	30 <sup>th</sup> May 2024	Approved	\$0
Hui 93	Ōhinerau	St. Cuthbert's School Planting Day	Community	25 <sup>th</sup> May 2024	Approved	\$0
Hui 93	Ōtāhuhu	Community Planting Day	Community	19 <sup>th</sup> May 2024	Approved	\$0
Hui 92	Maungawhau	Briar Pacey/Tātaki Unlimited Destination Tourism	Private	15 <sup>th</sup> May 2024	Approved	\$0
Hui 92	Maungawhau	Deborah Gray/Balmoral School	Community	9 <sup>th</sup> May 2024	Approved	\$0
Hui 92	Maungawhau	Richard Taylor/Wayne Taylor Band	Community	7 <sup>th</sup> April 2024	Approved	\$0
Hui 92	Maungawhau	Ali Bowey/Green By Nature	Private	4 <sup>th</sup> April 2024	Approved	\$0
Hui 92	Maungawhau	Ashley Pihema/Mā Whero Education	Private	4 <sup>th</sup> April 2024	Approved	\$0
Hui 92	Maungawhau	Kara Beckford	Private	4 <sup>th</sup> April 2024	Approved	\$450
Hui 92	Maungawhau	James McGoram/Rare Disorders NZ	Community	30 <sup>th</sup> March 2024	Approved	\$0
Hui 92	Takarunga	Andie Levell/Combined Churches of Devonport	Community	29 <sup>th</sup> March 2024	Approved	\$0



Hui reported to	Maunga	Applicant	Event Description	Event Date	Status	Revenue
Hui 92	Te Pane o Mataoho	Teresa Ah Wa/Māngere Catholic	Community	29 <sup>th</sup> March 2024	Approved	\$0
Hui 92	Maungawhau	Dillon Blair/Conservation Volunteers NZ	Private	21 <sup>st</sup> March 2024	Approved	\$0
Hui 90	Maungawhau	Rebecca Woodward/Te Kura School Hikoi	Community	20 <sup>th</sup> March 2024	Approved	\$0
Hui 90	Maungawhau	Trish Wilson/Auckland City Brass Concert	Community	16 <sup>th</sup> March 2024	Approved	\$190
Hui 90	Maungarei	Richard Johnston/Panmure Bridge School Hikoi	Community	12 <sup>th</sup> March 2024	Approved	\$0
Hui 90	Maungauika	Caroline Aspden/AUT Field Sampling	Private	9 <sup>th</sup> March 2024	Approved	\$280
Hui 90	Maungakiekie	Tia Barrett	Private	8 <sup>th</sup> January 2024	Approved	\$0
Hui 90	Maungawhau	Maxim Sherstobitov	Private	4 <sup>th</sup> December 2023	Approved	\$450 (ex GST)
Hui 90	Maungauika	Jeff Karaka	Community	25 <sup>th</sup> November 2023	Approved	\$0