



Date: Monday, 25 May 2026
Time: 2:30pm
Meeting Room: Reception Lounge
Venue: Auckland Town Hall
301-305 Queen Street
Auckland

TŪPUNA MAUNGA O TĀMAKI MAKAUURAU AUTHORITY

HUI 105

OPEN AGENDA

Co-Chairpersons	Marama Royal	Ngā Mana Whenua o Tāmaki Makaurau (Ngāti Whātua Rōpū)
	Paul Majurey	Ngā Mana Whenua o Tāmaki Makaurau (Marutūāhu Rōpū)
Deputy Chairperson Members	Cr Alf Filipaina	Auckland Council (Governing Body – Manukau)
	Cr Christine Fletcher	Auckland Council (Governing Body - Albert-Eden-Puketāpapa)
	Damian Light	Auckland Council (Howick Local Board)
	Ropata Paora	Ngā Mana Whenua o Tāmaki Makaurau (Ngāti Whātua Rōpū)
	Sarah Powrie	Auckland Council (Ōrākei Local Board)
	Vanessa Reynolds	Ngā Mana Whenua o Tāmaki Makaurau (Waiohua-Tāmaki Rōpū)
	Tame Taratu	Ngā Mana Whenua o Tāmaki Makaurau (Waiohua-Tāmaki Rōpū)
	Tania Tarawa	Ngā Mana Whenua o Tāmaki Makaurau (Marutūāhu Rōpū)
	Jon Turner	Auckland Council (Puketāpapa Local Board)
Cr Ken Turner	Auckland Council (Governing Body – Waitākere)	

(Quorum 6 members, comprising the chair or deputy chair and 2 members appointed by the rōpū entities and 2 members appointed by Auckland Council)

CONTENTS

- 1 Apologies**
- 2 Declaration Of Interest**
- 3 Confirmation of Minutes**
- 4 Reports**
 - 4.1 Tūpuna Maunga o Tāmaki Makaurau Authority Draft Operational Plan 2026/27 and Summary
 - 4.2 Quarter 2 Report
 - 4.3 Building options for use going forward
 - 4.4 Michael King Writers Centre Lease update
 - 4.5 Tūpuna Maunga Residency Programme
 - 4.6 Research Policy Update
 - 4.7 Māori Education Trust Partnership
 - 4.8 Delegation to the Co-Chairs and Deputy Chair for licencing decisions under the Reserves Act 1977
 - 4.9 Registers

Ngā Mana Whenua o Tāmaki Makaurau Collective Redress Act 2014

109 Functions and powers

- (1) The Maunga Authority has the powers and functions conferred on it by or under this Act or any other enactment.
- (2) In exercising its powers and carrying out its functions in relation to the maunga, the Maunga Authority must have regard to—
 - (a) the spiritual, ancestral, cultural, customary, and historical significance of the maunga to Ngā Mana Whenua o Tāmaki Makaurau; and
 - (b) section 41(2).
- (3) In exercising its powers and carrying out its functions in relation to the administered lands, the Maunga Authority must have regard to the spiritual, ancestral, cultural, customary, and historical significance of the administered lands to Ngā Mana Whenua o Tāmaki Makaurau.

[Emphasis added]

41 Maunga must remain as reserves vested in trustee

- (1) This section applies to each maunga once the maunga is—
 - (a) vested in the trustee under subpart 1, 2, or 3 of this Part;and
 - (b) Declared a reserve under any of sections 18 to 29, 33, and 39.
- (2) The maunga is held by the trustee for the common benefit of Ngā Mana Whenua o Tāmaki Makaurau and the other people of Auckland.

...

[Emphasis added]



Tūpuna Maunga Reserve Status*

The following Tūpuna Maunga, with the relevant reserve status, are classified as reserves subject to the Reserves Act 1977

Maunga	Reserve Status
Matukutūruru	Historic reserve
Maungakiekie / One Tree Hill	Recreation reserve
Maungarei / Mt Wellington	Recreation reserve, Local Purpose reserve
Maungawhau / Mount Eden	Historic reserve, Recreation reserve
Maungauika / North Head	Historic reserve
Ōwairaka / Te Ahi-kā-a-Rakataura / Mount Albert	Recreation reserve
Pukewīwī / Puketāpapa / Mount Roskill	Recreation reserve
Te Kōpuke / Tītīkōpuke / Mount St John	Recreation reserve
Ōhinerau / Mount Hobson	Recreation reserve
Ōhūiarangi / Pigeon Mountain	Historic reserve, Recreation reserve, Local Purpose reserve
Ōtāhuhu / Mount Richmond	Recreation reserve
Takarunga / Mount Victoria	Recreation reserve, Local Purpose reserve
Te Tātua-a-Riukiuta / Big King	Recreation reserve
Te Ara Pueru / Te Pane-o-Mataaho / Mangere Mountain	Historic reserve, Recreation reserve, Local Purpose reserve
Rarotonga / Mount Smart	Recreation reserve

* See sections 18-29, 33 (repealed), 39, 41, 47, 53, 54, and Schedules 1 & 2, 6 of Ngā Mana Whenua o Tāmaki Makaurau Collective Redress Act 2014

1 Apologies

No apologies have been received.

2 Declaration of Interest

Members are reminded of the need to be vigilant to stand aside from decision making when a conflict arises between their role as a member and any private or other external interest they might have.

3 Confirmation of Minutes

Click the meeting date below to access the minutes.

That the Tūpuna Maunga Authority:

- a. **confirm** the minutes for Hui 103 held on 30 March 2026 as a true and accurate record.



Date: Monday, 30 March 2026
Time: 3:00pm
Meeting Room: Reception Lounge
Venue: Auckland Town Hall
301-305 Queen Street
Auckland

TŪPUNA MAUNGA O TĀMAKI MAKĀURAU AUTHORITY

HUI 103

OPEN MINUTES

The open hui commenced at 2.51pm.

PRESENT TE HUNGA KUA TAE MAI		
Co-Chairpersons	Paul Majurey (Presiding)	
	Marama Royal	From 2.58pm, Item 4.1
Deputy Chairperson	Cr Alf Filipaina	
Members	Cr Christine Fletcher	
	Damian Light	
	Ropata Paora	
	Sarah Powrie	
	Vanessa Reynolds	
	Tame Taratu	
	Tania Tarawa	
	Jon Turner	
	Cr Ken Turner	

Member R Paora opened the hui with a karakia.

1 Apologies

Apologies

There were no apologies.

2 Declaration Of Interest

Declaration of Interest

There were no declarations of interest.

3 Confirmation of Minutes

Confirmation of Minutes

There were no minutes to be confirmed.

4 Reports

Items 4.1 and 4.2 were taken together.

4.1 Appointment of the Chairperson and Deputy Chairperson for the Tūpuna Maunga Authority

Note: Rōpū entities announced the appointment of Member M Royal and Member P Majurey as Co-Chairpersons for the Tūpuna Maunga Authority.

Co-Chair M Royal entered the meeting at 2.58pm.

Note: Members appointed by Auckland Council had two nominations for the position of Deputy Chairperson. Cr C Fletcher nominated Cr K Turner which was supported by two members. Member D Light nominated Cr A Filipaina supported by four members, therefore, Cr A Filipaina was announced as the Auckland Council appointee as Deputy Chairperson for the Tūpuna Maunga Authority.

Note: changes to the original recommendation were made during discussion.

MOVED by Member P Majurey, seconded by Member J Turner:

That the Tūpuna Maunga Authority:

- a. **note the appointment of Member M Royal and Member P Majurey as Co-Chairpersons for the Tūpuna Maunga Authority.**
- b. **note the appointment of Member A Filipaina as Deputy Chairperson for the Tūpuna Maunga Authority.**

CARRIED

4.2 Appointment of members to Tūpuna Maunga Authority Rōpū

Note: changes were made to the original recommendation, adding new clause c) with the agreement of the meeting, in response to a request from Cr C Fletcher.

Note: changes to the original motion were made during discussion.

MOVED by Co-Chair P Majurey, seconded by Member J Turner:

That the Tūpuna Maunga Authority:

- a. **confirm replacement appointments of Member M Royal (Co-Chair), P Majurey (Co-Chair), A Filipaina (Deputy Chair), T Taratu and J Turner to the Tūpuna Maunga Authority Film and the Events Rōpū.**
- b. **confirm replacement appointments of Members P Majurey (Co Chair), M Royal (Co-Chair), A Filipaina (Deputy Chair), V Reynolds and K Turner to the Resource Management Act Rōpū.**
- c. **note that the Tūpuna Maunga Authority strongly supports the protection of the viewshafts to the Tūpuna Maunga Authority and their retention within the Auckland Unitary Plan.**

CARRIED

4.3 Quarter 1 Report

MOVED by Member P Majurey, seconded by Member T Tarawa:

That the Tūpuna Maunga Authority:

- a. **note the attached Quarter 1 Report for 2025/26 financial year.**

CARRIED

4.4 Registers

MOVED by Member M Royal, seconded by Member T Tarawa:

That the Tūpuna Maunga Authority:

- a. **note the attached Registers, which have been updated since Hui 102 (29 September 2025).**

CARRIED

Meeting Closed

Member T Taratu closed Hui 103 with a karakia.

03.20pm

Co-Chair P Majurey thanked members for their attendance and attention to business and declared the meeting closed.

CONFIRMED AS A TRUE AND CORRECT
RECORD AT A MEETING OF THE TŪPUNA
MAUNGA O TĀMAKI MAKĀURAU AUTHORITY -
HUI 103 MEETING HELD ON

DATE:.....

CHAIRPERSON:.....

Tūpuna Maunga o Tāmaki Makaurau Authority Draft Operational Plan 2026/27 and Summary

Author/s :

Dominic Wilson, Te Tauihu Waka Tairanga Whenua / Co-Governance Manager
Bizhan Rahnama, Kaitohutohu Tupuna Maunga / Co-Governance Advisor

Purpose

1. To consider adoption of the Tūpuna Maunga Authority's Draft Operational Plan 2026/27 (and summary).

Recommendation

That the Tūpuna Maunga Authority:

- a. **approve** the Tūpuna Maunga Authority Operational Plan 2026/27 (Attachment A) and the summary of the Tūpuna Maunga Authority Operational Plan 2026/27(Attachment B).
- b. **delegate** authority to Te Tauihu Waka Tai Ranga Whenua to incorporate into the Operational Plan maps and photographs and any further minor typographical changes that may be identified.
- c. **note** the Auckland Council Governing Body will be invited to jointly approve the Tūpuna Maunga Authority Operational Plan 2026/27 and the summary of the Tūpuna Maunga Authority Operational Plan 2026/27 for inclusion in the Annual Plan 2026/27.

Item 4.1

Background

2. The Ngā Mana Whenua o Tāmaki Makaurau Collective Redress Act 2014 requires the Tūpuna Maunga Authority and Auckland Council to jointly agree an annual operational plan and a summary of that plan for inclusion in council's annual plan.
3. Both the Auckland Council and Tūpuna Maunga Authority have completed consultation on Tūpuna Maunga Authority Operational Plan 2026/27 and the summary of the Tūpuna Maunga Authority Operational Plan 2026/27 including Annual Plan 2026/27 (annual budget).

Statutory Context

4. The process and any decision to adopt an Operational Plan, and summary thereof, is required to take into account the legislative and policy framework.
5. Section 109(2) of Ngā Mana Whenua o Tāmaki Makaurau Collective Redress Act 2014 requires the Authority to have regard to the spiritual, ancestral, cultural, customary, and historical significance of the Maunga to Ngā Mana Whenua o Tāmaki Makaurau and that the Tūpuna Maunga is held in trust for Ngā Mana Whenua and the other people of Auckland.

6. The Tūpuna Maunga Authority's Integrated Management Plan was unanimously adopted (Mana Whenua and Auckland Council members) by the Authority pursuant to the Ngā Mana Whenua o Tāmaki Makaurau Collective Redress Act 2014 and Reserves Act 1977. The Integrated Management Plan describes a series of "Values" and "Pathways" that guide all activities on the Tūpuna Maunga.
7. The Tūpuna Maunga Authority (Mana Whenua and Auckland Council members) unanimously adopted the Tūpuna Maunga Strategies at Hui 50 on 25 September 2020. The Tūpuna Maunga Strategies are 7 key sections that outline the strategic direction with regards to education, Biodiversity, Tūpuna Maunga design, Recreation, commercial activities and monitoring. Together with the IMP, these strategies inform guide and manage the activities undertaken on the Maunga.
8. The Ngā Mana Whenua o Tāmaki Makaurau Collective Redress Act 2014 sets out a process for the adoption of an "Annual Operational Plan" by the Authority (refer sections 60-63). Management have worked alongside the council's legal and finance teams to ensure compliance with the procedures set out in the legislation.
9. The Authority administers the Tūpuna Maunga under the Reserves Act 1977 and pursuant to Ngā Mana Whenua o Tāmaki Makaurau Collective Redress Act 2014. The Hauraki Gulf Marine Park Act 2000 is also applicable in relation to Maungauika.

Item 4.1

Discussion

10. Attachment A to this report is the Draft Tūpuna Maunga Authority Operational Plan 2026/27. Attachment B is the draft Summary of the Tūpuna Maunga Authority Draft Operational Plan 2026/27.
11. At their hui on 2 June 2026, the Governing Body of the Auckland Council will consider the Draft Tūpuna Maunga Authority Operational Plan 2026/27 and Annual Plan 2026/27.
12. Management recommend that the Authority approve Attachments A and B.

Attachments

- A. Tūpuna Maunga Authority Operational Plan 2026/27
- B. Summary of the Tūpuna Maunga Authority Operational Plan 2026/27

Tūpuna Maunga o Tāmaki Makaurau
DRAFT TŪPUNA MAUNGA OPERATIONAL PLAN 2026/2027

CONTENTS	1
INTRODUCTION	1
NGĀ TŪPUNA MAUNGA O TĀMAKI MAKĀURAU THE ANCESTRAL MOUNTAINS OF AUCKLAND	2
REDRESS AND CO-GOVERNANCE	2
THE TŪPUNA MAUNGA REDRESS	3
NGĀ MANA WHENUA O TĀMAKI MAKĀURAU	5
TŪPUNA TAONGA O TĀMAKI MAKĀURAU TRUST	5
TŪPUNA MAUNGA AUTHORITY	6
AUCKLAND COUNCIL	7
STRATEGIC FRAMEWORK	8
TŪPUNA MAUNGA INTEGRATED MANAGEMENT PLAN	9
TŪPUNA MAUNGA INTEGRATED MANAGEMENT PLAN STRATEGIES	9
TŪPUNA MAUNGA INDIVIDUAL MAUNGA PLANS	9
TŪPUNA MAUNGA VALUES	10
THE TŪPUNA MAUNGA AUTHORITY OPERATIONAL PLAN	12
TŪPUNA MAUNGA WORK PROGRAMME 2024-34	13
WORK PROGRAMME OVERVIEW	14
TABLE 1 - TŪPUNA MAUNGA WORK PROGRAMME 2024- 34	17
FUNDING, REVENUE AND EXPENDITURE	21
TABLE 2 – FUNDING ENVELOPE FOR THE TŪPUNA MAUNGA AUTHORITY ENDORSED IN THE COUNCIL’S 10- YEAR BUDGET (LONG-TERM PLAN) 2024-34	23
NETWORK-WIDE REVENUE	24
NETWORK-WIDE PROGRAMMES	25
CAPITAL EXPENDITURE PROGRAMME	25
OPERATIONAL EXPENDITURE PROGRAMME	26
MATUKUTŪRURU / WIRI MOUNTAIN	28
MAUNGAKIEKIE / ONE TREE HILL	31
MAUNGAREI / MT WELLINGTON	35

MAUNGAUIKA / NORTH HEAD	39
MAUNGAWHAU / MT EDEN	43
ŌHINERAU / MT HOBSON	47
ŌHUIARANGI / PIGEON MOUNTAIN	51
ŌTĀHUHU / MT RICHMOND	55
ŌWAIRAKA / TE AHI-KĀ-A-RAKATAURA / MT ALBERT	59
PUKEWĪWĪ / PUKETĀPAPA / MT ROSKILL	63
TAKARUNGA / MT VICTORIA	66
TE PANE-O-MATAAHO / TE ARA PUERU / MĀNGERE MOUNTAIN	70
TE KŌPUKE / TĪTĪKŌPUKE / MT ST JOHN	74
TE TĀTUA A RIUKIUTA / BIG KING	77
GLOSSARY	81

Introduction





Ngā Tūpuna Maunga o Tāmaki Makaurau

The ancestral mountains of Auckland

It is the rich history of Māori connection to the Maunga (volcanoes) of Tāmaki Makaurau / Auckland, unbroken over time, that sets them apart from any other volcanic landscape in the world.

As Māori established here, the Maunga were valued as natural places for pā (settlements), with their rich volcanic soils and their unique form and height for easy defence. The number of Maunga pā across Tāmaki Makaurau made it an important region of Māori social organisation and a main location for trade between tribes throughout Aotearoa / New Zealand.

The Maunga are central to the spiritual and cultural identity of Māori.

A defining principle in te ao Māori (the Māori world) is kinship. All the myriad elements of creation – the living and the dead, the animate and inanimate – are inter-related. All are infused with mauri (life force) and wairua (spirit), and all are related through whakapapa (common descent) from Ranginui (Sky Father) and Papatūānuku (Earth Mother).

In Māori culture, the people of a place are related to its mountains, rivers and species of plant and animal, and regard them in personal terms. Wairuatanga (spiritual

connections) between people and the natural world is an integral part of traditional Māori cultural practices.

Tikanga (protocols) have been established over time to ensure that resources are harvested sustainably and that the relationship with the natural environment remains balanced. The Maunga, as with all of the natural environment, are governed by fundamental values such as kaitiakitanga (guardianship), manaakitanga (care and generosity) and utu (reciprocity) which reinforce a sense of belonging and social cohesion.

To Nga Mana whenua o Tāmaki Makaurau (the Māori tribes of Auckland), the Maunga are living entities with mauri and wairua. They are regarded as Tūpuna (ancestors), and as taonga tuku Iho (treasures to be handed down the generations).

In recognition of the deep spiritual, cultural and customary connection between the Maunga and the Māori people of this land, the Auckland volcanic field heads New Zealand's working list for World Heritage status with the United Nations Educational, Scientific and Cultural Organisation (UNESCO).

Redress and Co-Governance



The Tūpuna Maunga Redress

The Ngā Mana Whenua o Tāmaki Makaurau Collective Redress Settlement is an outcome of Mana Whenua and the Crown settling historical Treaty of Waitangi breaches. The settlement recognises that the Tūpuna Maunga are taonga in relation to which Mana Whenua have always maintained a unique relationship and honours their intergenerational role as kaitiaki (guardians).

In July 2014, the Collective Redress Act was passed. The Act vested the Crown-owned land of 14 Tūpuna Maunga in Ngā Mana Whenua o Tāmaki Makaurau, on the basis that they are held in trust for the common benefit of the iwi/hapū of Ngā Mana Whenua o Tāmaki Makaurau and the other people of Auckland.

The Tūpuna Maunga are owned by the 13 iwi/hapū of Ngā Mana Whenua o Tāmaki Makaurau via the Tūpuna Taonga o Tāmaki Makaurau Trust.

THE 14 TŪPUNA MAUNGA ARE:

Matukutūruru/Wiri Mountain

Maungakiekie/One Tree Hill

Maungarei/Mount Wellington

Maungauika/North Head

Maungawhau/Mount Eden

Ōhinerau/Mount Hobson

Ōhūiarangi/Pigeon Mountain

Ōtāhuhu/Mount Richmond

Ōwairaka/Te Ahi-kā-a-Rakataura/Mount Albert

Puketāpapa/Pukewīwī/Mount Roskill

Rarotonga/Mount Smart *

Takarunga/Mount Victoria

Te Kōpuke/Tītīkōpuke/Mount St John

Te Tātua a Riukiuta/Big King

Under the Act each Tūpuna Maunga was declared a reserve and the Tūpuna Maunga Authority was appointed as the administering body for the majority of the Maunga for the purposes of the Reserves Act 1977.

THE EXCEPTION IS:

- Rarotonga /Mount Smart which is vested in the Taonga Trust and administered by Auckland Council (Regional Facilities Auckland) under the Mount Smart Regional Recreation Centre Act 1985 and Reserves Act 1977.

The Collective Redress Act also transferred the administration of the following reserve land retained in Crown ownership to the Tūpuna Maunga Authority:

- Te Pane-o-Mataaho /Te Ara Pueru/ Māngere Mountain – ownership of the land remains with the Crown and is administered by the Tūpuna Maunga Authority under the Collective Redress Act and Reserves Act.
- Maungakiekie / One Tree Hill Northern land ownership of the land remains with the Crown and it is administered by the Tūpuna Maunga Authority under the Collective Redress Act and Reserves Act.



Key

- Tūpuna Maunga
- Local board boundaries and geographic areas



NGĀ MANA WHENUA O TĀMAKI MAKAURAU

Ngā Mana Whenua o Tāmaki Makaurau is the collective name of the 13 iwi/hapū with historical Treaty claims in the wider Tāmaki Makaurau. The iwi/hapū are grouped into the following three rōpū:

- Marutūāhu Rōpū: Ngāti Maru, Ngāti Pāoa, Ngāti Tamaterā, Ngāti Whanaunga, Te Patukirikiri;
- Ngāti Whātua Rōpū: Ngāti Whātua o Kaipara, Ngāti Whātua Ōrākei, Te Rūnanga o Ngāti Whātua; and
- Waiohua Tāmaki Rōpū: Ngāi Tai ki Tāmaki, Ngāti Tamaoho, Ngāti Te Ata, Te Ākitai Waiohua, Te Kawerau ā Maki.

The collective approach recognises that the iwi and hapū have various shared customary interests within Tāmaki Makaurau such that a collective settlement approach is appropriate. It also provides for the greater exercise of whanaungatanga and kotahitanga between the iwi/hapū.

The sections for each of the Tūpuna Maunga within this document show the individual iwi and hapū customary association with that Tūpuna Maunga as recorded in the Ngā Mana Whenua o Tāmaki Makaurau Collective Redress Deed of Settlement.

TŪPUNA TAONGA O TĀMAKI MAKAURAU TRUST

The Tūpuna Taonga o Tāmaki Makaurau Trust (Trust) was set up to receive the Tāmaki Collective cultural redress arising out of the Collective Redress Act.

The Trust receives, administers, manages, protects and governs the assets of the Trust for and on behalf of the 13 iwi and hapū of Ngā Mana Whenua o Tāmaki Makaurau.

The Trust's Statement of Intent 2017/18 confirms the Trust's strategic objectives as:

- 1. Toitū te whenua, whatu ngarongaro te tangata**
Enduring protection and management of cultural redress properties
- 2. Tē tōia, tē haumatia**
A sustainable Trust that fulfils its purpose well
- 3. Toitū te kupu, toitū te mana, toitū te whenua**
A strong Mana Whenua presence and connection to cultural redress
- 4. Mā whero, mā pango ka oti ai te mahi**
Enduring relationships and collaboration.

TŪPUNA MAUNGA AUTHORITY

The Tūpuna Maunga Authority is the statutory authority established under the Ngā Mana Whenua o Tāmaki Makaurau Collective Redress Act to co-govern the Tūpuna Maunga. The inaugural hui was held in November 2014.

The Tūpuna Maunga Authority has six representatives appointed by Ngā Mana Whenua o Tāmaki Makaurau and six appointed by council. The Minister for Arts, Culture and Heritage may also appoint a non-voting Crown representative.

The Tūpuna Maunga Authority is independent of council and has its own decision-making powers and functions. Council is responsible for the routine management of the Maunga under the direction of the Tūpuna Maunga Authority.

The Tūpuna Maunga Authority's bespoke co-governance structure recognises not only the important relationship Ngā Mana Whenua have with these sacred places, but also their importance to, and connection with, all the peoples of Auckland. The Tūpuna Maunga Authority is a tangible expression of the spirit of partnership between Ngā Mana Whenua and council.

THE TŪPUNA MAUNGA AUTHORITY MEMBERS ARE:

Toni van Tonder	Auckland Council
Clay Hawke	Ngā Mana Whenua o Tāmaki Makaurau (Ngāti Whātua Rōpū)
Ngarimu Blair	Ngā Mana Whenua o Tāmaki Makaurau (Ngāti Whātua Rōpū)
Ken Turner	Auckland Council
Nerissa Henry	Auckland Council
Paul Majurey	Ngā Mana Whenua o Tāmaki Makaurau (Marutūāhu Rōpū)
Tania Tarawa	Ngā Mana Whenua o Tāmaki Makaurau (Marutūāhu Rōpū)
Christine Fletcher	Auckland Council
Tauanu'u Nick Bakulich	Auckland Council
Karen Wilson	Ngā Mana Whenua o Tāmaki Makaurau (Waiohua-Tamaki Rōpū)
Josie Smith	Ngā Mana Whenua o Tāmaki Makaurau (Waiohua-Tamaki Rōpū)
Kerrin Leoni	Auckland Council

AUCKLAND COUNCIL

Auckland Council is responsible for the routine management of the Tūpuna Maunga under the direction of the Tūpuna Maunga Authority. It is responsible for the costs in relation to the Tūpuna Maunga and administered lands incurred by council and the Tūpuna Maunga Authority in carrying out their respective functions under the Collective Redress Act or the Reserves Act 1977.

Council must also provide the Tūpuna Maunga Authority with the administrative support necessary to carry out its functions and to exercise its powers. This responsibility is within the extent that funding and revenue for the Maunga and the administered lands allow.



Strategic Framework





TŪPUNA MAUNGA INTEGRATED MANAGEMENT PLAN

The Tūpuna Maunga Integrated Management Plan (“IMP”) sets the foundations for how the Tūpuna Maunga are valued, protected, restored, enhanced, and managed in the future with equal consideration and reverence. The IMP established a set of Values for the Tūpuna Maunga which are outlined below.

The IMP was developed in accordance with Section 41 of the Reserves Act to provide for and ensure the use, enjoyment, maintenance, protection, preservation, and development as appropriate for the reserve purposes for which each of the Tūpuna Maunga is classified. This single integrated plan replaces the former separate legacy reserve management plans for the Tūpuna Maunga.

The IMP was approved in 2016 following a public consultation process and can be read online at www.maunga.nz.¹

TŪPUNA MAUNGA INTEGRATED MANAGEMENT PLAN STRATEGIES

The Tūpuna Maunga Integrated Management Plan Strategies are the next level of policy development for the Tūpuna Maunga and aim to support the Values and Pathways in the Tūpuna Maunga Integrated Management Plan 2016.

The IMP Strategies was approved in 2019 following a public consultation process and can be read online at www.maunga.nz.

TŪPUNA MAUNGA INDIVIDUAL MAUNGA PLANS

The Individual Maunga plans (Maunga Plans) are the final tier of policy development and complete the series of documents as part of the Integrated Management Plan Framework. The Plans give effect to the Values, Pathways, Guidelines and Strategies and provide further detail with regards to the work the Authority is undertaking to enhance the health and well-being of the Tūpuna Maunga. The Maunga Plans are living documents that can be updated in accordance with future Annual Operational Plans.

¹ The IMP was amended in 2022 following another public consultation process to allow for the delivery of the Tūpuna Maunga restoration programme

The first 3 Maunga Plans were approved in July 2023. Further Individual Maunga Plans will be developed over the course of the current term of the Tūpuna Maunga Authority.

TŪPUNA MAUNGA VALUES

Within the Tūpuna Maunga Integrated Management Plan, the Tūpuna Maunga Authority has articulated a set of values of the Tūpuna Maunga. The values promote the statutory purpose of the Tūpuna Maunga under section 109 of the Collective Redress Act, where in exercising its powers and functions the Authority must have regard to the spiritual, ancestral, cultural, customary and historical significance of the Tūpuna Maunga to Ngā Mana Whenua.

The values provide a strategic framework to guide the Tūpuna Maunga Authority in making any decision about the Tūpuna Maunga.

The values weave together and give expression to mana whenua and other world views, and the connections and histories in a manner that highlights the way in which these views complement each other and create a richness to the relationship people have with the Tūpuna Maunga and multiple ways in which these relationships are thought of and expressed.

VALUE PATHWAYS

WAIJUATANGA /SPIRITUAL

- Restore and recognise the relationship between the Maunga and its people.
 - Recognise the tihi is sacred.
 - Tread gently.
 - Treat the Maunga as taonga tuku iho – treasures handed down the generations.
-

MANA AOTŪROA / CULTURAL AND HERITAGE

- Enable mana whenua role as kaitiaki over the Tūpuna Maunga.
 - Recognise European and other histories, and interaction with the Maunga.
 - Encourage culturally safe access.
 - Restoring customary practices and associated knowledge.
-

TAKOTORANGA WHENUA / LANDSCAPE

- Protect the integrity of the landscape of the Tūpuna Maunga.
 - Active restoration and enhancement of the natural features of the Maunga.
 - Encourage activities that are in keeping with the natural and indigenous landscape.
 - Encourage design that reflects Tūpuna Maunga values.
 - Promote a connected network of Tūpuna Maunga.
 - Preserve the visual and physical integrity of the Maunga as landmarks of Tāmaki.
-

MAURI PŪNAHA HAUROPI / ECOLOGY AND BIODIVERSITY

- Strengthen ecological linkages between the Tūpuna Maunga.
 - Maunga tū mauri ora, Maunga tū makaurau ora / if the Maunga are well, Auckland is well.
 - Protect and restore the biodiversity of the Tūpuna Maunga.
-

MANA HONONGA TANGATA / LIVING CONNECTION

- Rekindle the sense of living connection between the Maunga and the people.
 - Give expression to the history and cultural values of the Tūpuna Maunga.
 - Actively nurture positive relationships.
 - A place to host people.
-

WHAI RAWA WHAKAUKA / ECONOMIC / COMMERCIAL

- Alignment with the Tūpuna Maunga values.
 - Foster partnerships and collaboration.
 - Focus on commercial activities that create value and enhance experience.
 - Explore alternative and self-sustaining funding opportunities.
-

MANA WHAI A RĒHIA / RECREATIONAL

- Balance informal and formal recreation.
 - Encourage informal inclusive recreational activities.
 - Recreational activities consistent with tikanga Māori.
 - Maunga are special places and treasures handed down.
 - Promote health and wellbeing.
-



The Tūpuna Maunga Authority Operational Plan

For each financial year the Tūpuna Maunga Authority and Auckland Council (council) must agree an operational plan. The plan outlines how council will carry out the routine maintenance of the Tūpuna Maunga (ancestral mountains) and administered lands under the direction of the Tūpuna Maunga Authority. This is a requirement under section 60 of the Ngā Mana Whenua o Tāmaki Makaurau Collective Redress Act 2014 (the Collective Redress Act).

The operational plan outlines the work programme for the financial year, which comprises of a number of projects at a network and individual Maunga level. Importantly, the operational plan sets out how these individual projects contribute to delivery of the Tūpuna Maunga Authority's

objectives and vision for the Tūpuna Maunga by linking them to one or more of the Tūpuna Maunga Values in the Integrated Management Plan.

This Operational Plan covers the financial years 2026/27, 2027/28 and 2028/29 in detail. Network-wide budgets are shown for a number of programmes. Once the guidelines and strategies and individual Maunga plans have been developed, these will be able to be further refined to show spend on individual Maunga.

This Operational Plan also includes the funding envelope for the third year of the Auckland Council 10-year Budget (Long-term Plan) 2024-34.

Tūpuna Maunga Work Programme 2024-34



WORK PROGRAMME OVERVIEW

In addition to expressing the objectives and vision for the Tūpuna Maunga, the values are the key driver of the Tūpuna Maunga work programme (see Table 1).

This work programme is a continuation from the Long-Term Plan 2024-34. This year's operational plan reflects the progress that has been made on this programme and includes further projects which have emerged from the Tūpuna Maunga Strategies.

The outer years of the proposed work programme foreshadow a change in the focus of the Authority as the significant CAPEX projects are completed.

Priority programmes and projects over the next 3 years include:

POLICY AND MANAGEMENT

- Develop individual Tūpuna Maunga plans to provide direction on how the Values, Pathways, guidelines and strategies should be reflected on each Tūpuna Maunga.
- Progressing the potential transfer of administration over certain Maunga reserve lands from the Department of Conservation to the Authority, and the potential transfer of the administration of land contiguous to other Tūpuna Maunga.
- Establishment of a compliance programme including a review of current and establishment of appropriate bylaws.

HEALING THE MAUNGA

VALUES:

TAKOTORANGA WHENUA / LANDSCAPE VALUE

- Protection and restoration of the tihi (summits) including reconfiguring space and provision of cultural infrastructure.
- Protection and restoration of historic kumara pits, pā sites and wahi tapu.
- Development of infrastructure to enhance visitor experience including provision of carparks, amenity areas, tracks and ancillary infrastructure such as wharepaku/ toilets.

- Removal of redundant infrastructure (built structures, water reservoirs, impermeable surfaces, etc) and returning areas to open space.

EDUCATION, COMMUNICATIONS AND PARTNERSHIPS

VALUES:

WAIKUATANGA / SPIRITUAL VALUE

- On-site staff to protect and enhance the Tūpuna Maunga and the visitor experience.
- Volunteer programmes to connect communities to the Tūpuna Maunga.
- Education programmes, community events and a bespoke website that celebrates the living connection that all communities have with the Tūpuna Maunga.
- Implementation of the Education Strategy to promote the values of the Tūpuna Maunga and the unique history and whakapapa of Ngā Mana Whenua. This includes exploration of visitor centre opportunities, connecting with communities of learning such as schools and the development of a communications strategy.

CULTURAL CONNECTION

VALUES:

MANA AOTŪROA / CULTURAL AND HERITAGE VALUE

MANA HONONGA TANGATA / LIVING CONNECTION VALUE

- Development of a programme of work which enables Ngā Mana Whenua to express their living and unbroken connection with the Tūpuna Maunga. This may include cultural interpretation including distinct entrance ways, pou whenua, pa reconstructions, kaitiaki opportunities, and other cultural activities.
- Mana whenua living connection programme focusing on their role as kaitiaki (guardians), restoring customary practices and associated knowledge and enabling cultural activities.

BIODIVERSITY/BIOSECURITY

VALUES:

MAURI PŪNAHA HAUROPI / ECOLOGY AND BIODIVERSITY VALUE

- Restoration of indigenous native ecosystems; reintroducing native plants and attracting native animal species; removing inappropriate exotic trees and weeds (For context, see pages 58, 65-66, 71, 87,88 90-91, and appendix 5 of the amended Tūpuna Maunga Authority Integrated Management Plan, and at pages 7 and 34 of the Integrated Management Plan Strategies).
- Pest control on all Maunga in line with Auckland's plan to be pest free by 2050.
- Researching options to achieve efficient and effective animal and pest control methods, which includes a phased reduction in the use of herbicides and pesticides on the Tūpuna Maunga.
- Establishing a pest-proof fencing solution at Matukutūruru.

All projects are designed to deliver outcomes for the 13 iwi/hapū of the Tāmaki Collective and all the people of Auckland, enhance the mana and mauri of the Tūpuna Maunga and deliver improved open spaces across the eight local board areas.

They will also enable a compelling case in a future UNESCO World Heritage bid for the Tūpuna Maunga, which will contribute to a Māori identity that is Auckland's point of difference in the world. The bid for World Heritage status will require a dedicated resource and will continue to be progressed in this financial year in partnership with the Department of Conservation.

RECREATION AND ACTIVATION

VALUES:

MANA HONONGA TANGATA / LIVING CONNECTION VALUE

MANA WHAI A RĒHIA / RECREATIONAL VALUE

- Exploration of facilities and activities on, around and between the Tūpuna Maunga which provide for passive and active recreational opportunities.

COMMERCIAL

VALUES:

WHAI RAWA WHAKAUKA / ECONOMIC / COMMERCIAL VALUE

- Develop and implement a commercial framework which ensures continued investment back into the Tūpuna Maunga. This includes exploration of potential commercial activities and facilities, as well as the development of a concession framework for commercial operators on the Maunga.

LEVELS OF SERVICE

Levels of Service are set as part of the Auckland Council Long Term Plan 2024-34 process and the current Operational Plan. The performance measures and targets for the Tūpuna Maunga are as follows:

LEVEL OF SERVICE STATEMENT	PROTECT, CONSERVE & INTERP THE VALUES & FEATURES OF AUCKLAND'S VOLCANIC HERITAGE		
Customer Performance measure(s)	2026/27 target	2027/28 target	2028/29 target
Number of proposed events on Tūpuna Maunga that Mana Whenua are engaged about (to approve or decline)	30	30	30
Number of key sites of significance of Tūpuna Maunga with mitigation measures to improve or maintain their condition	13	13	13

NGĀ MANA WHENUA O TĀMAKI MAKĀURAU PROGRAMMES, INCLUDING IWI OR HAPŪ PROGRAMMES (2024-2034)

The Tūpuna Maunga Authority plans various programmes to support Ngā Mana Whenua o Tāmaki Makaurau. Some key programmes for each Maunga and the administered lands discussed in this Operational Plan are:

- on-site interpretation/storytelling projects that recognise and share with visitors the relationships of mana whenua to the Tūpuna Maunga,
- education programmes developed, in partnership with mana whenua that help share the values of the Tūpuna Maunga and increasing support for the protection and restoration of these values,
- projects that work with mana whenua to identify and implement infrastructure and programmes that will support mana whenua reconnecting with the Tūpuna Maunga,
- a network-wide programme to work with mana whenua to identify, protect and heal sites of significance,
- general engagement and consultation to seek technical and landowner input into projects and programmes; and
- supporting events where possible including mana whenua cultural activities.

TABLE 1 - TŪPUNA MAUNGA WORK PROGRAMME 2024-34

Projects to be completed on the Tūpuna Maunga are approved by the Tūpuna Maunga Authority and prioritised according to the urgency and nature of the work, the staging of other projects, the available funding and management's capacity to deliver. The table below sets out the prioritised projects, grouped into programmes of work aligned with values, for the 10 years of the Auckland Council 10-year Budget (Long-term Plan) 2024-34. These are then phased over the short, medium and long term. It includes policy projects as well as operational and capital projects. Projects for years 1-3 are also covered in the individual Tūpuna Maunga sections of this plan.

TŪPUNA MAUNGA VALUE	PRIORITISED PROJECTS	SHORT TERM YEARS 1 – 3 (2024– 2026)	MEDIUM TERM YEARS 4 – 7 (2027– 2030)	LONG TERM YEARS 8 – 10 (2031 – 2034)
WAIRUATANGA / SPIRITUAL <ul style="list-style-type: none"> restore and recognise the relationship between the Maunga and its people tread gently recognise the tihi is sacred treat the Maunga as taonga tuku iho – treasures handed down the generations 	Protection and restoration of tihi: <ul style="list-style-type: none"> continue exploration of pedestrianisation opportunities across the Tūpuna Maunga network Complete removal of redundant infrastructure and reinstate tihi vegetation management – remove weed species, manage health and safety risks and inappropriate exotics including the delivery of the approved Vegetation Restoration Programme as per the IMP revegetate suitable areas, and minimise impact of remaining infrastructure. 	○		
	Protection and restoration of waahi tapu and taonga: <ul style="list-style-type: none"> Develop and implement a programme with mana whenua to protect and restore sites of significance. 	○	○	○
	On-site interpretation/storytelling: <ul style="list-style-type: none"> plan and develop other information centre opportunities, and develop comprehensive and specific interpretation for each Tūpuna Maunga using signs, notice boards, visual aids, interactive displays, art etc that recognises and shares with visitors the significance of the Tūpuna Maunga and mana whenua's relation to them. 	○	○	○
	Off-site interpretation/storytelling: <ul style="list-style-type: none"> develop technology and digital content to complement on-site interpretation. 	○	○	○
	Education programmes: <ul style="list-style-type: none"> develop, in partnership with mana whenua and stakeholders, programmes that help share the values of the Tūpuna Maunga and increasing support for the protection and restoration of these values 	○	○	○
	Events: <ul style="list-style-type: none"> work with partners to develop an events programme that celebrate the Tūpuna Maunga and connecting, engaging and educating the people of Tamaki Makaurau. 	○	○	○
	Settings that inspire reverence, aroha, respect and awareness of the Tūpuna Maunga as treasures: <ul style="list-style-type: none"> Through working with mana whenua, future opportunities to establish an authentic Māori presence will be identified and implemented. 	○	○	○
	Planning: <ul style="list-style-type: none"> complete individual Tūpuna Maunga plans to provide direction on how the Values, Pathways, guidelines and strategies should be reflected on each Tūpuna Maunga. review and develop appropriate bylaws to ensure the values of the Maunga are protected. 	○		
	<ul style="list-style-type: none"> potential transfer of administration of Crown and Council land contiguous to other Tūpuna Maunga pursuant to s110 of Ngā Mana Whenua o Tāmaki Makaurau Collective Redress Act 2014. potential administration of certain Maunga reserve lands from the Department of Conservation to the Authority. 	○	○	○
	MANA AOTŪROA / CULTURAL AND HERITAGE	Mana whenua reconnection: <ul style="list-style-type: none"> work with mana whenua to identify and implement infrastructure and programmes that will support mana whenua reconnecting with the Tūpuna Maunga. 	○	○
	<ul style="list-style-type: none"> Develop greater on the ground Tūpuna Maunga Authority presence 	○	○	○

TŪPUNA MAUNGA VALUE	PRIORITISED PROJECTS	SHORT TERM YEARS 1 – 3 (2024– 2026)	MEDIUM TERM YEARS 4 – 7 (2027– 2030)	LONG TERM YEARS 8 – 10 (2031 – 2034)
<ul style="list-style-type: none"> enable Mana Whenua role as kaitiaki over the Tūpuna Maunga encourage culturally safe access restoring customary practices and associated knowledge recognise European and other histories, and interaction with the Maunga 	<p>Sharing histories and promoting the geological significance of the Maunga</p> <ul style="list-style-type: none"> develop interpretation that honours the multiple narratives, cultural meaning and connections felt and expressed among Ngā Mana Whenua and all people of Tāmaki Makaurau over the Tūpuna Maunga and the geological significance of the Tūpuna Maunga. Initially work will focus on obtaining baseline knowledge to be used in interpretation. The focus will then move on to how to share this and encourage collective stewardship of existing historical heritage. 	○	○	○
	<p>Neighbours and local communities:</p> <ul style="list-style-type: none"> communicate and collaborate with neighbours, local communities and key decision makers to enhance the values of the Tūpuna Maunga. The initial focus for this will be on informing them of key developments, engagement in the biosecurity programme and the development of the individual Tūpuna Maunga plans. 	○	○	○
<p>TAKOTORANGA / LANDSCAPE</p> <ul style="list-style-type: none"> protect the integrity of the Tūpuna Maunga encourage design that reflects Tūpuna Maunga Values promote a connected network of Maunga preserve the visual and physical integrity of the Maunga as landmarks of Tāmaki active restoration and enhancement of the natural features of the Maunga encourage activities that are in keeping with the natural and indigenous landscape 	<p>Protection and restoration of integrity of the Tūpuna Maunga:</p> <ul style="list-style-type: none"> complete programme to remove redundant infrastructure and reinstate and minimise impact of existing infrastructure restore and protect historic sites e.g. stone walls, waahi tapu, kumara pits, reconstructed terraces remove pest animals vegetation removal – remove weed species, health and safety risks, and inappropriate exotics to deliver the approved Vegetation Restoration programme in accordance with the Integrated Management Plan and Strategies revegetate suitable areas as per the Vegetation Restoration programme in accordance with the Integrated Management Plan ensure that new structures, services, areas of planting and facilities are appropriately located and designed to complement the landform, reduce or minimise visual distractions and respect cultural, historical and spiritual values, work with stakeholders to develop and implement a sustainability programme e.g. enhance stormwater management through on-site treatment, install solar panels, develop water conservation techniques, remove encroachments on the Tūpuna Maunga and reinstate (“encroachment” refers to any unlawful interference to Maunga reserve land such as the building of structures or fences within the reserve) influence developments in Auckland to ensure that the Tūpuna Maunga remain markers in the landscape and their cultural and natural features remain visually apparent advocate for the acquisition/transfer land to enable the Maunga Authority to manage adjoining land that comprise the true extent of the Tūpuna Maunga to enable integrated management and development, and explore options for planting plans to include fire retardant plants and extending firebreaks as appropriate. plan and implement measures to improve storm and erosion resilience across the Maunga, reinforce and celebrate Maunga to Maunga sightlines using digital and physical mediums explore opportunities to acknowledge the Tūpuna Maunga as a connected network, including walks and other events 	○	○	○

TŪPUNA MAUNGA VALUE	PRIORITISED PROJECTS	SHORT TERM YEARS 1 – 3 (2024– 2026)	MEDIUM TERM YEARS 4 – 7 (2027– 2030)	LONG TERM YEARS 8 – 10 (2031 – 2034)	
MAURI PŪNAHA HAUROPI / ECOLOGY AND BIODIVERSITY	Pest Management and Biosecurity programme:	○	○	○	
	<ul style="list-style-type: none"> strengthen ecological linkages between the Maunga Maunga tū mauri ora, Maunga tu Makaurau ora / if the Maunga are well, Auckland is well restore the biodiversity of the Tūpuna Maunga 	<ul style="list-style-type: none"> continue programme to control the presence and spread of pest plants and animals and environmental weeds in accordance with the Biosecurity Plan. establish a framework for research opportunities on the Tūpuna Maunga, including student research and pest control practices develop technology and trials for monitoring of the biodiversity on the Tūpuna Maunga 			
	Biodiversity programme:	○	○	○	
	<ul style="list-style-type: none"> restore the indigenous biodiversity of the Tūpuna Maunga through the ongoing management of existing threatened plants, replanting of suitable areas with indigenous ecosystems and the reintroduction or attraction of indigenous species such as microorganisms, invertebrates, lizards and birds. Establish pest proof areas through working with neighbours and partners and neighbours and the installation of pest proof fencing 				
	Volunteer programme:	○	○	○	
	<ul style="list-style-type: none"> actively create opportunities for people to contribute to the wellbeing of the Tūpuna Maunga through involvement in the biosecurity and biodiversity programmes 				
MANA HONANGA TANGATA/LIVING CONNECTION	Develop the Tūpuna Maunga as places of education, understanding, discovery and rediscovery so that everyone can understand the historical connections and develop their own personal connections to the Tūpuna Maunga through for example interpretation, events, Tūpuna Maunga Lease Outcome Plans, and the development of infrastructure that creates an authentic Māori presence.	○	○	○	
	<ul style="list-style-type: none"> a place to host people actively nurture positive relationships give expression to the history and cultural values of the Maunga rekindle the sense of living connection between the Maunga and the people 	<ul style="list-style-type: none"> Develop a package of information and education materials that reflect the tikanga and the histories of the Tūpuna Maunga. Create a network of communities of learning which connect tamariki and rangatahi to surrounding Maunga. Develop network of assets to advance interests of the Maunga and Ngā Mana Whenua o Tāmaki Makaurau 			
WHAI RAWA WHAKAUKA / ECONOMIC AND COMMERCIAL	Facilitate and promote commercial activities that promote the values of the Tūpuna Maunga:	○	○	○	
	<ul style="list-style-type: none"> focus on commercial activities that create value and enhance experience explore alternative and self-sustaining funding opportunities 	<ul style="list-style-type: none"> develop (or facilitate the development by 3rd parties) new facilities or repurpose existing assets and areas, implement the Maunga Tohu framework, identify and progress sponsorship opportunities, continue to manage filming and events, and progress other activities identified in the Commercial Strategy. investigate new revenue opportunities at Hāngī ki te Whānau Ātea explore opportunities to enable Mana Whenua to engage in commercial activities on the Tūpuna Maunga 			

TŪPUNA MAUNGA VALUE	PRIORITISED PROJECTS	SHORT TERM YEARS 1 – 3 (2024– 2026)	MEDIUM TERM YEARS 4 – 7 (2027– 2030)	LONG TERM YEARS 8 – 10 (2031 – 2034)
<ul style="list-style-type: none"> foster partnerships and collaboration alignment with the Tūpuna Maunga Values 	<p>Alternative revenue streams:</p> <ul style="list-style-type: none"> investigate and progress the development of philanthropy, such as grants, gifting and bequeaths, to support the protection and restoration of the values of the Tūpuna Maunga 	○	○	○
<p>MANA WHAI A RĒHIA / RECREATIONAL</p> <ul style="list-style-type: none"> promote health and wellbeing encourage informal inclusive recreation activities balance informal and formal recreation recreational activities consistent with tikanga Māori Maunga are special places and treasures handed down 	<p>Track network development:</p> <ul style="list-style-type: none"> develop the agreed track network for each Tūpuna Maunga to enhance access and protect the values of the Tūpuna Maunga. 	○		
	<p>Way-finding programme:</p> <ul style="list-style-type: none"> develop and implement comprehensive way-finding markers/signs on each Tūpuna Maunga 	○	○	
	<p>Ancillary visitor infrastructure:</p> <ul style="list-style-type: none"> develop/upgrade/renew ancillary facilities to support visitor experience such as toilets, seating, car parking, water fountains, bike racks, vehicle barriers. 	○	○	○
	<p>Passive recreation and play infrastructure:</p> <ul style="list-style-type: none"> develop play spaces inspired by the topography of the landscape, the stories on the Tūpuna Maunga and Māori culture that encourage young people to connect with the Tūpuna Maunga, and identify and develop facilities/spaces that promote health and wellbeing 		○	○
	<p>Manage activities:</p> <ul style="list-style-type: none"> progressively implement the Recreation Strategy and the individual Tūpuna Maunga to align activities to the values of the Tūpuna Maunga e.g. bylaw reviews, remove and reinstate or repurpose leased assets and/or areas where leases are not renewed identify ongoing opportunities for connectivity between the Tūpuna Maunga and for passive and active recreation explore possibilities for appropriate sports facilities 	○	○	○

Funding, Revenue and Expenditure



Funding and revenue for the Tūpuna Maunga and administered lands may only be applied for the purposes of the Maunga and the administered lands.

Funding and revenue for the Maunga must be:

- Held and accounted for separately by council
- Applied by council under the direction of the Tūpuna Maunga Authority and in accordance with the annual operational plan

Every 3 years council must prepare and adopt a 10-year Budget (Long Term Plan) which describes the activities of the council and forecast expenditure and funding requirements for the next 10 years.

The expenditure and funding requirements for the Maunga Authority for 10 years are included in the council's 10-year Budget (Long-term Plan) 2024-34 are shown in Table 2.

This operational plan sets out the detailed expenditure and revenue for the 2026/27 and indicative financial information for 2027/28 and 2028/29. The annual operational plan for 2026/27 and the subsequent years fits within this funding envelope. The Tūpuna Maunga Authority manage the Maunga as a network. The individual Maunga sections set out maunga-specific costs for programmes and projects where these have been identified and scoped. The network-wide programmes require further project planning to determine how they will be applied to each Maunga.

Any budget variation associated with individual projects or network-wide programmes will be shared across the network in accordance with the priorities set out in Table 2 and kept within the total funding envelope.

OPERATIONAL EXPENDITURE

Net operating expenditure covers income and expenditure from day-to-day operations and services.

The operational expenditure shown in the individual Maunga sections is in future year dollar terms. The annual inflation rates applied are based on the rates used in the Auckland Council Long-term Plan 2024-34.

CAPITAL EXPENDITURE

CAPITAL DEVELOPMENT PROJECTS

These are for the creation or purchase of new assets, typically to address growth in demand, changes to the required Level of Service and to be consistent with the Tūpuna Maunga values and pathways as identified in the Integrated Management Plan. Any new Capital Project to be delivered are identified under each Maunga.

TABLE 2 – FUNDING ENVELOPE FOR THE TŪPUNA MAUNGA AUTHORITY
ENDORSED IN THE COUNCIL’S 10-YEAR BUDGET (LONG-TERM PLAN)
2024-34

LTP 2024-2034

Funding Envelope (\$000's)	2024/25	2025/26	2026/27	2027/28	2028/29	2029/30	2030/31	2031/32	2032/33	2033/34	Total
Net operating expenditure	4,085	4,214	4,373	4,373	4,819	4,927	5,029	4,830	4,834	4,837	46,321
Capital expenditure	9,395	9,720	12,580	12,600	12,856	13,117	13,383	3,384	3,564	3,752	94,352
Total LTP Funding Requirement 2024-34*	13,480	13,934	16,953	16,973	17,675	18,044	18,413	8,215	8,397	8,589	140,673

* Excludes depreciation
and inflation.

The budget for 2026/27 fits within the Auckland Council's
10-year budget (2024-34) funding envelope.

Network-wide Revenue

There are a number of revenue-generating activities that occur on the Tūpuna Maunga. This revenue contributes to the protection and restoration of the Maunga and is incorporated into the net operational expenditure calculations.

ACTIVITY	DESCRIPTION	2026/27	2027/28	2028/29
Filming and Events	Filming and events that incur fees and charges as per the Tūpuna Maunga Authority's Fees and Charges Schedule	\$8,175	\$8,339	\$8,506
Leases	Leases that incur fees and charges as per the Tūpuna Maunga Authority's Fees and Charges Schedule	\$258,500	\$258,500	\$258,500
Tenancies	2 residential tenancies on the Maunga	\$54,080	\$54,080	\$54,080
Venue bookings	Mangere War Memorial Hall, Hāngī ki te Whānau Ātea	\$71,400	\$72,828	\$74,285
Concessions framework	Implement Maunga Tohu scheme	\$6,000	\$6,000	\$6,000

This is projected to increase over time as a result of:

- the implementation of the Tūpuna Maunga Authority's Fees and Charges Schedule to new leases
- the granting of licences and concessions for existing and new commercial activities
- new commercial partnerships/sponsorships
- the promotion of philanthropy to contribute to the care and protection of the Tūpuna Maunga, and
- the development of visitor information hubs.

The Commercial Strategy will confirm the activities that the Tūpuna Maunga Authority will actively progress and the staging of these projects.

Network-wide Programmes

CAPITAL EXPENDITURE PROGRAMME

There are a number of programmes that require further project planning to determine how they will be applied to each Maunga. Once this has occurred, the individual Maunga sections will be updated at the next available opportunity.

VALUE	PROJECT	DESCRIPTION	2026/27	2027/28	2028/29
MANA AOTŪROA / CULTURAL & HERITAGE	Interpretation and Wayfinding signs	Network wide programme to develop comprehensive site-specific interpretation and wayfinding signage	\$500,000	\$700,000	\$800,000
	Storytelling and Cultural Infrastructure	Network-wide programme to develop unique infrastructure that bring Mana Whenua stories and values to life on the Maunga	\$220,000	\$880,000	\$880,000
	Digital storytelling infrastructure	Network-wide programme to develop of digital platform for storytelling	\$30,000	\$50,000	\$100,000
TAKOTORANGA / LANDSCAPE	Protection and restoration of integrity of the Tūpuna Maunga	Network-wide Vegetation Restoration programme to remove vegetation and reinstate and/or revegetate in accordance with the IMP	\$1,100,000	\$1,100,000	\$1,100,000
	Adverse climate events	Response to, and building resilience i.e. quarry stability, land erosion and degradation, landslides	\$100,000	\$200,000	\$286,000
	Implement Maunga water strategy	Investigate and implement passive stormwater management devices across the Maunga	\$350,000	\$200,000	\$200,000
MAURI PŪNAHA HAUROPI / ECOLOGY AND BIODIVERSITY	Traditional Cultivation	Network-wide programme to establish gardens based on Maturanga Māori such as māra kai, rongoa and pā harakeke	\$50,000	\$100,000	\$100,000
MANA WHAI A RĒHIA / RECREATIONAL	Asset Renewals	Network-wide programme to renew furniture, fixtures, roading, tunnels, water lines, stormwater lines and other assets	\$720,000	\$860,000	\$1,000,000
MANA HONONGA TANGATA/LIVING CONNECTION	Visitor Information	Programme to explore opportunities for visitor centre, community hub or education centre on the Maunga	\$50,000	\$1,650,000	\$1,500,000
	Monitoring	Network-wide programme to investigate options for monitoring strategy	\$200,000	\$200,000	\$200,000
WHAI RAWA WHAKAUKA/ ECONOMIC/ COMMERCIAL	Commercial Building renewal	Network-wide programme to maintain commercial buildings on the Maunga	\$150,000	\$600,000	\$200,000

OPERATIONAL EXPENDITURE PROGRAMME

There are a number of programmes that require further project planning to determine how they will be applied to each Maunga. Once this has occurred, the individual Maunga sections will be updated at the next available opportunity.

PROJECT	DESCRIPTION	2026/27	2027/28	2028/29
Consents processing, and RMA Rōpū	Professional services to support the RMA Rōpū and Resource Consent and Heritage NZ applications not associated with the capital expenditure programme	\$36,641	\$37,374	\$38,122
Green By Nature Full Facilities Maintenance Contract	Annual Management Fee, Annual Response Works over \$1,000 and Sportsfields Renovations	\$449,766	\$458,762	\$467,937
General consulting and engagement	Technical and landowner input into projects and programmes	\$67,514	\$68,864	\$70,241
Insurance	Associations Insurance	\$10,200	\$10,404	\$10,612
Maunga information and research	Development and enhancement of Maunga information and communications to promote cultural and environmental significance of Maunga. Monitoring and research to better understand expectations, experiences and impacts on mana whenua, visitors and local community.	\$59,112	\$60,295	\$61,501
Events and Activations	Providing Love Your Maunga events, facilitating activations and supporting other events including exploring opportunities such as sports tournaments, cultural, environmental, creative, community, and commercial wānanga.	\$87,206	\$88,950	\$90,729
Management planning	Completing, the individual Tūpuna Maunga plans and concessions framework, progressing the UNESCO World Heritage Bid, contiguous land analysis and other planning projects identified in these documents.	\$79,594	\$65,088	\$94,669
Pest control equipment	Equipment to support the pest control programme	\$5,645	\$5,747	\$5,850
Volunteers and partnerships	Strengthening and expanding the volunteer programme	\$25,000	\$25,000	\$25,000
Kaitiaki Programme and Mana Whenua Connection	Enabling Mana Whenua role as kaitiaki over the Tūpuna Maunga, support building capacity and capability to deliver Mana Whenua led activities, restoring customary practices and sharing histories.	\$71,971	\$72,266	\$74,731

Education	Developing educational resources and establishing partnerships with communities of learning	\$54,504	\$55,594	\$56,706
Security	Static Guards and Patrols to reduce public risks and increase the security in all Maunga	\$105,616	\$107,728	\$108,883
Monitoring	Implement monitoring of Maunga ecosystems	\$40,000	\$40,000	\$40,000



MATUKUTŪRURU / WIRI MOUNTAIN

IWI /
HAPŪ INTERESTS:

Ngāi Tai ki Tāmaki

Ngāti Maru

Ngāti Tamaoho

Ngāti Tamaterā

Ngāti Te Ata

Ngāti Whanaunga

Ngāti Whātua Ōrakei

Ngāti Whātua o Kaipara

Te Ākitai Waiohua

Te Kawerau ā Maki

LOCAL BOARD AREA:

Manurewa Local Board

RESERVE
CLASSIFICATION:

Historic Reserve

LEGAL DESCRIPTION:

Section 1 & 2 SO38228

MATUKUTŪRURU / WIRI MOUNTAIN

CAPITAL EXPENDITURE PROGRAMME

VALUE	PROJECT	DESCRIPTION	2026/27	2027/28	2028/29
MANA AOTŪROA/ CULTURAL AND HERITAGE	Interpretation and wayfinding signs	Network wide programme to develop comprehensive site- specific interpretation and wayfinding signage	X	\$50,000	X
	Storytelling and Cultural Infrastructure	Network-wide programme to develop unique infrastructure that bring Mana Whenua stories and values to life on the Maunga	X	X	X
TAKORANGA / LANDSCAPE	Protection and restoration of integrity of the Tūpuna Maunga	Vegetation removal, revegetation and stream/wetland restoration	X	X	X
	Pest proof fence	Establish fencing to create pest proof areas on the Maunga	\$0	\$800,000	X
WHAI RAWA WHAKAUKA/ ECONOMIC/ COMMERCIAL	Building renewals	Network-wide programme to maintain building assets – actions and staging to be confirmed	\$50,000	\$100,000	\$500,000
MANA WHAI A RĒHIA / RECREATIONAL	Ancillary visitor infrastructure	Programme to provide welcoming entranceways, complete stage 2 car park extension	\$0	\$0	\$300,000

Note: X indicates that this is part of a network-programme

MATUKUTŪRURU / WIRI MOUNTAIN

OPERATIONAL EXPENDITURE PROGRAMME

VALUE	PROJECT		2026/27	2027/28	2028/29
MAURI PŪNAHA HAUROPI / ECOLOGY AND BIODIVERSITY	Pest Management	Undertake animal and plant pest control	\$21,474	\$21,903	\$22,342
	Pest Proof Fencing Management	Maintenance of pest proof fencing	\$100,000	\$100,000	\$100,000
MANA HONONGA TANGATA / LIVING CONNECTIONS	Volunteers and Partners	Continue to build strong working relationships with partners such as the Department of Conservation and Corrections	X	X	X

Note: X indicates that this is part of a network-programme

CONTRACTS

CONTRACTOR	DESCRIPTION	CONTRACT VALUE	PERIOD COVERED
Green By Nature	Full facilities maintenance – annual scheduled works and response under \$1000	\$9,646	2026/27
	Track maintenance	\$10,200	2026/27

Note: these figures are subject to the outcome of future contract negotiations



MAUNGAKIEKIE / ONE TREE HILL

IWI / HAPŪ INTERESTS:

Ngāi Tai ki Tāmaki

Ngāti Maru

Ngāti Pāoa

Ngāti Tamaoho

Ngāti Tamaterā

Ngāti Te Ata

Ngāti Whanaunga

Ngāti Whātua o Kaipara

Ngāti Whātua Ōrakei

Te Ākitai Waiohua

Te Kawerau ā Maki

Te Patukirikiri

Te Rūnanga o

Ngāti Whātua

LOCAL BOARD AREA:

Maungakiekie – Tāmaki
Local Board

RESERVE CLASSIFICATION:

Recreation Reserve

LEGAL DESCRIPTION:

40.3168 hectares Part
Allotment 11 Section 12
Suburbs of Auckland

6.1462 hectares Allotment
54 Section 12
Suburbs of Auckland

2.5596 hectares Part
Allotment 11 Section 12
Suburbs of Auckland

MAUNGAKIEKIE / ONE TREE HILL

CAPITAL EXPENDITURE PROGRAMME

VALUE	PROJECT	DESCRIPTION	2026/27	2027/28	2028/29
MANA AOTŪROA / CULTURAL & HERITAGE	Interpretation and wayfinding signs	Network wide programme to develop comprehensive site-specific interpretation and wayfinding signage	X	X	X
	Storytelling and cultural infrastructure	Network-wide programme to develop unique infrastructure that bring mana whenua stories and values to life on the maunga	X	X	X
TAKOTORANGA / LANDSCAPE	Protection and restoration of integrity of the tūpuna maunga	Network-wide programme to remove vegetation and reinstate and/or revegetate	X	X	X
		Programme to provide welcoming entranceways and remove redundant infrastructure	\$0	\$100,000	\$500,000
MANA WHAI A RĒHIA / RECREATIONAL	Ancillary visitor infrastructure	Redevelop playground to create a bespoke play space inspired by the landscape and the stories associated with the maunga and māori culture	\$150,000	\$800,000	\$900,000
		Upgrade of wharepaku / toilets and other visitor infrastructure	\$150,000	\$250,000	\$0
		Develop bus parking infrastructure at haydn ave	\$50,000	\$50,000	\$1,100,000
		Reservoir repurposing contribution	\$0	\$0	\$60,000

Note: X indicates that this is part of a network-programme

MAUNGAKIEKIE / ONE TREE HILL

OPERATIONAL EXPENDITURE PROGRAMME

VALUE	PROJECT	DESCRIPTION	2026/27	2027/28	2028/29
MAURI PŪNAHA HAUROPI / ECOLOGY AND BIODIVERSITY	Pest Management	Undertake animal and plant pest control	\$7,740	\$7,895	8,052
	Vegetation Management	Annual Vegetation Maintenance programme Tihi planting maintenance programme	\$8,941	\$9,320	\$9,507
MANA HONONGA TANGATA / LIVING CONNECTIONS	Volunteers and Partners	Continue to build strong working relationships with partners across the Maunga	X	X	X
	Building Maintenance associated costs	Sorrento Function Centre Stardome Observatory Woolshed 3 x Toilet Facilities Tenanted building	\$24,662	\$25,155	\$25,658
	Water /Electricity Expenses	Expenses relating to stock and toilets	\$8,874	\$9,052	\$9,233
WHAI RAWA WHAKAUKA / ECONOMIC AND COMMERCIAL	Commercial Operators	Formalise agreements with commercial operators on the Maunga	X	X	X

Note: X indicates that this is part of a network-programme

MAUNGAKIEKIE / ONE TREE HILL

CONTRACTS

CONTRACTOR	DESCRIPTION	CONTRACT VALUE	PERIOD COVERED
Green By Nature	Full facilities maintenance – annual scheduled Works and response under \$1000	\$212,678	2026/27
	Track maintenance	\$8,160	2026/27

Note: these figures are subject to the outcome of future contract negotiations

LEASES

LEASE HOLDER	ACTIVITY TYPE	LEASE STATUS / TERM	ANNUAL FEE	LEASE EXPIRY DATE
Private residential	Residential tenancy (cottage)	Until either party terminates this agreement	\$26,520 + GST	Annually reviewed
Auckland Observatory & Planetarium	Public observatory and planetarium	1 x 5-year initial term with 2 x 5 years right of renewal	\$24,150 + GST	Final Expiry 31 Dec 34
Sorrento Group	Restaurant	1 x 5-year initial term with 2 x 5 years right of renewal, 1x2 year extension, 2x4 year extension	\$152,930 + GST	Final expiry 20 Feb 2034
Auckland Archery Club	Community activity (sports)	1-year initial term	\$3,150 + GST	30 November 2023
Watercare Services Ltd	2 x reservoirs & associated activities	Expired currently on a month-by-month renewal	\$0.00	27 Jan 2986
TOTAL REVENUE PER ANNUM:			\$206,750 + GST	



MAUNGAREI / MT WELLINGTON

IWI / HAPŪ INTERESTS:

- Ngāi Tai ki Tāmaki
- Ngāti Maru
- Ngāti Pāoa
- Ngāti Tamaoho
- Ngāti Tamaterā
- Ngāti Te Ata
- Ngāti Whanaunga
- Ngāti Whātua Ōrakei
- Ngāti Whātua o Kaipara
- Te Ākitai Waiohua
- Te Kawerau ā Maki
- Te Patukirikiri
- Te Rūnanga o Ngāti Whātua

LOCAL BOARD AREA:

Maungakiekie – Tāmaki
Local Board

RESERVE CLASSIFICATION:

Local Purpose Reserve
sub section (1);
Recreation Reserve sub
section (2)

LEGAL DESCRIPTION:

23.4346 hectares Part
Allotment 56 Section 12
Suburbs of Auckland

0.5084 hectares Part
Allotment 64 Section 12
Suburbs of Auckland

2.1064 hectares Allotment
200 Section 12
Suburbs of Auckland

0.7001 hectares Part
Allotment 64 Section 12
Suburbs of Auckland

1.0813 hectares Allotment
201 Section 12
Suburbs of Auckland

MAUNGAREI / MT WELLINGTON

CAPITAL EXPENDITURE PROGRAMME

VALUE	PROJECT	DESCRIPTION	2026/27	2027/28	2028/29
MANA AOTŪROA / CULTURAL & HERITAGE	Storytelling and Cultural Infrastructure	Programme to develop unique infrastructure that bring Mana Whenua stories and values to life on the Maunga	\$4,800,000	\$0	\$0
TAKOTORANGA / LANDSCAPE	Protection and restoration of integrity of the Tūpuna Maunga	Network-wide programme to remove vegetation and revegetate	X	X	X
	Boundary Stone Walls	Renew boundary stone walls	\$0	\$60,000	\$350,000
	Quarry Wall	Stabilise quarry face	\$60,000	\$200,000	\$0

Note: X indicates that this is part of a network-programme

MAUNGAREI /
MT WELLINGTON

OPERATIONAL EXPENDITURE PROGRAMME

VALUE	PROJECT	DESCRIPTION	2026/27	2027/28	2028/29
MAURI PŪNAHA HAUROPI / ECOLOGY AND BIODIVERSITY	Pest Management	Undertake animal and plant pest control	\$25,000	\$25,500	\$26,010
	Plant Maintenance	Maintenance of planted areas	\$15,000	\$15,000	\$15,000
	Vegetation Management	Annual Vegetation Maintenance programme	\$8,906	\$9,284	\$9,469
MANA HONGA TANGATA / LIVING CONNECTIONS	Volunteers and Partners	Continue to build strong working relationships with partners across the Maunga	X	X	X
	Water /Electricity Expenses	Expenses relating to gates and toilets	\$4,663	\$4,756	\$4,852
WHAI RAWA WHAKAUKA / ECONOMIC AND COMMERCIAL	Commercial Operators	Formalise agreements with commercial operators on the Maunga	X	X	X
MANA WHAI A RĒHIA / RECREATIONAL	Events and Activations	Activate Māori sports programme	X	X	X
TAKATORANGA WHENUA / LANDSCAPE	Perimeter Firebreaks	Continuation of firebreaks programme to reduce risk of fire in sensitive areas*	\$12,376	\$12,623	\$12,876

Note: X indicates that this is part of a network-programme

*Cost factored into maintenance contract

MAUNGAREI / MT WELLINGTON

CONTRACTS

CONTRACTOR	DESCRIPTION	CONTRACT VALUE	PERIOD COVERED
Green By Nature	Full facilities maintenance - annual scheduled works and response under \$1000	\$112,412	2026/27
	Track maintenance	\$25,536	2026/27

Note: these figures are subject to the outcome of future contract negotiations

LEASES

LEASE HOLDER	ACTIVITY TYPE	LEASE STATUS / TERM	ANNUAL FEE	LEASE EXPIRY DATE
Mt Wellington Roller Skating Club	Community activity (skating & indoor Sports)	1 x 5 year initial term with 1 x 5 years right of renewal	\$11,800 + GST	Final expiry 31 Dec 2034
Auckland Council	Council Depot	Agreement document to be developed	\$0.00	
Watercare Services Ltd	2 x reservoirs & associated infrastructure	In perpetuity	\$0.00	

TOTAL REVENUE PER ANNUM:





MAUNGAUIKA / NORTH HEAD

IWI / HAPŪ INTERESTS:

Ngāi Tai ki Tāmaki

Ngāti Maru

Ngāti Pāoa

Ngāti Tamaoho

Ngāti Tamaterā

Ngāti Te Ata

Ngāti Whanaunga

Ngāti Whātua o Kaipara

Ngāti Whātua Ōrakei

Te Ākitai Waiohua

Te Kawerau ā Maki

Te Patukirikiri

Te Rūnanga o Ngāti
Whātua

LOCAL BOARD AREA:

Devonport-Takapuna

RESERVE CLASSIFICATION:

Historic Reserve

LEGAL DESCRIPTION:

8.5995 hectares
approximately, being
Allotment 36 Section 2
Parish of Takapuna

MAUNGAUIKA / NORTH HEAD

CAPITAL EXPENDITURE PROGRAMME

VALUE	PROJECT	DESCRIPTION	2026/27	2027/28	2028/29
WAIRUATANGA / SPIRITUAL	Interpretation and Wayfinding storytelling	Network wide programme to develop comprehensive site-specific interpretation and wayfinding signage	X	X	X
MANA AOTŪROA / CULTURAL & HERITAGE	Asset restoration	Restoration of historic assets on the Maunga	\$50,000	\$330,000	\$650,000
TAKOTORANGA / LANDSCAPE	Protection and restoration of integrity of the Tūpuna Maunga	Network-wide programme to remove vegetation and revegetate	X	X	X
		Depot stormwater remediation	\$150,000	\$50,000	\$0

Note: X indicates that this is part of a network-programme

MAUNGAUIKA / NORTH HEAD

OPERATIONAL EXPENDITURE PROGRAMME

VALUE	PROJECT	DESCRIPTION	2026/27	2027/28	2028/29
TAKOTORANGA / LANDSCAPE	Geotechnical Monitoring	Monitoring of integrity of coastal cliff	\$6,630	\$6,763	\$6,898
	Tunnel Maintenance	Annual inspections to ensure integrity and safety of tunnels	\$6,500	\$6,500	\$6,500
MAURI PŪNAHA HAUROPI / ECOLOGY AND BIODIVERSITY	Pest Management	Undertake animal and plant pest control	\$30,000	\$30,600	\$31,212
MANA HONONGA TANGATA / LIVING CONNECTIONS	Volunteers and Partners	Continue to build strong working relationships with partners such as the Department of Conservation and community groups	X	X	X
WHAI RAWA WHAKAUKA / ECONOMIC AND COMMERCIAL	Commercial Operators	Formalise agreements with commercial operators on the Maunga	X	X	X

Note: X indicates that this is part of a network-programme

MAUNGAUIKA / NORTH HEAD

CONTRACTS

A variation to the Green By Nature full facilities maintenance contract hasn't been negotiated yet. This section will be updated when this is finalised.

CONTRACTOR	DESCRIPTION	CONTRACT VALUE	PERIOD COVERED
Green By Nature	Full facilities maintenance - annual scheduled works and response under \$1000	\$206,453	2026/27
	Track maintenance	\$18,612	2026/27

LEASES / CONCESSIONS

LEASE / CONCESSION HOLDER	ACTIVITY TYPE	LEASE / CONCESSION STATUS / TERM	ANNUAL FEE	LEASE / CONCESSION EXPIRY DATE
Department of Conservation	Buildings in area C1 & C2 as shown in OTS-115-12 Map	Undefined	\$0	By notice by Department of Conservation
Bigfoot Adventures Limited	Guiding	10 year	\$0	14 December 2025
TOTAL REVENUE PER ANNUM:			\$0	



MAUNGAWHAU / MT EDEN

IWI / HAPŪ INTERESTS:

Ngāi Tai ki Tāmaki

Ngāti Maru

Ngāti Pāoa

Ngāti Tamaoho

Ngāti Tamaterā

Ngāti Te Ata

Ngāti Whanaunga

Ngāti Whātua o Kaipara

Ngāti Whātua Ōrakei

Te Ākitai Waiohua

Te Kawerau ā Maki

Te Patukirikiri

Te Rūnanga o Ngāti Whātua

LOCAL BOARD AREA:

Albert – Eden Local Board 0.0685 hectares Allotment
121 Section 6 Suburbs of
Auckland

RESERVE CLASSIFICATION:

Historic Reserve sub
section (1) 0.064 hectares Part
Allotment 53 Section 6
Suburbs of Auckland

Recreation Reserve sub
section (2) 0.0599 hectares Lot 3 DP
31644

LEGAL DESCRIPTION:

10.4900 hectares Part
Allotment 1A Section 6
Suburbs of Auckland 0.1445 hectares Part
Section 6
Suburbs of Auckland

16.1150 hectares Part
Allotment 1A Section 6
Suburbs of Auckland 0.1547 hectares Section 1
SO 63939

MAUNGAWHAU / MT EDEN

CAPITAL EXPENDITURE PROGRAMME

VALUE	PROJECT	DESCRIPTION	2026/27	2027/28	2028/29
MANA AOTŪROA / CULTURAL & HERITAGE	Storytelling and Cultural Infrastructure	Network-wide programme related to Information Centres across the network	X	X	X
	Interpretation and Wayfinding signs	Network wide programme to develop comprehensive site- specific interpretation and wayfinding signage	X	X	X
	Storytelling and Cultural Infrastructure	Network-wide programme to develop unique infrastructure that bring Mana Whenua stories and values to life on the Maunga	\$50,000	\$120,000	X
TAKOTORANGA / LANDSCAPE	Quarry wall	Mitigation of potential quarry wall failure	\$150,000	\$0	\$0
	Track Renewal	Renewal and review design of batger quarry track	\$200,000	\$0	\$0
MANA WHAI A RĒHIA / RECREATIONA L	Ancillary visitor infrastructure	Improve access and circulation	\$0	\$0	\$240,000
	Ancillary visitor infrastructure	Tāhaki reserve lighting renewal	\$100,000	\$0	\$0

Note: X indicates that this is part of a network-programme

MAUNGAWHAU / MT EDEN

OPERATIONAL EXPENDITURE PROGRAMME

VALUE	PROJECT	DESCRIPTION	2026/27	2027/28	2028/29
MAURI PŪNAHA HAUROPI / ECOLOGY AND BIODIVERSITY	Pest Management	Undertake animal and plant pest control	\$33,683	\$34,357	\$35,044
	Vegetation Management	Annual Vegetation Maintenance programme including the maintenance of view shafts around tihi & kiosk	\$4,646	4,939	\$5,037
	Nursery management	Annual nursery management	\$5,000	\$5,000	\$5,000
	Volunteers and Partners	Continue to build strong working relationships with the FOM & partners across the Maunga & including the restoration planting on the lower slopes	X	X	X
MANA HONONGA TANGATA / LIVING CONNECTIONS	Water /Electricity Expenses		\$15,001	\$15,301	\$15,607
	Building Maintenance associated costs	Kiosk Nursery & associated buildings Toilets Tenanted building	\$35,064	\$35,771	\$36,486
WHAI RAWA WHAKAUKA / ECONOMIC AND COMMERCIAL	Commercial Operators	Formalise current commercial operators operating on the Maunga	X	X	X
MANA WHAI A RĒHIA / RECREATIONAL	Events and Activations	Activate Māori sports programme	X	X	X
TAKATORANGA WHENUA / LANDSCAPE	Perimeter Firebreaks	Continuation of firebreaks programme to reduce risk of fire in sensitive areas*	\$14,038	\$14,318	\$14,605
	Structural Monitoring	Tiltmeter and other geotechnical monitoring	\$4,008	\$4,162	\$4,245

Note: X indicates that this is part of a network-programme
*Cost factored into maintenance contract

MAUNGAWHAU / MT EDEN

CONTRACTS

CONTRACTOR	DESCRIPTION	CONTRACT VALUE	PERIOD COVERED
Green By Nature	Full facilities maintenance - annual scheduled works and response under \$1000	\$284,590	2026/27
	Track maintenance	\$71,183	2026/27

Note: these figures are subject to the outcome of future contract negotiations

LEASES

LEASE HOLDER	ACTIVITY TYPE	LEASE STATUS / TERM	ANNUAL FEE	LEASE EXPIRY DATE
Watercare Services Ltd	2 x reservoirs and associated infrastructure	In perpetuity	\$0.00	
Maungawhau Cottage	Residential tenancy	Fixed term tenancy	\$28,600	As per tenancy agreement
Braemar Hospitality Limited	Food premises	1 year initial term with 2 x 2 years right of renewal	50%profit share	Final expiry date 30 June 2027
Youthtown	Community facility	5 year initial term with 1x5 years right of renewal	\$0.00	Final expiry date 30 September 2029
TOTAL REVENUE PER ANNUM:			\$28,600	

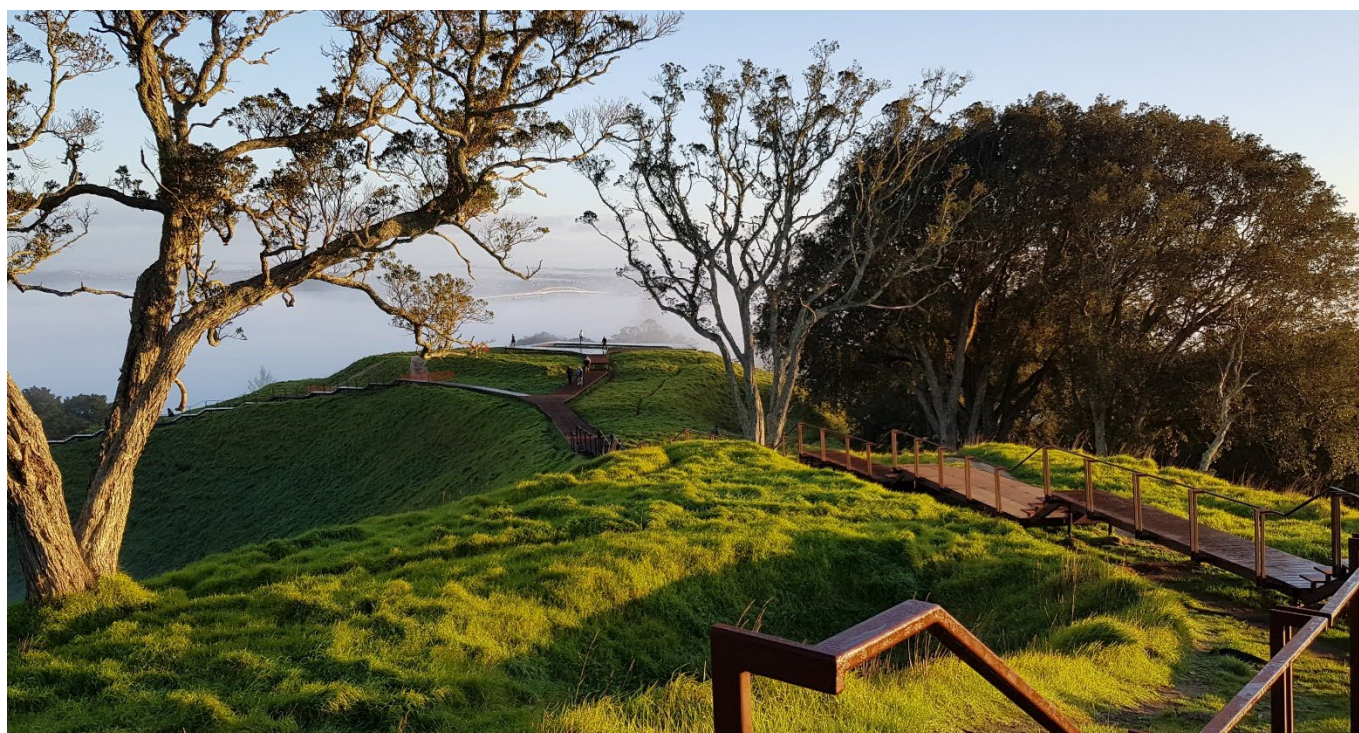



ŌHINERAU / MT HOBSON

IWI / HAPŪ INTERESTS:

Ngāi Tai ki Tāmaki

Ngāti Maru

Ngāti Tamaoho

Ngāti Tamaterā

Ngāti Te Ata

Ngāti Whanaunga

Ngāti Whātua o Kaipara

Ngāti Whātua Ōrakei

Te Ākitai Waiohua

Te Kawerau ā Maki

Te Patukirikiri

Te Rūnanga o Ngāti Whātua

LOCAL BOARD AREA:

Ōrakei Local Board

RESERVE CLASSIFICATION:

Recreation Reserve

LEGAL DESCRIPTION:

9.4089 hectares
Allotment 2A Section 11
Suburbs of Auckland

ŌHINERAU / MT HOBSON

CAPITAL EXPENDITURE PROGRAMME

VALUE	PROJECT	DESCRIPTION	2026/27	2027/28	2028/29
MANA AOTŪROA / CULTURAL & HERITAGE	Interpretation and Wayfinding	Prepare and implement network wide programme to develop comprehensive site-specific interpretation and wayfinding signage	X	X	X
TAKOTORANGA / LANDSCAPE	Protection and restoration of integrity of the Tūpuna Maunga	Network-wide programme to remove vegetation and revegetate	X	X	X
	Quarry wall	Improve quarry stability	X	X	\$100,000
MAURI PŪNAHA HAUROPI / ECOLOGY AND BIODIVERSITY	Traditional Cultivation	Network-wide programme to establish gardens based on Matauranga Māori such as māra kai, rongoa and pā harakeke	\$0	\$0	\$40,000

Note: X indicates that this is part of a network-programme

ŌHINERAU / MT HOBSON

OPERATIONAL EXPENDITURE PROGRAMME

VALUE	PROJECT	DESCRIPTION	2026/27	2027/28	2028/29
MAURI PŪNAHA HAUROPI / ECOLOGY AND BIODIVERSITY	Pest Management	Undertake animal and plant pest control	\$28,559	\$29,131	\$29,713
	Plant Maintenance	Maintenance of planted areas	\$5,000	\$5,000	\$5,000
	Vegetation Management	Annual Vegetation Maintenance programme including control of dutch elms and mature vegetation along Remuera Rd	\$3,462	\$3,831	\$3,908
WHAI RAWA WHAKAUKA / ECONOMIC AND COMMERCIAL	Commercial Operators	Formalise agreements with commercial operators on the Maunga	X	X	X
MANA WHAI A RĒHIA / RECREATIONAL	Events and Activations	Activate Māori sports programme	X	X	X
TAKATORANGA WHENUA / LANDSCAPE	Perimeter Firebreaks	Continuation of firebreaks programme to reduce risk of fire in sensitive areas*	\$10,000	\$10,200	\$10,404

Note: X indicates that this is part of a network-programme
*Cost factored into maintenance contract

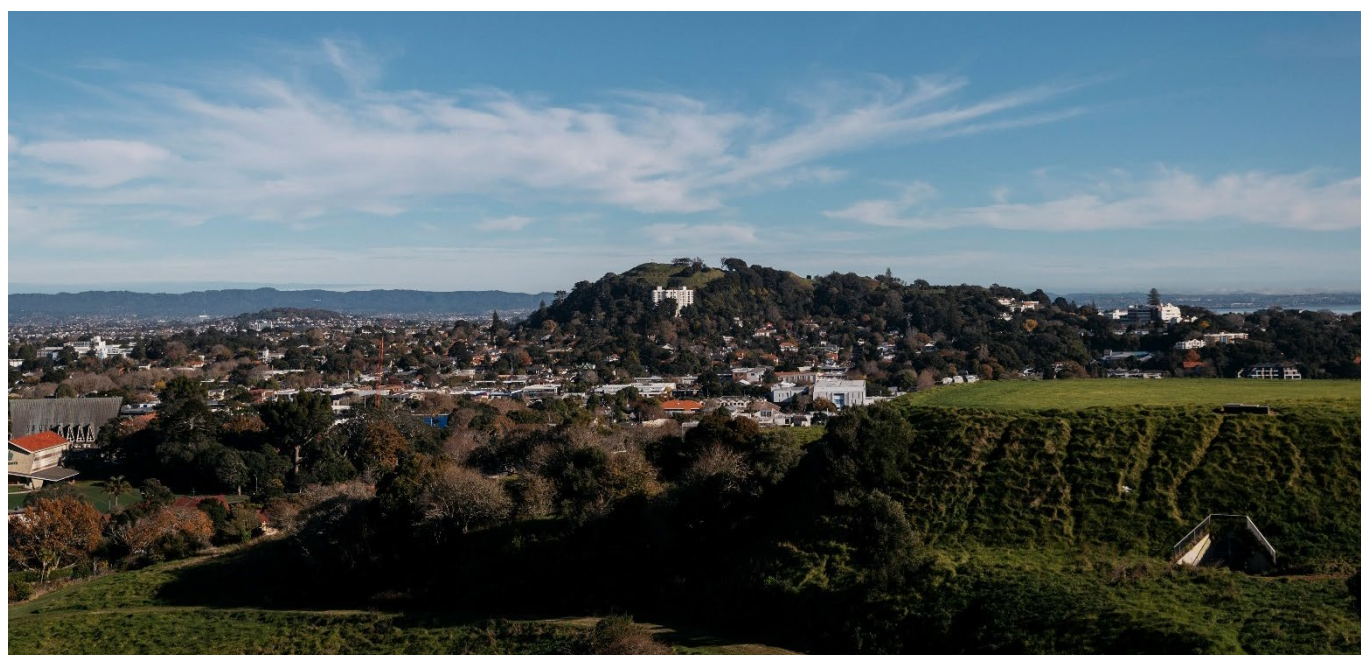

ŌHINERAU / MT HOBSON

CONTRACTS

CONTRACTOR	DESCRIPTION	CONTRACT VALUE	PERIOD COVERED
Green By Nature	Full facilities maintenance - annual scheduled works and response under \$1000	\$57,402	2026/27
	Track maintenance	\$16,792	2026/27

Note: these figures are subject to the outcome of future contract negotiations

LEASES

LEASE HOLDER	ACTIVITY TYPE	LEASE STATUS / TERM	ANNUAL FEE	LEASE EXPIRY DATE
Watercare Services Ltd	1 x reservoir& associated activities	In perpetuity	\$0.00	
TOTAL REVENUE PER ANNUM:			\$0.00 + GST	





ŌHUIARANGI / PIGEON MOUNTAIN

IWI / HAPŪ INTERESTS:

Ngāi Tai ki Tāmaki

Ngāti Maru

Ngāti Tamaoho

Ngāti Tamaterā

Ngāti Te Ata

Ngāti Whanaunga

Ngāti Whātua o Kaipara

Ngāti Whātua Ōrakei

Te Ākitai Waiohūa

Te Kawerau ā Maki

Te Patukirikiri

LOCAL BOARD AREA:

Howick Local Board

RESERVE CLASSIFICATION:

Historic Reserve sub
section (1)

Local Purpose Reserve sub
section (2)

Recreation Reserve sub
section (3)

LEGAL DESCRIPTION:

3.2314 hectares Part
Allotment 18 Section 5

small farms near Howick

1.0358 hectares Part
Allotment 22 Section 5
small farms near Howick

3.4035 hectares Section 5
SO 434440

3.5763 hectares Section 6
SO 43440

ŌHUIARANGI / PIGEON MOUNTAIN

CAPITAL EXPENDITURE PROGRAMME

VALUE	PROJECT	DESCRIPTION	2026/27	2027/28	2028/29
MANA AOTŪROA / CULTURAL & HERITAGE	Interpretation and Wayfinding signs	Prepare and implement network wide programme to develop comprehensive site-specific interpretation and wayfinding signage	\$150,000	X	X
	Storytelling and Cultural Infrastructure	Network-wide programme to develop unique infrastructure that bring Mana Whenua stories and values to life on the Maunga	X	X	X
TAKOTORANGA / LANDSCAPE	Protection and restoration of integrity of the Tūpuna Maunga	Network-wide programme to remove vegetation and revegetate	X	X	X
	Protection and restoration of integrity of the Tūpuna Maunga	Programme to provide welcoming entranceways and remove redundant infrastructure	\$280,000	\$0	\$0
MANA WHAI A RĒHIA / RECREATIONAL	Asset Renewals	Programme to maintain and repurpose assets on the Maunga	\$0	\$80,000	\$350,000
MAURI PŪNAHA HAUROPI / ECOLOGY AND BIODIVERSITY	Traditional Cultivation	Network-wide programme to establish gardens based on Matauranga Māori such as māra kai, rongoa and pā harakeke	\$0	\$0	\$40,000

Note: X indicates that this is part of a network-programme

ŌHUIARANGI / PIGEON MOUNTAIN

OPERATIONAL EXPENDITURE PROGRAMME

The contract for maintenance has been awarded to Green By Nature. A programme has been established for community groups supporting weeding on the Maunga.

VALUE	PROJECT	DESCRIPTION	2026/27	2027/28	2028/29
MAURI PŪNAHA HAUROPI / ECOLOGY AND BIODIVERSITY	Pest Management	Undertake animal and plant pest control	\$12,536	\$12,786	\$13,042
	Plant Maintenance	Maintenance of planted areas	\$10,000	\$10,000	\$10,000
	Vegetation Management	Annual Vegetation Maintenance programme	\$8,906	\$9,284	\$9,469
MANA HONONGA TANGATA / LIVING CONNECTIONS	Volunteers and Partners	Continue to build strong working relationships with partners across the Maunga	X	X	X
	Building Maintenance associated costs	Toilets and leased buildings	\$12,355	\$12,602	\$12,854
	Water /Electricity Expenses	Expenses relating to toilets	\$5,453	\$5,562	\$5,673
WHAI RAWA WHAKAUKA / ECONOMIC AND COMMERCIAL	Commercial Operators	Formalise agreements with commercial operators on the Maunga	X	X	X

Note: X indicates that this is part of a network-programme

ŌHUIARANGI / PIGEON MOUNTAIN

CONTRACTS

A variation to the Green By Nature full facilities maintenance contract hasn't been negotiated yet. This section will be updated when this is finalised.

CONTRACTOR	DESCRIPTION	CONTRACT VALUE	PERIOD COVERED
Green By Nature	Full facilities maintenance - annual scheduled works and response under \$1000	\$132,465	2026/27
	Track maintenance	\$7,140	2026/27

Note: these figures are subject to the outcome of future contract negotiations

LEASES / CONCESSIONS

LEASE / CONCESSION HOLDER	ACTIVITY TYPE	LEASE / CONCESSION STATUS / TERM	ANNUAL FEE	LEASE / CONCESSION EXPIRY DATE
Pakuranga United Rugby Football Club	Community activity (sport)	Informal arrangement for training (using the fields & night lighting)	\$0.00	Informal arrangement
Auckland Kindergarten Association	Community activity (preschool)	5 year term and 5 year renewal	\$6,300, + GST	Final expiry 30 June 2030
Pakuranga Tennis Club	Community activity (sport)	3 year initial term with 1 x 2 years right of renewal	\$14,000 + GST	Final expiry 30 June 2025
Pigeon Mountain Scout Association	Community activity	4 year term	\$4,320 + GST	30 April 2027
Watercare Services Ltd	Reservoir & associated infrastructure	In perpetuity	\$0.00	

TOTAL REVENUE PER ANNUM: \$24,620 + GST



ŌTĀHUHU / MT RICHMOND

IWI / HAPŪ INTERESTS:

Ngāi Tai ki Tāmaki

Ngāti Maru

Ngāti Pāoa

Ngāti Tamaoho

Ngāti Tamaterā

Ngāti Te Ata

Ngāti Whanaunga

Ngāti Whātua o Kaipara

Ngāti Whātua Ōrakei

Te Ākitai Waiohua

Te Kawerau ā Maki

Te Patukirikiri

Te Rūnanga o Ngāti Whātua

LOCAL BOARD AREA:

Maungakiekie – Tāmaki
Local Board

RESERVE CLASSIFICATION:

Recreation Reserve

LEGAL DESCRIPTION:

16.5921 hectares Part
Allotment 60 and Parts
Allotment 61 Section 12
Suburbs of Auckland

0.0582 hectares Part
Hamlin's Grant Bert Henham
Reserve

4.3954 hectares Part Lot 10
DP 47429

CAPITAL EXPENDITURE PROGRAMME

VALUE	PROJECT	DESCRIPTION	2026/27	2027/28	2028/29
MANA AOTŪROA / CULTURAL & HERITAGE	Interpretation and Wayfinding signs	Network-wide programme to develop comprehensive site- specific interpretation and wayfinding signage	X	X	X
	Storytelling and Cultural Infrastructure	Network-wider programme to develop unique infrastructure that brings Mana Whenua stories and values to life on the Maunga	X	X	X
TAKOTORANG A / LANDSCAPE	Protection and restoration of integrity of the Tūpuna Maunga	Network-wide programme to remove vegetation and revegetate	X	X	X
MANA WHAI A RĒHIA / RECREATIONA L	Ancillary visitor infrastructure	Develop māra hūpara trail to interpret the landscape and the stories associated with the Maunga	\$20,000	\$200,000	\$800,000
	Ancillary visitor infrastructure	Complete car park security gate	\$0	\$0	\$280,000
	Asset Renewals	Network-wide programme to maintain building assets	\$220,000	\$0	\$0

Note: X indicates that this is part of a network-programme

OPERATIONAL EXPENDITURE PROGRAMME

The contract for maintenance has been awarded to Green By Nature. A programme has been established for community groups supporting weeding on the Maunga.

VALUE	PROJECT	DESCRIPTION	2026/27	2027/28	2028/29
MAURI PŪNAHA HAUROPI / ECOLOGY AND BIODIVERSITY	Pest Management	Undertake animal and plant pest control	\$22,595	\$23,016	\$23,476
	Plant Maintenance	Maintenance of planted areas	\$20,000	\$20,000	\$20,000
	Vegetation Management	Annual Vegetation Maintenance programme	\$8,081	\$8,502	\$8,672
MANA HONONGA TANGATA /LIVING CONNECTIONS	Volunteers and Partners	Continue to build strong working relationships with partners across the Maunga	X	X	X
	Water /Electricity Expenses	Expenses relating to toilets	\$9,702	\$9,896	\$10,094
WHAI RAWA WHAKAUKA / ECONOMIC AND COMMERCIAL	Commercial Operators	Formalise agreements with commercial operators on the Maunga	X	X	X

Note: X indicates that this is part of a network-programme

ŌTĀHUHU / MT RICHMOND

CONTRACTS

A variation to the Green By Nature full facilities maintenance contract hasn't been negotiated yet. This section will be updated when this is finalised.

CONTRACTOR	DESCRIPTION	CONTRACT VALUE	PERIOD COVERED
Green By Nature	Full facilities maintenance - annual scheduled works and response under \$1000	\$215,762	2026/27

Note: these figures are subject to the outcome of future contract negotiations

LEASES / CONCESSIONS

LEASE / CONCESSION HOLDER	ACTIVITY TYPE	LEASE / CONCESSION STATUS / TERM	ANNUAL FEE	LEASE / CONCESSION EXPIRY DATE
Otāhuhu Rovers Rugby League Football Club	Community activity (sports)	1x5 year term with 2x5 year renewal	\$5,150 + GST	Final expiry 31 Aug 2023
Watercare Services Ltd	Reservoirs & associated infrastructure	In perpetuity	\$0.00	

TOTAL REVENUE PER ANNUM: \$5,150+ GST





ŌWAIRAKA / TE AHI-KĀ-A-RAKATAURA / MT ALBERT

IWI / HAPŪ INTERESTS:

Ngāi Tai ki Tāmaki

Ngāti Maru

Ngāti Pāoa

Ngāti Tamaoho

Ngāti Tamaterā

Ngāti Te Ata

Ngāti Whātua o Kaipara

Ngāti Whātua Ōrakei

Te Ākitai Waiohua

Te Kawerau ā Maki

Te Rūnanga o Ngāti Whātua

LOCAL BOARD AREA:

Albert – Eden Local Board

RESERVE CLASSIFICATION:

Recreation Reserve

LEGAL DESCRIPTION:

3.7660 hectares Part
Allotment 100 Parish of
Titirangi

5.0890 hectares Part
Allotment 100 Parish of
Titirangi

0.6310 hectares Lot 48 DP
39801

0.0290 hectares Part
Allotment 195 Parish of
Titirangi

ŌWAIRAKA / TE AHI-KĀ-A-RAKATAURA / MT ALBERT

CAPITAL EXPENDITURE PROGRAMME

VALUE	PROJECT	DESCRIPTION	2026/27	2027/28	2028/29
MANA AOTŪROA / CULTURAL & HERITAGE	Interpretation and Wayfinding signs	Network wide programme to develop comprehensive site-specific interpretation and wayfinding signage	X	X	X
	Storytelling and Cultural Infrastructure	Network-wide programme to develop unique infrastructure that bring Mana Whenua stories and values to life on the Maunga	X	X	X
TAKOTORANGA / LANDSCAPE	Protection and restoration of integrity of the Tūpuna Maunga	Network-wide programme to remove vegetation and revegetate as per the Integrated Management Plan.	X	X	X
	Protection and restoration of tihi	Tihi redevelopment	\$100,000	\$600,000	\$0

Note: X indicates that this is part of a network-programme

ŌWAIRAKA / TE AHI-KĀ-A-RAKATAURA /
MT ALBERT

OPERATIONAL EXPENDITURE PROGRAMME

VALUE	PROJECT	DESCRIPTION	2026/27	2027/28	2028/29
MAURI PŪNAHA HAUROPI / ECOLOGY AND BIODIVERSITY	Pest Management	Undertake animal and plant pest control	\$17,224	\$17,568	\$17,919
	Plant Maintenance	Maintenance of planted areas	\$10,000	\$10,000	\$10,000
	Vegetation Management	Annual Vegetation Maintenance programme including control of cherry, privet	\$7,921	\$8,179	\$8,343
MANA HONONGA TANGATA / LIVING CONNECTIONS	Volunteers and Partners	Continue to build strong working relationships with partners across the Maunga	X	X	X
	Water / Electricity Expenses		\$4,158	\$4,242	\$4,326
WHAI RAWA WHAKAUKA / ECONOMIC AND COMMERCIAL	Commercial Operators	Formalise agreements with commercial operators on the Maunga	X	X	X
MANA WHAI A RĒHIA / RECREATIONAL	Events and Activations	Activate Māori sports programme	X	X	X
TAKATORANGA WHENUA / LANDSCAPE	Perimeter Firebreaks	Continuation of firebreaks programme to reduce risk of fire in sensitive areas*	\$2,522	\$2,573	\$2,624

Note: X indicates that this is part of a network-programme
*Cost factored into maintenance contract

ŌWAIRAKA / TE AHI-KĀ-A-RAKATAURA / MT ALBERT

CONTRACTS

CONTRACTOR	DESCRIPTION	CONTRACT VALUE	PERIOD COVERED
Green By Nature	Full facilities maintenance - annual scheduled works and response under \$1000	\$97,570	2026/27
	Track maintenance	\$15,300	2026/27

Note: these figures are subject to the outcome of future contract negotiations

LEASES / CONCESSIONS

LEASE / CONCESSION HOLDER	ACTIVITY TYPE	LEASE / CONCESSION STATUS / TERM	ANNUAL FEE	LEASE / CONCESSION EXPIRY DATE
Watercare Services Ltd	Reservoir & associated infrastructure	In perpetuity	\$0.00	

TOTAL REVENUE PER ANNUM:

\$0 + GST





PUKEWĪWĪ / PUKETĀPAPA / MT ROSKILL

IWI / HAPŪ INTERESTS:

Ngāi Tai ki Tāmaki

Ngāti Maru

Ngāti Tamaoho

Ngāti Tamaterā

Ngāti Te Ata

Ngāti Whātua o Kaipara

Ngāti Whātua Ōrakei

Te Ākitai Waiohua

Te Kawerau ā Maki

Te Rūnanga o Ngāti Whātua

LOCAL BOARD AREA:

Puketāpapa Local Board

RESERVE CLASSIFICATION:

Recreation Reserve

LEGAL DESCRIPTION:

8.3259 hectares Part Lot
1476 DP 22826

0.1452 hectares Lots 94 &
211 DP 42694

0.2081 hectares Section 3 SO
430425

0.3922 hectares Lots 103,
106, 107 & 109 DP 41516

PUKEWĪWĪ / PUKETĀPAPA /
MT ROSKILL

CAPITAL EXPENDITURE PROGRAMME

VALUE	PROJECT	DESCRIPTION	2026/27	2027/28	2028/29
MANA AOTŪROA / CULTURAL & HERITAGE	Interpretation and Wayfinding signs	Network wide programme to develop comprehensive site- specific interpretation and wayfinding signage	X	X	
MAURI PŪNAHA HAUROI / ECOLOGY AND BIODIVERSITY	Traditional Cultivation	Network-wide programme to establish gardens based on Matauranga Māori such as māra kai, rongoa and pā harakeke	\$0	\$0	\$80,000
TAKOTORANGA / LANDSCAPE	Protection and restoration of integrity of the Tūpuna Maunga	Network-wide programme to remove vegetation and revegetate	X	X	X
	Protection and restoration of tihi	Tihi redevelopment and install the permanent fence	\$0	\$300,000	\$0
MANA WHAI A RĒHIA / RECREATIONAL	Ancillary visitor infrastructure	Install new wharepaku / toilet	\$50,000	\$200,000	\$0

Note: X indicates that this is part of a network-programme

PUKEWĪWĪ / PUKETĀPAPA / MT ROSKILL

OPERATIONAL EXPENDITURE PROGRAMME

VALUE	PROJECT	DESCRIPTION	2026/27	2027/28	2028/29
MAURI PŪNAHA HAUROPI / ECOLOGY AND BIODIVERSITY	Pest Management	Undertake animal and plant pest control	\$12,318	\$12,564	\$12,815
	Plant Maintenance	Maintenance of planted areas	\$10,000	\$10,000	\$10,000
	Vegetation Management	Annual Vegetation Maintenance programme including control of cherry, privet	\$5,590	\$5,802	\$5,918
MANA HONONGA TANGATA / LIVING CONNECTIONS	Volunteers and Partners	Continue to build strong working relationships with partners across the Maunga	X	X	X
WHAI RAWA WHAKAUKA / ECONOMIC AND COMMERCIAL	Commercial Operators	Formalise agreements with commercial operators on the Maunga	X	X	X

Note: X indicates that this is part of a network-programme

CONTRACTS

CONTRACTOR	DESCRIPTION	CONTRACT VALUE	PERIOD COVERED
Green By Nature	Full facilities maintenance annual scheduled works and response under \$1000	\$51,121	2026/27

Note: these figures are subject to the outcome of future contract negotiations

LEASES / CONCESSIONS

LEASE HOLDER	ACTIVITY TYPE	LEASE STATUS / TERM	ANNUAL FEE	LEASE EXPIRY DATE
Watercare Services Ltd	Reservoir & associated infrastructure	In perpetuity	\$0.00	
TOTAL REVENUE PER ANNUM:			\$0.00 + GST	



TAKARUNGA / MT VICTORIA

IWI / HAPŪ INTERESTS:

Ngāi Tai ki Tāmaki

Ngāti Maru

Ngāti Pāoa

Ngāti Tamaoho

Ngāti Tamaterā

Ngāti Te Ata

Ngāti Whanaunga

Ngāti Whātua o Kaipara

Ngāti Whātua Ōrakei

Te Ākitai Waiohua

Te Kawerau ā Maki

Te Patukirikiri

Te Rūnanga o Ngāti Whātua

LOCAL BOARD AREA:

Devonport – Takapuna
Local Board

RESERVE CLASSIFICATION:

Recreation Reserve
subsection (1)

Local Purpose Reserve
subsection (2) and (3)

LEGAL DESCRIPTION:

6.5476 hectares Part
Allotment 42 & 46 Section 2

Parish of Takapuna

0.0726 hectares Part
Allotment 42 Section 2
Parish of Takapuna

1.0361 hectares Part
Allotment 42 Section 2

Parish of Takapuna

TAKARUNGA / MT VICTORIA

CAPITAL EXPENDITURE PROGRAMME

VALUE	PROJECT	DESCRIPTION	2026/27	2027/28	2028/29
MANA AOTŪROA / CULTURAL & HERITAGE	Interpretation and Wayfinding signs	Network wide programme to develop comprehensive site- specific interpretation and wayfinding signage	X	X	X
	Storytelling and Cultural Infrastructure	Network-wide programme to develop unique infrastructure that bring Mana Whenua stories and values to life on the Maunga	X	X	X
	Asset restoration	Restoration of historic assets on the Maunga	\$100,000	\$200,000	\$200,000
MANA WHAI A RĒHIA / RECREATIONA L	Asset Renewals	Michael King Writers Centre building renewal	\$100,000	\$0	\$0
	Ancillary visitor infrastructure	Re-develop the existing tennis courts to improve active and passive recreation value including the provision of a dedicated visitors bus parking area located downslope of the courts.	\$1,100,000	\$0	\$0

Note: X indicates that this is part of a network-programme

TAKARUNGA / MT VICTORIA

OPERATIONAL EXPENDITURE PROGRAMME

VALUE	PROJECT	DESCRIPTION	2026/27	2027/28	2028/29
MAURI PŪNAHA HAUROPI / ECOLOGY AND BIODIVERSITY	Pest Management	Undertake animal and plant pest control	\$21,256	\$21,681	\$22,115
	Vegetation Management	Annual Vegetation Maintenance programme including control of cherry, privet	\$5,490	\$5,600	\$5,712
MANA HONONGA TANGATA / LIVING CONNECTIONS	Volunteers and Partners	Continue to build strong working relationships with partners across the Maunga	X	X	X
	Building Maintenance associated costs	Michael King Writers Cottage Bunker The Depot Gun emplacement & tunnels	\$11,463	\$11,670	\$11,903
	Water /Electricity Expenses	Expenses relating to toilets	\$3,468	\$3,537	\$3,608
WHAI RAWA WHAKAUKA / ECONOMIC AND COMMERCIAL	Commercial Operators	Formalise agreements with commercial operators on the Maunga	X	X	X

Note: X indicates that this is part of a network-programme

TAKARUNGA / MT VICTORIA

CONTRACTS

CONTRACTOR	DESCRIPTION	CONTRACT VALUE	PERIOD COVERED
Green By Nature	Full facilities maintenance - annual scheduled works and response under \$1000	\$66,251	2026/27
	Track maintenance	\$6,984	2026/27

Note: these figures are subject to the outcome of future contract negotiations

LEASES / CONCESSIONS

LEASE HOLDER	ACTIVITY TYPE	LEASE STATUS / TERM	ANNUAL FEE	LEASE EXPIRY DATE
Takarunga Playcentre – Te Whānau Tupu Ngātahi o Aotearoa	Community activity (preschool)	5 year term	\$6060.00 + GST	31 Aug 2029
The Depot Inc	Community activity (gallery)	5 year initial term with 1x5 years right of renewal	\$4,640 + GST	Final expiry 30 June 2030
Michael King Writer Studio Trust	Community activity (creative)	1 year initial term	\$26,000 + GST	30 June 2026
Devonport Folk Music Club	Community activity (music)	20 year term (2 x 10 years) First term expired May 2019	\$1.00 + GST	15 May 2029

TOTAL REVENUE PER ANNUM: \$36,700 + GST



TE PANE-O-MATAAHO / TE ARA PŪERU / MĀNGERE MOUNTAIN

IWI / HAPŪ INTERESTS:

Ngāi Tai ki Tāmaki

Ngāti Maru

Ngāti Tamaoho

Ngāti Tamaterā

Ngāti Te Ata

Ngāti Whātua o Kaipara

Ngāti Whātua Ōrakei

Te Ākitai Waiohua

Te Kawerau ā Maki

Te Patukirikiri

LOCAL BOARD AREA: 0.0460 hectares more or less, being Allotment 270
Māngere – Ōtāhuhu Local Board
Parish of Manurewa

RESERVE CLASSIFICATION: 0.3914 hectares more or less, being Section 3 SO 68568

Historic, Recreation & Local Purpose 0.1019 hectares more or less, being Section 4 SO 68568

LEGAL DESCRIPTION:

31.8291 hectares more or less, being Section 1 SO 68568 0.4520 hectares more or less, being Section 1 SO 41481

5.3805 hectares more or less, being Section 2 SO 68568 0.0865 hectares more or less, being Lot 16 DP 42381

0.1889 hectares more or less, being Section 1 SO 40483

TE PANE-O-MATAAHO / TE ARA PŪERU / MĀNGERE MOUNTAIN

CAPITAL EXPENDITURE PROGRAMME

VALUE	PROJECT	DESCRIPTION	2026/27	2027/28	2028/29
MANA AOTŪROA / CULTURAL & HERITAGE	Interpretation and Wayfinding signs	Network wide programme to develop comprehensive site-specific interpretation and wayfinding signage	X	X	X
	Storytelling and Cultural Infrastructure	Network-wide programme to develop unique infrastructure that bring Mana Whenua stories and values to life on the Maunga	X	X	X
TAKOTORANGA / LANDSCAPE	Protection and restoration of integrity of the Tūpuna Maunga	Network-wide programme to remove vegetation and revegetate	X	X	X
		Develop Southern ridge track	\$600,000	\$1,400,000	\$0
MAURI PŪNAHA HAUROPI / ECOLOGY AND BIODIVERSITY	Traditional Cultivation	Network-wide programme to establish gardens based on Matauranga Māori such as māra kai, rongoa and pā harakeke	\$70,000	\$70,000	\$0

Note: X indicates that this is part of a network-programme

TE PANE-O-MATAAHO / TE ARA PŪERU / MĀNGERE MOUNTAIN

OPERATIONAL EXPENDITURE PROGRAMME

VALUE	PROJECT	DESCRIPTION	2026/27	2027/28	2028/29
MAURI PŪNAHA HAUROPI / ECOLOGY AND BIODIVERSITY	Pest Management	Undertake animal and plant pest control	\$23,109	\$23,571	\$24,043
	Plant Maintenance	Maintenance of planted areas	\$20,000	\$20,000	\$20,000
	Vegetation Management	Annual Vegetation Maintenance programme	\$5,730	\$6,085	\$6,206
MANA HONONGA TANGATA / LIVING CONNECTIONS	Volunteers and Partners	Continue to build strong working relationships with partners across the Maunga	X	X	X
	Building Maintenance associated costs	Memorial Hall Toilets /changing rooms	\$11,388	\$11,584	\$11,816
	Water /Electricity Expenses	Expenses relating to toilets and building	\$17,070	\$17,411	\$17,759
WHAI RAWA WHAKAUKA / ECONOMIC AND COMMERCIAL	Commercial Operators	Formalise agreements with commercial operators on the Maunga	X	X	X
TAKATORANGA WHENUA / LANDSCAPE	Perimeter Firebreaks	Continuation of firebreaks programme to reduce risk of fire in sensitive areas*	\$12,144	\$12,387	\$12,635

Note: X indicates that this is part of a network-programme

*Cost factored into maintenance contract

TE PANE-O-MATAAHO / TE ARA PUERU / MĀNGERE MOUNTAIN

CONTRACTS

CONTRACTOR	DESCRIPTION	CONTRACT VALUE	PERIOD COVERED
Green By Nature	Full facilities maintenance -annual scheduled works and response under \$1000	\$240,438	2026/27
	Track maintenance	\$78,655	2026/27

Note: these figures are subject to the outcome of future contract negotiations

HIREABLE FACILITIES

FACILITY	ACTIVITY TYPE	STATUS	ANNUAL FEE
Mangere Memorial Hall	General activity type	Short term occupancy – available for hire	Council's fees and charges

LEASES / CONCESSIONS

LEASE HOLDER	ACTIVITY TYPE	LEASE STATUS / TERM	ANNUAL FEE	LEASE EXPIRY DATE
Onehunga Mangere United Football Club	Football	5 year term	\$3,400 + GST	Final expiry date 31 October 2029
The Auckland Playcentres Association Inc	Playcentre	5 year term	\$4,800 + GST	31 July 2027

TOTAL REVENUE PER ANNUM: \$8,200 + GST





TE KŌPUKE / TĪTĪKŌPUKE / MT ST JOHN

IWI / HAPŪ INTERESTS:

Ngāi Tai ki Tāmaki
Ngāti Maru
Ngāti Pāoa
Ngāti Tamaoho
Ngāti Tamaterā
Ngāti Te Ata
Ngāti Whanaunga
Ngāti Whātua o Kaipara
Ngāti Whātua Ōrakei
Te Ākitai Waiohua
Te Kawerau ā Maki
Te Patukirikiri
Te Rūnanga o Ngāti Whātua

LOCAL BOARD AREA: 0.3819 hectares Lot 1 DP
37516
Albert Eden Local Board

RESERVE
CLASSIFICATION: 0.0047 hectares Part Lot 5
DP 106274
Recreation Reserve 0.1110 hectares Parts Lot 8
DP 15394

LEGAL DESCRIPTION: 0.1901 hectares Allotment
43 & Part Allotment 44
Section 11
3.0402 hectares Allotment
12A Section 11 Suburbs of
Auckland Suburbs of Auckland

0.1576 hectares Part Lot 23
of Allotment 18 Section 11
Suburbs of Auckland 0.0033 hectares Part
Allotment 15 Section 11
Suburbs of Auckland

0.2633 hectares Part Lots 24
& 25 DP 13194 0.0098 hectares Lot 4 DP
106274

0.4879 hectares Lot 1 DP
39142

TE KŌPUKE / TĪTĪKŌPUKE /
MT ST JOHN

CAPITAL EXPENDITURE PROGRAMME

VALUE	PROJECT	DESCRIPTION	2026/27	2027/28	2028/29
MANA AOTŪROA / CULTURAL & HERITAGE	Interpretation and Wayfinding signs	Network wide programme to develop comprehensive site-specific interpretation and wayfinding signage	\$30,000	X	X
TAKOTORANGA / LANDSCAPE	Protection and restoration of integrity of the Tūpuna Maunga	Network-wide programme to remove vegetation and revegetate	X	X	X

Note: X indicates that this is part of a network-programme

TE KŌPUKE / TĪTĪKŌPUKE /
MT ST JOHN

OPERATIONAL EXPENDITURE PROGRAMME

VALUE	PROJECT	DESCRIPTION	2026/27	2027/28	2028/29
MAURI PŪNAHA HAUROPI / ECOLOGY AND BIODIVERSITY	Pest Management	Undertake animal and plant pest control	\$12,318	12,564	\$12,815
	Vegetation Management	Annual Vegetation Maintenance programme including control of cherry, privet & olives	\$5,490	\$5,600	\$5,712
WHAI RAWA WHAKAUKA / ECONOMIC AND COMMERCIAL	Commercial Operators	Formalise agreements with commercial operators on the Maunga	X	X	X

Note: X indicates that this is part of a network-programme

CONTRACTS

CONTRACTOR	DESCRIPTION	CONTRACT VALUE	PERIOD COVERED
Green By Nature	Full facilities maintenance - annual scheduled works and response under \$1000	\$33,739	2026/27
	Track maintenance	\$20,182	2026/27

Note: these figures are subject to the outcome of future contract negotiations

LEASES / CONCESSIONS

LEASE HOLDER	ACTIVITY TYPE	LEASE STATUS / TERM	ANNUAL FEE	LEASE EXPIRY DATE
Watercare Services Ltd	Reservoirs & associated infrastructure	In perpetuity	\$0.00	
TOTAL REVENUE PER ANNUM:			\$0.00 + GST	



TE TĀTUA A RIUKIUTA / BIG KING

IWI /
HAPŪ INTERESTS:

Ngāi Tai ki Tāmaki

Ngāti Maru

Ngāti Tamaoho

Ngāti Tamaterā

Ngāti Te Ata

Ngāti Whanaunga

Ngāti Whātua o Kaipara

Ngāti Whātua Ōrakei

Te Ākitai Waiohua

Te Kawerau ā Maki

Te Patukirikiri

LOCAL BOARD AREA:

Puketāpapa Local Board

RESERVE
CLASSIFICATION:

Recreation Reserve

LEGAL DESCRIPTION:

7.7295 hectares Section 1
SO 34827

TE TĀTUA A RIUKIUTA / BIG KING

CAPITAL EXPENDITURE PROGRAMME

VALUE	PROJECT	DESCRIPTION	2026/27	2027/28	2028/29
MANA AOTŪROA / CULTURAL & HERITAGE	Interpretation and Wayfinding signs	Network wide programme to develop comprehensive site- specific interpretation and wayfinding signage	X	X	X
	Storytelling and Cultural Infrastructure	Network-wide programme to develop unique infrastructure that bring Mana Whenua stories and values to life on the Maunga	X	X	X
TAKOTORANGA / LANDSCAPE	Protection and restoration of integrity of the Tūpuna Maunga	Network-wide programme to remove vegetation and revegetate	X	X	X
MANA WHAI A RĒHIA / RECREATIONAL	Asset Renewals	Replacement of existing toilet	\$250,000	\$0	\$0

Note: X indicates that this is part of a network-programme

TE TĀTUA A RIUKIUTA / BIG KING

OPERATIONAL EXPENDITURE PROGRAMME

VALUE	PROJECT	DESCRIPTION	2026/27	2027/28	2028/29
MAURI PŪNAHA HAUROPI / ECOLOGY AND BIODIVERSITY	Pest Management	Undertake animal and plant pest control	\$13,000	\$13,260	\$13,525
	Plant Maintenance	Maintenance of planted areas	\$10,000	\$10,000	\$10,000
	Vegetation Management	Annual Vegetation Maintenance programme	\$5,490	\$5,600	\$5,712
MANA HONONGA TANGATA / LIVING CONNECTIONS	Volunteers and Partners	Continue to build strong working relationships with partners across the Maunga	X	X	X
	Water /Electricity Expenses	Expenses relating to toilets	\$2,866	\$2,924	\$2,982
WHAI RAWA WHAKAUKA / ECONOMIC AND COMMERCIAL	Commercial Operators	Formalise agreements with commercial operators on the Maunga	X	X	X
TAKATORANGA WHENUA / LANDSCAPE	Perimeter Firebreaks	Continuation of firebreaks programme to reduce risk of fire in sensitive areas*	\$7,719	\$7,873	\$8,030

Note: X indicates that this is part of a network-programme

*Cost factored into maintenance contract

TE TĀTUA A RIUKIUTA / BIG KING

CONTRACTS

CONTRACTOR	DESCRIPTION	CONTRACT VALUE	PERIOD COVERED
Green By Nature	Full facilities maintenance - annual scheduled works and response under \$1000	\$111,882	2026/27
	Track maintenance	\$20,898	2026/27

Note: these figures are subject to the outcome of future contract negotiations

LEASES / CONCESSIONS

LEASE HOLDER	ACTIVITY TYPE	LEASE STATUS / TERM	ANNUAL FEE	LEASE EXPIRY DATE
Watercare Services Ltd	Reservoir & associated Infrastructure	In perpetuity	\$0.00	

TOTAL REVENUE PER ANNUM:

\$0.00 + GST



GLOSSARY



TERM	MEANS
Administered lands	a. means <ul style="list-style-type: none"> i. the Maungakiekie/One Tree Hill northern land; and ii. Māngere Mountain; and b. except in subpart 5 of Part 2, includes any land - <ul style="list-style-type: none"> i. described in section 110(1)(a) or (b); and ii. to which section 110(2) and (3) apply.
Aotearoa	New Zealand
Hapū	Kinship group, tribe, and the primary political unit in traditional Māori society
Iwi	Tribe, nationality, race
Kaitiaki	Mana Whenua guardian
Kaitiakitanga	Mana Whenua guardianship
Mana	Prestige, spiritual power, charisma, status
Manaakitanga	Mutual respect, hospitality, kindness, generosity, support – the process of showing respect, generosity and care for others
Mana Aotūroa	Cultural and heritage
Mana Hononga Tangata	Living connection
Mana Whai a Rēhia	Recreational
Marutūāhu Rōpū	The following collective of Iwi: Ngāti Maru, Ngāti Pāoa, Ngāti Tamaterā, Ngāti Whanaunga, Te Patukirikiri
Maunga	Mountain, mount, peak
Mātauranga Māori	Māori knowledge, the body knowledge originating from Māori ancestors, including Māori world view, Māori creativity and cultural practices
Mauri Pūnaha Hauropi	Ecology and biodiversity
Member of Ngā Mana Whenua o Tāmaki Makaurau	An individual who is a member of 1 or more of the Iwi / Hapū who comprise Ngā Mana Whenua o Tāmaki Makaurau

TERM	MEANS
Ngā Mana Whenua o Tāmaki Makaurau (“Ngā Mana Whenua”)	a. Means the collective group of the following iwi/hapū: <ul style="list-style-type: none"> i. Ngāi Tai ki Tāmaki; and ii. Ngāti Maru; and iii. Ngāti Pāoa; and iv. Ngāti Tamaoho; and v. Ngāti Tamaterā; and vi. Ngāti Te Ata; and vii. Ngāti Whanaunga; and viii. Ngāti Whātua o Kaipara; and ix. Ngāti Whātua Ōrākei; and x. Te Ākitai Waiohua; and xi. Te Kawerau ā Maki; and xii. Te Patukirikiri; and xiii. Hapū of Ngāti Whātua whose beneficiaries of Te Rūnanga o Ngāti Whātua; including Te Taoū not descended from Tuperiri; and b. includes the individuals who are members of 1 or more of the iwi and hapū described in paragraph (a); and c. includes any whanau, hapū or group to the extent that it is composed of those individuals.
Ngā Mana Whenua o Tāmaki Makaurau Collective Redress Deed (“Collective Deed”)	The deed entitled Ngā Mana Whenua o Tāmaki Makaurau Collective Redress Deed
Ngāti Whātua Rōpū	The following collective of Iwi / Hapū: Ngāti Whātua o Kaipara, Ngāti Whātua Ōrākei, hapū of Ngāti Whātua (other than Ngāti Whātua o Kaipara and Ngāti Whātua Ōrākei) whose members are beneficiaries of Te Rūnanga o Ngāti Whātua
Pā	Fortified village or area
Pou	Post, upright, pole, sustenance
Rangatahi	Younger generation, youth
Takotoranga Whenua	Landscape
Tāmaki Makaurau	Auckland
Tamariki	Children, youthful
Taonga	Treasure, anything prized – applied to anything considered to be of value including socially or culturally valuable objects, resources, phenomenon, ideas and techniques
Taonga tuku iho	Treasure handed down from the ancestors, heirloom, cultural property, heritage

TERM	MEANS
Tapu	Be sacred, prohibited, restricted, set apart, forbidden, under atua protection
Tihi	Summit, top, peak, point
Tikanga	Correct procedure, custom, habit, lore, method, manner, rule, way, code, meaning, plan, practice, convention, protocol – the customary system of values and practices that have developed over time and are deeply embedded in the social context
Tūpuna	Ancestors
Tūpuna Maunga	Matukutūruru / Wiri Mountain; Maungakiekie / One Tree Hill; Maungarei / Mount Wellington; Maungauika / North Head; Maungawhau / Mount Eden; Ōhinerau / Mount Hobson; Ōhūiarangi / Pigeon Mountain; Ōtāhuhu / Mount Richmond; Ōwairaka / Tē Ahi-kā-a-Rakataura / Mount Albert; Pukewīwī / Puketāpapa / Mount Roskill; Rarotonga / Mount Smart; Takarunga / Mount Victoria; Te Ara Pūeru / Te Pane-o-Mataaho/ Māngere Mountain; Te Kōpuke / Tītīkōpuke / Mount St John; and • Te Tātua a Riukiuta / Big King
Tūpuna Maunga o Tāmaki Makaurau Integrated Management Plan (IMP)	Document adopted 23 June 2016, providing strategic direction for the management of the 14 Tūpuna Maunga
Tūpuna Maunga o Tāmaki Makaurau Authority (“The Authority”)	The Tūpuna Maunga o Tāmaki Makaurau Authority comprised of: <ul style="list-style-type: none"> • six Ngā Mana Whenua appointees being two each from the Marutūāhu Rōpū, Ngāti Whātua Rōpū and Waiohua Tāmaki Rōpū; • six Auckland Council appointees; and • one (non-voting) Crown representative
Tūpuna Taonga o Tāmaki Makaurau Trust	The Tūpuna Taonga o Tāmaki Makaurau Trust
Waahi tapu	Sacred place, sacred site – a place subject to long-term ritual restrictions on access or use
Waiohua Tāmaki Rōpū	The following collective of Iwi/Hapū: Ngāi Tai ki Tāmaki, Ngāti Tamaoho, Ngāti Te Ata, Te Ākitai Waiohua, Te Kawerau ā Maki
Wairuatanga	Spirituality

TERM	MEANS
Whai Rawa Whakauka	Economic and commercial
Whakapapa	Genealogy, genealogical table, lineage, descent
Whare	House, building, residence, dwelling

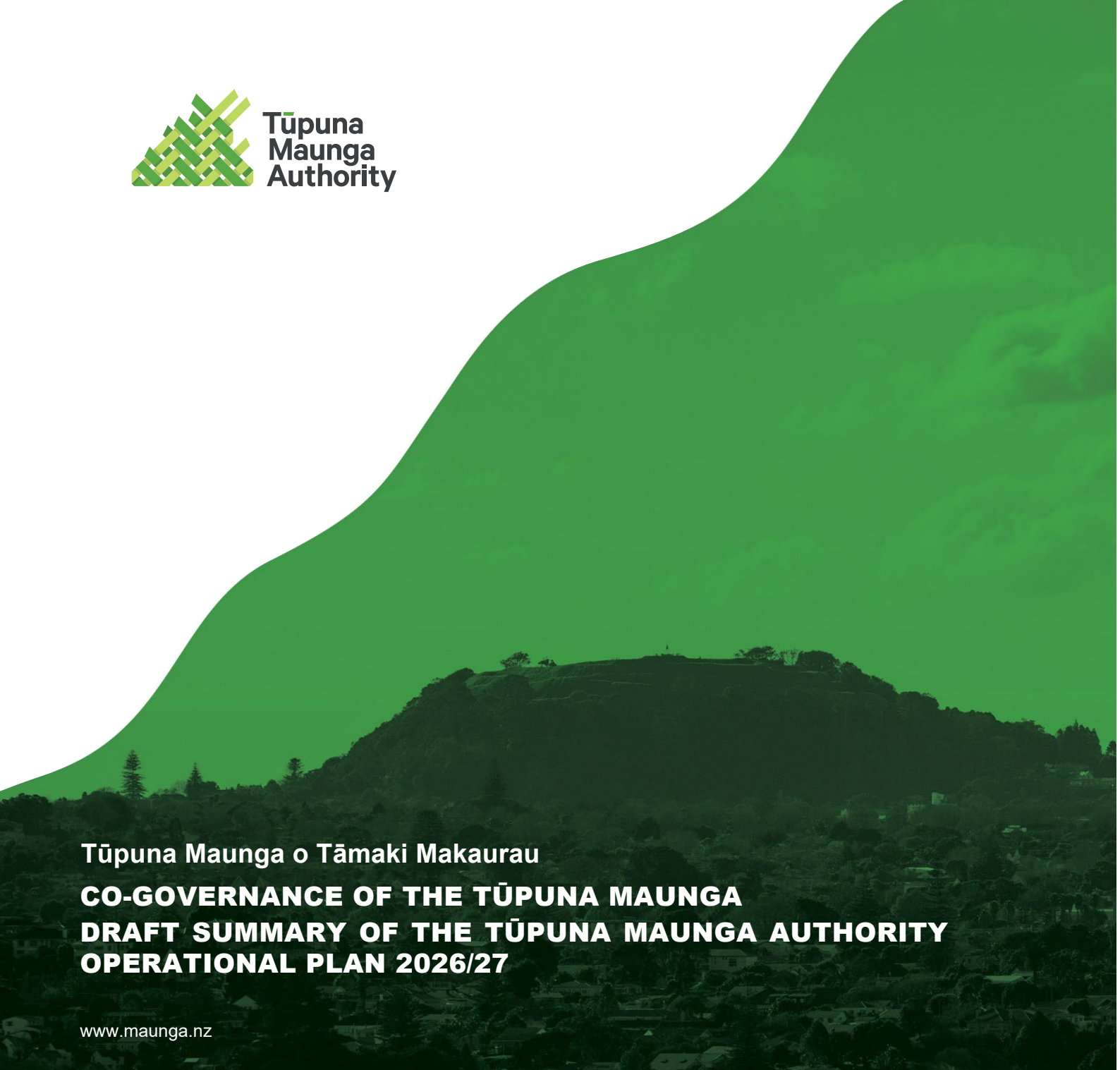

Tūpuna Maunga o Tāmaki Makaurau
CO-GOVERNANCE OF THE TŪPUNA MAUNGA
DRAFT SUMMARY OF THE TŪPUNA MAUNGA AUTHORITY
OPERATIONAL PLAN 2026/27

www.maunga.nz

The Ngā Mana Whenua o Tāmaki Makaurau Collective Redress Act 2014 (the Act) requires the Tūpuna Maunga o Tāmaki Makaurau Authority (Tūpuna Maunga Authority) and Auckland Council to prepare an Annual Operational Plan and a summary of that plan for inclusion in the Auckland Council's Annual Operational Plan 2026/27 process.

The Tūpuna Maunga Authority and Auckland Council are required to approve the Annual Operational Plan. The Tūpuna Maunga Authority Operational Plan 2026/27 must be considered and adopted concurrently with the Auckland Council's Operational Plan 2026/27. A summary of the Tūpuna Maunga Authority's indicative funding requirements are outlined in this Section.

NGĀ MANA WHENUA O TĀMAKI MAKAURAU

Ngā Mana Whenua o Tāmaki Makaurau negotiated a collective settlement of their historical Treaty claims with the Crown. Ngā Mana Whenua o Tāmaki Makaurau is the collective name of the 13 iwi/hapū with historical Treaty claims in wider Tāmaki Makaurau. The iwi/hapū are grouped into the following three rōpū:

MARUTŪĀHU RŌPŪ	NGĀTI WHĀTUA	WAIOHUA TĀMAKI RŌPŪ
Ngāti Maru	Ngāti Whātua o Kaipara	Ngāi Tai ki Tāmaki
Ngāti Pāoa	Ngāti Whātua Ōrākei	Ngāti Tamaoho
Ngāti Tamaterā	Te Rūnanga o Ngāti Whātua	Ngāti Te Ata
Ngāti Whanaunga		Te Ākitai Waiohua
Te Patukirikiri		Te Kawerau ā Maki

THE NGĀ MANA WHENUA O TĀMAKI MAKAURAU COLLECTIVE REDRESS ACT 2014

The Collective Redress Act 2014 vested the Crown owned land in 14 Tūpuna Maunga (ancestral mountains) in Ngā Mana Whenua o Tāmaki Makaurau. They are held for the common benefit of the iwi/hapū of Ngā Mana Whenua o Tāmaki Makaurau and the other people of Auckland. The Tūpuna Maunga are vested as reserves under the Reserves Act 1977.

THE 14 TŪPUNA MAUNGA ARE:

Matukutūruru/Wiri Mountain

Maungakiekie/One Tree Hill

Maungarei/Mount Wellington

Maungauika/North Head

Maungawhau/Mount Eden

Ōhinerau/Mount Hobson

Ōhūiarangi/Pigeon Mountain

Ōtāhuhu/Mount Richmond

Ōwairaka/Te Ahi-kā-a-Rakataura/ Mount Albert

Puketāpapa/Pukewīwī/Mount Roskill

Rarotonga/Mount Smart *

Takarunga/Mount Victoria

Te Kōpuke/Tītīkōpuke/Mount St John

Te Tātua a Riukiuta/Big King

CO-GOVERNANCE

The Act also established the Tūpuna Maunga Authority, a bespoke co-governance entity, to administer the Tūpuna Maunga.

The Authority has six representatives from Ngā Mana Whenua o Tāmaki Makaurau, six from Auckland Council and one non-voting Crown representative appointed by the Minister for Arts, Culture and Heritage. The term of the Authority aligns with the term of the Council.

Under the Act, the Tūpuna Maunga Authority is the administering body for each Maunga for the purposes of the Reserves Act 1977, with two exceptions of Maungauika / North Head and Rarotonga / Mount Smart.

Maungauika / North Head has previously been administered by the Crown (Department of Conservation) but has now been transferred to the Tūpuna Maunga Authority. Routine management is now undertaken by council under the direction of the Tūpuna Maunga Authority in the same way as for the other Maunga.

Responsibility for administration and management of Rarotonga / Mount Smart remains with Auckland Council (Regional Facilities Auckland) under the Mount Smart Regional Recreation Centre Act 1985 and Reserves Act 1977.

The Tūpuna Maunga Authority is also the administering body for Te Pane-o-Mataaho / Te Ara Pueru / Māngere Mountain and the Maungakiekie / One Tree Hill northern land.

The legislation provides for funding and staff resourcing through Auckland Council. The Authority is currently supported by a core team of eight council staff across the Governance and Parks, Sport and Recreation units.

The scale of this co-governance arrangement is unparalleled in Auckland and the resulting unified and cohesive approach to caring for the Maunga has garnered widespread support.

STRATEGIC FRAMEWORK:

TŪPUNA MAUNGA INTEGRATED MANAGEMENT PLAN

The Tūpuna Maunga Integrated Management Plan (“IMP”) sets the foundations for how the Tūpuna Maunga are valued, protected, restored, enhanced, and managed in the future with equal consideration and reverence. The IMP established a set of Values for the Tūpuna Maunga which are outlined below.

The IMP was developed in accordance with Section 41 of the Reserves Act to provide for and ensure the use, enjoyment, maintenance, protection, preservation, and development as appropriate for the reserve purposes for which each of the Tūpuna Maunga is classified. This single integrated plan replaces the former separate legacy reserve management plans for the Tūpuna Maunga.

The IMP was approved in 2016 following a public consultation process and are available at www.maunga.nz.

TŪPUNA MAUNGA INTEGRATED MANAGEMENT PLAN STRATEGIES

The Tūpuna Maunga Integrated Management Plan Strategies are the next level of policy development for the Tūpuna Maunga and aim to support the Values and Pathways in the Tūpuna Maunga Integrated Management Plan 2016.

The IMP Strategies was approved in 2019 following a public consultation process and are available at www.maunga.nz.

TŪPUNA MAUNGA VALUES

Within the Tūpuna Maunga Integrated Management Plan, the Tūpuna Maunga Authority has articulated a set of values of the Tūpuna Maunga. The values promote the statutory purpose of the Tūpuna Maunga under section 109 of the Collective Redress Act, where in exercising its powers and functions the Authority must have regard to the spiritual, ancestral, cultural, customary and historical significance of the Tūpuna Maunga to Ngā Mana Whenua.

The values provide a strategic framework to guide the Tūpuna Maunga Authority in making any decision about the Tūpuna Maunga.

The values weave together and give expression to mana whenua and other world views, and the connections and histories in a manner that highlights the way in which these views complement each other and create a richness to the relationship people have with the Tūpuna Maunga and multiple ways in which these relationships are thought of and expressed.

VALUE

PATHWAYS

WAIRUATANGA / SPIRITUAL

- Restore and recognise the relationship between the Maunga and its people.
- Recognise the tihi is sacred.
- Tread gently.
- Treat the Maunga as taonga tuku iho – treasures handed down the generations.

MANA AOTŪROA / CULTURAL AND HERITAGE

- Enable mana whenua role as kaitiaki over the Tūpuna Maunga.
- Recognise European and other histories, and interaction with the maunga.
- Encourage culturally safe access.
- Restoring customary practices and associated knowledge.

TAKOTORANGA WHENUA / LANDSCAPE

- Protect the integrity of the landscape of the Tūpuna Maunga.
- Active restoration and enhancement of the natural features of the Maunga.
- Encourage activities that are in keeping with the natural and indigenous landscape.
- Encourage design that reflects Tūpuna Maunga values.
- Promote a connected network of Tūpuna Maunga.
- Preserve the visual and physical integrity of the Maunga as landmarks of Tāmaki.

MAURI PŪNAHA HAUROPI / ECOLOGY AND BIODIVERSITY

- Strengthen ecological linkages between the Tūpuna Maunga.
- Maunga tū mauri ora, Maunga tū makaurau ora / if the Maunga are well, Auckland is well.
- Protect and restore the biodiversity of the Tūpuna Maunga.

MANA HONONGA TANGATA / LIVING CONNECTION

- Rekindle the sense of living connection between the Maunga and the people.
- Give expression to the history and cultural values of the Tūpuna Maunga.
- Actively nurture positive relationships.
- A place to host people.

WHAI RAWA WHAKAUKA / ECONOMIC / COMMERCIAL

- Alignment with the Tūpuna Maunga values.
- Foster partnerships and collaboration.
- Focus on commercial activities that create value and enhance experience.
- Explore alternative and self-sustaining funding opportunities.

MANA WHAI A RĒHIA / RECREATIONAL

- Balance informal and formal recreation.
 - Encourage informal inclusive recreational activities.
 - Recreational activities consistent with tikanga Māori.
 - Maunga are special places and treasures handed down.
 - Promote health and wellbeing.
-

TŪPUNA MAUNGA OPERATIONAL PLAN 2026/27

Each financial year, the Tūpuna Maunga Authority and Council must agree an annual operational plan to provide a framework in which the Council will carry out its functions for the routine management of the Tūpuna Maunga and administered lands for that financial year, under the direction of the Tūpuna Maunga Authority.

The Tūpuna Maunga Operational Plan 2026/27 identifies a number of projects to be delivered or commenced in the coming financial year and the subsequent two financial years. The Tūpuna Maunga Operational Plan 2026/27 also sets out the 10-year work programme and funding envelope confirmed through the Long-term Plan 2024-2034. The budget for 2026/27 and the subsequent years fits within this funding envelope.

A copy of the Operational Plan can be found at www.aucklandcouncil.govt.nz

PRIORITY PROGRAMMES AND PROJECTS OVER THE NEXT 3 YEARS INCLUDE:

POLICY AND MANAGEMENT

- Develop individual Tūpuna Maunga plans to provide direction on how the Values, Pathways, guidelines and strategies should be reflected on each Tūpuna Maunga.
- Progressing the potential transfer of administration over certain Maunga reserve lands from the Department of Conservation to the Authority, and the potential transfer of the administration of land contiguous to other Tūpuna Maunga.
- Establishment of a compliance programme including a review of current and establishment of appropriate bylaws.
- Development of individual Tūpuna Maunga plans which reflect the Integrated Values and Pathways, overarching guidelines and strategies for each of the Tūpuna Maunga.

HEALING THE MAUNGA

VALUES:

TAKOTORANGA WHENUA / LANDSCAPE VALUE

- Protection and restoration of the tihi (summits) including reconfiguring space and provision of cultural infrastructure.
- Protection and restoration of historic kumara pits, pā sites and wahi tapu.
- Development of infrastructure to enhance visitor experience including provision of carparks, amenity areas and ancillary infrastructure such as wharepaku/ toilets.
- Removal of redundant infrastructure (built structures, water reservoirs, impermeable surfaces, etc) and returning areas to open space.

EDUCATION, COMMUNICATIONS AND PARTNERSHIPS

VALUES:

WAIRUATANGA / SPIRITUAL VALUE

- On-site staff to protect and enhance the Tūpuna Maunga and the visitor experience.
- Volunteer programmes to connect communities to the Tūpuna Maunga.
- Education programmes, community events and a bespoke website that celebrates the living connection that all communities have with the Tūpuna Maunga.
- Implementation of the Education Strategy to promote the values of the Tūpuna Maunga and the unique history and whakapapa of Ngā Mana Whenua. This includes exploration of visitor centre opportunities, connecting with communities of learning such as schools and the development of a communications strategy.

CULTURAL CONNECTION

VALUES:

MANA AOTŪROA / CULTURAL AND HERITAGE VALUE

MANA HONONGA TANGATA / LIVING CONNECTION VALUE

- Development of a programme of work which enables Ngā Mana Whenua to express their living and unbroken connection with the Tūpuna Maunga. This may include cultural interpretation including distinct entrance ways, pou whenua, pa reconstructions, kaitiaki opportunities, and other cultural activities.
- Mana whenua living connection programme focusing on their role as kaitiaki (guardians), restoring customary practices and associated knowledge and enabling cultural activities

BIODIVERSITY/BIOSECURITY

VALUES:

MAURI PŪNAHA HAUROI / ECOLOGY AND BIODIVERSITY VALUE

- Restoration of indigenous native ecosystems; reintroducing native plants and attracting native animal species; removing inappropriate exotic trees and weeds (For context, see pages 58, 65-66, 71, 87, and 90-91 of the Tūpuna Maunga Authority Integrated Management Plan, and at pages 7 and 34 of the Integrated Management Plan Strategies).
- Pest control on all Maunga in line with Auckland's plan to be pest free by 2050.
- Researching options to achieve efficient and effective animal and pest control methods, which includes a phased reduction in the use of herbicides and pesticides on the Tūpuna Maunga.

RECREATION AND ACTIVATION

VALUES:

MANA HONONGA TANGATA / LIVING CONNECTION VALUE

MANA WHAI A RĒHIA / RECREATIONAL VALUE

- Exploration of facilities and activities on, around and between the Tūpuna Maunga which provide for passive and active recreational opportunities.

COMMERCIAL

VALUES:

WHAI RAWA WHAKAUKA / ECONOMIC / COMMERCIAL VALUE

- Develop and implement a commercial framework which ensures continued investment back into the Tūpuna Maunga. This includes exploration of potential commercial activities and facilities, as well as the development of a concession framework for commercial operators on the Maunga.

All projects are designed to deliver outcomes for the 13 iwi/hapū of the Tāmaki Collective and all the people of Auckland, enhance the mana and mauri of the Tūpuna Maunga and deliver improved open spaces across the eight local board areas.

They will also enable a compelling case in a future UNESCO World Heritage bid for the Tūpuna Maunga, which will contribute to a Māori identity that is Auckland's point of difference in the world. The bid for World Heritage status will require a dedicated resource and will continue to be progressed in this financial year in partnership with the Department of Conservation.



SUMMARY OF INDICATIVE FUNDING REQUIREMENTS

The funding for Tūpuna Maunga is set at a regional level. The 10-year budget to enable the priority projects and programmes in the council's 10-year Budget (Long-term Plan) 2024-2034 is shown in Table.

The budget for 2026/27 fits within this 10-year Budget (Long-term Plan) 2024-2034 funding envelope.

FUNDING ENVELOPE FOR THE TŪPUNA MAUNGA AUTHORITY IN THE COUNCIL'S 10 YEAR BUDGET (LONG TERM PLAN) 2024-2034

LTP 2024-2034

Funding Envelope (\$000's)	2024/25	2025/26	2026/27	2027/28	2028/29	2029/30	2030/31	2031/32	2032/33	2033/34	Total
Net operating expenditure	4,085	4,214	4,373	4,373	4,819	4,927	5,029	4,830	4,834	4,837	46,321
Capital expenditure	9,395	9,720	12,580	12,600	12,856	13,117	13,383	3,384	3,564	3,752	94,352
Total LTP Funding Requirement 2024-34*	13,480	13,934	16,953	16,973	17,675	18,044	18,413	8,215	8,397	8,589	140,673

* Excludes depreciation and inflation.

Quarter 2 Report

Author/s :

Matt Burton, Senior Operations Advisor
Munen Prakash, Lead Financial Advisor

Purpose

1. To consider the Quarter 2 Report for the 2025/26 financial year.

Recommendation

That the Tūpuna Maunga Authority:

- a. **note** the attached Quarter 2 Report for 2025/26 financial year.

Background

2. Quarterly report providing the Tūpuna Maunga Authority with operational performance and financial update.

Discussion

3. Attached is the Tūpuna Maunga Authority Quarter 2 Report for the 2025/26 financial year.

Attachments

- A. Quarter 2 Report

Item 4.2



QUARTER 2 REPORT

As at 31 December 2025

CONTENTS

1. Key highlights

2. Tūpuna Maunga – key objectives and Maunga-specific work programme

3. Financials

3.1 Operating revenue and costs

3.2 Capital projects

1. Key highlights in this quarter:

Kī o Rahi Junior Regionals tournament held on Ōtahuhu

The team partnered with College Sport Auckland and Kī o Rahi Tāmaki Makaurau to hold the Junior regional tournament.

Guy Fawkes & New Years

Management put in place protective measures including security and closing the Maunga afterhours during the sale of fireworks. Also had kaimahi on site during the New Years celebrations to manage large numbers of manuhiri.

Māngere whānau day

A day to celebrate the mahi that is happening on Māngere as well as the community. This included tākarō māori with Harko Brown, community stalls with I am Māngere, Māngere Education Centre, and a hāngi fundraiser for the Ecohub in Māngere Centre.

School Holiday Programmes

Several guided hīkoi occurred over Māngere and Maungauika during the school holidays to encourage whānau to get on the Maunga.

Ruru and bat monitoring

The nest boxes put out during Q1 were monitored during Q2 and into Q3, bat monitoring devices were placed out in December 2025 to provide data on bat presence across all the Tūpuna Maunga.

2. Tūpuna Maunga key activities and Maunga-specific work programmes

This section of the Performance Report lists each of the Tūpuna Maunga and the key activities undertaken Quarter 2.

Matukutūruru / Wiri	Pest management undertaken Bat monitoring
Maungakiekie / One Tree Hill	Pest management undertaken. Firebreaks mown. Scheduled tree maintenance undertaken. Maungakiekie songbird event Bat monitoring

Maungarei / Mt Wellington	<p>Pest management undertaken.</p> <p>Firebreaks mown.</p> <p>Scheduled tree maintenance undertaken</p> <p>Bat monitoring</p>
Maungauika/North Head	<p>Pest management undertaken.</p> <p>Devonport Half Marathon.</p> <p>School holidays activation.</p> <p>Scheduled tree maintenance undertaken.</p> <p>Bat monitoring</p>
Maungawhau / Mt Eden	<p>Pest management undertaken.</p> <p>Firebreaks mown.</p> <p>Scheduled tree maintenance undertaken.</p> <p>Friends of Maungawhau working bee</p> <p>Bat and ruru monitoring</p>
Ōhinerau / Mt Hobson	<p>Pest management undertaken.</p> <p>Secondary tracks project started.</p> <p>Firebreaks mown.</p> <p>Bat monitoring</p>
Ōhūiarangi/Pigeon Mountain	<p>Pest management undertaken.</p> <p>Firebreaks mown.</p> <p>Bat monitoring</p>
Ōtāhuhu / Mt Richmond	<p>Ki-o-Rahi Tāmaki Regional tournament held.</p> <p>Pest management undertaken.</p> <p>Firebreaks mown.</p> <p>Bat monitoring</p>
Ōwairaka / Te Ahi-Kā-Rakataura /Mt Albert	<p>Pest management undertaken.</p> <p>Firebreaks mown.</p> <p>Bat monitoring</p>
Pukewīwī / Puketāpapa / Mt Roskill	<p>Pest management undertaken.</p> <p>Firebreaks mown.</p> <p>Scheduled tree maintenance undertaken.</p> <p>Bat and ruru monitoring</p>
Takarunga / Mt Victoria	<p>Pest management undertaken.</p> <p>Tihi reconfiguration project started.</p> <p>Firebreaks mown.</p> <p>Bat and ruru monitoring</p>

Te Kōpuke / Tītīkōpuke / Mt St John	Pest management undertaken. Firebreaks mown. Bat monitoring
Te Pane-o-Mataaho/ Te Ara Pueru / Māngere Mountain	Pest management undertaken. School holidays activation. Secondary tracks project started. Firebreaks mown. Bat monitoring
Te Tātua-a-Riukiuta / Big King	Pest management undertaken. Firebreaks mown. Friends of Te Tātua a Riukiuta working bee Bat and ruru monitoring

3.0 FINANCIALS

3.1 Operating revenue and costs

TŪPUNA MAUNGA O TĀMAKI MAKAURAU AUTHORITY
Operating Revenue and Expenditure for Quarter 2 as at 31 December 2025

	Actual Qtr 2 \$'000	Budget Qtr 2 \$'000	Variance Qtr 2 \$'000	Actual YTD \$'000	Budget YTD \$'000	Variance YTD \$'000
Operating Revenue	-112	-91	21	-190	-163	26
Operating Expenditure	1,285	1,423	138	2,723	2,708	-15
Governance Costs	17	0	-17	38	60	22
Net Operating Result	1,190	1,332	143	2,571	2,604	33

TŪPUNA MAUNGA O TĀMAKI MAKAURAU AUTHORITY
Operating Revenue and Expenditure for Quarter 2 as at 31 December 2025

	Actual Qtr 2 \$'000	Budget Qtr 2 \$'001	Variance Qtr 2 \$'000	Actual YTD \$'000	Budget YTD \$'000	Variance YTD \$'000
Fees and user charges revenue	-12	-15	-4	-22	-30	-8
Property rental revenue	-100	-75	25	-168	-133	35
Operating Revenue	-112	-91	21	-190	-163	26
Repairs and maintenance & Outsourced works	410	501	90	1,029	1,160	131
Professional services	13	33	19	34	70	35
Other expenditure on activities	861	890	29	1,659	1,478	-181
Operating Expenditure	1,285	1,423	138	2,723	2,708	-15
Governance Costs	17	0	-17	38	60	22
Net Operating Result	1,190	1,332	143	2,571	2,604	33

Financial Commentary:

Operating Revenue for quarter two ended 31 December 2025 was slightly unfavourable due to timing of hall hire revenue.

Operating Expenditure for quarter two ended 31 December 2025 was lower than budget due to repairs and maintenance offset by higher water and electricity expenses.

3.2 Capital projects

TŪPUNA MAUNGA O TĀMAKI MAKAURAU AUTHORITY

Capital Expenditure for Quarter 2 as at 31 December 2025

	Actual YTD \$'000	Budget YTD \$'000	Variance YTD \$'000	FY Budget (incl c/fwd) \$'000
Total Capital Projects	4,115	5,217	1,102	10,434

Financial Commentary:

Capital Expenditure for the quarter one ended 31 December 2025 is lower mainly due to timing of work programmes and is expected to come within capex budget for FY25.

Building options for use going forward

Author/s :

Carl Tate, Kaiwhakahaere Tupuna Maunga
Lucia Kohler, Kaihautu Hotaka

Purpose

1. To consider an update on the buildings for terminated leases Northern Sports Car Club at Ōtāhuhu / Mt Richmond, Pigeon Mountain Cricket Club at Ōhūiarangi/Pigeon Mountain and Mountain Green Archery Club at Ōwairaka / Mt Albert.

Recommendation

That the Tūpuna Maunga Authority:

- a. **direct management to engage** with the Tūpuna Taonga Trust as whether they have any aspirations for the use the buildings.
- b. **remove** the buildings formerly of the Northern Sports Car Club at Ōtāhuhu / Mt Richmond, Pigeon Mountain Cricket Club at Ōhūiarangi/Pigeon Mountain and Mountain Green Archery Club at Ōwairaka / Mt Albert, but subject to any requests for use of such buildings by the Tūpuna Taonga Trust.
- c. **request** management to notify tenants of terminated leases of the Authority's decision on removal of buildings for Northern Sports Car Club at Ōtāhuhu / Mt Richmond, Pigeon Mountain Cricket Club at Ōhūiarangi/Pigeon Mountain and Mountain Green Archery, but subject to any requests for use of such buildings by the Tūpuna Taonga Trust.

Item 4.3

Background

2. At Hui 101 (4 August 2025), the Tūpuna Maunga Authority resolved to terminate leases inherited from Auckland Council and its predecessors. Management seeks direction on buildings use going forward for terminated leases
 - a. Pigeon Mountain Cricket Club at Ōhūiarangi / Pigeon Mountain
 - b. Northern Sports Club at Ōtāhuhu / Mt Richmond
 - c. Mountain Green Archery Club at Ōwairaka / Mt Albert
3. The Tūpuna Maunga Authority's Integrated Management Plan (IMP) was adopted by the Authority in terms of Ngā Mana Whenua o Tāmaki Makaurau Collective Redress Act 2014 and the Reserves Act 1977. The IMP describes a series of "Values" and "Pathways" that guide all activities on the Tūpuna Maunga. The primary focus of the IMP is to protect the health and well-being of the Tūpuna Maunga. A number of pathways that would allow for appropriate re-purposing of the building, for example, retaining the building as a space for community activities or operational purpose.
 - i. Under Wairuatanga / Spiritual, a pathway to restoring and recognising the relationship between the Maunga and its people is by making the Tūpuna Maunga places for all people to come together and share common aspirations for the protection and restoration of these landscapes.
 - ii. Under Mana Hononga Tangata / Living Connection - rekindle the sense of living connection between the Maunga and the people, give expression to the history and cultural values of the Tūpuna Maunga and Actively nurture positive relationships.

- iii. Under the Mana Aotūroa / Cultural and Heritage to support restoration of customary practices.
- iv. Under the Takatoranga Whenua/ Landscape Pathway, the IMP encourages the progressive removal of structures and features that detract from the Maunga.

Statutory Context

4. Section 109(2) of Ngā Mana Whenua o Tāmaki Makaurau Collective Redress Act 2014 requires the Authority to have regard to the spiritual, ancestral, cultural, customary, and historical significance of the Maunga to Ngā Mana Whenua o Tāmaki Makaurau and that the Tūpuna Maunga is held in trust for Ngā Mana Whenua and the other people of Auckland.
5. The Tūpuna Maunga Authority's Integrated Management Plan was unanimously adopted (Mana Whenua and Auckland Council members) by the Authority pursuant to the Ngā Mana Whenua o Tāmaki Makaurau Collective Redress Act 2014 and Reserves Act 1977. The Integrated Management Plan describes a series of "Values" and "Pathways" that guide all activities on the Tūpuna Maunga.
6. The Tūpuna Maunga Authority (Mana Whenua and Auckland Council members) unanimously adopted the Tūpuna Maunga Strategies at Hui 50 on 25 September 2020. The Tūpuna Maunga Strategies are 7 key sections that outline the strategic direction with regards to education, Biodiversity, Tūpuna Maunga design, Recreation, commercial activities and monitoring. Together with the IMP, these strategies inform guide and manage the activities undertaken on the Maunga.
7. The Authority administers the Tūpuna Maunga under the Reserves Act 1977 and pursuant to Ngā Mana Whenua o Tāmaki Makaurau Collective Redress Act 2014. The Hauraki Gulf Marine Park Act 2000 is also applicable in relation to Maungauika.

Item 4.3

Discussion

Pigeon Mountain Cricket Club at Ōhūiarangi / Pigeon Mountain

8. The Pigeon Mountain Cricket Club (the Cricket Club) lease was a legacy lease was inherited by the Tūpuna Maunga Authority, it was originally granted by Manukau City Council and the lease expired in 2019. The Cricket Club owns and maintained the building that they currently occupy.
9. The Club occupies an area which is classified as a Recreation Reserve. The location of the Club is shown in attachment A.

Legal advice on Cricket Club building

10. Building reverts to the Authority upon termination, with no compensation payable to the lessee.
11. Alternatively, the Authority may require the lessee to remove the building and reinstate the premises.
12. If the lessee fails to remove the building, the improvements automatically revert to the Authority, who may then dispose of them at the lessee's cost.

Assessment of Cricket Club Building

13. In February 2022 we have assessed the state of the building. Overall grading is 3 out of 5. Building structure is in average condition, but as a result of insufficient maintenance over the years, repairs required externally and internally. Contractors have estimated an approximate cost of \$200,000 for the repairs. Building area is 124m².
14. Building is not suitable for relocation and building removal costs are estimated at \$83,300, the costs may not be recoverable from the Club.

Engagement with the Cricket Club

15. Management served the termination notice to the Club and will be working with the Cricket Club on an Exit Plan.

Engagement with Ngā Mana Whenua

16. Ngāi Tai ki Tāmaki expressed their vision to have this area revegetated.

Cricket Club Building future options

17. Retain/repair the building for hireage or lease. Further investigations would be required if this option is selected.
18. Remove building and revegetate area (recommended).

Northern Sports Car Club at Ōtāhuhu / Mt Richmond

19. The Northern Sports Car Club (the Car Club) lease was a legacy lease was inherited by the Tūpuna Maunga Authority, it was originally granted by Auckland City Council and the lease expired in 2021. The Club has built, owned and maintained the building that they currently occupy.
20. The Club occupies an area which is classified as a Recreation Reserve. The location of the Club is shown in attachment B.

Legal advice on Car Club building

21. Building reverts to the Landlord without compensation when the lease ends.
22. Lease also contains rights (not obligations) for the TMA to:
 - i. require Tenant to remove the Building;
 - ii. require an incoming tenant to pay the outgoing Tenant the value of the Building;
 - iii. Itself pay the Tenant the value of the Building if the Building has value to the landlord.

Assessment of Car Club Building

23. The building state was assessed in August 2025. Overall grade is 4 out of 5 and building area is 612m². Although the Club kept regular maintenance, the report suggest extensive repairs required externally and internally. Further specialist assessments will be required to assess external cladding, windows, doors and fire safety, the repair costs will likely be more than \$1m.
24. Building removal costs excluding carpark are estimated at \$140,150, the costs may not be recoverable from the Club.
25. Potential future use of the building would also impact on the second club on the Maunga i.e. venue hire.
26. During the opening hours, the carpark location attracts socialising, and litter is frequently left behind.

Engagement with the Car Club

27. Management is working with the Club on Exit Plan.

Car Club Building future options

28. Retain/repair the building for hireage or lease. Further investigations would be required if this option is selected.
29. Remove building and revegetate area (recommended).

Mountain Green Archery Club at Ōwairaka / Mt Albert

30. Mountain Green Archery Club (the Archery Club) lease was a legacy lease was inherited by the Tūpuna Maunga Authority, it was originally granted by Auckland City Council. At Hui 62 (22 February 2021) the Tupuna Maunga Authority resolved to grant a lease to the Archery Club for the initial term of 1 year and the lease expired in November 2023. The Club has owned and maintained the building that they currently occupy.
31. The Archery Club occupies an area which is classified as a Recreation Reserve. The location of the Club is shown in attachment C.

Legal advice on Archery Club building

32. The Auckland Council Legal team has advised that under the current lease, the Tūpuna Maunga Authority, as landlord, can require the tenant to remove within six months on expiry of the lease.
33. If the tenant fails to meet these obligations, the Tūpuna Maunga Authority can remove and dispose of the building and improvements at the tenant's cost.
34. If the Tūpuna Maunga Authority wants to keep the building for its own use, we can keep the ownership without compensation.

Archery Building Assessment

35. Archery building is a basic storage shed with water input but no power, the building is in poor condition with overall rating 4 out of 5. Significant remedial works are required to external walls and roof. The repair costs are estimated at \$100,000. Building area is 70m².
36. Building removal costs are estimated at \$12,782 the costs may not be recoverable from the Club.

Engagement with the Archery Club:

37. Management is currently working with the Archery Club on the Exit Plan.

Archery Club Building future options

38. Retain/repair for operational use to assist with Maunga Management i.e. volunteers shed for conservation purposes.
39. Remove building and revegetate area (recommended).

Next Steps

40. Engage with the Tūpuna Taonga Trust as to whether they have any aspirations for the use of the buildings.
41. Depending on feedback from the Authority, for the retained buildings investigate the use of the property for alternative purposes that may have benefits for the Maunga and report findings to the Tūpuna Maunga Authority.
42. Prepare a decision paper for the Authority.

Attachments

- A. Site Plan for the Pigeon Mountain Cricket Club at Ōhūiarangi Pigeon Mountain
- B. Site Plan for the Northern Sports Club at Ōtāhuhu - Mt Richmond
- C. Site Plan for the Mountain Green Archery Club at Ōwairaka - Mt Albert

Attachment A: Site Plan for the Pigeon Mountain Cricket Club at Ōhūiarangi Pigeon Mountain

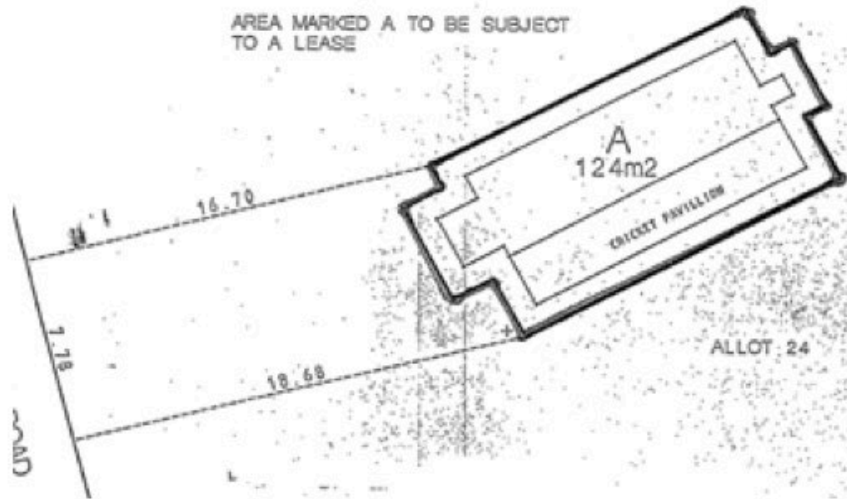

Attachment B: Site Plan for the Northern Sports Club at Ōtāhuhu - Mt Richmond



Lease area shown in red.



Attachment C: Site Plan for the Mountain Green Archery Club at Ōwairaka - Mt Albert



Michael King Writers Centre Lease update

Author/s :

Lucia Kohler, Kaihautu Hotaka

Carl Tate, Kaiwhakahaere Tupuna Maunga

Purpose

1. This report recommends that the Tūpuna Maunga Authority offer Michael King Writers Centre a lease on Takarunga/Mount Victoria.

Recommendation

That the Tūpuna Maunga Authority:

- a. **delegate** to the Co-Chairs and Deputy Chair the power to execute a lease, including a Maunga Outcomes Plan, with the Michael King Writers Centre at a market rental \$26,000 (as determined by a registered valuer) and otherwise on the standard terms and conditions; and
- b. **delegate** to the Co-Chairs and Deputy Chair the power to agree to terms governing the termination arrangements of the Michael King Writers Centre should the Centre decide not to accept the new lease.

Item 4.4

Background

2. The Michael King Writers Centre (the Centre) lease was inherited by the Tūpuna Maunga Authority. This lease was originally with the North Shore City Council (predecessor to Auckland Council) and was drafted in accordance with that council's policy at the time. This legacy lease commenced in 2005 and will expire on 19 June 2025. Current rental amount is \$1.
3. The Centre occupies an area of Takarunga/Mount Victoria which is classified as a Local Purpose Reserve. The location of the lease area is shown in Attachment A. The building is owned by Auckland Council and Tūpuna Maunga Authority maintains the building.
4. At Hui 99 (26 May 2025), the Tūpuna Maunga Authority (Authority) resolved to grant a lease to the Michael King Writers Centre at the market rental of \$26,000 for an initial term of 1 year ending 30 June 2026.

Statutory Context

5. This paper relates to Takarunga/Mount Victoria.
6. Clause 2.3 of the Ngā Mana Whenua o Tāmaki Makaurau Collective Redress Deed 2012 states:

“2.3 The Tāmaki Makaurau collective legislation will, on the terms provided by section 43 of the draft bill, direct the Registrar-General to record on any computer freehold register for each Maunga that the iwi and hapū of Ngā Mana Whenua o Tāmaki Makaurau specified for that Maunga in table 1 of part 3 of the property redress schedule have spiritual, ancestral, cultural, customary and historical interests in the Maunga.”

7. The Collective Deed Property Redress Schedule contains the table referred to in clause 2.3, and the iwi/hapū having spiritual, ancestral, cultural, customary and historical interests in the Maunga are as follows:

Takarunga / Mt Victoria	Ngāi Tai ki Tāmaki Ngāti Maru Ngāti Pāoa Ngāti Tamaoho Ngāti Tamaterā Ngāti Te Ata Ngāti Whanaunga	Ngāti Whātua Ōrākei Ngāti Whātua o Kaipara Te Ākitai Waiohua Te Kawerau ā Maki Te Patukirikiri Te Rūnanga o Ngāti Whātua
-------------------------	---	--

8. Any decision to determine management within a reserve must take into account the legislative and policy framework.
9. The Authority administers the Tūpuna Maunga under the Reserves Act 1977 and pursuant to Ngā Mana Whenua o Tāmaki Makaurau Collective Redress Act 2014. The Hauraki Gulf Marine Park Act 2000 is also relevant. The activities of the Club are consistent with the reserve classification.
10. Section 109(2) of Ngā Mana Whenua o Tāmaki Makaurau Collective Redress Act 2014 requires the Authority to have regard to the spiritual, ancestral, cultural, customary, and historical significance of the Maunga to Ngā Mana Whenua o Tāmaki Makaurau and that the Tūpuna Maunga is held in trust for Ngā Mana Whenua and the other people of Auckland.
11. The Tūpuna Maunga Authority’s Integrated Management Plan (IMP) was adopted by the Authority in terms of Ngā Mana Whenua o Tāmaki Makaurau Collective Redress Act 2014 and the Reserves Act 1977. The Integrated Management Plan describes a series of “Values” and “Pathways” that guide all activities on the Tūpuna Maunga. The primary focus of the IMP is to protect the health and well-being of the Tūpuna Maunga.
12. The Tūpuna Maunga Authority adopted the Tūpuna Maunga Strategies at Hui 50 on 25 September 2020. The Tūpuna Maunga Strategies are 7 key sections that outline the strategic direction with regards to education, Biodiversity, Tūpuna Maunga design, Recreation, commercial activities and monitoring. Together with the IMP, these strategies inform guide and manage the activities undertaken on the Maunga.
13. Section 61 of the Reserves Act 1977 sets out the Authority’s powers in relation to leasing on a Local Purpose Reserve. The activities of Centre are consistent with the classification of the reserve.

Item 4.4

Discussion

Leases on Tūpuna Maunga

14. The Tūpuna Maunga o Tāmaki Makaurau Integrated Management Plan (IMP) describes a series of values and pathways that dictate decision-making on leases. The IMP places the health and well-being of the Tūpuna Maunga at the heart of all decisions.
15. Any leasing activity must be consistent with the IMP Tūpuna Maunga values and should actively promote those values.

Michael Kings Writers Centre

16. The Centre provides temporary residency to support diverse New Zealand writers and promote the development of high-quality New Zealand writing.
17. The Michael King Writers Centre is overseen by the Michael King Writers Studio Trust. The Trust and the Centre were established in 2005, a year after historian and writer Michael King died in a car accident. The Centre receives approximately 130 applications per year for the 17 residencies that they offer and each year a minimum of two residencies are awarded to a Māori writer. In 2025 five Māori writers will hold a residency. They have now hosted residency to over 200 of Aotearoa's writers and in addition 100 writers who pay to stay.
18. Like with all Tūpuna Maunga leases, Management worked with The Centre to develop an outcomes plan. They have developed an information pack including TMA values, use dual naming, encourage writers to recognise the Maunga and Ngā Mana Whenua, maintain gardens and native plantings, promote Alcohol and Smoke Free policy.

Terms

Term

19. The Centre has demonstrated their contribution to the wellbeing of the Maunga and the values set out in the IMP. Management has a good working relationship with the tenant.
20. Given the above context management recommend lease for term of 5 years.

Rental

21. A market rental valuation has been undertaken by an independent registered valuer in 2024 due to the short timeframe since the start initial lease term it is recommended that the rental stays at the same amount at \$26,000 per annum.

Next Steps

22. If a lease is to be offered, Management will work alongside the Centre to draft a Tūpuna Maunga Lease for consideration and execution by the Chair and Deputy Chair

Attachments

- A. Site Plan for Michael King Writers Centre on Takarunga Mount Victoria

Attachment A: Site Plan for Michael King Writers Centre on Takarunga Mount Victoria



Tūpuna Maunga Residency Programme

Author/s :

Lucia Kohler, Kaihautu Hotaka

Rebecca Poi, Apiha Whakaae Kaupapa / Permit Processing and Engagement Officer

Challen Wilson – Te Pūtātara Waka Tairanga Whenua / Manager Co-Governance

Communications and Engagement

Purpose

1. To propose a residency at the Michael King Writers Centre at Takarunga / Mt Victoria.

Recommendation

That the Tūpuna Maunga Authority:

- a. **note** the report.
- b. **approve** the allocation of \$8,000 funding for the Tūpuna Maunga Authority Residency Programme for 2026/2027 and thereafter on annual basis, subject to a lease being approved by the Authority for the Michael King Writers Centre.

Background

2. The Michael King Writers Centre (The Centre) is overseen by the Michael King Writers Studio Trust. The Trust and the Centre were established in 2005, a year after historian and writer Michael King died in a car accident. The Centre receives approximately 130 applications per year for the 17 residencies that they offer and each year a minimum of two residencies are awarded to a Māori writer. In 2025 five Māori writers held a residency and in 2026 they will host 3 Māori writers. The centre have now hosted residencies to over 200 of Aotearoa's writers and in addition 100 writers who pay to stay.
3. The Centre occupies an area of Takarunga/Mount Victoria which is classified as a Local Purpose Reserve.
4. At Hui 99 (26 May 2025), the Tūpuna Maunga Authority (Authority) resolved to grant a lease to the Michael King Writers Centre at the market rental of \$26,000 for an initial term of 1 year ending 30 June 2026. Management is planning to propose the lease extension for further 5 years.
5. The Research Policy was adopted at Hui 71 (14 February 2022). The policy provides for an annual pool of \$10,000 for which students can apply to support their research. This is called the Tūpuna Maunga Authority Research Scholarship. The Authority has since awarded scholarship to 7 researchers working across various disciplines.
6. During The Centre lease negotiations process in 2025 management discussed unique opportunity to work together to provide residency to either
 - a. Mana Whenua Writers,
 - b. Research Scholarship Recipients,
 - c. Tūpuna Maunga Specialist Projects,
 - d. A one-week residency at the Centre was piloted in September 2025, where a Mana Whenua creative stayed at The Centre while developing creative projects.

Item 4.5

Statutory Context

7. The Authority administers the Tūpuna Maunga under the Reserves Act 1977 and pursuant to Ngā Mana Whenua o Tāmaki Makaurau Collective Redress Act 2014. The Hauraki Gulf Marine Park Act 2000 is also relevant. Any decision to determine management within a reserve must consider the legislative and policy framework.
8. Section 109(2) of Ngā Mana Whenua o Tāmaki Makaurau Collective Redress Act 2014 requires the Authority to have regard to the spiritual, ancestral, cultural, customary, and historical significance of the maunga to Ngā Mana Whenua o Tāmaki Makaurau and that the Tūpuna Maunga is held in trust for Ngā Mana Whenua and the other people of Auckland.
9. The Tūpuna Maunga Authority's management of the Tūpuna Maunga is guided by an integrated statutory and strategic framework, including the Integrated Management Plan adopted under the Ngā Mana Whenua o Tāmaki Makaurau Collective Redress Act 2014 and the Reserves Act 1977, the Tūpuna Maunga Strategies adopted in September 2020, and the Hauraki Gulf Marine Park Act 2000; together these recognise and give effect to the cultural, spiritual, environmental, and intergenerational values of tangata whenua, with a primary focus on protecting the health and well-being of the Tūpuna Maunga while guiding education, biodiversity, recreation, design, commercial activity, monitoring, and wider catchment connections to the Hauraki Gulf.

Item 4.5

Discussion

Tūpuna Maunga Authority Residency Programme (TMA Residency)

10. The Centre offered to administer residency in partnership with Tūpuna Maunga Authority. Management has considered The Centre leading the programme, but a programme led by Tūpuna Maunga Authority will support more effective management of these taonga.
11. The programme is designed to support researchers, writers, creatives and specialists undertaking projects while connecting with the Maunga environment and wairuatanga.
12. The TMA Integrated Management Plan (IMP) and IMP Strategies set out key pathways to guide TMA decisions to support the residency programme
 - i. Tūpuna Maunga Values
 - Under Wairuatanga / Spiritual, a pathway to restoring and recognising the relationship between the Maunga and its people is by making the Tūpuna Maunga places for all people to come together and share common aspirations for the protection and restoration of these landscapes.
 - Under Mana Hononga Tangata / Living Connection - rekindle the sense of living connection between the Maunga and the people, give expression to the history and cultural values of the Tūpuna Maunga and Actively nurture positive relationships.
 - Under the Mana Aotūroa / Cultural and Heritage to support restoration of customary practices.
 - ii. Under Education strategy
 - Rekindling associations – Promote opportunities for mana whenua to tell the story.
 - Enable authentic mana whenua presence and building Mana Whenua Connection -

Mana whenua are at the heart of creating the cultural experience and explaining the values and significance of the Maunga.

- Education and information sharing programmes are proactive method of raising awareness, broadening engagement, collaboration and increase knowledge and experience on Maunga.

Residency Applicants

13. Each year The Centre will accommodate 2 TMA Residencies.

14. Candidates from the pools outlined below will be invited to apply

a) Mana Whenua Writers

- Mana Whenua Writers applications will be informed through the Centre application process. Applicants can indicate as part of their application whether they are part of 13 iwi and hapū Ngā Mana Whenua o Tāmaki Makaurau and with applicant's permission, The Centre will share applications with Tūpuna Maunga Authority for a decision.

- Management will send out the communications to Mana Whenua about the opportunity for TMA Residency.

b) Research Scholarship Applicants

- Following the submission of research scholarship applications, applicants will be informed to apply for TMA Residency.

c) Tūpuna Maunga Authority Specialist Projects

- Management will inform the suppliers delivering specialist projects for design, strategy and storytelling about the TMA Residency.

Funding and timeline

15. As part of the 2025/2026 Operational Plan, the Tūpuna Maunga Authority allocated \$54,504 towards delivering its educational strategies. Management proposes that a portion of that funding should be utilised for the TMA Residency and is requesting the Authority to allocate \$8,000 annually.

16. Funding Allocation: Funding would be allocated for The Centre accommodation and administration costs, and a stipend at living wage. Funding will be reviewed annually to ensure it reflects up to date costs.

17. Length of stay: The Centre offers standard two-week residency.

18. Timeline: Management propose that TMA Residency would align with the Research Scholarship and The Centre timelines, in August / September of each year that the fund is advertised, seeking applications from interested parties.

Evaluation

19. Applications would be initially reviewed by Management to determine their suitability and alignment. Management would then provide recommendations to the Tūpuna Maunga Authority to make a decision on the allocation.

20. Projects closely related for Takarunga / Mt Victoria or creating opportunities for Mana Whenua to tell their story will be prioritised.

21. Management evaluation panel is formed after application close with various subject matter experts.

End of Stay Reports

22. The residents will produce end of stay report that will be presented to the Authority. A standard template will be provided for consistency.

Next steps

23. If approved by the Authority, Management will work with MKWC to deliver the TMA Residency. The TMA Residency will be open for applications from 29 June 2026.

Attachments

There are no attachments for this report.

Research Policy Update

Author/s :

Rebecca Poi, Apiha Whakaae Kaupapa / Permit Processing and Engagement Officer
Challen Wilson – Te Pūtātara Waka Tairanga Whenua / Manager Co-Governance
Communications and Engagement

Purpose

1. To consider an updated Research Policy.

Recommendation

That the Tūpuna Maunga Authority:

- a. **note** the report.
- b. **approve** the updated Tūpuna Maunga Research Policy as set out in Attachment A to the report.

Background

2. The Tūpuna Maunga Research Policy was adopted at Hui 71 (14 February 2022).
3. The Research Policy states that the Tūpuna Maunga Authority will actively endorse research projects which align with the Tūpuna Maunga Values, as outlined in the Integrated Management Plan.
4. The Research Policy also states that it will create an annual pool of funding for which students can apply to support their research. This is called the Tūpuna Maunga Authority Research Scholarship.
5. Since adoption, the Tūpuna Maunga Authority Research Scholarship (Research Scholarship) has granted \$30,000 to seven researchers working across various disciplines.

Statutory Context

6. The Authority administers the Tūpuna Maunga under the Reserves Act 1977 and pursuant to Ngā Mana Whenua o Tāmaki Makaurau Collective Redress Act 2014. The Hauraki Gulf Marine Park Act 2000 is also relevant. Any decision to determine management within a reserve must consider the legislative and policy framework.
7. Section 109(2) of Ngā Mana Whenua o Tāmaki Makaurau Collective Redress Act 2014 requires the Authority to have regard to the spiritual, ancestral, cultural, customary, and historical significance of the maunga to Ngā Mana Whenua o Tāmaki Makaurau and that the Tūpuna Maunga is held in trust for Ngā Mana Whenua and the other people of Auckland.
8. The Tūpuna Maunga Authority's management of the Tūpuna Maunga is guided by an integrated statutory and strategic framework, including the Integrated Management Plan adopted under the Ngā Mana Whenua o Tāmaki Makaurau Collective Redress Act 2014 and the Reserves Act 1977, the Tūpuna Maunga Strategies adopted in September 2020, and the Hauraki Gulf Marine Park Act 2000; together these recognise and give effect to the cultural, spiritual, environmental, and intergenerational values of tangata whenua,

Item 4.6

with a primary focus on protecting the health and well-being of the Tūpuna Maunga while guiding education, biodiversity, recreation, design, commercial activity, monitoring, and wider catchment connections to the Hauraki Gulf.

Discussion

Research Policy update

9. Building on the background and statutory context outlined above, the management team has drafted an updated Research Policy and now seeks feedback from Authority members to inform its refinement prior to adoption.
10. The proposed update to the Research Policy is intended to remove barriers to access to the research scholarship and to better align the policy with, and deliver on, the strategic direction set out in the Tūpuna Maunga Strategies.
11. Proposed changes include: 1) expanding the definitions of research and researcher in order to increase potential research scholarship candidates, 2) to clearly state TMA's willingness to enter in partnerships with value-aligned businesses and organisations for the purpose of funding research on the Tūpuna Maunga, and 3) include Mana Hononga Tangata / Living Connection Value as a value within the Research Policy.

Next steps

12. If approved by the Authority, the updated Research Policy will go into effect effective immediately.

Attachments

- A. DRAFT Tūpuna Maunga Research Policy (updated 2026)

TŪPUNA MAUNGA RESEARCH POLICY

Policy

1. The Tūpuna Maunga Authority has adopted a policy that:
 - a. all research conducted on Tūpuna Maunga requires a permit from the Tūpuna Maunga Authority;
 - b. it will actively endorse research projects which align with the Tūpuna Maunga Values, as outlined in the Integrated Management Plan (amended 2022); and
 - c. it will create an annual pool of funding for which researchers can apply to support their research.
 - d. when appropriate, it will enter into partnerships with value-aligned businesses or organisations, to support research on the Tūpuna Maunga.
2. The policy does not affect any research held as an “Authorised Cultural Activity” pursuant to Ngā Mana Whenua o Tāmaki Makaurau Collective Redress Act 2014.

Background

3. The Ngā Mana Whenua o Tāmaki Makaurau Collective Redress Act 2014 legislated the transfer of ownership of 14 Tūpuna Maunga to Ngā Mana Whenua o Tāmaki Makaurau (the 13 hapū/iwi of Tāmaki Makaurau).
4. The Act establishes and appoints the Tūpuna Maunga Authority as the administering body for the Tūpuna Maunga under the Reserves Act 1977. In exercising its powers and carrying out its functions, the Maunga Authority must have regard to the spiritual, ancestral, cultural, customary, and historical significance of the Tūpuna Maunga to Ngā Mana Whenua o Tāmaki Makaurau.
5. The Tūpuna Maunga Authority is made up of 6 Mana Whenua representatives, 6 Auckland Council representatives and 1 non-voting Crown member. As the administering body, the Tūpuna Maunga Authority is responsible for decision-making and the governance of the Tūpuna Maunga and can implement its own policies on the Maunga.
6. The Policy applies to the Tūpuna Maunga being:
 - Matukutūruru/Wiri Mountain
 - Maungakiekie/One Tree Hill
 - Maungarei/Mount Wellington
 - Maungawhau/Mount Eden
 - Maungauika/North Head
 - Ōwairaka/Te Ahi-kā-a-Rakataura/ Mount Albert
 - Ōhinerau/Mount Hobson



- Ōhūiarangi/Pigeon Mountain
- Pukewīwī/Puketāpapa/Mount Roskill
- Te Ara Pueru/Te Pane-o-Mataaho/Mangere Mountain
- Te Kōpuke/Tītīkōpuke/Mount St John
- Takarunga/Mount Victoria
- Te Tātua a Riukiuta/Big King.
- Ōtāhuhu/Mount Richmond

Rationale

7. The purpose of the policy is to protect the sanctity, health, and well-being of the Tūpuna Maunga.
8. The Tūpuna Maunga Authority will endorse research projects which align with the Tūpuna Maunga Values because the research outputs will provide benefit to the Maunga, enhancing their mana and mauri.
9. The Authority administers the Tūpuna Maunga under the Reserves Act 1977 and pursuant to Ngā Mana Whenua o Tāmaki Makaurau Collective Redress Act 2014. The Hauraki Gulf Marine Park Act 2000 is also relevant.
10. Section 109(2) of Ngā Mana Whenua o Tāmaki Makaurau Collective Redress Act 2014 requires the Authority to have regard to the spiritual, ancestral, cultural, customary, and historical significance of the Maunga to Ngā Mana Whenua o Tāmaki Makaurau and that the Tūpuna Maunga is held in trust for Ngā Mana Whenua and the other people of Auckland.
11. The Tūpuna Maunga Authority's Integrated Management Plan (IMP) was adopted by the Authority in terms of Ngā Mana Whenua o Tāmaki Makaurau Collective Redress Act 2014 and the Reserves Act 1977. The Integrated Management Plan describes a series of "Values" and "Pathways" that guide all activities on the Tūpuna Maunga. The primary focus of the IMP is to protect the health and well-being of the Tūpuna Maunga. The "protection and enhancement of the mauri and wairua of the Tūpuna Maunga is paramount" (p57).
12. The policy is designed to align with the following Maunga values:
 - a) Wairuatanga / Spiritual. Relevant pathways for aligning to this value include: 1. Treat gently, and 2. Treat the Maunga as taonga tuku iho – treasures handed down the generations.
 - b) Mana Ao Tūroa / Cultural and Heritage Value. Relevant pathways for aligning to this value include: 1. Encourage culturally safe access.
 - c) Takotoranga Whenua / Landscape. Relevant pathways for aligning to this value include: 1. Protecting the integrity of the landscape of the Tūpuna Maunga, and 2. Preserve the visual and physical integrity of the Maunga as landmarks of Tāmaki.



- d) Mana Hononga Tangata / Living Connection Value. Relevant pathways for aligning to this value include: 1. Rekindle the sense of living connection between the maunga and the people, 2. Actively nurture positive relationships, and 3. Give expression to the history and cultural values of the Tūpuna Maunga.

Implementation

13. Management will regulate research permits to ensure the sites are well managed and do not conflict with other research or events.
14. Permits may be refused at the discretion of Management and may include any conditions necessary to protect the health and well-being of the Maunga.
15. Research permits may be subject to fees.
16. Management will have the delegation to approve research projects that are deemed low risk, meaning where:
 - a. an application is on the approved list of research projects (see 18); and
 - b. the methodology does not require any physical samples to be taken, such as the flora or fauna of the Maunga.
17. Research projects that fall outside of the scope of being low risk will require approval from the Tūpuna Maunga Research, Events and Commercial Activities Rōpū (previously the Filming and Events Rōpū) and will require Mana Whenua feedback to inform the final decision.
18. As per the Monitoring Strategy (identified in the IMP), Management is required to provide a list of research projects for students to undertake as part of their qualifications. This list is included as an attachment to this policy and will be subject to regular review.
19. The Tūpuna Maunga Authority will provide an annual funding pool of up to \$10,000, to be allocated to one or more applicants on the merits of their applications, subject to funding availability and prevailing circumstances.
20. Additional funding and research opportunities may be available through partnerships with value-aligned businesses or organisations. Additional funding will be communicated as a part of the annual promotion of the Tūpuna Maunga Authority Research Scholarship.

Definitions

21. In this policy, research' means any activities on or relating to the Maunga such as the collection of physical samples, the monitoring of conditions over time, experiments, creative pursuits, or any socially focussed studies which take place on the Maunga but fall outside the scope of an event.
22. In this policy, researcher' means a person or group of people who conducts research. Researchers can be a part of a formal research institution, such as a university or polytechnic, or outside of one, such as independent researchers, community researchers, or iwi researchers.

Māori Education Trust Partnership

Author/s :

Rebecca Poi, Apiha Whakaae Kaupapa / Permit Processing and Engagement Officer
Challen Wilson – Te Pūtātara Waka Tairanga Whenua / Manager Co-Governance
Communications and Engagement

Purpose

1. To consider a partnership opportunity between the Tūpuna Maunga Authority and the Māori Education Trust, to increase the overall amount for the Tūpuna Maunga Authority Research Scholarship.

Recommendation

That the Tūpuna Maunga Authority:

- a. **note** the report.
- b. **approve** the partnership between the Māori Education Trust for the 2026/27 Research Scholarship onwards as set out in the report.

Background

2. The Tūpuna Maunga Research Policy was adopted at Hui 71 (14 February 2022).
3. Alongside the policy, the Tūpuna Maunga Authority agreed to make up to \$10,000 available annually to contribute to research projects deemed to be beneficial for the Tūpuna Maunga.
4. Aims of the scholarship include:
 - a) provide opportunities for public to engage with the maunga as a space of learning and discovery,
 - b) support student learning, and
 - c) help gather detailed, site-specific information which supports effective management of the maunga.

Statutory Context

5. The Authority administers the Tūpuna Maunga under the Reserves Act 1977 and pursuant to Ngā Mana Whenua o Tāmaki Makaurau Collective Redress Act 2014. The Hauraki Gulf Marine Park Act 2000 is also relevant. Any decision to determine management within a reserve must consider the legislative and policy framework.
6. Section 109(2) of Ngā Mana Whenua o Tāmaki Makaurau Collective Redress Act 2014 requires the Authority to have regard to the spiritual, ancestral, cultural, customary, and historical significance of the maunga to Ngā Mana Whenua o Tāmaki Makaurau and that the Tūpuna Maunga is held in trust for Ngā Mana Whenua and the other people of Auckland.
7. The Tūpuna Maunga Authority's management of the Tūpuna Maunga is guided by an integrated statutory and strategic framework, including the Integrated Management Plan adopted under the Ngā Mana Whenua o Tāmaki Makaurau Collective Redress Act 2014

Item 4.7

and the Reserves Act 1977, the Tūpuna Maunga Strategies adopted in September 2020, and the Hauraki Gulf Marine Park Act 2000; together these recognise and give effect to the cultural, spiritual, environmental, and intergenerational values of tangata whenua, with a primary focus on protecting the health and well-being of the Tūpuna Maunga while guiding education, biodiversity, recreation, design, commercial activity, monitoring, and wider catchment connections to the Hauraki Gulf.

Discussion

Proposed Partnership

8. Management proposes a partnership be entered between the Tūpuna Maunga Authority and the Māori Education Trust for the 2026/27 Research Scholarship onwards.
9. The Māori Education Trust (MET) was established as the Māori Education Foundation in 1961, under the Māori Education Foundation Act 1961. In 1993 the Māori Education Trust Deed superseded the 1961 Act, and the MET has been operational under that name since.
10. The MET have various partnerships with iwi, land trusts, and educational institutes, with an overall objective of encouraging Māori into tertiary education. Since 1963, the MET has awarded 65,000 scholarships to Māori students.
11. This partnership has the potential to increase the funding pool up to \$20,000, through the Māori Education Trust matching funding for Māori tertiary-level scholarship recipients.
12. MET's financial contribution is dependent on the amount of money that Māori applicants are awarded by the Tūpuna Maunga Authority. MET will provide equivalent funding for Māori applicants up to \$10,000.
13. The Authority will retain full decision-making power over the scholarship programme.
14. This proposed partnership with MET supports the implementation of the Education Strategy, through the promotion of the whakapapa of Ngā Mana Whenua. Additional funding for Māori applicants, provided by the MET, increases the opportunity for Ngā Mana Whenua o Tāmaki Makaurau to connect with the Tūpuna Maunga.
15. Management have worked on improving the scholarship based on feedback from the Authority at Hui 100, such as the addition of a fluent te reo Māori speaker and academic to the scholarship panel, to review applications in both te reo Māori and English. Management have worked with the Māori Education Trust to streamline communications, to ensure TMA brand visibility and scholarship ownership, and details on previous recipients have been added to the website.

Next steps

16. If the Authority approves this partnership, a partnership agreement will be signed between Management and the Māori Education Trust. This partnership will be implemented into the 2026/2027 scholarship round, which opens for applications on 29 June 2026.

Attachments

There are no attachments for this report.

Item 4.7

Delegation to the Co-Chairs and Deputy Chair for licencing decisions under the Reserves Act 1977

Author/s :

Dominic Wilson, Te Tauihu Waka Tairanga Whenua / Co-Governance Manager
Bizhan Rahnama, Kaitohutohu Tupuna Maunga / Co-Governance Advisor

Purpose

1. To consider and approve a delegation for Reserves Act 1977 licence approvals relating to Tūpuna Maunga, to enable timely and efficient decision making.

Recommendation

That the Tūpuna Maunga Authority:

- a. **delegate** to the Co-Chairs and Deputy Chair jointly, the power to consent to the granting of licences (as delegated by the Minister of Conservation) under the Reserves Act 1977; and
- b. **delegate** to the Co-Chairs and Deputy Chair jointly, the power to grant licences under the Reserves Act 1977 including, but not limited to, the powers under ss 54, 58A 74 of the Reserves Act.

Background

2. The Tūpuna Maunga are held as reserves under the Reserves Act 1977. The Maunga are presently held under three types of reserves: Recreation, historic, and local purpose.
3. Section 111 of the Ngā Mana Whenua o Tāmaki Makaurau Collective Redress Act 2014 provides that:
 - (1) The Maunga Authority may exercise or perform, in relation to the maunga and the administered lands, a power or function—
 - (a) that the Minister of Conservation has delegated to all local authorities under section 10 of the Reserves Act 1977; and
 - (b) that is relevant to the maunga and the administered lands.
 - (2) The delegation applies to the Maunga Authority with all necessary modifications.
4. Section 40 of the Reserves Act 1977 (the Act) establishes the primary statutory obligations of an administering body, requiring it to administer, manage, and control a reserve in accordance with the Act. This includes ensuring the appropriate use and enjoyment of the reserve, while also providing for its development, maintenance, protection, and preservation.
5. The Act also provides powers to the administering body to grant licences in exercise of those functions, subject to other statutory requirement like public notice and objections.
6. Licensing decisions must be made within the statutory authority provided under the Act, be consistent with the reserve's classification and purpose, and be exercised in accordance with the administering body's duty to administer, manage, and control the reserve under section 40 and consistent with Ngā Mana Whenua o Tāmaki Makaurau Collective Redress Act 2014.

Item 4.8

7. Under the Reserves Act 1977 depending upon the type of reserve (eg historic, recreation, or local purpose) the Maunga Authority may determine whether parts of the Tūpuna Maunga may be licensed for use, including commercial or other activities, with the relevant decision-making powers transferred from the Minister to the Maunga Authority. Licences are usually temporary grants to individuals or companies to carry out activities. Licences do not provide exclusive use of any reserve.
8. Management have become aware that there is presently no delegation to allow the determination of licence applications that are made between Authority hui.

Statutory and other considerations

9. Any decision to determine management within a reserve must take into account the legislative and policy framework.
10. Section 109(2) of Ngā Mana Whenua o Tāmaki Makaurau Collective Redress Act 2014 requires the Authority to have regard to the spiritual, ancestral, cultural, customary, and historical significance of the Maunga to Ngā Mana Whenua o Tāmaki Makaurau and that the Tūpuna Maunga is held in trust for Ngā Mana Whenua and the other people of Auckland.
11. The Tūpuna Maunga Authority's Integrated Management Plan was unanimously adopted (Mana Whenua and Auckland Council members) by the Authority pursuant to the Ngā Mana Whenua o Tāmaki Makaurau Collective Redress Act 2014 and Reserves Act 1977. The Integrated Management Plan describes a series of "Values" and "Pathways" that guide all activities on the Tūpuna Maunga.
12. The Tūpuna Maunga Authority (Mana Whenua and Auckland Council members) unanimously adopted the Tūpuna Maunga Strategies at Hui 50 on 25 September 2020. The Tūpuna Maunga Strategies are 7 key sections that outline the strategic direction with regards to education, Biodiversity, Tūpuna Maunga design, Recreation, commercial activities and monitoring. Together with the IMP, these strategies inform guide and manage the activities undertaken on the Maunga.
13. The Authority administers the Tūpuna Maunga under the Reserves Act 1977 and pursuant to Ngā Mana Whenua o Tāmaki Makaurau Collective Redress Act 2014. The Hauraki Gulf Marine Park Act 2000 is also applicable in relation to Maungauika.

Reserves Act 1977 considerations

14. Section 54 (recreation), s58A (historic), and s74 (recreation, historic, and local purpose) provide the Authority with powers to offer licences for various activities on reserves.
15. Section 54 allows for licences to be granted for any trade, business or occupation on a recreation reserve.
16. Section 58A(1) of the Act provides that the Authority may grant licences over historic reserves for specified uses.
17. Section 58A(2) of the Act states that any such licence must be consistent with the preservation and protection of the reserve's historic, archaeological, cultural, and natural values.

Item 4.8

18. Section 58A(3)–(6) of the Act sets out the procedural requirements, including public notification and the opportunity to make submissions or objections, unless an exception to notification applies.
19. Section 74 allows the Authority to grant temporary licences to occupy the Maunga.

Discussion

Licence application for the Tūpuna Maunga

20. Licensing matters arise regularly as part of the normal operational activity on the Munga, including licence renewal, minor amendments, and administrative approvals. These matters are often time-sensitive and may be constrained by the Authority's hui cycle, resulting in avoidable delays.
21. Management have received feedback from the public in relation to licencing and acknowledge that timing of the Authority's hui cycles can contribute to delay in progressing licencing approvals. In some instances, this creates a procedural constraint on routine, operational decision-making processes.
22. Management propose a delegation for licence approvals to enable timely and efficient decision-making, reducing delays between the Authority's hui cycles. All decisions on leases (which can provide exclusive and long-term rights and occupation on the Maunga) will remain with the Authority.

Delegation

23. Management recommend that the Maunga Authority authorises the Co-Chairs and Deputy Chair to make decision on licencing matters, including the approval and signing off licence under section 54, 58A and 74 of the Act. This would mean decisions could be made between Authority hui by the Co-Chairs and or Deputy Chair.

Attachments

There are no attachments for this report.

Registers

Author/s :

Tai Stirling, Kaihautu Hotaka Tupuna Maunga
Rebecca Poi, Apiha Whakaae Kaupapa / Permit Processing and Engagement Officer
Challen Wilson – Te Pūtātara Waka Tairanga Whenua / Manager Co-Governance
Communications and Engagement

Purpose

1. To consider update registers for:
 - a. Health & Safety (Attachment A)
 - b. Events (Attachment B)

Recommendation

That the Tūpuna Maunga Authority:

- a. **note** the attached Registers, which have been updated since Hui 103 (30 March 2026).

Background

Discussion

Attachments

- A. Health and Safety Register
- B. Events Register

Item 4.9

Health and Safety Register

Hui reported to	Maunga	Summary of incident	Number of any near misses	Outcome of investigations into any incidents and near misses	Health and Safety management matters arising	Actions Taken
Hui 105	Maungawhau	<p>On 1 May, an incident occurred where a parked van on the Clive Road exit had its back window smashed and broken into.</p> <p>She was a tourist, and it appears that her possessions were found nearby and thrown in the rubbish bin at the hospital.</p>		The tourist reported the incident to the police.	Potential risk to manuhiri.	Management is considering signage to raise awareness and prevent similar incidents from occurring again.
Hui 103	Maungawhau	<p>Serious incident in the afternoon on 5 February involving two pedestrians and a vehicle which resulted in injuries.</p> <p>A tourist minibus/van was disembarking passengers behind the toilet block, where a car was following closely behind. While the pedestrians were crossing the road, two of them were hit by the car.</p>		<p>This serious incident was caused by the minibus driver's actions of not parking in the allocated bus bays on the Maunga.</p> <p>As such, the investigation is ongoing and a police incident report has been logged.</p>	Injuries to passengers were sustained from this incident.	<p>The TMA operations team has contacted Police for more information about this incident.</p> <p>Summer Field Officers will monitor the area during busy periods on the Maunga, communications will be sent out to bus companies that operate on the Maunga regarding improper offloading of passengers and where they need to be stopping.</p>
Hui 102	Maungakiekie	<p>Serious incident in the early hours of September 1st, a large Macrocarpa at the archery club uprooted in the wind event. As the tree fell, it caused significant damage to the archery club building and the heritage stone wall at the base of the tree. No one was in the vicinity at the time of the incident. One of many examples where uprooting trees cause risk to persons and the whenua.</p>		This serious incident was due to the significant wind event that hit the area on the stated weekend, causing the uprooting of the Macrocarpa. These trees are very large and are exposed to some of the prevailing wind.	No injuries from the incident but there was potential for significant risk to members of the public if it happened at a busier time. An example of significant risks posed by uprooting trees to people and the whenua.	<p>The TMA Ops team had Treescape response to the incident and remove the tree from where it was positioned. Our Capex team also supported with doing response propping work in the building to ensure it was safe for items to be removed from the building. AAC are now having a building assessment done.</p> <p>A thorough risk assessment of this windbreak line of Macrocarpas had been commissioned through August and was at its conclusion when this tree uprooted. We have a full understanding of the structural health of these trees, provided by this report and will be ensuring we mitigate any risks highlighted.</p>
Hui 102	Titikōpuke	<p>During the same wind event, a large Eucalyptus tree has had a significant split-out with a portion of the tree falling over the Maunga boundary and partially damaging a shared fenceline and light pole.</p>		This incident was due to the significant wind event that hit the area on the stated weekend, causing the split-out of the Eucalyptus.	No injuries from the incident. This location is in an area that is fenced off from the general public so there was minimal risk of injury where it fell.	A plan is being put in place to remove the split-out and the rest of the tree. It is a more complex removal that will require helicopter work that is still in the planning phase.
Hui 101	Maungauika	<p>A serious incident: 07:45am, 21st May a DoC vehicle collided with the bottom swing arm gate as it was leaving the DoC sheds. The steel arm has penetrated into the cabin through the windshield and caused</p>		This was a serious incident that required a fulsome inquiry. The Incident investigation has closed and actions assigned and enacted. A number of factors caused this incident with the main element being the	Potential injury to DoC kaimahi.	To remove this risk, swing gates on Maungauika have been painted white for high contrast visibility, latch posts have been instated to secure gate arms and vegetation has been cut back to improve visibility.

Hui reported to	Maunga	Summary of incident	Number of any near misses	Outcome of investigations into any incidents and near misses	Health and Safety management matters arising	Actions Taken
		significant front quarter panel damage. Driver was unharmed but very shaken up.		swing arm not secured when in the open position.		
Hui 101	Ōhinerau	One of the Green by Nature facility kaimahi was verbally abused and assaulted on the maunga.		The investigation is ongoing; nonetheless, the kaimahi logged the incident in Donesafe and filed a police report.	Injury to contractor.	Reinforcement of safety protocols during contractor's toolbox hui. Management has notified the council's health, safety and wellbeing team for assistance and viable solutions.
Hui 101	Maungarei	While edging Winifred Huggins' tracks, the Green by Nature contractor hit a rock, which then struck its glasses.		Near miss; the contractor was wearing protective goggles, protecting the worker from more serious injury.	Potential injury to contractor.	Reinforcement of safety protocols and personal protective equipment (PPE) requirements when doing this mahi at the contractor's toolbox hui.
Hui 101	Ōwairaka / Te Ahi-kā-a-Rakataura	While driving around Summit Drive, a dog ran up to the Green by Nature truck and began barking.		Near miss.	Potential risk to contractor and manuhiri.	Management to install more signage reminding of dog control rules, with an emphasis on the sports field. Continue to work with Animal Control for protection of contractors and the public.
Hui 99	Te Pane o Mataoho / Te Ara Pueru	The Green by Nature contractor was approaching the hill's brow when an off-leash dog charged at its mower; the contractor stopped about five metres away.		Near miss; it may have bitten the contractor.	Potential risk to contractor and manuhiri.	Management to notify the council's animal management team for assistance, viable solutions including enforcement action, as well as potential additional signage.
Hui 99	Maungawhau	Dog came racing and barking at Green by Nature contractor.		Near miss; it may have bitten the contractor.	Potential risk to contractor and manuhiri.	Management to notify the council's animal management team for assistance, viable solutions including enforcement action, as well as potential additional signage.

Events Register

Hui reported to	Maunga	Applicant	Event Description	Event Date	Status	Revenue
Hui 105	Te Pane o Mataoho	Mycesan Salatielu / ANZAC Day Dawn Service	Community	25 th of April 2026	Approved	\$0
Hui 105	Te Pane o Mataoho	Hayley Simpson / Māngere Bridge ANZAC Service	Community	25 th of April 2026	Approved	\$0
Hui 105	Maungauika	Michelle Chen / Wedding – Lovers Cove	Private	22 nd of April 2026	Approved	\$0
Hui 105	Maungawhau	Richard Taylor / Wayne Taylor Band Gig	Community	19 th of April 2026	Approved	\$0
Hui 105	Maungarei	Ashleigh Matthews / NZ Olympic Committee – Social Media Video	Community	13 th of April 2026	Approved	\$190
Hui 105	Maungakiekie	Hannah Grave / Roady for Roadies Fundraiser	Community	10 th of April 2026	Approved	\$0
Hui 105	Ōwairaka	Tani Haunga / Mt Albert Presbyterian – Dawn Easter Service	Community	5 th of April 2026	Approved	\$0
Hui 105	Takarunga	Robyn Holt / Devonport Combined Churches – Good Friday Stations of the Cross	Community	3 rd of April 2026	Approved	\$0
Hui 105	Te Pane o Mataoho	Teresa Ah Wa / Māngere Catholic Parishes - Good Friday Stations of the Cross	Community	3 rd of April 2026	Approved	\$0
Hui 105	Maungauika, Takarunga	Tabitha Coleman / Devonport Business Association Filming	Community	30 th of March 2026	Approved	\$0
Hui 103	Te Tātua-a-Riukiuta	Nikita Jones / Urban Ark and Friends of Te Tātua-a-Riukiuta – Conservation Event	Community	29 th of March 2026	Approved	\$0
Hui 103	Te Pane o Mataoho	Avele Aukilani / ACOPA Auckland Walkathon	Community	28 th of March 2026	Approved	\$0
Hui 103	Puketāpapa	Zain Ali / End of Ramadan Moon Sighting	Community	20 th of March 2026	Approved	\$0
Hui 103	Takarunga	Lance Calbk / Restoring Takarunga Hauraki – Night Hīkoi	Community	14 th of March 2026	Approved	\$0
Hui 103	Maungakiekie	Maharookh / Auckland Home Educators Picnic	Community	6 th of March 2026	Approved	\$0

Hui reported to	Maunga	Applicant	Event Description	Event Date	Status	Revenue
Hui 103	Maungawhau	Justine Harvey / Cuban Groove Dance Event	Community	28 th of February 2026	Approved	\$0
Hui 103	Te Pane o Mataoho	Eric PaoYu Chou / Hakka Society Event	Community	28 th of February 2026	Approved	\$0
Hui 103	Maungakiekie	Iain Hook / Maungakiekie Songbird Event	Community	28 th of February 2026	Approved	\$0
Hui 103	Maungakiekie	James Shin / Community Wellness Walk	Community	28 th of February 2026	Approved	\$0
Hui 103	Maungakiekie	Ben Bradford / Te Whatu Stardome – Food Truck Summer Sessions	Community	14 th of February 2026	Approved	\$0
Hui 103	Maungakiekie	Catherine Grey / Auckland Libraries – Mobile Library Pop-up	Community	22 nd of January 2026	Approved	\$0
Hui 103	Maungakiekie	Catherine Grey / Auckland Libraries – Mobile Library Pop-up	Community	15 th of January 2026	Approved	\$0
Hui 103	Maungakiekie / Maungawhau	Garreth Collard / Latter Day Saints Convention – Maunga Tours	Community	8 th of January 2026	Approved	\$580
Hui 103	Maungakiekie	Catherine Grey / Auckland Libraries – Mobile Library Pop-up	Community	6 th of January 2026	Approved	\$0
Hui 103	Maungawhau	Dillon Blair / Conservation Volunteers NZ – Appreciation Picnic	Community	9 th of December 2025	Approved	\$0
Hui 103	Te Pane o Mataoho	Davina KIDS Christmas Picnic	Community	5 th of December 2025	Approved	\$0
Hui 103	Maungawhau	Richard Taylor / Wayne Taylor Band Gig	Community	16 th of November 2025	Approved	\$0
Hui 103	Maungakiekie	Sia Siafa / Watercare Christmas Party	Community	29 th of November 2025	Approved	\$0
Hui 103	Maungarei	Justin Barton / NZMA Sylvia Park Student Wellness Run	Community	5 th of November 2025	Approved	\$0
Hui 103	Maungakiekie	Iain Hook / Maungakiekie Songbird Event	Community	18 th of October 2025	Approved	\$0
Hui 103	Maungauika	Amber Greaves / Devonport Half Marathon	Commercial	5 th of October 2025	Approved	\$1200

Hui reported to	Maunga	Applicant	Event Description	Event Date	Status	Revenue
Hui 103	Ōtāhuhu	Jenni Heka-Beazley / Ki-o-Rahi Tournament	Community	4 th of October 2025	Approved	\$0
Hui 102	Maungawhau	Joy Stirling / Peace Walk	Community	21 st of September 2025	Approved	\$0
Hui 102	Maungauika	Auckland Coastal Defences Historical Trust / Auckland Heritage Festival - Maungauika Coastal Defences Tour	Community	20 th & 21 st of September 2025	Approved	\$0
Hui 102	Ōtāhuhu	Dane Maera / Tāmaki Makaurau Senior Regionals Ki-o-rahi	Community	16 th of September 2025	Approved	\$0
Hui 102	Ōhuirangi	Lochlan Hynd / Engineering for Everyone Filming	Community	3 rd of September 2025	Approved	\$0
Hui 102	Maungauika	Dion Jelley / North Shore Marathon	Community	31 st of August 2025	Approved	\$900
Hui 102	Maungarei	Steff Holcroft / Northern Schools Cycling Tour	Community	30 th of August 2025	Approved	\$630
Hui 102	Maungakiekie	Lee Askew-Burrell / Watercare Winnovators Fun Run	Community	2 nd of August 2025	Approved	\$0
Hui 101	Maungawhau	Ryan Roelants / Metro Films – Photography	Commercial	23 rd of July 2025	Approved	
Hui 101	Te Tātua-a-Riukiuta	TMA / Community Planting	Community	20 th of July 2025	Approved	\$0
Hui 101	Maungawhau	Lucy Cacciopoli / Precinct Property Shoot	Commercial	18 th of July	Approved	\$600
Hui 101	Te Tātua-a-Riukiuta	TMA / Community Planting	Community	13 th of July 2025	Approved	\$0
Hui 101	Ōhinerau	TMA / Organisation Planting	Organisation	10 th of July 2025	Approved	\$0
Hui 101	Maungakiekie	Gabrielle Lynam-Smith / Stardome Drone Filming	Community	9 th of July 2025	Approved	\$0
Hui 101	Pukewīwī	John Sutton / Manu Aute Kite Day	Community	6 th of July 2025	Approved	\$0
Hui 101	Pukewīwī	Alinne Hernandez Parades / Really Really Free Shop Market Day	Community	29 th of June 2025	Approved	\$0

Hui reported to	Maunga	Applicant	Event Description	Event Date	Status	Revenue
Hui 101	Te Pane o Mataoho	TMA / Community Planting	Community	29 th of June 2025	Approved	\$0
Hui 101	Te Pane o Mataoho	TMA / Love Your Maunga Community Hāngī Fundraiser	Community	28 th of June 2025	Approved	\$0
Hui 101	Maungarei	Johannah Rawiri / Ngāti Paoa Matariki Kaupapa	Mana Whenua	22 nd of June 2025		
Hui 101	Te Pane o Mataoho	Oriana Hansell-Pune / Sylvia Park School Event	Community	19 th of June 2025	Approved	\$280
Hui 101	Maungarei	Rama Hammond / Ventia Matariki Hīkoi	Commercial	19 th of June 2025	Approved	\$0
Hui 101	Takarunga	TMA / Takarunga School Planting	Community	19 th of June 2025	Approved	\$0
Hui 101	Pukewīwī	Jackie-Jade Sio / Mount Roskill School Matariki Hīkoi	Community	18 th of June 2025	Approved	\$0
Hui 101	Ōwairaka	Sheryl Fletcher / Ōwairaka District School Matariki Hīkoi	Community	18 th of June 2025	Approved	\$0
Hui 101	Te Pane o Mataoho	TMA / Community Planting	Community	7 th of June 2025	Approved	\$0
Hui 101	Te Pane o Mataoho	Ritua Aliivaa / Hāngī Fundraiser – Collegiate Netball Club	Community	7 th of June 2025	Approved	
Hui 101	Takarunga	Madelaine Crawford / Devonport Community House Matariki Hīkoi	Community	7 th of June 2025	Approved	\$0
Hui 101	Maungawhau	Snehalata Thakur / Engineering Surveying Practical	Community	1 st of June 2025	Approved	\$0
Hui 101	Maungauika	Brendon William Butt / Kahawai Productions – Matariki Filming	Commercial	22 nd of May 2025	Approved	
Hui 99	Maungawhau	Snehalata Thakur / Engineering Surveying Practical	Community	22 nd of May 2025	Approved	\$0
Hui 99	Maungawhau	Snehalata Thakur / Engineering Surveying Practical	Community	21 st of May 2025	Approved	\$0
Hui 99	Maungawhau	Snehalata Thakur / Engineering Surveying Practical	Community	15 th of May 2025	Approved	\$0

Hui reported to	Maunga	Applicant	Event Description	Event Date	Status	Revenue
Hui 99	Maungawhau	Snehalata Thakur / Engineering Surveying Practical	Community	14 th of May 2025	Approved	\$0
Hui 99	Maungawhau	Snehalata Thakur / Engineering Surveying Practical	Community	8 th of May 2025	Approved	\$0
Hui 99	Maungakiekie	Shad Samsuya / Oranga School Hīkoi	Community	5 th of May 2025	Approved	\$0
Hui 99	Te Pane o Mataaoho	Ritua Aliivaa / Hāngī Fundraiser – Collegiate Netball Club	Community	3 rd of May 2025	Approved	
Hui 99	Maungawhau	Snehalata Thakur / Engineering Surveying Practical	Community	1 st of May 2025	Approved	\$0
Hui 99	Maungawhau	Snehalata Thakur / Engineering Surveying Practical	Community	30 th of April 2025	Approved	\$0
Hui 99	Te Pane o Mataaoho	Mycesan Salatielu / ANZAC Day Dawn Service	Community	25 th of April 2025	Approved	\$0
Hui 99	Maungawhau	Snehalata Thakur / Engineering Surveying Practical	Community	24 th of April 2025	Approved	\$0
Hui 99	Ōwairaka	Tani Haunga / Presbyterian Easter Sunday Dawn Service	Community	20 th of April 2025	Approved	\$0
Hui 99	Takarunga	Robyn Holt / Combined Churches of Devonport Good Friday Procession	Community	18 th of April 2025	Approved	\$0
Hui 99	Te Pane o Mataaoho	Teresa Ah Wa / Good Friday Service	Community	18 th of April 2025	Approved	\$0
Hui 99	Maungawhau	Richard Taylor / Wayne Taylor Band Gig	Community	13 th of April 2025	Approved	\$0