

Date: Monday, 23 August 2021
Time: 3.00pm
Venue: Online via Zoom

TŪPUNA MAUNGA O TĀMAKI MAKĀURAU AUTHORITY

HUI 66 – 23 August 2021

Open Agenda

Chairperson	Paul Majurey	Ngā Mana Whenua o Tāmaki Makāurau (Marutūāhu Rōpū)
Deputy Chairperson	Cr Alf Filipaina	Auckland Council (Governing Body)
Members	Cr Josephine Bartley	Auckland Council (Governing Body)
	Cr Dr Cathy Casey	Auckland Council (Governing Body)
	Toni Van Tonder	Auckland Council (Devonport-Takapuna Local Board)
	Chris Makoare	Auckland Council (Maungakiekie-Tāmaki Local Board)
	Lemauga Lydia Sosene	Auckland Council (Chair – Māngere-Ōtāhuhu Local Board)
	Hauāuru Rawiri	Ngā Mana Whenua o Tāmaki Makāurau (Marutūāhu Rōpū)
	Bernadette Papa	Ngā Mana Whenua o Tāmaki Makāurau (Ngāti Whātua Rōpū)
	Clay Hawke	Ngā Mana Whenua o Tāmaki Makāurau (Ngāti Whātua Rōpū)
	Zaelene Maxwell-Butler	Ngā Mana Whenua o Tāmaki Makāurau (Waiohūa-Tāmaki Rōpū)
	Dennis Kirkwood	Ngā Mana Whenua o Tāmaki Makāurau (Waiohūa-Tāmaki Rōpū)

ITEM TABLE OF CONTENTS

1. Apologies
2. Declarations of Interest
3. Confirmation of minutes
4. Takarunga Visitor Facilities
5. Takarunga/ Mt Victoria Track Upgrade
6. Ōwairaka/ Te Ahi-ka-a-Rakataura / Mt Albert Track Upgrade
7. Onehunga Māngere United Sports Club lease
8. Planting update
9. Registers
 - A Health & Safety
 - B Events

(Quorum is 7 members, comprising the chair or deputy chair and 2 members appointed by the rōpū entities and 2 members appointed by Auckland Council)

Ngā Mana Whenua o Tāmaki Makaurau Collective Redress Act 2014

109 Functions and powers

- (1) The Maunga Authority has the powers and functions conferred on it by or under this Act or any other enactment.
- (2) In exercising its powers and carrying out its functions in relation to the maunga, the Maunga Authority must have regard to—
 - (a) the spiritual, ancestral, cultural, customary, and historical significance of the maunga to Ngā Mana Whenua o Tāmaki Makaurau; and
 - (b) section 41(2).
- (3) In exercising its powers and carrying out its functions in relation to the administered lands, the Maunga Authority must have regard to the spiritual, ancestral, cultural, customary, and historical significance of the administered lands to Ngā Mana Whenua o Tāmaki Makaurau.

[Emphasis added]

41 Maunga must remain as reserves vested in trustee

- (1) This section applies to each maunga once the maunga is—
 - (a) vested in the trustee under subpart 1, 2, or 3 of this Part;and
 - (b) declared a reserve under any of sections 18 to 29, 33, and 39.
- (2) The maunga is held by the trustee for the common benefit of Ngā Mana Whenua o Tāmaki Makaurau and the other people of Auckland.

...

[Emphasis added]



Key

- Tūpuna Maunga
- Local board boundaries and geographic areas

Tūpuna Maunga Reserve Status*

The following Tūpuna Maunga, with the relevant reserve status, are classified as reserves subject to the Reserves Act 1977

Maunga	Reserve Status
Matukutūruru	Historic reserve
Maungakiekie / One Tree Hill	Recreation reserve
Maungarei / Mt Wellington	Recreation reserve, Local Purpose reserve
Maungawhau / Mount Eden	Historic reserve, Recreation reserve
Maungauika / North Head	Historic reserve
Ōwairaka / Te Ahi-kā-a-Rakataura / Mount Albert	Recreation reserve
Pukewīwī / Puketāpapa / Mount Roskill	Recreation reserve
Te Kōpuke / Tītīkōpuke / Mount St John	Recreation reserve
Ōhinerau / Mount Hobson	Recreation reserve
Ōhūiarangi / Pigeon Mountain	Historic reserve, Recreation reserve, Local Purpose reserve
Ōtāhuhu / Mount Richmond	Recreation reserve
Takarunga / Mount Victoria	Recreation reserve, Local Purpose reserve
Te Tātua-a-Riukiuta / Big King	Recreation reserve
Te Ara Pueru / Te Pane-o-Mataaho / Mangere Mountain	Historic reserve, Recreation reserve, Local Purpose reserve
Rarotonga / Mount Smart	Recreation reserve

* See sections 18-29, 33 (repealed), 39, 41, 47, 53, 54, and Schedules 1 & 2, 6 of Ngā Mana Whenua o Tāmaki Makaurau Collective Redress Act 2014



Date:

Monday, 26 July 2021

Time:

3.00pm

Venue:

Reception Lounge

Level 2, Auckland Town Hall

301 Queen Street, Auckland

TŪPUNA MAUNGA O TĀMAKI MAKĀURAU AUTHORITY

HUI 65 – 26 July 2021

Open Minutes

Chairperson

Deputy Chairperson

Members

Paul Majurey

Cr Alf Filipaina

Cr Josephine Bartley

Cr Dr Cathy Casey

Toni Van Tonder

Chris Makoare

Lemauga Lydia Sosene

Hauāuru Rawiri

Ngā Mana Whenua o Tāmaki Makaurau (Marutūāhu Rōpū)

Auckland Council (Governing Body)

Auckland Council (Governing Body) via Skype

Auckland Council (Governing Body)

Auckland Council (Devonport-Takapuna Local Board)

Auckland Council (Maungakiekie-Tāmaki Local Board)

Auckland Council (Chair – Māngere-Ōtāhuhu Local Board)

Ngā Mana Whenua o Tāmaki Makaurau (Marutūāhu Rōpū)

APOLOGIES

Clay Hawke

Bernadette Papa

Dennis Kirkwood

Zaelene Maxwell-Butler

Ngā Mana Whenua o Tāmaki Makaurau (Ngāti Whātua Rōpū)

Ngā Mana Whenua o Tāmaki Makaurau (Ngāti Whātua Rōpū)

Ngā Mana Whenua o Tāmaki Makaurau (Waiohūa-Tāmaki Rōpū)

Ngā Mana Whenua o Tāmaki Makaurau (Waiohūa-Tāmaki Rōpū)

1. Apologies

MOVED by Cr C Casey, SECONDED by Member C Makoare

That the Tūpuna Maunga Authority:

- a) **accept** the apologies of Clay Hawke, Dennis Kirkwood, Bernadette Papa and Zaelene Maxwell-Butler for absence.

CARRIED

2. Declarations of Interest

There were no declarations of interest.

3. Confirmation of Minutes

MOVED by Cr C Casey, SECONDED by Member C Makoare

That the Tūpuna Maunga Authority:

- a) **confirm** the minutes of Hui 64 held on Monday, 31 May 2021, as a true and accurate record.

CARRIED

4. Operational Plan 2021-22 and 10-year budget 2021-2031

MOVED by Member T Van Tonder, SECONDED by Member H Rawiri

That the Tūpuna Maunga Authority:

- a) **note** that the Tūpuna Maunga Authority's Operational Plan 2021/22 has been agreed.

CARRIED

5. Tūpuna Maunga planting update

MOVED by Deputy Chairperson Cr A Filipaina, SECONDED by Member L Sosene

That the Tūpuna Maunga Authority:

- a) **note** the report.

CARRIED

6. **Maunga furniture design**

MOVED by Chairperson P Majurey, SECONDED by Member C Makoare

That the Tūpuna Maunga Authority:

- a) **approve** the design and intent of the furniture suite as presented.

CARRIED

7. **Puketāpapa Kite Day and Ficino School cross-country event permits**

MOVED by Cr C Casey, SECONDED by Deputy Chairperson Cr A Filipaina

That the Tūpuna Maunga Authority:

- a) **resolve** to grant a five year permit to the Puketāpapa Local Board and Ficino School to hold their events at the respective locations, Pukewīwī/ Puketāpapa / Mount Roskill and Tahaki Reserve (Maungawhau / Mt Eden) and subject to usual Authority conditions and such further conditions that may become necessary.
- b) **resolve** to waive the event permit fees in accordance with the events policy.
- c) **note** management will work with the respective groups to establish dates for the future events and monitor and report on each of the events when they occur.

CARRIED

8. **Tūpuna Maunga Authority Quarter 4 Report**

MOVED by Member L Sosene, SECONDED by Member T Van Tonder

That the Tūpuna Maunga Authority:

- a) **note** the attached 4th Quarter Report for the 2020/2021 financial year.

CARRIED

9. Mangere Bridge Playcentre Lease

MOVED by Member H Rawiri, SECONDED by Member T Van Tonder

That the Tūpuna Maunga Authority:

- a) **resolve** to grant a new lease to the Mangere Bridge Playcentre for a term beginning 01 August 2021 and ending on 31 July 2022.
- b) **delegate** to the Chair and Deputy Chair the power to execute a lease, including a Maunga Outcomes Plan, with the Mangere Bridge Playcentre at a market rental (as determined by a registered valuer) and otherwise on the standard terms and conditions; and
- c) **delegate** to the Chair and Deputy Chair the power to agree to terms governing the termination arrangements of the Mangere Bridge Playcentre should the Club decide not to accept the new lease.

CARRIED

10. Policy for Weddings on Tūpuna Maunga

MOVED by Chairperson P Majurey, SECONDED by Deputy Chairperson Cr A Filipaina

That the Tūpuna Maunga Authority:

- a) **adopt** the Weddings Policy for the Tūpuna Maunga (Attachment B).

CARRIED

11. Registers

MOVED by Deputy Chairperson A Filipaina, SECONDED by Cr C Casey

That the Tūpuna Maunga Authority:

- a) **note** the attached Registers, which have been updated since Hui 64 (31 May 2021).

CARRIED

Member Hauāuru Rawiri closed Hui 65.

3.24 pm

The Chairperson thanked members for their attendance and attention to business and declared the meeting closed.

CONFIRMED AS A TRUE AND CORRECT RECORD AT A
MEETING OF THE TŪPUNA MAUNGA O TĀMAKI
MAKAURAU AUTHORITY HELD ON

DATE:.....

CHAIRPERSON:.....

Open Agenda

1. Apologies

No apologies had been received at the close of the agenda.

2. Declarations of Interest

Members are reminded of the need to be vigilant to stand aside from decision making when a conflict arises between their role as a member and any private or other external interest they might have.

3. Confirmation of Minutes

- a) **confirm** the minutes of Hui 65 held on Monday, 26 July 2021 as a true and accurate record.

Takarunga Visitor Facilities

Author: Liz Parkin, Kaihautū Hōtaka

Purpose	To consider concepts for proposed changes at Takarunga / Mt Victoria.
Recommendations	That the Tūpuna Maunga o Tāmaki Makaurau Authority: a) approve the plans for the tihi for implementation as set out in this report.

Background

1. The successful pedestrianisation of Takarunga / Mt Victoria and the completed upgrade of the tihi track has led to a change in the way people access and move around the Maunga. The 20/21 and 21/22 Operational Plans contemplate additional changes to support that, including the removal of redundant infrastructure and the provision of toilet facilities.

Statutory and other considerations

2. Any decision to determine management within a reserve must take into account the legislative and policy framework.
3. This paper relates to Takarunga/Mount Victoria (Recreation Reserve, Local Purpose Reserve).
4. Clause 2.3 of the Ngā Mana Whenua o Tāmaki Makaurau Collective Redress Deed 2012 states:

“2.3 The Tāmaki Makaurau collective legislation will, on the terms provided by section 43 of the draft bill, direct the Registrar-General to record on any computer freehold register for each maunga that the iwi and hapū of Ngā Mana Whenua o Tāmaki Makaurau specified for that maunga in table 1 of part 3 of the property redress schedule have spiritual, ancestral, cultural, customary and historical interests in the maunga.”

5. The Collective Deed Property Redress Schedule contains the table referred to in clause 2.3, and the iwi/hapū having spiritual, ancestral, cultural, customary and historical interests in the Maunga are as follows:

Takarunga / Mount Victoria	Ngāi Tai ki Tāmaki Ngāti Maru Ngāti Pāoa Ngāti Tamaoho Ngāti Tamaterā Ngāti Te Ata Ngāti Whanaunga	Ngāti Whātua Orākei Ngāti Whatua o Kaipara Te Ākitai Waiohūa Te Kawerau ā Maki Te Patukirikiri Te Rūnanga o Ngāti Whātua
-------------------------------	--	--

6. The Authority administers the Tūpuna Maunga under the Reserves Act 1977 and pursuant to Ngā Mana Whenua o Tāmaki Makaurau Collective Redress Act 2014. The Hauraki Gulf Marine Park Act 2000 is also relevant.
7. Section 109(2) of Ngā Mana Whenua o Tāmaki Makaurau Collective Redress Act 2014 requires the Authority to have regard to the spiritual, ancestral, cultural, customary, and historical significance of the maunga to Ngā Mana Whenua o Tāmaki Makaurau and that the Tūpuna Maunga is held in trust for Ngā Mana Whenua and the other people of Auckland.
8. The Tūpuna Maunga Authority's Integrated Management Plan (IMP) was adopted by the Authority in terms of Ngā Mana Whenua o Tāmaki Makaurau Collective Redress Act 2014 and the Reserves Act 1977. The Integrated Management Plan describes a series of "Values" and "Pathways" that guide all activities on the Tūpuna Maunga. The primary focus of the IMP is to protect the health and well-being of the Tūpuna Maunga.
9. The Tūpuna Maunga Authority adopted the Tūpuna Maunga Strategies at Hui 50 on 25 September 2020. The Tūpuna Maunga Strategies are 7 key sections that outline the strategic direction with regards to education, Biodiversity, Tūpuna Maunga design, Recreation, commercial activities and monitoring. Together with the IMP, these strategies inform guide and manage the activities undertaken on the Maunga.
10. The IMP the "Values" and "Pathways" achieve a change in the approach to the integrated care and management of Ngā Tūpuna Maunga. Of particular relevance are the Wairuatanga / Spiritual value and the Mana Aotūroa / Cultural and Heritage values. These include the recognition of the sacred nature of the tihi, a responsibility to tread gently, and the recognition of European and other histories.
11. In addition, the Mana Whai A Rēhia / Recreational Value aims to provide for recreational activities that are appropriate on the Tūpuna Maunga and appeal to a diverse population.
12. The Tūpuna Maunga Design Strategy is based on overarching principles that inform the direction of use and development:
 - a. The tihi is the most sacred part of the maunga to Mana Whenua. The nature of activities and establishment of structures needs to be carefully managed on the tihi.
 - b. All development will respect and maintain, and where appropriate, enhance and restore the mana of the Maunga.
 - c. Existing tracks and structures including infrastructure such as buildings, car parks, trig stations that are inappropriately located or that do not align with the Tūpuna Maunga values will be removed.
 - d. Development will be restricted to that which is necessary to serve the values of the maunga and the needs of both Mana Whenua and manuhiri (visitors) to the Maunga.
 - e. Development will be designed and located to minimise visual impact and to maintain the pre-eminence of the tihi, Maunga to Maunga sightlines and volcanic viewshafts.
 - f. Development materials and structures will seek to minimise impact on the Maunga and to achieve whole-of-life sustainability including a consideration of decommissioning.

- g. Materials, colours and scale of development will be appropriate to the context and reflect the natural and/or cultural environment of the locality.
 - h. Impervious areas are progressively reduced to minimise erosion and stormwater generation facilitating more natural water systems.
13. The Tūpuna Maunga Recreation Strategy recognises that the Maunga play a role in supporting and encouraging active healthy lifestyles

Design Summary

14. In March 2018 changes to access were implemented at Takarunga and the Maunga became a predominantly pedestrian space. The changes present an opportunity to reduce the now-redundant car parking infrastructure at the tihi. However, because people now spend more time on the Maunga, the provision of toilets facilities is also proposed.

Tihi

15. Changes at the tihi comprise the removal of redundant infrastructure and the reduction of impermeable surfaces (Attachment A).
16. Almost the entire parking space is shown as being removed and returned to grass. This is a reduction of around 660m² of impermeable surface. A new reinforced grass access provided to the Port of Auckland facility. Planting screening the Ports of Auckland facility is proposed, along with painting the fence a more recessive colour.
17. Existing seating is at the end of its life and will be replaced with new tables and seating. A formed path to the seating will ensure no restriction on access for people with limited mobility.
18. There is an existing relief model illustrating the landform of Tāmaki Makaurau and the harbours at the tihi. Management propose to retain the model but make it more relevant through the incorporation of additional (and accurate) Māori place names for all of the Maunga and the motu. The model becomes the focus of the circular path leading from the turning area.

Planting

19. The existing plantings at the tihi will be reinvigorated with native species.
20. Planting of broadleaf forest species will be undertaken on the modified banks surrounding the courts on the lower flanks of the maunga. These are species that were once prevalent across the maunga and include puriri, taraire and kohekohe.

Wharepaku and other amenity

21. A wharepaku/toilet will be installed alongside the existing tennis area to meet the demands of visitors, along with seating and native planters to increase the amenity of the area.
22. Management will continue to investigate and progress options for informal traditional hūpara play experiences in the space and on the banks where the new native plantings will occur. Possible elements include:
- Torere tree for climbing

- Triple-posted tama-tane-wahine installation
- Hikeikei on which to hop, jump and walk over;
- Land-based kōkiri; or
- Wera-te-paatu to practice agility, speed and balance.

23. By integrating traditional play elements into the Tūpuna Maunga, we are encouraging mana whenua and manuhiri to re-engage with the restored natural environment and thereby to reawaken their sense of history and place. More contemporary options that acknowledge the history of the space as one of the first dedicated active recreation spaces for young girls, will also be considered.

24. Management will also progress the engineering requirements for the provision of a drop-off space at the base of the Maunga.

Next steps

25. Management will develop and finalise the plans for implementation.

Attachments

Attachment A: Takarunga tihi concept plans



Extent of existing paved area
delineated by dotted line

KEY

- 1 Mobility Parking
- 2 Vehicle Turn-around
- 3 New Grass-paved Vehicle Access to Signal Station
- 4 Stone Bollards
- 5 Removable Bollard
- 6 Existing Vegetation Retained and Enhanced
- 7 New Planting in Front of Fence
- 8 Paint Existing Fence Black
- 9 Remove Existing Carpark and Areas of Seal and Reinstate Grass
- 10 Permeable Bound Aggregate Paving
- 11 Enhance Existing Brass Relief Feature (Incorporate further & more accurate Maori place names for maunga & motu)
- 12 Rubbish Bin
- 13 Investigate Potential Removal of Trig



Takarunga/ Mt Victoria Track Upgrade

Authors: Liz Parkin – Kaihautu Hotaka, Nicholas Turoa – Kaiwhakahaere Te Waka Tairanga Whenua

Purpose	To consider final plans for the Takarunga/ Mt Victoria Track upgrade for approval
Recommendations	That the Tūpuna Maunga o Tāmaki Makaurau Authority: a) approve proceeding with the track upgrade at Takarunga/ Mt Victoria as set out in the report.

Background

1. This report presents a recommendation for the upgrade and renewal of the track network at Takarunga/ Mt Victoria.
2. The Authority has previously approved the pedestrianisation of the road to the tihi, and the upgrade of the main track to the tihi (Hui 22, 21 November 2016). These works are complete.
3. This project aims to complete the upgrade of tracks on the maunga to improve the visitor experience and protect the values of the maunga from erosion.

Statutory and other considerations

4. This paper relates to Takarunga / Mt Victoria (a Recreation Reserve and Local Purpose Reserve under the Reserves Act 1977).
5. Clause 2.3 of the Ngā Mana Whenua o Tāmaki Makaurau Collective Redress Deed 2012 states:
 “2.3 The Tāmaki Makaurau collective legislation will, on the terms provided by section 43 of the draft bill, direct the Registrar-General to record on any computer freehold register for each maunga that the iwi and hapū of Ngā Mana Whenua o Tāmaki Makaurau specified for that maunga in table 1 of part 3 of the property redress schedule have spiritual, ancestral, cultural, customary and historical interests in the maunga.”
6. The Collective Deed Property Redress Schedule contains the table referred to in clause 2.3, and the iwi/hapū having spiritual, ancestral, cultural, customary and historical interests in the Maunga are as follows:

Takarunga / Mt Victoria	Ngāi Tai ki Tāmaki Ngāti Maru Ngāti Pāoa Ngāti Tamaoho Ngāti Tamatera Ngāti Te Ata Ngāti Whanaunga,	Ngāti Whātua Ōrākei Ngāti Whātua o Kaipara Te Ākitai Waiohua Te Kawerau ā Maki Te Patukirikiri Te Rūnanga o Ngāti Whātua
-------------------------	---	---

7. The Authority administers the Tūpuna Maunga under the Reserves Act 1977 and pursuant to Ngā Mana Whenua o Tāmaki Makaurau Collective Redress Act 2014. The Hauraki Gulf Marine Park Act 2000 is also relevant.
8. The Tūpuna Maunga are within the catchments that support the Hauraki Gulf. The purpose of the Hauraki Gulf Marine Park Act 2000, among other matters, is to “recognise the historic, traditional, cultural, and spiritual relationship of the tangata whenua with the Hauraki Gulf.
9. Section 109(2) of Ngā Mana Whenua o Tāmaki Makaurau Collective Redress Act 2014 requires the Authority to have regard to the spiritual, ancestral, cultural, customary, and historical significance of the maunga to Ngā Mana Whenua o Tāmaki Makaurau and that the Tūpuna Maunga is held in trust for Ngā Mana Whenua and the other people of Auckland.

Integrated Management Plan and Strategies Considerations

10. The Tūpuna Maunga Authority’s Integrated Management Plan (IMP) was adopted by the Authority in terms of Ngā Mana Whenua o Tāmaki Makaurau Collective Redress Act 2014 and the Reserves Act 1977. The Integrated Management Plan describes a series of “Values” and “Pathways” that guide all activities on the Tūpuna Maunga. The primary focus of the IMP is to protect the health and well-being of the Tūpuna Maunga. The “protection and enhancement of the mauri and wairua of the Tūpuna Maunga is paramount” (p57). As such the Authority must “tread gently” on the maunga to ensure that only appropriate structures are built and that pathways and tracks limit the disturbance of, and impact on the Tūpuna Maunga. When considering new structures the Wairuatanga / Spiritual value guides the Authority to:

“Appropriately locate, design and construct new structures, services, areas of planting and facilities to complement the landform, reduce or minimise visual distractions and respect cultural historical and spiritual values” (p58).

11. The Tūpuna Maunga design strategy is based on overarching principles that inform the direction of use and development. The following specific principles are relevant:
 - a. All development will respect and maintain, and where appropriate, enhance and restore the mana of the Maunga.
 - b. Development will be restricted to that which is necessary to serve the values of the Maunga and the needs of both Mana Whenua and manuhiri to the Maunga.
 - c. Development materials and structures will seek to minimise impact on the Maunga and to achieve whole-of-life sustainability including a consideration of decommissioning.
 - d. Materials, colours and scale of development will be appropriate to the context and reflect the natural and/or cultural environment of the locality.
 - e. Impervious areas are progressively reduced to minimise erosion and stormwater generation facilitating more natural water systems.
12. The upgrade and renewal of the track network at Ōwairaka / Te Ahi-kā-ā-Rakataura / Mt Albert is anticipated in the 2021/22 Tūpuna Maunga Operational Plan.

Design Details

13. The lower loop track will be upgraded to a Day Visitor Standard as outlined in the New Zealand Track Standards and following practices adopted on other Maunga track upgrades. This includes a compacted aggregate surface, shaped to ensure water is kept off the track surface. Where the track is steep, timber boxed steps will be built and filled with compacted aggregate.
14. The track will typically be formed between 800mm and 1200mm wide. Soft retaining solutions will be used to support the track surface where necessary, rather than cutting into the maunga and constructing traditional retaining walls.
15. Timber handrails will be included where they will add to the comfort of the user.
16. There are no boardwalks or raised timber staircases planned in this project.
17. Attachment B outlines the standard design details and specifications for the track upgrade. These are the same as have been applied for other track projects across Ngā Tūpuna Maunga.

Next steps

18. Attachment A presents the final recommended route and construction detail.
19. Management will implement the next steps, including procurement.

Attachments

Attachment A: Map of track upgrade route and construction detail

Attachment B: Standard Maunga track design details

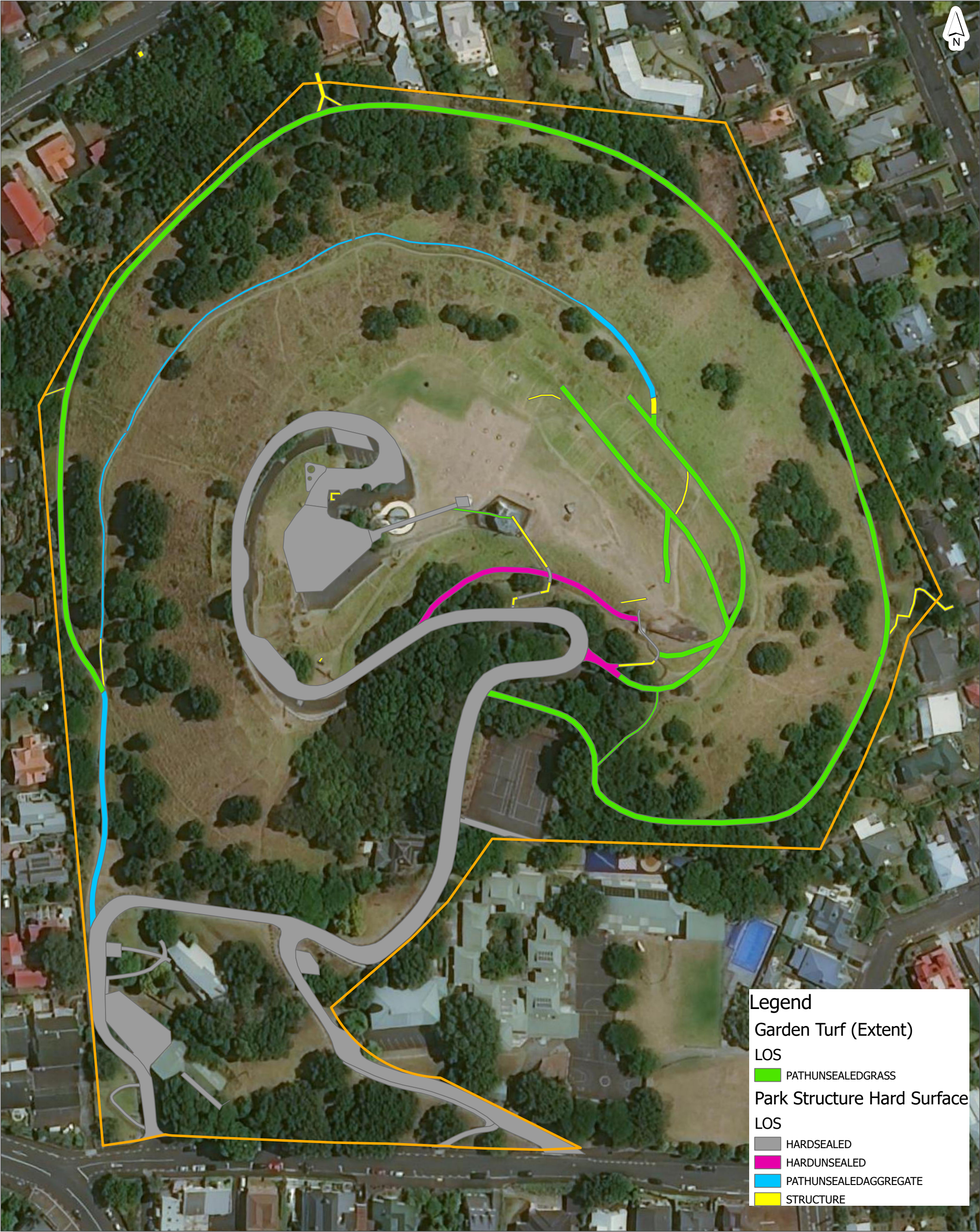

DISCLAIMER:
This map/plan is illustrative only and all information should be independently verified on site before taking any action.
Copyright Auckland Council. Land Parcel Boundary information from LINZ (Crown Copyright Reserved). Whilst due care has been taken, Auckland Council gives no warranty as to the accuracy and plan completeness of any information on this map/plan and accepts no liability for any error, omission or use of the information. Height datum: Auckland 1946.

Takarunga Track and path network

0 10 20 30
Meters
Scale @ A3
= 1:1,200
Date Printed:
6/14/2021

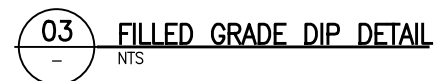

[illegible]

TUPUNA MAUNGA AUTHORITY TRACK DETAILS



STATUS:

FOR TENDER

DRAWING NO:

2217E-P1-500

CONTRACT NUMBER:	J002217
SCALE:	1:250 @ A3
REVISION:	9

Plotted: Fri, 17 Jul 2020 - 9:40am By: ERIKASORIANO
File Name: C:\Dropbox\Stellar Projects\217 - JOBS\IP.M PROJECTS\217 Maungaauka Track Upgrades\217E-P1_Maungaauka (North Head) R9.dwg

TABLE 1 – STEP GEOMETRY		
ANGLE	RISE	GOING
18° / 33%	190	575
20° / 36%	190	530
22° / 40%	190	475
24° / 45%	190	420
27° / 50%	190	380
30° / 58%	190	330
31° / 60%	190	315
34° / 66.6%	190	285
36° / 73%	190	260
37° / 76%	190	250

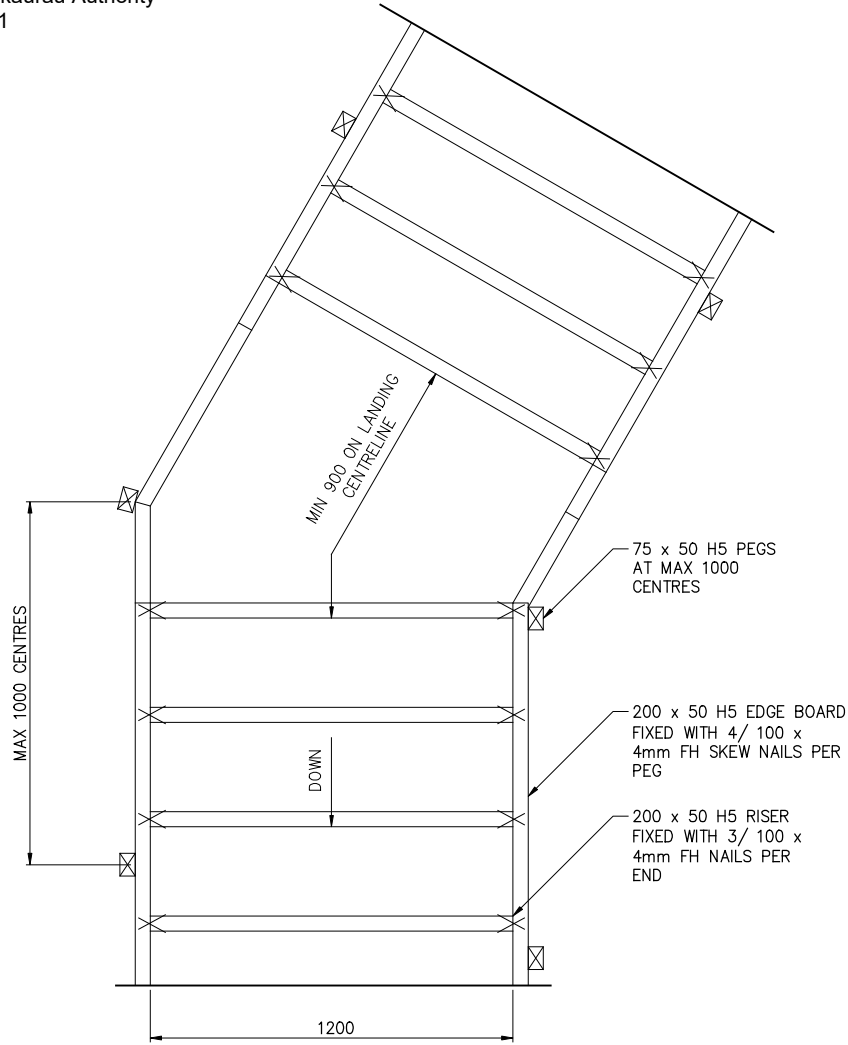

04 BOXED STEPS PLAN
SCALE: 1:20 @ A3

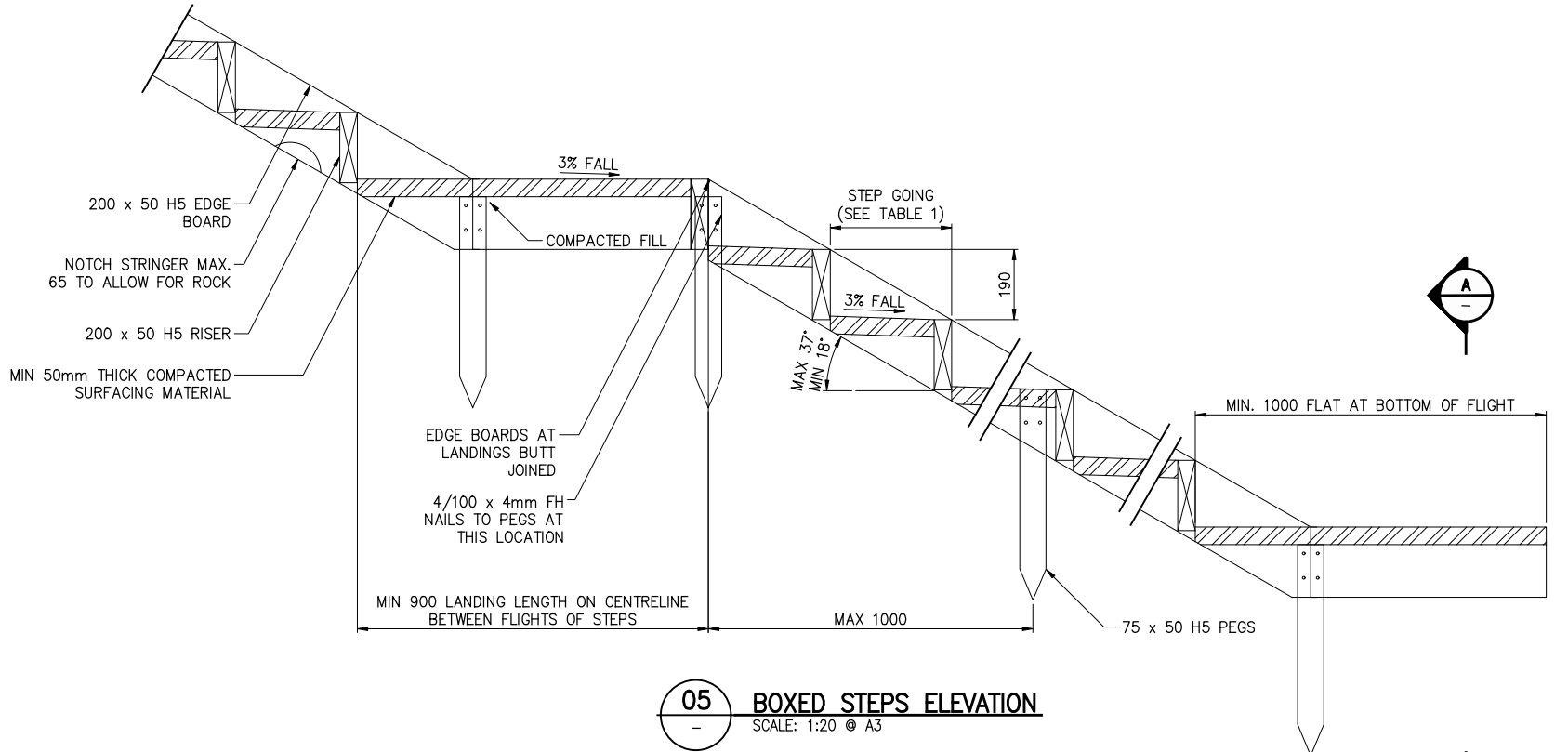

05 BOXED STEPS ELEVATION
SCALE: 1:20 @ A3

GENERAL NOTES:

1. PROVIDE LANDING EVERY MAX 13 STEPS. LANDING SHALL CONSIST OF AT LEAST 900MM LONG LEVEL STEP.
2. STEPS SHALL HAVE UNIFORM LENGTH AND RISER HEIGHT WITHIN EACH FLIGHT BETWEEN LANDINGS.
3. TIMBER GRADE:
 - ALL TO BE N01 FRAMING OR BETTER.
4. TIMBER TREATMENT:
 - SAWN TIMBER IN CONTACT WITH GROUND TO BE H5.
 - TREATMENT SHALL COMPLY WITH THE CURRENT REQUIREMENTS OF THE TIMBER PRESERVATION COUNCIL. ALL TIMBER SHALL BE BRANDED WITH THE APPROPRIATE WOODMARK. IT IS PREFERRED THAT TIMBER BE TREATED AT LEAST 2 MONTHS PRIOR TO USE.
6. NAILS:
 - GENERAL STRUCTURAL USE 100 X 4MM FH.
 - ALL NAILS SHALL BE HOT DIPPED GALVANISED.

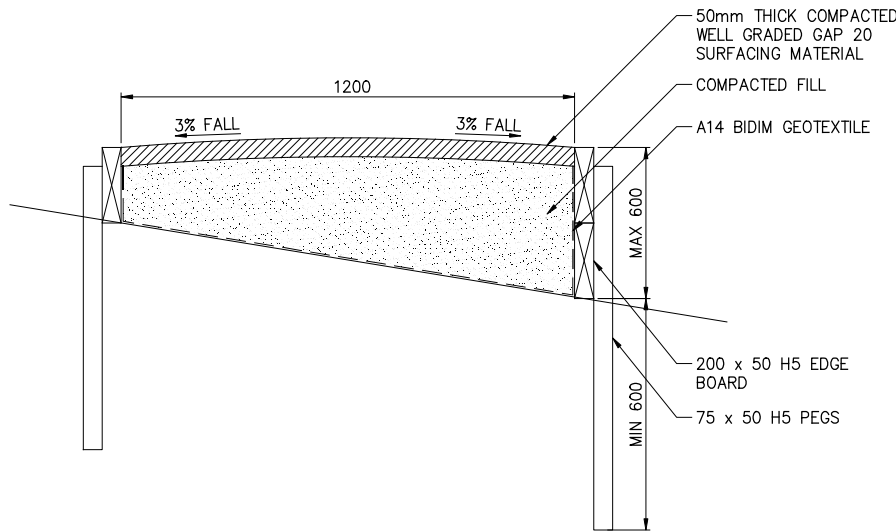

A BOXED STEPS SECTION
SCALE: 1:20 @ A3



TUPUNA MAUNGA AUTHORITY
BOXED STEPS DETAILS



STATUS:
FOR TENDER
DRAWING NO.
2217E-P1-501

CONTRACT NUMBER:
J002217
SCALE:
1:250 @ A3
REVISION:
9

DESIGNED:	AM	15/10/2019							
DRAWN:	MW	04/03/2020							
DWG CHK:	SD	04/03/2020							
DSGN CHK:	AM	04/03/2020	9	FOR TENDER	ES	AM	15/07/2020		
APPROVED:	M	06/03/2020	8	FOR CONSENT	ES	AM	27/05/2020		
			7	FOR TENDER	ES	AM	22/05/2020		
BY:	DATE	REVISION			BY:	APPRD	DATE		

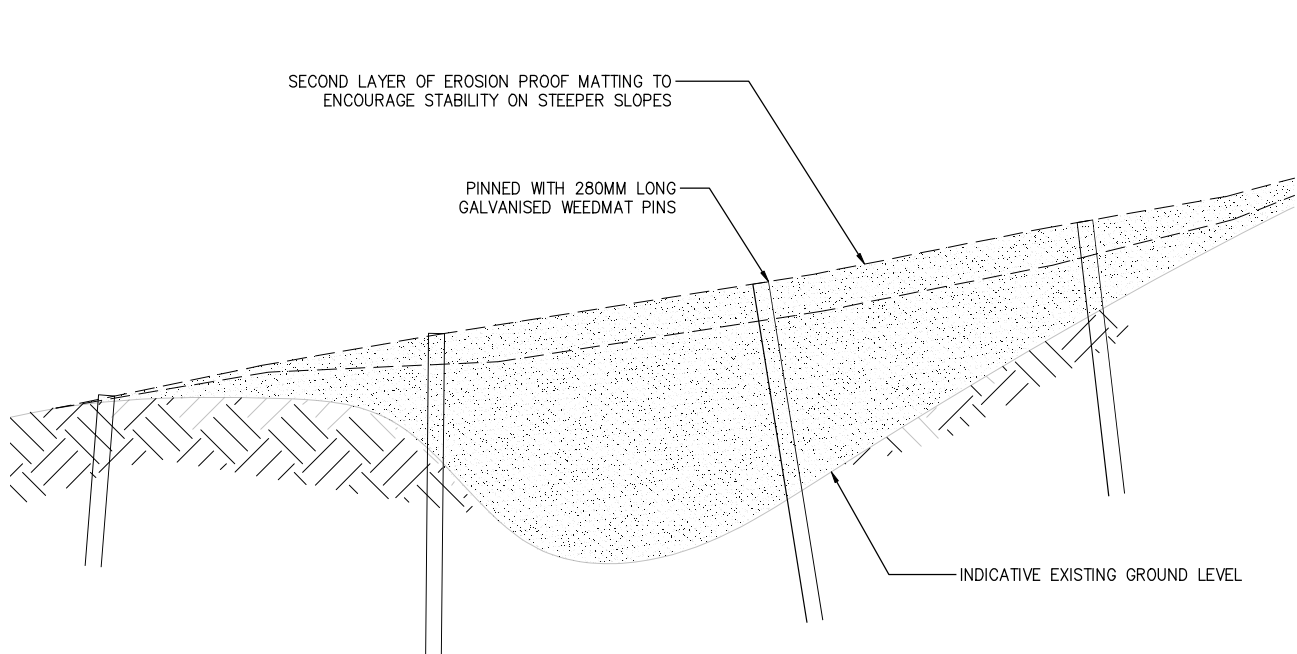

06 GROUND REINSTATEMENT – TYPE 1B (STEEPER SLOPES)
– NTS

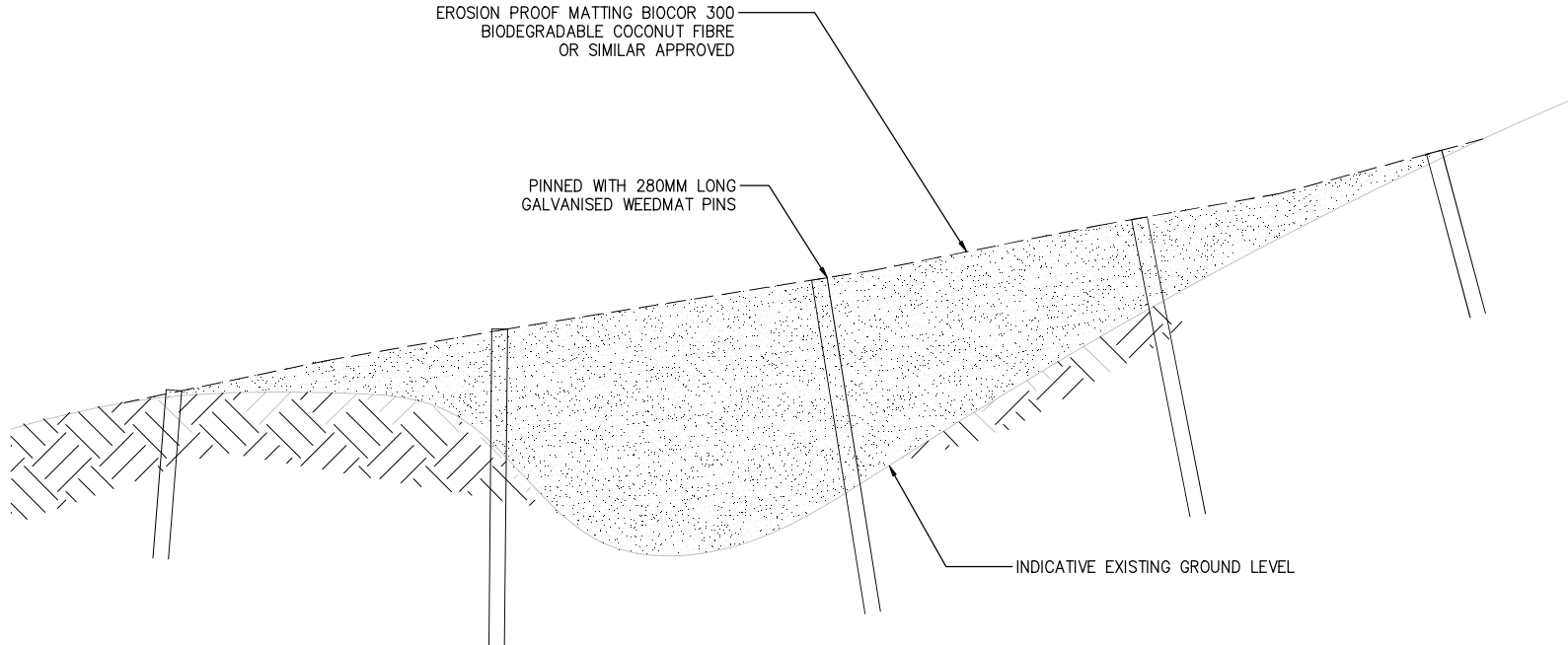

07 GROUND REINSTATEMENT – TYPE 1A
– NTS

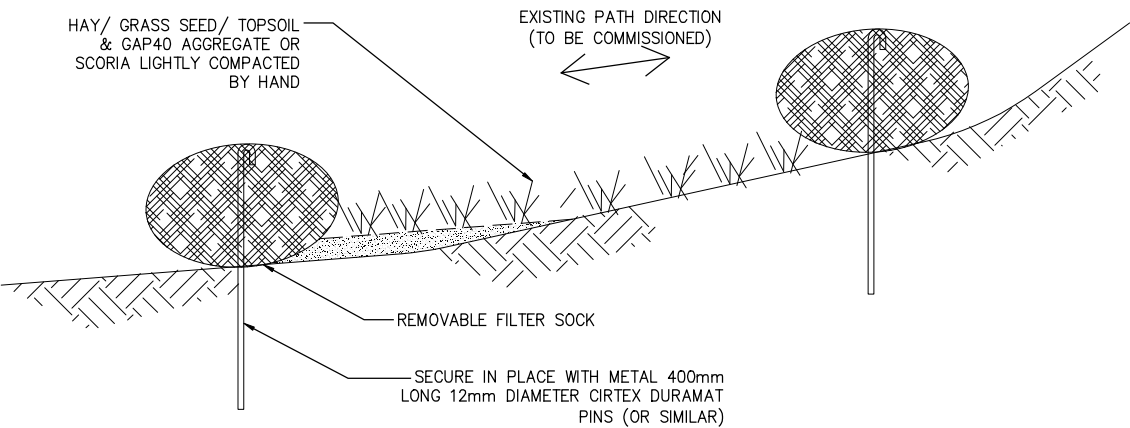

08 GROUND REINSTATEMENT – TYPE 2 MEDIUM
– NTS

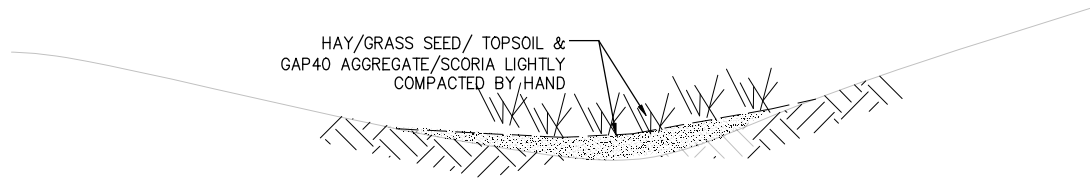

09 GROUND REINSTATEMENT – TYPE 3 LIGHT
– NTS

TYPE 1 METHODOLOGY

FOR USE IN TRACK REPAIR AREAS WHICH HAVE HIGH PUBLIC VISIBILITY OR HEAVILY ERODED. FOR USE AROUND MAIN ACCESSPATHS AND MID CONE

1. GRASS TRIMMING AND WEED EATING AROUND THE AFFECTED PATH
2. LIGHTLY FILL THE ERODED AREAS WITH A CLAY / SOIL MIX WITH LOCAL MATERIAL, SPREAD VIA HAND TOOLS
3. LIGHT HAND COMPACTION OF AREA
4. GRASS SEED SOWN
- 5.A. EROSION PROOF MATTING INSTALLED – BIOCOR 300 BIODEGRADABLE COCONUT FIBRE OR SIMILAR APPROVED
- 5.B. ON STEEPER SLOPES, ADDITIONAL FILL WAS ADDED ON TOP OF THE COCONUT MATTING, SOWN WITH ADDITIONAL GRASS SEED, AND A SECOND LAYER OF MATTING WAS USED TO EFFECTIVELY SANDWICH THE NEW MATERIAL AND ENCOURAGE STABILITY
6. PINNED WITH 280mm LONG GALVANISED WEEDMAT PINS AT APPROXIMATELY 500mm CENTRES
7. TEMPORARY PUBLIC INFORMATION SIGNAGE
8. WATERING – (TIMING OF WORKS TO COINCIDE WITH WARM WET WEATHER)

TYPE 2 METHODOLOGY

FOR USE IN AREAS MID TRACK AND STEEPER SLOPES.

1. LAY REMOVABLE FILTER SOCK
2. SECURE IN PLACE WITH METAL 400mm LONG 12mm DIAMETER CIRTEX DURAMAT PINS (OR SIMILAR)
3. LIGHTLY FILL THE ERODED AREAS WITH A CLAY / SOIL MIX WITH LOCAL FILL MATERIAL, SPREAD VIA HAND TOOLS.
4. HAY/GRASS SEED/TOPSOIL AND GAP40 AGGREGATE OR SCORIA
5. LIGHT HAND COMPACTION OF AREA
6. WATERING – (TIMING OF WORKS TO COINCIDE WITH WARM WET WEATHER)
7. WHEN GRASS ESTABLISHED REMOVE FILTER SOCK & TIMBER STAKES

Plotted: Fri, 17 Jul 2020 - 9:44am By: ERIKASORIANO
File Name: C:\Dropbox (Stellar Projects)\1 - JOBS\IP.M PROJECTS\J002217_Maungaulka Track Upgrades\CAD\00 Drawings\217E-P1_Maungaulka (North Head) R9.dwg

DESIGNED:	AM	15/10/2019							
DRAWN:	MW	04/03/2020							
DWG CHK:	SD	04/03/2020							
DSGN CHK:	AM	04/03/2020	9	FOR TENDER		ES	AM	15/07/2020	
APPROVED:	M	06/03/2020	8	FOR CONSENT		ES	AM	27/05/2020	
			7	FOR TENDER		ES	AM	22/05/2020	
BY:	DATE	REVISION				BY:	APPRD	DATE	



TUPUNA MAUNGA AUTHORITY
GROUND REINSTATEMENT DETAILS



STATUS:	FOR TENDER
DRAWING NO.	2217E-P1-502

CONTRACT NUMBER:	J002217
SCALE:	1:250 @ A3
REVISION:	9

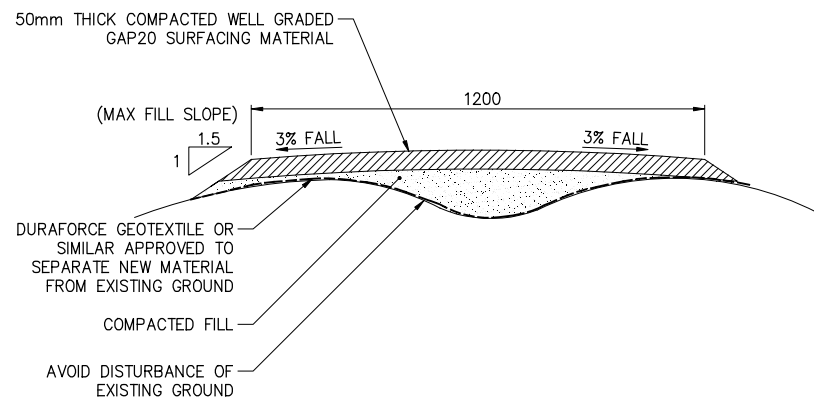

01 TYPICAL CROWNED FORMATION
SCALE: 1:20 @ A3

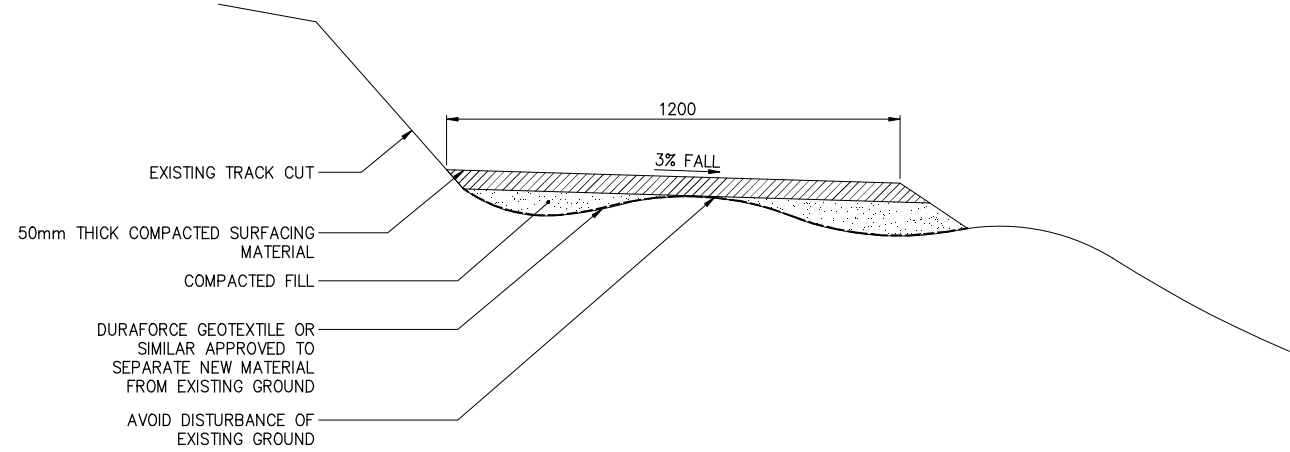

02 TYPICAL MONOSLOPE FORMATION
SCALE: 1:20 @ A3

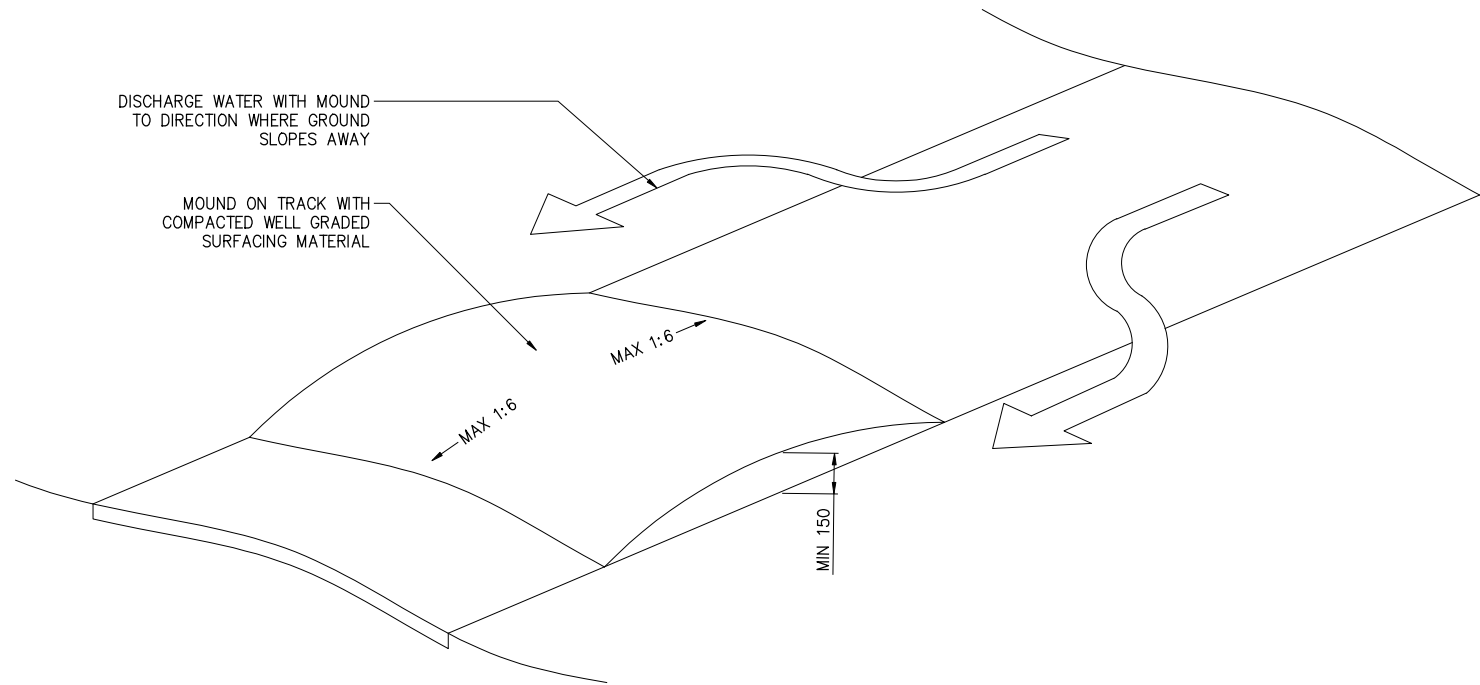

03 FILLED GRADE DIP DETAIL
NTS

Plotted: Fri, 17 Jul 2020 - 9:35am By: ERIKASORIANO
File Name: C:\Dropbox (Stellar Projects)\1 - JOBS\IP.M PROJECTS\J002217_Maungaulka Track Upgrades\3 CAD\00 Drawings\217E-P1_Maungaulka (North Head) R9.dwg

DESIGNED:	AM	15/10/2019							
DRAWN:	MW	04/03/2020							
DWG CHK:	SD	04/03/2020							
DSGN CHK:	AM	04/03/2020	9	FOR TENDER	ES	AM	15/07/2020		
			8	FOR CONSENT	ES	AM	27/05/2020		
APPROVED:	M	06/03/2020	7	FOR TENDER	ES	AM	22/05/2020		
BY:	DATE	REVISION			BY:	APPRD	DATE		



TUPUNA MAUNGA AUTHORITY
TRACK DETAILS



STATUS:	FOR TENDER
DRAWING NO:	2217E-P1-500

CONTRACT NUMBER:	J002217
SCALE:	1:250 @ A3
REVISION:	9

Plotted: Fri, 17 Jul 2020 - 9:40am By: ERIKASORIANO
File Name: C:\Dropbox\Stellar Projects\1 - JOBS\IP.M PROJECTS\002217_Maungauka Track Upgrades\217E-P1_Maungauka (North Head) R9.dwg

ANGLE	RISE	GOING
18° / 33%	190	575
20° / 36%	190	530
22° / 40%	190	475
24° / 45%	190	420
27° / 50%	190	380
30° / 58%	190	330
31° / 60%	190	315
34° / 66.6%	190	285
36° / 73%	190	260
37° / 76%	190	250

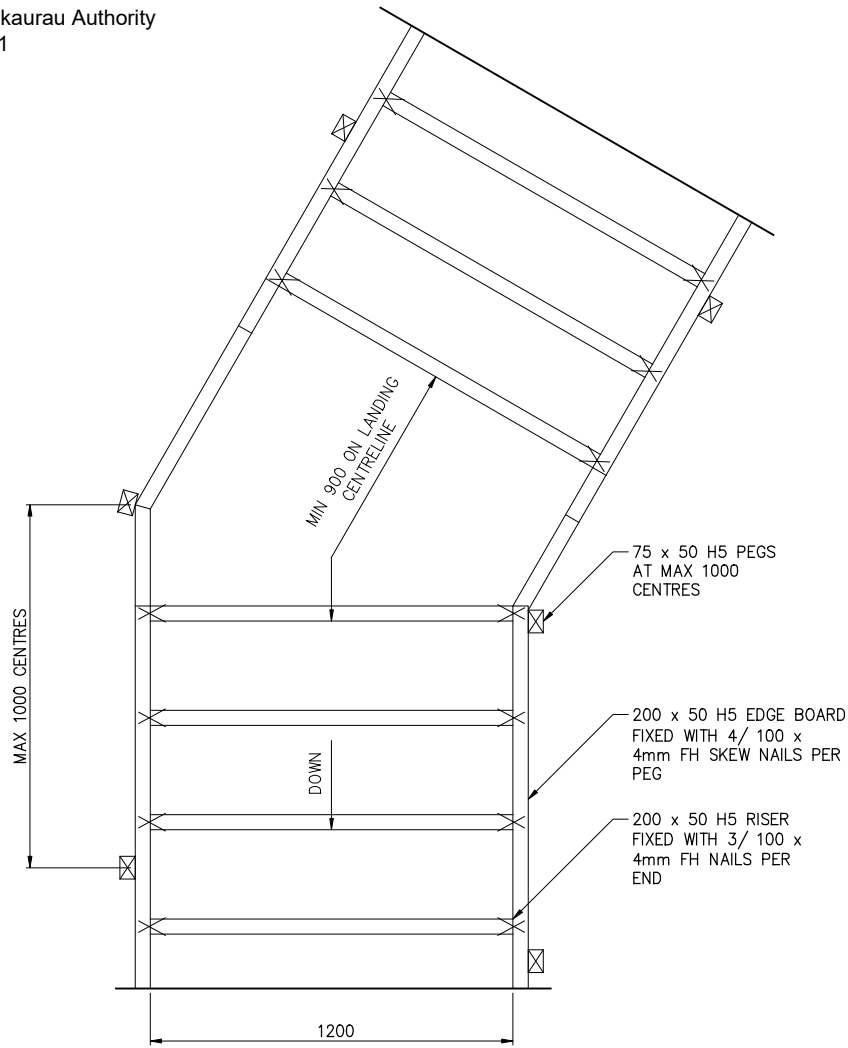

04 BOXED STEPS PLAN
SCALE: 1:20 @ A3

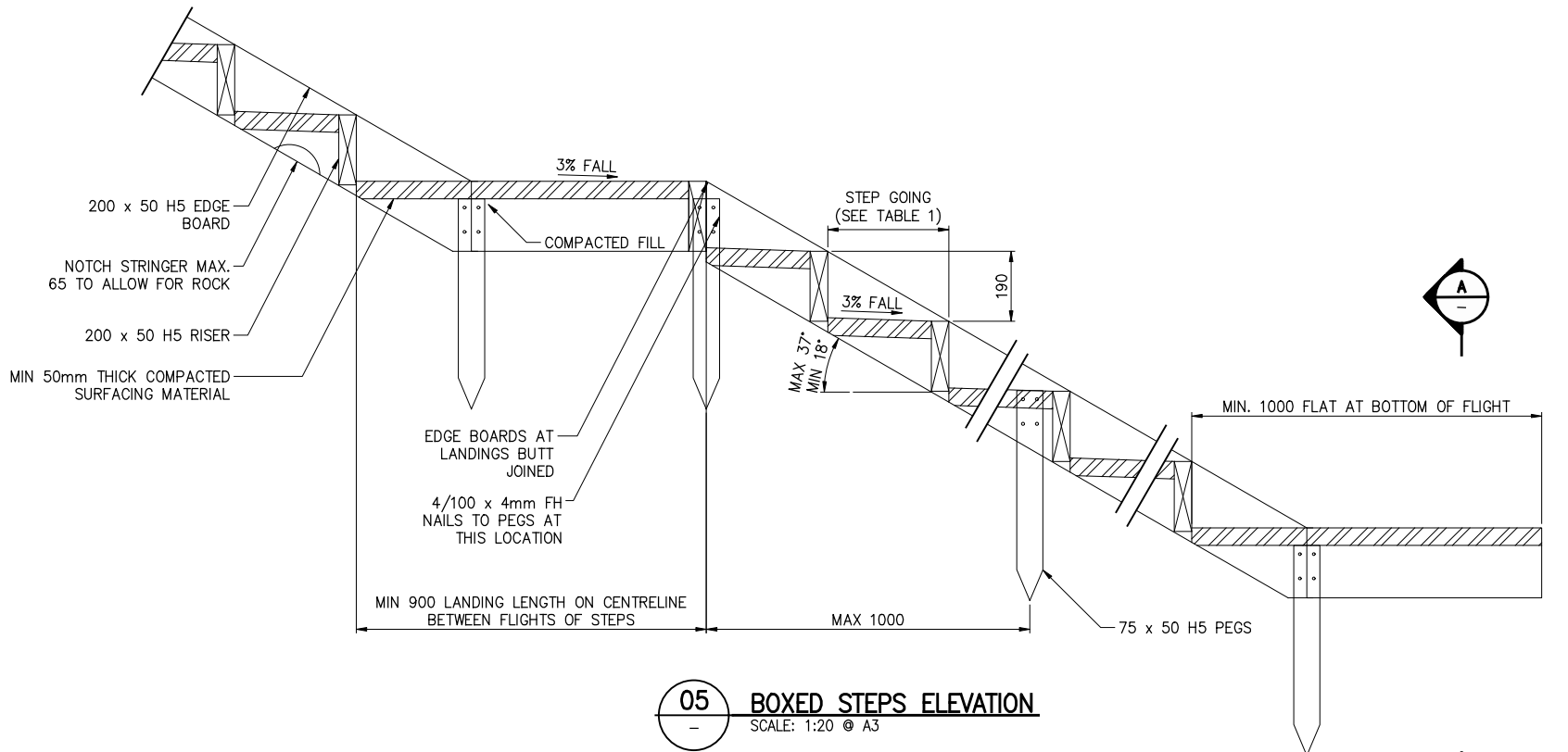

05 BOXED STEPS ELEVATION
SCALE: 1:20 @ A3

GENERAL NOTES:

1. PROVIDE LANDING EVERY MAX 13 STEPS. LANDING SHALL CONSIST OF AT LEAST 900MM LONG LEVEL STEP.
2. STEPS SHALL HAVE UNIFORM LENGTH AND RISER HEIGHT WITHIN EACH FLIGHT BETWEEN LANDINGS.
3. TIMBER GRADE:
 - ALL TO BE N01 FRAMING OR BETTER.
4. TIMBER TREATMENT:
 - SAWN TIMBER IN CONTACT WITH GROUND TO BE H5.
 - TREATMENT SHALL COMPLY WITH THE CURRENT REQUIREMENTS OF THE TIMBER PRESERVATION COUNCIL. ALL TIMBER SHALL BE BRANDED WITH THE APPROPRIATE WOODMARK. IT IS PREFERRED THAT TIMBER BE TREATED AT LEAST 2 MONTHS PRIOR TO USE.
6. NAILS:
 - GENERAL STRUCTURAL USE 100 X 4MM FH.
 - ALL NAILS SHALL BE HOT DIPPED GALVANISED.

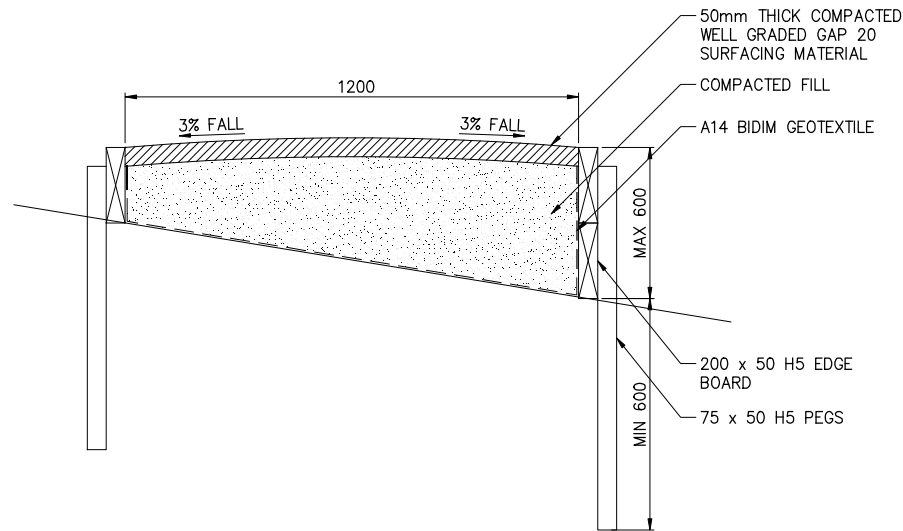

A BOXED STEPS SECTION
SCALE: 1:20 @ A3



TUPUNA MAUNGA AUTHORITY
BOXED STEPS DETAILS



STATUS:
FOR TENDER
DRAWING NO.
2217E-P1-501

CONTRACT NUMBER:
J002217
SCALE:
1:250 @ A3
REVISION:
9

DESIGNED:	AM	15/10/2019							
DRAWN:	MW	04/03/2020							
DWG CHK:	SD	04/03/2020							
DSGN CHK:	AM	04/03/2020	9	FOR TENDER	ES	AM	15/07/2020		
APPROVED:	M	06/03/2020	8	FOR CONSENT	ES	AM	27/05/2020		
			7	FOR TENDER	ES	AM	22/05/2020		
BY:	DATE	REVISION			BY:	APPRD	DATE		

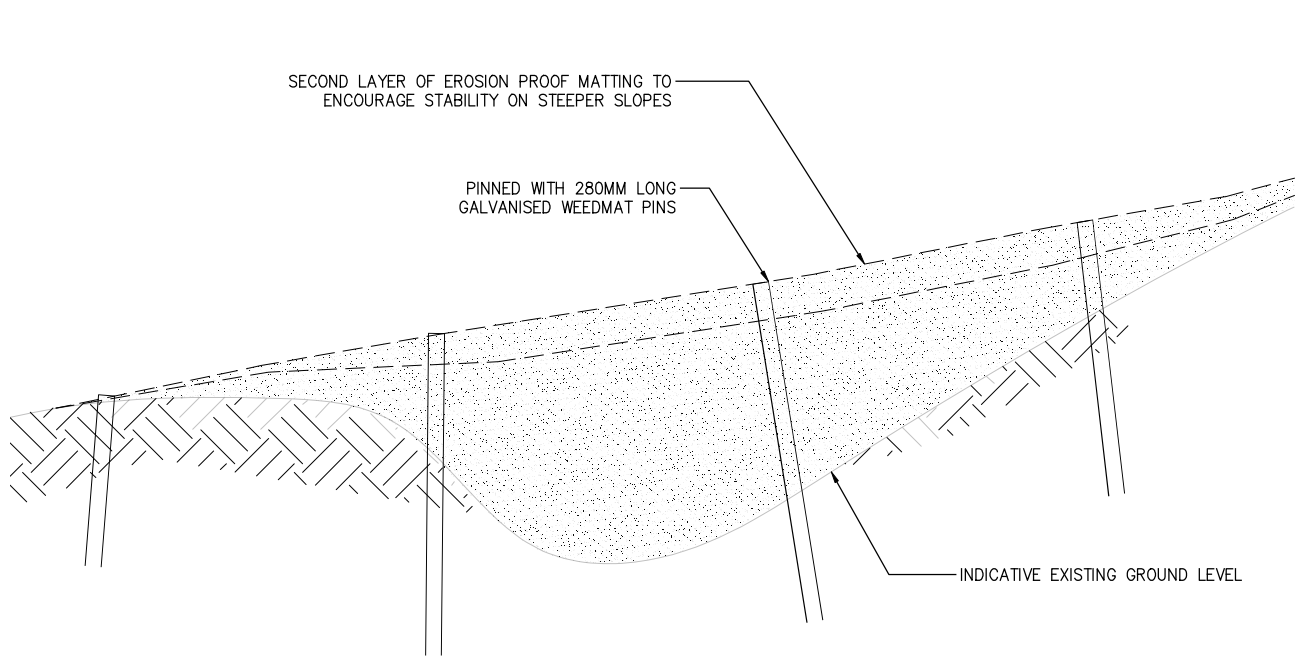

06 GROUND REINSTATEMENT – TYPE 1B (STEEPER SLOPES)
– NTS

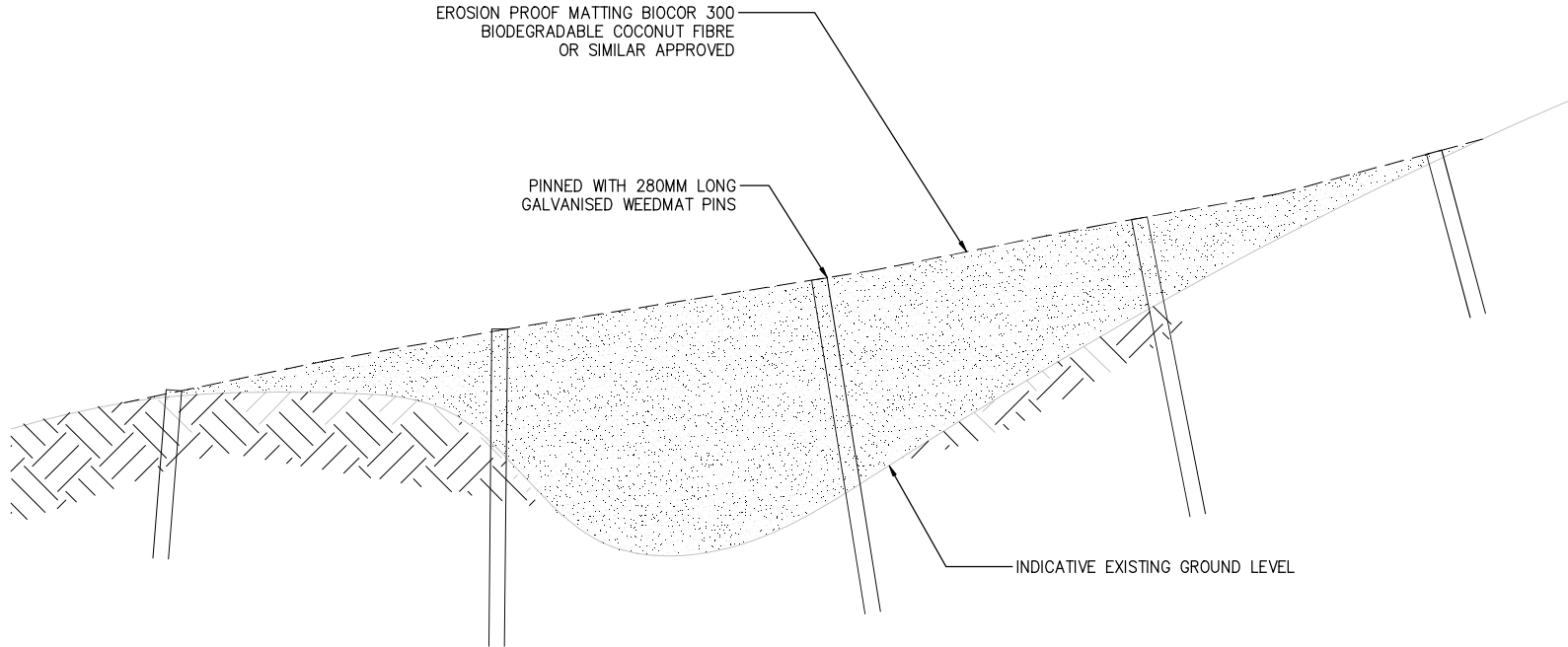

07 GROUND REINSTATEMENT – TYPE 1A
– NTS

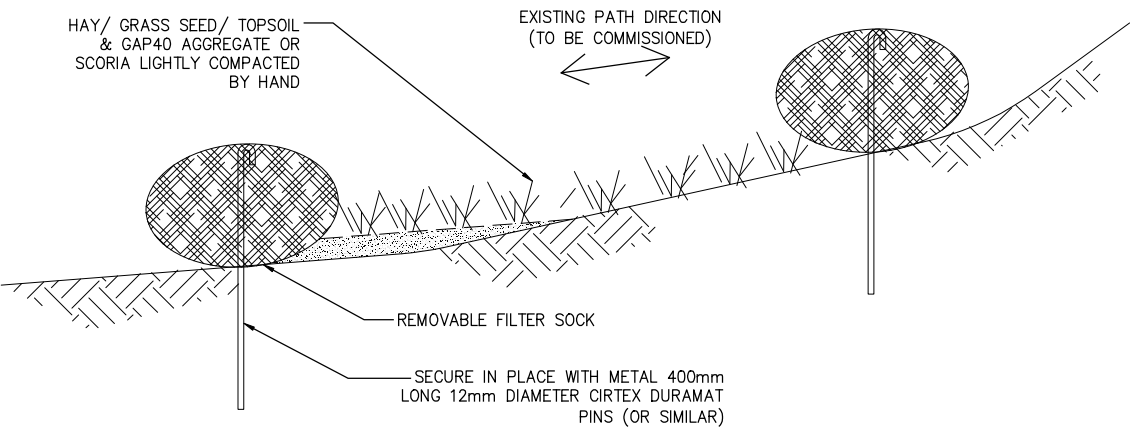

08 GROUND REINSTATEMENT – TYPE 2 MEDIUM
– NTS

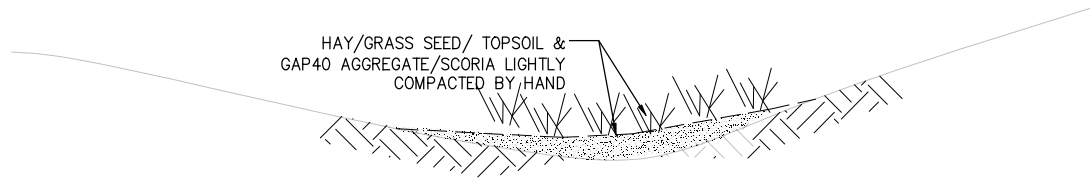

09 GROUND REINSTATEMENT – TYPE 3 LIGHT
– NTS

TYPE 1 METHODOLOGY

FOR USE IN TRACK REPAIR AREAS WHICH HAVE HIGH PUBLIC VISIBILITY OR HEAVILY ERODED. FOR USE AROUND MAIN ACCESSPATHS AND MID CONE

1. GRASS TRIMMING AND WEED EATING AROUND THE AFFECTED PATH
2. LIGHTLY FILL THE ERODED AREAS WITH A CLAY / SOIL MIX WITH LOCAL MATERIAL, SPREAD VIA HAND TOOLS
3. LIGHT HAND COMPACTION OF AREA
4. GRASS SEED SOWN
- 5.A. EROSION PROOF MATTING INSTALLED – BIOCOR 300 BIODEGRADABLE COCONUT FIBRE OR SIMILAR APPROVED
- 5.B. ON STEEPER SLOPES, ADDITIONAL FILL WAS ADDED ON TOP OF THE COCONUT MATTING, SOWN WITH ADDITIONAL GRASS SEED, AND A SECOND LAYER OF MATTING WAS USED TO EFFECTIVELY SANDWICH THE NEW MATERIAL AND ENCOURAGE STABILITY
6. PINNED WITH 280mm LONG GALVANISED WEEDMAT PINS AT APPROXIMATELY 500mm CENTRES
7. TEMPORARY PUBLIC INFORMATION SIGNAGE
8. WATERING – (TIMING OF WORKS TO COINCIDE WITH WARM WET WEATHER)

TYPE 2 METHODOLOGY

FOR USE IN AREAS MID TRACK AND STEEPER SLOPES.

1. LAY REMOVABLE FILTER SOCK
2. SECURE IN PLACE WITH METAL 400mm LONG 12mm DIAMETER CIRTEX DURAMAT PINS (OR SIMILAR)
3. LIGHTLY FILL THE ERODED AREAS WITH A CLAY / SOIL MIX WITH LOCAL FILL MATERIAL, SPREAD VIA HAND TOOLS.
4. HAY/GRASS SEED/TOPSOIL AND GAP40 AGGREGATE OR SCORIA
5. LIGHT HAND COMPACTION OF AREA
6. WATERING – (TIMING OF WORKS TO COINCIDE WITH WARM WET WEATHER)
7. WHEN GRASS ESTABLISHED REMOVE FILTER SOCK & TIMBER STAKES

Plotted: Fri, 17 Jul 2020 - 9:44am By: ERIKASORIANO
File Name: C:\Dropbox (Stellar Projects)\1 - JOBS\IP.M PROJECTS\J002217_Maungaulka Track Upgrades\CAD\00 Drawings\217E-P1_Maungaulka (North Head) R9.dwg

DESIGNED:	AM	15/10/2019							
DRAWN:	MW	04/03/2020							
DWG CHK:	SD	04/03/2020							
DSGN CHK:	AM	04/03/2020	9	FOR TENDER		ES	AM	15/07/2020	
APPROVED:	M	06/03/2020	8	FOR CONSENT		ES	AM	27/05/2020	
			7	FOR TENDER		ES	AM	22/05/2020	
BY:	DATE	REVISION				BY:	APPRD	DATE	



TUPUNA MAUNGA AUTHORITY
GROUND REINSTATEMENT DETAILS



STATUS:	FOR TENDER
DRAWING NO:	2217E-P1-502

CONTRACT NUMBER:	J002217
SCALE:	1:250 @ A3
REVISION:	9

Ōwairaka/ Te Ahi-ka-a-Rakataura / Mt Albert Track Upgrade

Authors: Liz Parkin – Kaihautu Hotaka, Nicholas Turoa – Kaiwhakahaere Te Waka Tairanga Whenua

Purpose	To present final plans for the Ōwairaka/ Te Ahi-ka-a-Rakataura/ Mt Albert for approval
Recommendations	That the Tūpuna Maunga o Tāmaki Makaurau Authority: a) approve proceeding with the proposed track upgrade at Ōwairaka/ Te Ahi-ka-a-Rakataura/ Mt Albert as set out in the report.

Background

1. This report presents a recommendation for the upgrade and renewal of the track network at Ōwairaka / Te Ahi-kā-ā-Rakataura / Mt Albert as anticipated in the 2021/22 Tūpuna Maunga Operational Plan.
2. The Authority has previously approved the pedestrianisation of the Maunga (Hui 22, 21 November 2016). Works to support this included the construction of a new carpark and toilet, demolition of the old facilities, and the installation of autogates. This work was completed in April 2019.
3. This project aims to complement the pedestrianisation of the Maunga by upgrading the off-road track network to improve visitor safety and comfort, and protect the values of the maunga from erosion.

Statutory and other considerations

4. This paper relates to Ōwairaka / Te Ahi-kā-ā-Rakataura / Mt Albert (a Recreation Reserve under the Reserves Act 1977).
5. Any decision to determine management within a reserve must take into account the legislative and policy framework.
6. Clause 2.3 of the Ngā Mana Whenua o Tāmaki Makaurau Collective Redress Deed 2012 states:

“2.3 The Tāmaki Makaurau collective legislation will, on the terms provided by section 43 of the draft bill, direct the Registrar-General to record on any computer freehold register for each maunga that the iwi and hapū of Ngā Mana Whenua o Tāmaki Makaurau specified for that maunga in table 1 of part 3 of the property redress schedule have spiritual, ancestral, cultural, customary and historical interests in the maunga.”
7. The Collective Deed Property Redress Schedule contains the table referred to in clause 2.3, and the iwi/hapū having spiritual, ancestral, cultural, customary and historical interests in the Maunga are as follows:

Ōwairaka / Te ahi-kā-a- Rakataura / Mt Albert	Ngāi Tai ki Tāmaki Ngāti Maru Ngāti Pāoa Ngāti Tamaoho Ngāti Tamaterā Ngāti Te Ata	Ngāti Whātua Ōrākei Ngāti Whātua o Kaipara Te Ākitai Waiohūa Te Kawerau ā Maki Te Rūnanga o Ngāti Whātua
--	---	--

8. The Authority administers the Tūpuna Maunga under the Reserves Act 1977 and pursuant to Ngā Mana Whenua o Tāmaki Makaurau Collective Redress Act 2014. The Hauraki Gulf Marine Park Act 2000 is also relevant.
9. The Tūpuna Maunga are within the catchments that support the Hauraki Gulf. The purpose of the Hauraki Gulf Marine Park Act 2000, among other matters, is to “recognise the historic, traditional, cultural, and spiritual relationship of the tangata whenua with the Hauraki Gulf.
10. Section 109(2) of Ngā Mana Whenua o Tāmaki Makaurau Collective Redress Act 2014 requires the Authority to have regard to the spiritual, ancestral, cultural, customary, and historical significance of the maunga to Ngā Mana Whenua o Tāmaki Makaurau and that the Tūpuna Maunga is held in trust for Ngā Mana Whenua and the other people of Auckland.

Integrated Management Plan and Strategies Considerations

11. The Tūpuna Maunga Authority’s Integrated Management Plan (IMP) was adopted by the Authority in terms of Ngā Mana Whenua o Tāmaki Makaurau Collective Redress Act 2014 and the Reserves Act 1977. The Integrated Management Plan describes a series of “Values” and “Pathways” that guide all activities on the Tūpuna Maunga. The primary focus of the IMP is to protect the health and well-being of the Tūpuna Maunga. The “protection and enhancement of the mauri and wairua of the Tūpuna Maunga is paramount” (p57). As such the Authority must “tread gently” on the Maunga to ensure that only appropriate structures are built and that pathways and tracks limit the disturbance of, and impact on the Tūpuna Maunga. When considering new structures the Wairuatanga / Spiritual value guides the Authority to:

“Appropriately locate, design and construct new structures, services, areas of planting and facilities to complement the landform, reduce or minimise visual distractions and respect cultural historical and spiritual values” (p58).
12. The Tūpuna Maunga design strategy is based on overarching principles that inform the direction of use and development. The following specific principles are relevant:
 - a. All development will respect and maintain, and where appropriate, enhance and restore the mana of the Maunga.
 - b. Development will be restricted to that which is necessary to serve the values of the Maunga and the needs of both Mana Whenua and manuhiri to the Maunga.
 - c. Development materials and structures will seek to minimise impact on the Maunga and to achieve whole-of-life sustainability including a consideration of decommissioning.
 - d. Materials, colours and scale of development will be appropriate to the context and reflect the natural and/or cultural environment of the locality.

- e. Impervious areas are progressively reduced to minimise erosion and stormwater generation facilitating more natural water systems.
13. The upgrade and renewal of the track network at Ōwairaka / Te Ahi-kā-ā-Rakataura / Mt Albert is anticipated in the 2021/22 Tūpuna Maunga Operational Plan.

Design Details

14. The tracks will be upgraded to a Day Visitor Standard as outlined in the New Zealand Track Standards and following practices adopted on other Maunga Track upgrades. This includes sets of 1.2m wide timber boxed stairs from the Toroa Road and Mt Royal entrances as these are steep and direct routes. In most other places a compacted aggregate surface will be formed, shaped to ensure water is kept off the track surface.
15. The track will typically be formed between 800mm and 1200mm wide. Soft retaining solutions will be used to support the track surface where necessary, rather than cutting into the maunga and constructing traditional retaining walls.
16. Timber handrails will be included where they will add to the comfort of the user.
17. There are no boardwalks or raised timber staircases planned in this project.

Next steps

18. Attachment A presents the final recommended route and construction detail.
19. Management will implement the next steps, including procurement.

Attachments

Attachment A: Map of track upgrade scope

Attachment B: Standard design details

Owairaka Tracks Upgrade Scope

13 Oct 2020



Key:



Formalise 1.2 wide aggregate track



Photo record



Close track

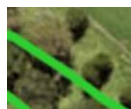

Existing track or desire line. Do nothing

[illegible]

TUPUNA MAUNGA AUTHORITY TRACK DETAILS



STATUS: **FOR TENDER**

DRAWING NO: **2217E-P1-500**

CONTRACT NUMBER:	J002217
SCALE:	1:250 @ A3
REVISION:	9

Plotted: Fri, 17 Jul 2020 - 9:40am By: ERIKASORIANO
File Name: C:\Dropbox (Seller Projects)\1 - JOBS\SP.M\PROJECTS\002217_Maungauika_Track Upgrades\3 CAD\00 Drawings\2217E-Prt_Maungauika (North Head).R3.dwg



- Plotted: Fri, 17 Jul 2020 - 9:40am By: ERIKASORIANO
File Name: C:\Dropbox (Seller Projects)\1 - JOBS\PM PROJECTS\002217 Maungauika Track Upgrades\3 CAD\00 Drawings\2217E-Pr1_Maungauika (North Head) R3.dwg

- Plotted: Fri, 17 Jul 2020 - 9:40am By: ERIKASORIANO
File Name: C:\Dropbox (Seller Projects)\1 - JOBS\PM PROJECTS\002217 Maungauika Track Upgrades\3 CAD\00 Drawings\2217E-Pr1_Maungauika (North Head) R3.dwg



Plotted: Fri, 17 Jul 2020 - 9:40am By: ERIKASORIANO
File Name: C:\Dropbox (Seller Projects)\1 - JOBS\PM PROJECTS\002217 Maungauika Track Upgrades\3 CAD\00 Drawings\2217E-Pr1_Maungauika (North Head) R3.dwg



Plotted: Fri, 17 Jul 2020 - 9:40am By: ERIKASORIANO
File Name: C:\Dropbox (Seller Projects)\1 - JOBS\PM PROJECTS\002217 Maungauika Track Upgrades\3 CAD\00 Drawings\2217E-Pr1_Maungauika (North Head) R3.dwg



Plotted: Fri, 17 Jul 2020 - 9:40am By: ERIKASORIANO
File Name: C:\Dropbox (Seller Projects)\1 - JOBS\PM PROJECTS\002217 Maungauika Track Upgrades\3 CAD\00 Drawings\2217E-Pr1_Maungauika (North Head) R3.dwg

Plotted: Fri, 17 Jul 2020 - 9:40am By: ERIKASORIANO
File Name: C:\Dropbox (Seller Projects)\1 - JOBS\PM PROJECTS\002217 Maungauika Track Upgrades\3 CAD\00 Drawings\2217E-Pr1_Maungauika (North Head) R3.dwg

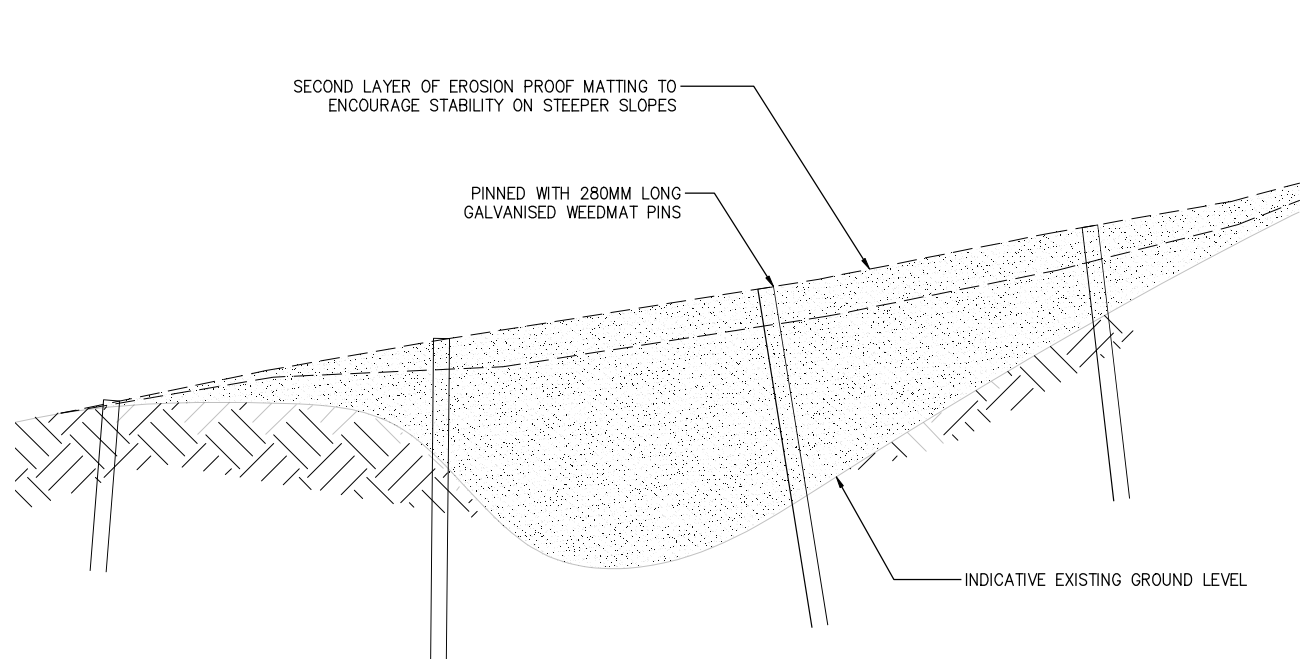

06 GROUND REINSTATEMENT – TYPE 1B (STEEPER SLOPES)
– NTS

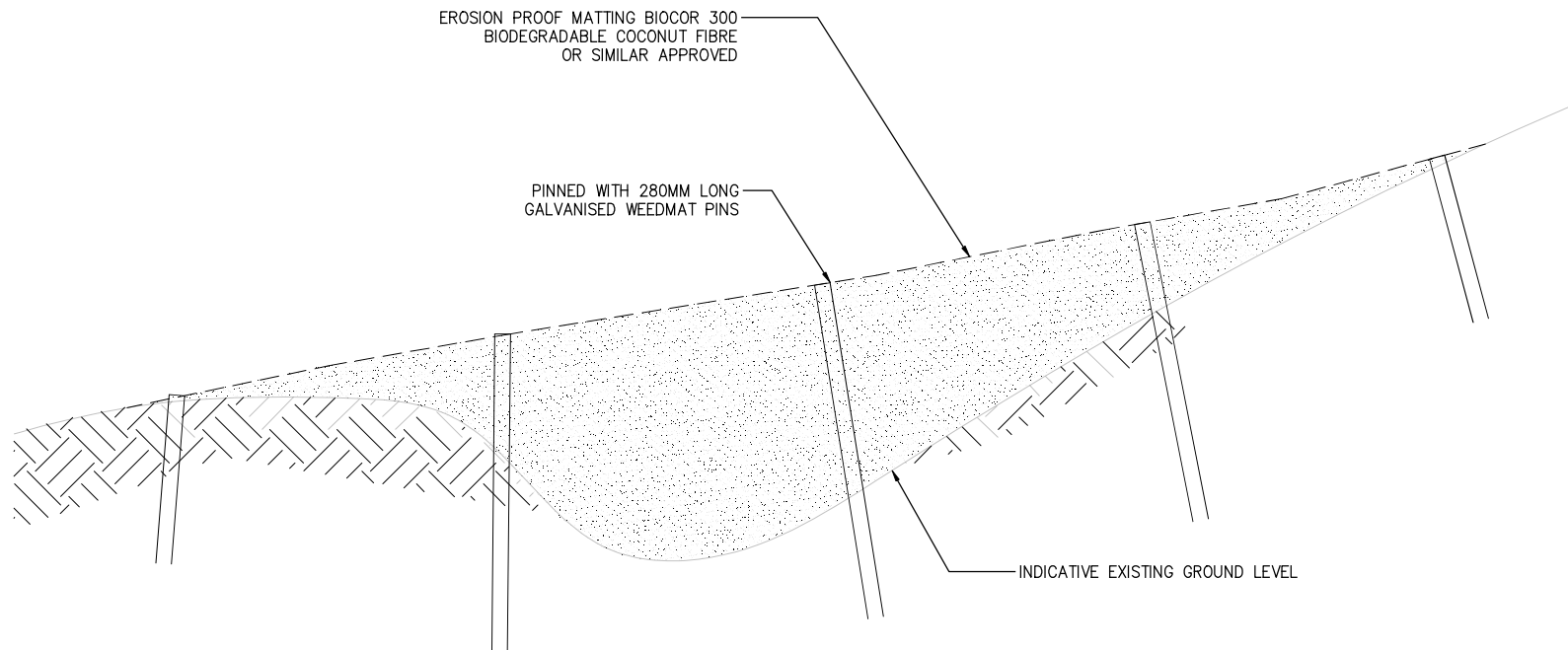

07 GROUND REINSTATEMENT – TYPE 1A
– NTS

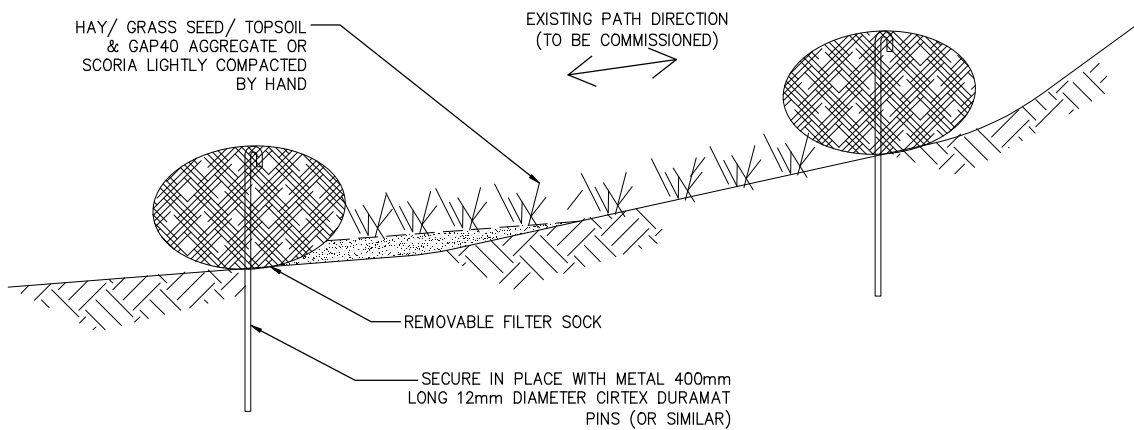

08 GROUND REINSTATEMENT – TYPE 2 MEDIUM
– NTS

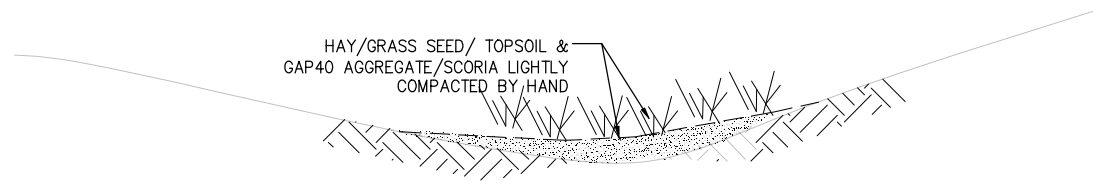

09 GROUND REINSTATEMENT – TYPE 3 LIGHT
– NTS

TYPE 1 METHODOLOGY

FOR USE IN TRACK REPAIR AREAS WHICH HAVE HIGH PUBLIC VISIBILITY OR HEAVILY ERODED. FOR USE AROUND MAIN ACCESSPATHS AND MID CONE

1. GRASS TRIMMING AND WEED EATING AROUND THE AFFECTED PATH
2. LIGHTLY FILL THE ERODED AREAS WITH A CLAY / SOIL MIX WITH LOCAL MATERIAL, SPREAD VIA HAND TOOLS
3. LIGHT HAND COMPACTION OF AREA
4. GRASS SEED SOWN
- 5.A. EROSION PROOF MATTING INSTALLED – BIOCOIR 300 BIODEGRADABLE COCONUT FIBRE OR SIMILAR APPROVED
- 5.B. ON STEEPER SLOPES, ADDITIONAL FILL WAS ADDED ON TOP OF THE COCONUT MATTING, SOWN WITH ADDITIONAL GRASS SEED, AND A SECOND LAYER OF MATTING WAS USED TO EFFECTIVELY SANDWICH THE NEW MATERIAL AND ENCOURAGE STABILITY
6. PINNED WITH 280mm LONG GALVANISED WEEDMAT PINS AT APPROXIMATELY 500mm CENTRES
7. TEMPORARY PUBLIC INFORMATION SIGNAGE
8. WATERING – (TIMING OF WORKS TO COINCIDE WITH WARM WET WEATHER)

TYPE 2 METHODOLOGY

FOR USE IN AREAS MID TRACK AND STEEPER SLOPES.

1. LAY REMOVABLE FILTER SOCK
2. SECURE IN PLACE WITH METAL 400mm LONG 12mm DIAMETER CIRTEX DURAMAT PINS (OR SIMILAR)
3. LIGHTLY FILL THE ERODED AREAS WITH A CLAY / SOIL MIX WITH LOCAL FILL MATERIAL, SPREAD VIA HAND TOOLS.
4. HAY/GRASS SEED/TOPSOIL AND GAP40 AGGREGATE OR SCORIA
5. LIGHT HAND COMPACTION OF AREA
6. WATERING – (TIMING OF WORKS TO COINCIDE WITH WARM WET WEATHER)
7. WHEN GRASS ESTABLISHED REMOVE FILTER SOCK & TIMBER STAKES

DESIGNED:	AM	15/10/2019							
DRAWN:	MW	04/03/2020							
DWG CHK:	SD	04/03/2020							
DSGN CHK:	AM	04/03/2020	9	FOR TENDER		ES	AM	15/07/2020	
APPROVED:	M	06/03/2020	8	FOR CONSENT		ES	AM	27/05/2020	
			7	FOR TENDER		ES	AM	22/05/2020	
BY:	DATE	REVISION				BY:	APPRD	DATE	



TUPUNA MAUNGA AUTHORITY
GROUND REINSTATEMENT DETAILS



STATUS:	FOR TENDER	CONTRACT NUMBER:	J002217
DRAWING NO:	2217E-P1-502	SCALE:	1:250 @ A3
REVISION:			9

Onehunga Māngere United Sports Club Incorporated Lease

Authors: Leigh Collecutt – Kaihautū Hōtaka, Nick Turoa - Manager Tūpuna Maunga

Purpose	This report recommends that the Tūpuna Maunga Authority offer the Onehunga Māngere United Sports Club a lease on Te Pane o Mataoho / Te Ara Pueru / Māngere Mountain
Recommendations	<p>That the Tūpuna Maunga o Tāmaki Makaurau Authority:</p> <ul style="list-style-type: none">a) resolve to publicly notify pursuant to s119 of the Reserves Act 1977 an intention to grant a new lease to occupy to the Onehunga Māngere United Sports Club for a term beginning 01 September 2021 and ending on 31 August 2022 with a one year right of renewal.b) recognise there may be submissions and a hearing pursuant to s120 of the Reserves Act 1977;c) delegate to the Chair and Deputy Chair the power to execute a lease, including a Maunga Outcomes Plan, with the Onehunga Mangere United Sports Club at a market rental (as determined by a registered valuer) and otherwise on the standard terms and conditions; andd) delegate to the Chair and Deputy Chair the power to agree to terms governing the termination arrangements of the Onehunga Mangere United Sports Club should the Club decide not to accept the new lease.

Background

1. The previous Onehunga Mangere United Sports Club (the Club) lease was inherited by the Tūpuna Maunga Authority. This lease was originally with the Manukau City Council (predecessor to Auckland Council) and was drafted in accordance with that council's policy at the time.
2. The Club occupies an area of Te Pane o Mataoho / Te Ara Pueru / Māngere Mountain which is classified as a Recreation Reserve.
3. The lease area covers the building on the site, excluding the ground floor amenity block as shown within the dotted line in Figure 2. The Club owns the portion of the building that they occupy.
4. The lease expired on 30 June 2020.

Statutory and other considerations

5. This paper updates the Authority on an area of Te Pane o Mataoho / Te Ara Pueru / Māngere Mountain under lease to the Onehunga Mangere United Sports Club. The location of the current leased area is shown below in Figure 1.

6. Clause 2.3 of the Ngā Mana Whenua o Tāmaki Makaurau Collective Redress Deed 2012 states:

“2.3 The Tāmaki Makaurau collective legislation will, on the terms provided by section 43 of the draft bill, direct the Registrar-General to record on any computer freehold register for each maunga that the iwi and hapū of Ngā Mana Whenua o Tāmaki Makaurau specified for that maunga in table 1 of part 3 of the property redress schedule have spiritual, ancestral, cultural, customary and historical interests in the maunga.”

7. The Collective Deed Property Redress Schedule contains the table referred to in clause 2.3, and the iwi/hapū having spiritual, ancestral, cultural, customary and historical interests in the Maunga are as follows:

Te Pane o Mataoho / Te Ara Pueru / Māngere Mountain	Ngāi Tai ki Tāmaki Ngāti Maru Ngāti Tamaoho Ngāti Tamaterā Ngāti Te Ata	Ngāti Whātua Ōrākei Ngāti Whātua o Kaipara Te Ākitai Waiohua Te Kawerau ā Maki Te Patukirikiri
---	---	--

8. Any decision to determine management within a reserve must take into account the legislative and policy framework.
9. The Authority administers the Tūpuna Maunga under the Reserves Act 1977 and pursuant to Ngā Mana Whenua o Tāmaki Makaurau Collective Redress Act 2014. The Hauraki Gulf Marine Park Act 2000 is also relevant. The activities of the Club are consistent with the reserve classification.
10. Section 109(2) of Ngā Mana Whenua o Tāmaki Makaurau Collective Redress Act 2014 requires the Authority to have regard to the spiritual, ancestral, cultural, customary, and historical significance of the Maunga to Ngā Mana Whenua o Tāmaki Makaurau and that the Tūpuna Maunga is held in trust for Ngā Mana Whenua and the other people of Auckland.
11. The Tūpuna Maunga Authority's Integrated Management Plan (IMP) was adopted by the Authority in terms of Ngā Mana Whenua o Tāmaki Makaurau Collective Redress Act 2014 and the Reserves Act 1977. The Integrated Management Plan describes a series of “Values” and “Pathways” that guide all activities on the Tūpuna Maunga. The primary focus of the IMP is to protect the health and well-being of the Tūpuna Maunga.
12. The Tūpuna Maunga Authority adopted the Tūpuna Maunga Strategies at Hui 50 on 25 September 2020. The Tūpuna Maunga Strategies are 7 key sections that outline the strategic direction with regards to education, Biodiversity, Tūpuna Maunga design, Recreation, commercial activities and monitoring. Together with the IMP, these strategies inform guide and manage the activities undertaken on the Maunga.
13. Section 54 of the Reserves Act 1977 sets out the Authority's powers in relation to leasing on a recreation reserve. This clause specifies that the intention to grant a lease must be publicly notified.

Leases on Tūpuna Maunga

14. The Tūpuna Maunga o Tāmaki Makaurau Integrated Management Plan (IMP) describes a series of values and pathways that dictate decision-making on leases. The IMP places the health and well-being of the Tūpuna Maunga at the heart of all decisions.
15. Any leasing activity must be consistent with the IMP Tūpuna Maunga values and should actively promote those values. One step is a Maunga Outcomes Plan which forms part of all leases on Tūpuna Maunga.
16. The proposed lease area is shown in red below.



Figure 1: Proposed Lease Location



Sealed Public Car Parking Area

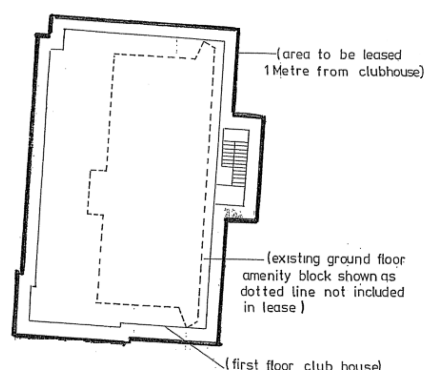

Figure 2: Proposed Leased Area, noting the publicly accessible amenity block on the ground floor does not form part of the proposed lease area.

Key Terms

Term

17. The approach to leases on the Tūpuna Maunga to date has been to initially offer short-term leases to give lessees the opportunity to demonstrate their contribution to the wellbeing of the Maunga and the values set out in the IMP.
18. As part of the lease, the club will be required to provide an outcomes plan to demonstrate this contribution.
19. Management proposes an initial term of 1 year with a 1 year right of renewal to allow time to for the club to deliver on Maunga outcomes and for those to be reviewed.

Rental

20. A market rental valuation has been undertaken by an independent registered valuer. The estimated annual rental is \$3,400 + GST.

Next Steps

21. If a lease is to be offered, Management will work alongside the Club to draft a Tūpuna Maunga Lease (including a Tūpuna Maunga Outcomes Plan) for consideration and execution by the Chair and Deputy Chair.

Tūpuna Maunga planting update

Author: Jordan Winiata – Kaihautū Tiaki Koiora

Purpose	To update the Tūpuna Maunga Authority on the 2021 restoration planting programme.
Recommendations	That the Tūpuna Maunga o Tāmaki Makaurau Authority: a) note the report

Restoration Planting Programme

- As discussed at Hui 64 (31 May, 2021), the ongoing restoration programme of planting native plants continues on Ngā Tūpuna Maunga.
- A total of 40,125 plants will be planted this year across 8 Tūpuna Maunga: Matukutūruru/Wiri Mountain, Maungarei/Mount Wellington, Ōhūiarangi/Pigeon Mountain, Ōtāhuhu/Mount Richmond, Ōwairaka/Te Ahi-kā-a-Rakataura/Mount Albert, Maungawhau/Mount Eden, Pukewīwī/Puketāpapa/Mount Roskill and Te Pane a Matāoho/Te Ara Pueru/Māngere Mountain between May – August 2021.
- These plantings add to the 65,860 plants already planted over the last 2 years (a total of 105,985 plants).
- The table below indicates the proposed planting details:

Tūpuna Maunga	Total plants	Potential Attendees	Planting Day(s) (2021)
Matukutūruru/Wiri Quarry	4,505	Ngā Mana Whenua, Department of Corrections, Department of Conservation, Specialist contractors	May 26 onwards
Maungarei / Mt Wellington	2,130	Specialist contractors	7 July onwards
Ōhūiarangi / Pigeon Mountain	10,755	Ngā Mana Whenua, Local schools, local community groups, Community	18 June (Schools planting), 26 June (Community planting)
Ōtāhuhu / Mt Richmond	7,695	Ngā Mana Whenua, Schools, local community groups, Sports club, Local businesses, Community, Specialist contractors	3 July and 1 August (Community planting)
Ōwairaka / Te Ahikā a Rakataura / Mt Albert	235	Specialist contractors	13 July onwards
Te Pane a Matāoho / Te Ara Pueru / Māngere Mountain	9,171	Ngā Mana Whenua, Schools, local community groups, Sports club,	11 June (Schools planting),

Tūpuna Maunga	Total plants	Potential Attendees	Planting Day(s) (2021)
		Local businesses, Community, Specialist contractors	Saturday 12 June and 21 August (Community planting event)
Maungawhau / Mt Eden	735	Specialist contractors	17 May onwards
Puketāpapa / Pukewīwī / Mt Roskill	4,899	Ngā Mana Whenua, Local community groups, Community, Specialist contractors	24 July (Community planting)

- The Maunga will be planted with the appropriate plant species within the guidance of ecosystem type, site suitability and fire retardant and archaeologically appropriate species.
- For health and safety reasons, there are areas on some of the Maunga where planting can only be undertaken using specialist contractors with the right qualifications, PPE and equipment to undertake the work.
- Community and schools planting dates were best aligned with the Maramataka. Where dates don't align with the Maramataka, this was due to the limits of contractor availability, schools availability and weekend planting dates.
- The multi-year planting programme will continue in 2022 and onwards.

Community Planting Days

- Management have successfully completed the full volunteer community planting program equating to six community planting days and three schools planting days across five different Maunga.
- Overall, management had 332 people registered for the six community planting days and 451 students from 16 different schools sign up for the schools planting days.
- Management anticipates that these figures will grow as more community engagement such as planting days are held across Maunga.

Next steps

- Continue with the ongoing restoration programme including planting maintenance and reporting
- Management will engage with nurseries, including those led by Mana Whenua, to supply plants for the 2022 planting season program.

Attachments

Attachment A: Puketāpapa / Pukewīwī / Mt Roskill Planting Day





Registers

Author: Nick Turoa; Tūpuna Maunga Authority

Purpose	To provide the Tūpuna Maunga Authority with updated registers for: a) Health & Safety (Attachment A) b) Events (Attachment B)
Recommendations	That the Tūpuna Maunga o Tāmaki Makaurau Authority: a) note the attached Registers, which have been updated since Hui 65 (26 July 2021).

Registers

Attachment A - Health & Safety Register.

Attachment B - Events Register.

Attachment A: Health and Safety Register

Hui reported to	Maunga	Summary of incident	Number of any near misses	Outcome of investigations into any incidents and near misses	Health and Safety management matters arising	Actions Taken
Hui 67	Maungawhau	Car has driven out of the Tahaki reserve over the hill doing surface damage to the grass.			Regular issues with unpermitted vehicle access	Grass to be remediated in the spring. As this hasn't been a frequent occurrence, we are currently monitoring the situation and considering bollards or a rock barrier.
Hui 67	Ōhūiarangi	Vandals have ripped off the toilet roll holder and set it on fire, as well as graffiti and other minor damage to assets.				Toilet roll holder replaced and minor damage repaired. Management are considering CCTV options for this site
Hui 66	Ōtāhuhu	Multiple incidents of quads and motorbikes driving on the sportsfield damaging the grass				The police have been notified of the incidents. Quad bikes are entering the site from various entry points including where capital works are being undertaken and pedestrian access ways. Management are investigating fencing options for the field.
Hui 66	Te Tātua a Riukiuta	Motorbike driving through the entrance of duke street and damaging turf, witnessed on two occasions in the morning.				The police have been notified of the incident. An arrest has recently been made of the person responsible. Management are awaiting further information from the police.
Hui 66	Ōhūiarangi	Sportsfield and slopes damaged by motorcycles driving onto the Maunga.				The police have been notified of the incident. Management are considering fencing options for the reserve and CCTV coverage.
Hui 66	Puketāpapa/ Pukewīwī	Contractor cut on Phoenix palm frond while putting rubbish on his truck		Contractor was hospitalised due to infection and not seeking medical attention right away		The Contractors have updated their SOP about working around Phoenix Palms. Workers have been reminded of their responsibilities to report health and safety incidents and seek medical attention at appropriate times.
Hui 66	Ōwairaka	Toilets vandalised by ripping out the flushing mechanism and pipes.				The police have been notified of this incident
Hui 66	Māngere	Oil spill reported at Mangere in the soccer club carpark running out of the track contractors site office area.		Contractor advised some spillage occurred when re-fueling their machinery. They have changed this process so that there is absorbent matting on the ground when this occurs.		Additional filter put around stormwater drain nearby and absorbent matting placed in spill area.

Hui reported to	Maunga	Summary of incident	Number of any near misses	Outcome of investigations into any incidents and near misses	Health and Safety management matters arising	Actions Taken
Hui 66	Maungakiekie	Oil spill reported on road area in the stardome carpark area. Potentially caused by vehicle that had driven through the area leaving a trail of oil earlier in the morning or overnight.		Area of spill was spreading out through carpark and onto Manukau Rd but contained by contractors.	Vehicles restricted from area until spill was cleaned up.	Area of spill cleaned up with absorbent product.
Hui 66	Maungakiekie	During weed eating stones have flicked up and damaged two car windows, one public vehicle and one contractor vehicle.				
Hui 64	Maungawhau	One of the planks on the boardwalk had a crack in it that has needed repairing			Potential to for plank to fail and injure a pedestrian	Plank spray-painted to indicate not to walk on Contractors attended and reapiored plank sufficient to walk over, but need to return to put proper plank back.
Hui 64	Ōwairaka, Te Tātua, Ōhinerau	Mowing contractors are routinely seeing dog owners not picking up after their dogs. This has led to them being covered in dog faeces during the mowing of these areas. Some areas have been sectioned off as they contain too much dog faeces to mow.			Contractors being covered in dog faeces	Problem areas sectioned off. Management considering locations of additional or new signage Management will be working with the contractor on a public awareness campaign to let people know the serious nature of the issue. A letter has been sent to dog walking companies to ensure they are picking up after themselves.
Hui 62	Maungawhau	Pedestrian slipped on the painted surfaces on the road to the tihi.				We have checked in with the contractor and confirmed that appropriate road grade paint was used alongside a non-slip surface application. Information about the incident came through the Auckland Council Reporting system but did not include the weather conditions or the types of shoes the person was wearing. Unfortunately contact details were not left either.
Hui 62	Puketāpapa	Multiple cars in lower carpark drinking in the mornings of weekends when contractors arrive to unlock		Contractors have said this is a regular occurrence early Saturday and Sunday mornings when they arrive to unlock.		Contractors to document when they see cars and bottles thrown around the maunga. Report lodged through police website of incident. Management have contacted local police station to investigate.

Hui reported to	Maunga	Summary of incident	Number of any near misses	Outcome of investigations into any incidents and near misses	Health and Safety management matters arising	Actions Taken
Hui 62	Māngere	Person has slipped on loop track, required air lift off the maunga to ambulance.				<p>Unfortunately this was not reported to staff immediately and it was not until well after the incident that we found out about this incident.</p> <p>The Authority have approved a track upgrade that will mitigate these types of hazards. Management are awaiting a resource consent to begin works on the track.</p> <p>A memo has been sent to the resource consenting team advising them of the incident and the importance of the track upgrades.</p>
Hui 61	Maungauika	A person was hit by a falling rock dislodged by child clambering up bank during cup racing days.		<p>The incident was thoroughly investigated by an Auckland Council Health and Safety officer. The investigation found that extensive planning had been put in place to manage large crowds on race days.</p> <p>The investigation found that the follow up actions were appropriate.</p>		<p>Staff stationed on Maungauika during racing attended the incident immediately alongside a police officer and a member of the public (who was a doctor) our staff member stayed with the person until an ambulance arrived.</p> <p>As a result extra signage was put up to prevent people to warn people about climbing on cliffs, extra security staff were put on duty during race days and more cliff areas cordoned off.</p>
Hui 61	Maungakiekie	Young girl was playing on the pipehenge structure outside Stardome and scratched herself on a sharp piece of metal sticking out.		Pipehenge is a Stardome asset, they are responsible for the future of structure.	Sharp object with potential to scratch anyone playing on structure	<p>Playground sectioned off</p> <p>Stardome have removed the structure</p>
Hui 61	Ōwairaka	On 21 January 2021, while mowing Ōwairaka contractors noted that the dog faeces were worst they have ever been, and mower operators got covered in dog faeces		Contractors noted that multiple doggy day care vans use Ōwairaka as a exercise area and don't pick up after the dogs in their care	Unsanitary work environment for contractors on the Maunga	<p>TMA committing summer field officers to Ōwairaka for at least two hours for two days a week.</p> <p>Signage indicating dog owners pick up after their dogs erected at car park</p>
Hui 60	Maungauika	On 7 November 2020 a Mountain biker going off road fell off and dislocated shoulder		The injury was the result of an unlawful activity.		

Hui reported to	Maunga	Summary of incident	Number of any near misses	Outcome of investigations into any incidents and near misses	Health and Safety management matters arising	Actions Taken
				Signage is in place on the Maunga (including directly beneath where the person fell off) Management were on site and assisted with the first aid given to the person and waited with them until an ambulance arrived		
Hui 60	Maungarei	On 6 November 2020, a group of youths attempted to get onto the Maunga to light fireworks. When they were asked to leave they tried to assault the guards on duty. Whilst running away, the security guard observed a can of petrol in one of the people's hands				The incident was reported to the Police who are currently investigating. An extra guard was put on the Maunga the following night and there will be night patrols on Maungarei over the next weekend.
Hui 60	Takarunga	On 5 November 2020, fireworks were thrown at guards on duty standing at the gate of Takarunga				While the security guard were unable to get registration details, the incident was reported to the Police.
Hui 60	Ohuiarangi	Several motorbikes driving up and down the terracing at Ōhuiārangi		Contractor reported that they are using mainly the track through the bush that was previously dug out for illegal mountain bike tracks		Temporary fencing has been put in between the trees to block access down from the tihi through this area. Bike signage still up and will be checked regularly The Team is investigating the possibility of barriers to prevent motor bikes.
Hui 58	Maungarei	Fire started on adjoining land to Maungarei Maunga from fireworks.	1	The fire was started as a result of fireworks set off by a group of youths. Apologies have been received by two of the youths and also an email report from the detective who investigated the matter. It is understood that group reported the incident directly to FENZ.		Tūpuna Maunga Staff attended the fire on the night and confirmed that the fire was not on the legal boundary of the Tūpuna Maunga. All firebreaks have been reviewed on Maungarei and extra precautions have been put in place during the closure of the Maunga during the Guy Fawkes Period.
Hui 58	Owairaka	A dog that was not under control attacked a member of the Mowing Team				Tūpuna Maunga staff ensuring dog bylaw signage still intact. Animal management contacted for assistance in managing uncontrolled dogs off leash

Hui reported to	Maunga	Summary of incident	Number of any near misses	Outcome of investigations into any incidents and near misses	Health and Safety management matters arising	Actions Taken
Hui 58	Maungawhau	Motorbike going down Maungawhau		Contractors were unable to get license plate for bike owner, have recommended additional speed humps or some other form of deterrent for bikes that come down the summit road		Tūpuna Maunga staff investigating options at slowing traffic down this side, already speed humps there currently though
Hui 57	Maungauika tunnel	Management have recently had a site visit to the tunnels with Geotech engineers who have advised that further assessments should be made of two areas; the tunnel leading to the coastal walkway and the “cave” next to the southern battery.				Management have sought a report from Geotech engineers and engineers about the safety of these two assets.
Hui 57	Maungauika/ North Head	On 27 July contractors advised us of a large new slip on the Maungauika/ North Head Coastal Track			This track has now been closed for over a year due to a slip in 2019. Management have previously scaled the wall of all loose rock and vegetation and been working with Geotech engineers and Geologist at the site for over a year now.	The Track remains closed. Extra signage and barriers have been put in place. Management have engaged Geotech engineers and geologist to re-assess the site.
Hui 56	Ōwairaka/ Te Ahi-Kā-a-Rakataura / Mt Albert	Feedback from public that the the La Veta entranceway track on Owairaka is slippery and that people have been slipping on the track			Peripheral tracks on Owairaka require upgrading. Management are investigating potential options. People have been pulling down the barriers and ripping off signage. Incidents have been reported to police. Barriers replaced with a “track closed” sign	The track has been closed until dry enough to reopen.
Hui 56	Ōwairaka/ Te Ahi-Kā-a-Rakataura / Mt Albert	Member of public slipped on the road on a patch of lichen breaking their arm			Management are reviewing the road surface and investigating potential upgrades.	Management have made contact with the member of the public and advised of actions taken to remedy the situation. The lichen has been waterblasted using a non-potable water source.
Hui 55	Ōwairaka / Te Ahi-Kā-a-Rakataura / Mt Albert	Member of the public has allegedly been attacked by another member of the public on 6 June 2020.				CCTV footage for the day has been forwarded to the police as part of their investigation. Management continue to assist Police with their investigation where possible
Hui 54	Maungawhau/ Mt Eden	Large party held on the tihi of the maunga on the night of Friday 15 May 2020.				Incident reported to the police (incident number: OR-52891N)

Hui reported to	Maunga	Summary of incident	Number of any near misses	Outcome of investigations into any incidents and near misses	Health and Safety management matters arising	Actions Taken
		Excessive smashed glass discovered in the morning over the tihi summit carpark				Glass Cleaned up and extra patrols organised for Saturday Night.
Hui 54	Ōwairaka/ Te Ahi-Kā-a-Rakataura / Mt Albert	2 Wasp nests discovered by biosecurity contractors. One near Archery Club, one near the summit road				Wasps nest treated with insecticide..
Hui 53	Ōwairaka / Te Ahi-kā-a-Rakataura / Mt Albert	Reports received from members of the public that the protest group were undertaking surveillance of the campsite in breach of the COVID 19 level 4 lockdown rules. Further reports were received that there were people congregating in and around the campsite in breach of the lockdown rules. Reports received from public and confirmed by contractors that tents from the camp had been moved around and new protest signs erected at the camp in breach of the COVID 19 lockdown rules.				Officers removed the tents, marquees and the several truckloads of other camping equipment in accordance with the Reserves Act. They will be returned to the owners when the COVID 19 alert levels allow.
Hui 53	Maungarei	A grass fire was caused by fireworks. Incident number: F2983259. At approximately 1830 FENZ received reports that there were people letting off fireworks on and around the maunga. An appliance was sent to site but no fire was spotted. At 1923 the fire was reported and further appliances dispatched. an area of 60m by 30m was damaged as a result of the fire.		FENZ have provided reports that the cause of the fire was fireworks – the initial call identified people with fireworks on the Maunga and the Incident Controller on the site at the time was of the opinion that fireworks were the cause.		A Tūpuna Maunga Officer was dispatched to site to provide information and support to FENZ. Tūpuna Maunga Authority issued a media release which called for the ban for the sales of Fireworks.

Attachment B: Events Register

Hui reported to	Maunga	Applicant	Event Description	Event date	Status	Revenue
Hui 66	Maungakiekie	Kids Can Fundraiser	Community	22 August 2021	Approved	No Charge
Hui 66	Maungarei	Chiropractic College health screening	Community	31 July 2021	Approved	No Charge
Hui 66	Maungawhau	Fresh TV segment	Community	23 July 2021	Approved	No Charge
Hui 65	Maungawhau	Ficino School cross country	Community	20 August 2021	Approved	No Charge
Hui 65	Maungarei	Tamaki Regeneration Matariki dawn hīkoi	Community	2 July 2021	Approved	No Charge
Hui 65	Maungauika	Nature Baby photoshoot	Commercial	2 July 2021 and 22 July 2021	Approved	\$600 ex gst
Hui 65	Maungawhau	Silo Theatre audio play launch event	Community	2 July 2021	Cancelled	(\$190 ex gst)
Hui 65	Puketāpapa	Puketāpapa Manu Aute Kite Day	Community	26 June 2021	Approved	No Charge
Hui 65	Ōwairaka	Ōwairaka School Matariki dawn hīkoi	Community	25 June 2021	Approved	No Charge
Hui 65	Ōwairaka	Emerge Aotearoa Matariki dawn hīkoi	Community	25 June 2021	Approved	No Charge
Hui 65	Te Pane-o-Mataoho/Māngere Mountain	Māngere Education Centre dawn Matariki hīkoi	Community	19 June 2021	Approved	No Charge
Hui 63	Maungawhau/Mt Eden	Epsom Girls Grammar hīkoi	Community	25 June 2021	Approved	No Charge
Hui 63	Ōtāhuhu	Auckland Ruby League game and livestream	Community	19 June 2021	Approved	No Charge
Hui 63	Maungawhau	Students filming for University of Auckland assignment	Community	4 June 2021	Approved	No Charge
Hui 63	Maungawhau	Conservation Volunteers New Zealand volunteer appreciation event	Community	8 May 2021	Approved	No Charge

Hui reported to	Maunga	Applicant	Event Description	Event date	Status	Revenue
Hui 63	Maungakiekie	5 th birthday picnic	Community	8 May 2021	Approved	No Charge
Hui 63	Maungakiekie	Elopement/Wedding	Private	8 May 2021	Approved	\$450 ex GST
Hui 63	Maungawhau/Mt Eden	Morris Dancers	Community	1 May 2021	Approved	No Charge
Hui 63	Maungawhau/Mt Eden	Diocesan School for Girls hīkoi	Community	17 April 2021	Approved	No Charge
Hui 63	Te Pane-o-Mataoho/Māngere Mountain	Police cultural competency hīkoi	Community	16 April 2021	Approved	No Charge
Hui 63	Te Pane-o-Mataoho/Māngere Mountain	Kī o Rahi Tāmaki Makaurau school tournament	Community	13 April 2021	Approved	No Charge
Hui 63	Ōwairaka/Mt Albert	Mount Albert Presbyterian Church Easter Sunday Dawn Services	Community	4 April 2021	Approved	No Charge
Hui 63	Takarunga/Mt Victoria	Combined Churches of Devonport Procession of Witness	Community	2 April 2021	Approved	No Charge
Hui 63	Maungarei/Mt Wellington	Point England School teachers only day hīkoi	Community	1 April 2021	Approved	No Charge
Hui 63	Maungakiekie/One Tree Hill	Western Springs College Year 9 history trip	Community	31 March 2021	Approved	No Charge
Hui 63	Maungarei/Mt Wellington	Tamaki Regeneration Company hīkoi	Community	27 March 2021	Approved	No Charge
Hui 63	Maungarei/Mt Wellington	Tamaki Regeneration Company hīkoi	Community	25 March 2021	Approved	No Charge
Hui 63	Maungakiekie/One Tree Hill	Meadowbank School Year 5 Leadership Day	Community	25 March 2021	Approved	No Charge
Hui 62	Maungakiekie / One Tree Hill	Fire and Emergency Family BBQ	Community	21 March 2021	Cancelled	Free
Hui 62	Takarunga / MT Victoria	Imagination TV – filming for company promotion	Commercial	10 March 2021	Approved	\$450
Hui 61	Maungawhau / MT Eden	Auckland Pride Board – Karakia to start Pride Festival	Community	3 February 2021	Approved	Free

Hui reported to	Maunga	Applicant	Event Description	Event date	Status	Revenue
Hui 61	Maungawhau / Mt Eden	Greenstone TV Ltd – filming for television show	Commercial	20 January 2021	Approved	\$1800
Hui 60	Maungawhau/ Mt Eden	Universal Music New Zealand Ltd – music video	Commercial	Thursday 17 December 2020	Approved	\$450
Hui 60	Maungakiekie/ Mt Eden	Power Rangers Productions – filming for television show	Commercial	12 November 2020	Approved	\$1800
Hui 59	Ōhūiarangi	Blue Light ventures – young people obstacle course competition	Community	Friday 23 September	Approved	No Charge
Hui 59	Maungawhau /MT Eden Tahaki Reserve	Ficino School – Cross Country	Community	Wednesday 9 September 2020	Approved	No Charge
Hui 59	Maungauika/ North Head	Devonport Marathon	Commercial	Saturday 10 October	Approved	\$1200
Hui 57	Ōtahuhu/ Mt Richmond	Auckland Rugby League Club (live stream filming)	Community	Saturday 1 August	Approved	\$380
Hui 56	Pukewīwī / Puketāpapa / Mt Roskill	Puketāpapa Local Board – Manu Aute / Matārīki celebration	Community	Sunday 28 June Sunday 5 July Sunday 12 July	Approved	No Charge
Hui 56	Maungawhau/ MT Eden	Epsom Girls Grammar – Matārīki Karakia	Community	26 June	Approved	No Charge
Hui 55	Maungarei/ Mt Wellington	Dawn Raid Entertainment	Filming	10 June 2020	Approved	\$380
Hui 55	Te Pane a Mataoho/ Mangere Mountain	Dawn Raid Entertainment	Filming	8 June 2020	Approved	\$380